

Floor Plan General Notes

- 3. New fire partition installed within existing openings DG03 & DF02. Refer to Drawing 311;
- 4. Existing door rehung to open outwards, the fire resistance is to be improved. Refer to Drawing 330
- 5. Existing door, fire resistance is to be improved. Refer to Door Schedule Drawing 330.

7. Existing asbestos clad fire resistant door, this is to have the asbestos removed. After these works, fire resistance is to be improved. Refer to: Drawings 110 & 111; Door Schedule 330;

12. Remove the asbestos lining from the staircase and repair structure in accordance with report.

11. Remove the decayed modern timber rooflight; including the internal modern wire glass glazing; and replace with a new low profile rooflight; such as 'The Conservation Plateau Rooflight' from 'The Rooflight Company'; this will not be visible above the parapet level. Internally the plaster is to be made good and the existing 'soffit architrave' reused to form the opening.

16. All existing cast iron rainwater pipes & lead rainwater goods are to be taken down, fully refurbished, redecorated/refinished and reinstalled. They are to be reinstalled in their original locations; the downpipes are to be adapted and be fitted with shoes. The gulleys are to be replaced with new earthenware accessible gulleys fitted with cast iron covers. Paint colour to match existing; British Standard BS 4800 '00 E 55 White'.

18. New platform lift; refer to Drawing 301.





20. Floor void to be environmentally cleaned of asbestos. Refer to Drawing 111 and Asbestos Survey.

DO NOT SCALE THIS DRAWING USE DIMENSIONS ONLY
 VERIFY ALL DIMENSIONS ON SITE BEFORE COMMENCING ANY WORK OR SHOP DRAWINGS
 INFORM THE ARCHITECT BEFORE ANY WORK STARTS IF THIS DRAWING EXCEEDS THE QUANTITIES IN ANY WAY

Revision	Date	Description
A	11th May 2017	All Notes Amended
B	31st August 2017	Notes amended for planning submission
C	5th January 2018	Lift proposals adjusted

Read this drawing in conjunction with all current issue Drawings, Specifications and the Schedule of Works. Notify the Architect to any discrepancies in the information immediately.

Alterations & Repairs Key

-  Fire partition
-  Fire resistant door
-  Work to a miscellaneous item; refer to notes for details
-  Refurbish rainwater goods
-  I. identified asbestos; refer to asbestos report



Asbestos is present within this building.

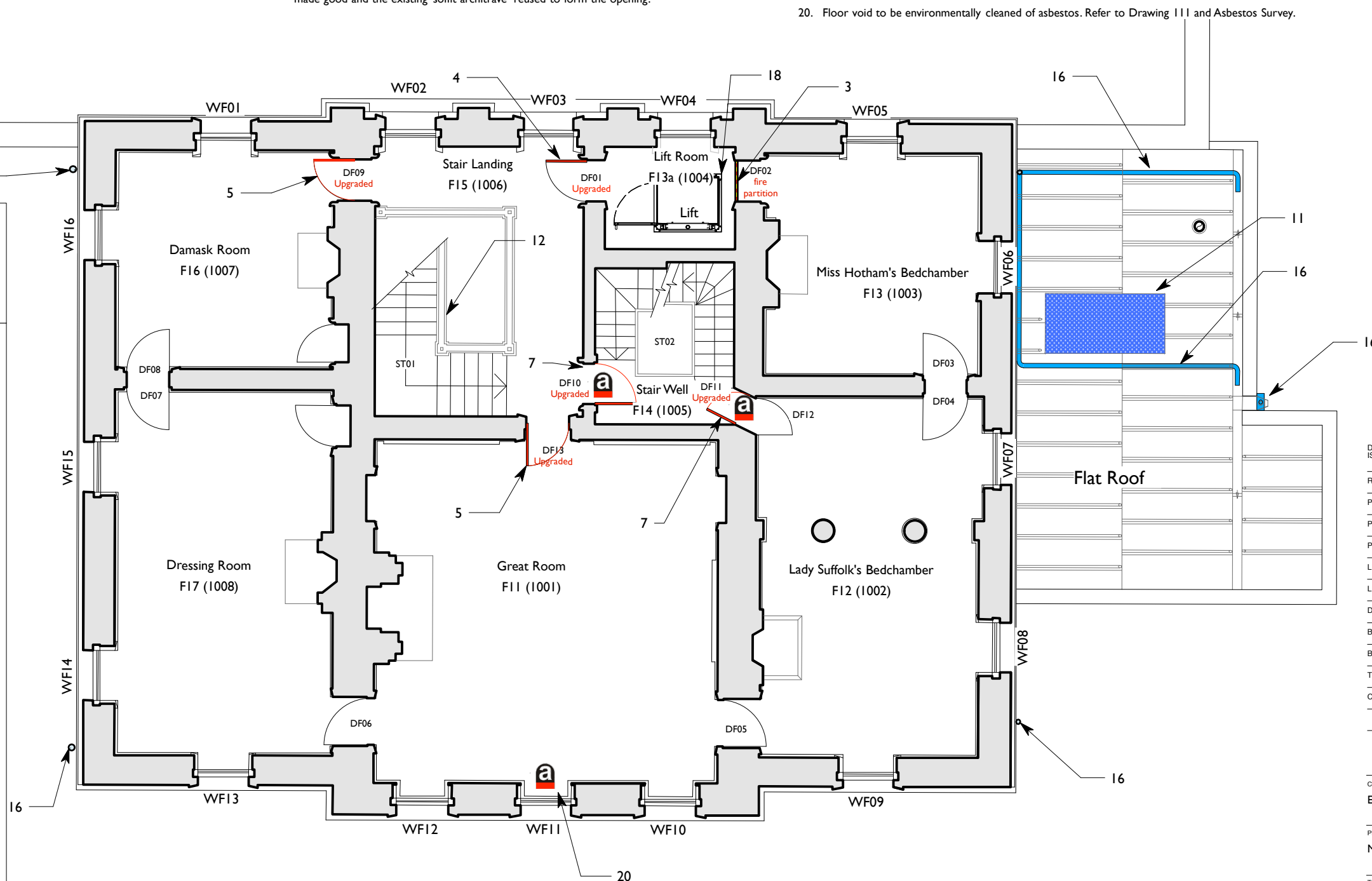

First Floor Plan



DRAWING ISSUE STATUS	REVISION N°	DATE	SIGNED
RISK ASSESSMENT UNDERTAKEN			
PLANNING APPLICATION N° 1			
PLANNING APPLICATION N° 2			
PLANNING CONSENT			
LISTED BLDG APPLICATION			
LISTED BLDG CONSENT			
DAC APPROVAL			
BLDG CONTROL APPLICATION			
BLDG CONTROL APPROVAL			
TENDER DOCUMENT			
CONTRACT DOCUMENT			

CLIENT
English Heritage

PROJECT
Marble Hill House

TITLE
Main House:
First Floor Plan; as Proposed

SCALE
1:100 @ A3

DATE
December 2016

JOB N°
16_132

DRAWN
HS

DRAWING N°
211 C

Acanthus Clews architects
 Acanthus House
 57 Hightown Road
 Banbury • Oxfordshire
 OX16 9BE
 Tel: 01295 702600
 Fax: 01295 702601
 architects@acanthusclews.co.uk
 www.acanthusclews.co.uk