

DO NOT SCALE THIS DRAWING USE DIMENSIONS ONLY  
 VERIFY ALL DIMENSIONS ON SITE BEFORE COMMENCING ANY WORK OR SHOP DRAWINGS  
 INFORM THE ARCHITECT BEFORE ANY WORK STARTS IF THIS DRAWING EXCEEDS THE QUANTITIES IN ANY WAY

**ISSUE STATUS:**

Revision	Date	Change of layout
A	19/03/18	Change of layout
B	30/07/18	Addition of notes
C	16/08/18	Addition of doors and minor note changes

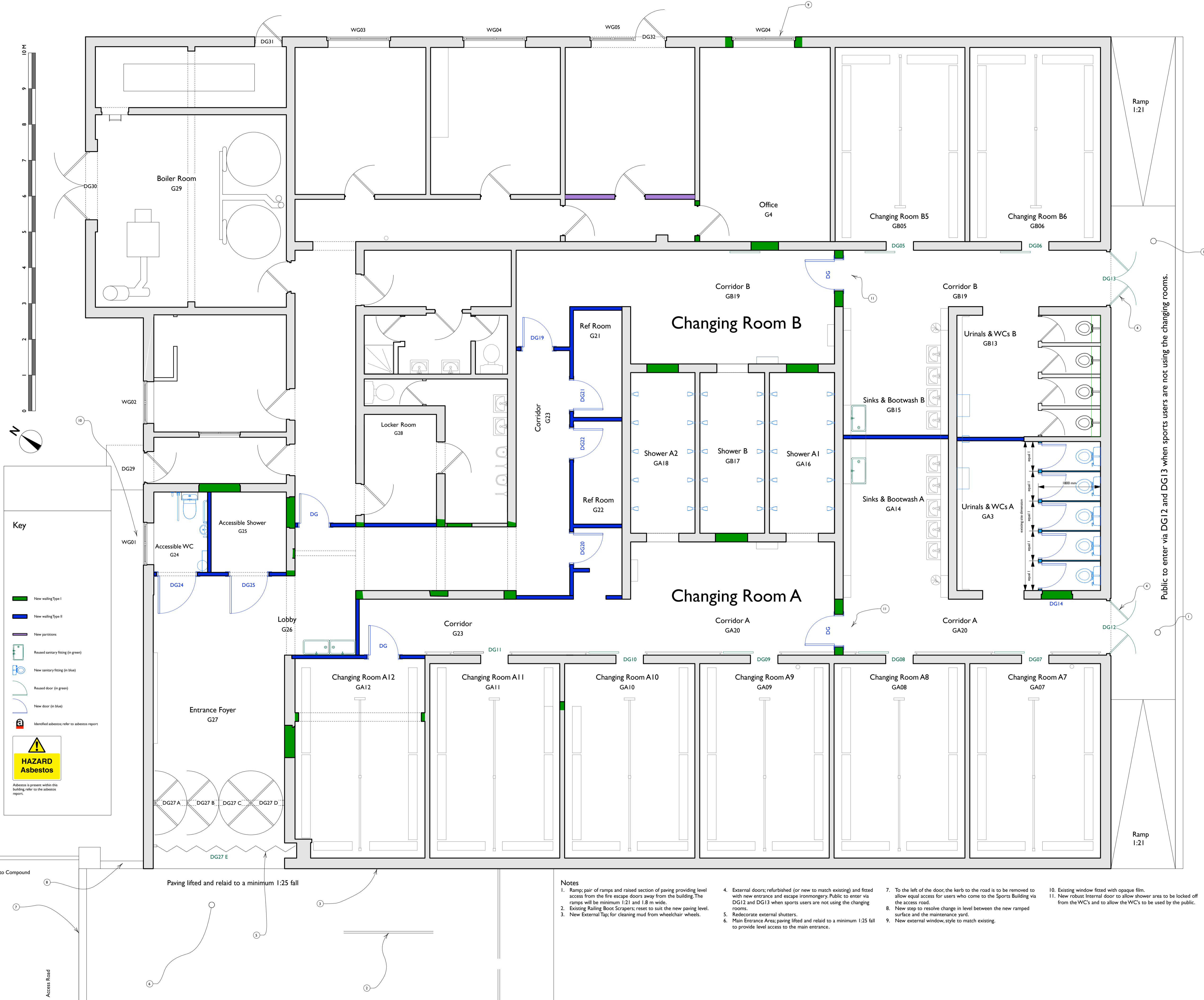

Public to enter via DG12 and DG13 when sports users are not using the changing rooms.

**Key**

- New wall Type I
- New wall Type II
- New partitions
- Raised sanitary fitting (in green)
- New sanitary fitting (in blue)
- Raised door (in green)
- New door (in blue)
- Identified asbestos; refer to asbestos report

**HAZARD Asbestos**

Asbestos is present within this building; refer to the asbestos report.

- Notes**
- Ramp; pair of ramps and raised section of paving providing level access from the fire escape doors away from the building. The ramps will be minimum 1:21 and 1.8m wide.
  - Existing Railing Boot Scrapers; reset to suit the new paving level.
  - New External Tap; for cleaning mud from wheelchair wheels.
  - External doors; refurbished (or new to match existing) and fitted with new entrance and escape ironmongery. Public to enter via DG12 and DG13 when sports users are not using the changing rooms.
  - Redecorate external shutters.
  - Main Entrance Area; paving lifted and relaid to a minimum 1:25 fall to provide level access to the main entrance.
  - To the left of the door, the kerb to the road is to be removed to allow equal access for users who come to the Sports Building via the access road.
  - New step to resolve change in level between the new ramped surface and the maintenance yard.
  - New external window, style to match existing.
  - Existing window fitted with opaque film.
  - New robust internal door to allow shower area to be locked off from the WC's and to allow the WC's to be used by the public.

CLIENT  
English Heritage  
Estates Department

PROJECT  
Marble Hill Sports Building  
Refurbishment

TITLE  
Ground Floor Plan  
As Proposed

SCALE  
1:50 @ A1

DATE  
November 2017

JOB N°  
17-146

DRAWN  
HS

DRAWING N°  
210 C

Acanthus House  
57 Hightown Road  
Banbury · Oxfordshire  
OX16 9BE  
Tel: 01295 702600  
Fax: 01295 702601  
architects@acanthusclews.co.uk  
www.acanthusclews.co.uk