

19/09

NOTES

THIS DRAWING IS THE COPYRIGHT OF THE ARCHITECT

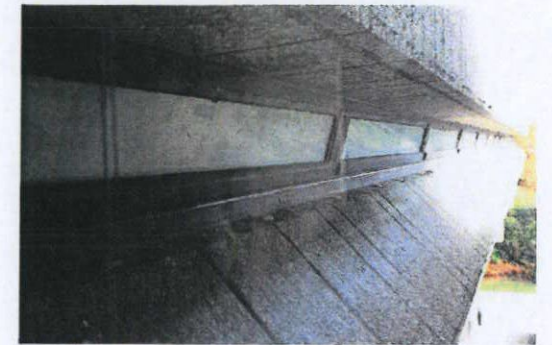

PHOTOGRAPH OF TYPICAL REPOSITORY EXTERNAL WINDOW/WALL

NOTES:

- THE INFORMATION SHOWN HERE IS PROVISIONAL ONLY DUE TO 'AS BUILT' DRAWINGS NOT BEING AVAILABLE
- READ IN CONJUNCTION WITH 'STRUCTURA' REPORT OF 16/08/2018 ON REMOVAL OF A TYPICAL EXISTING WINDOW

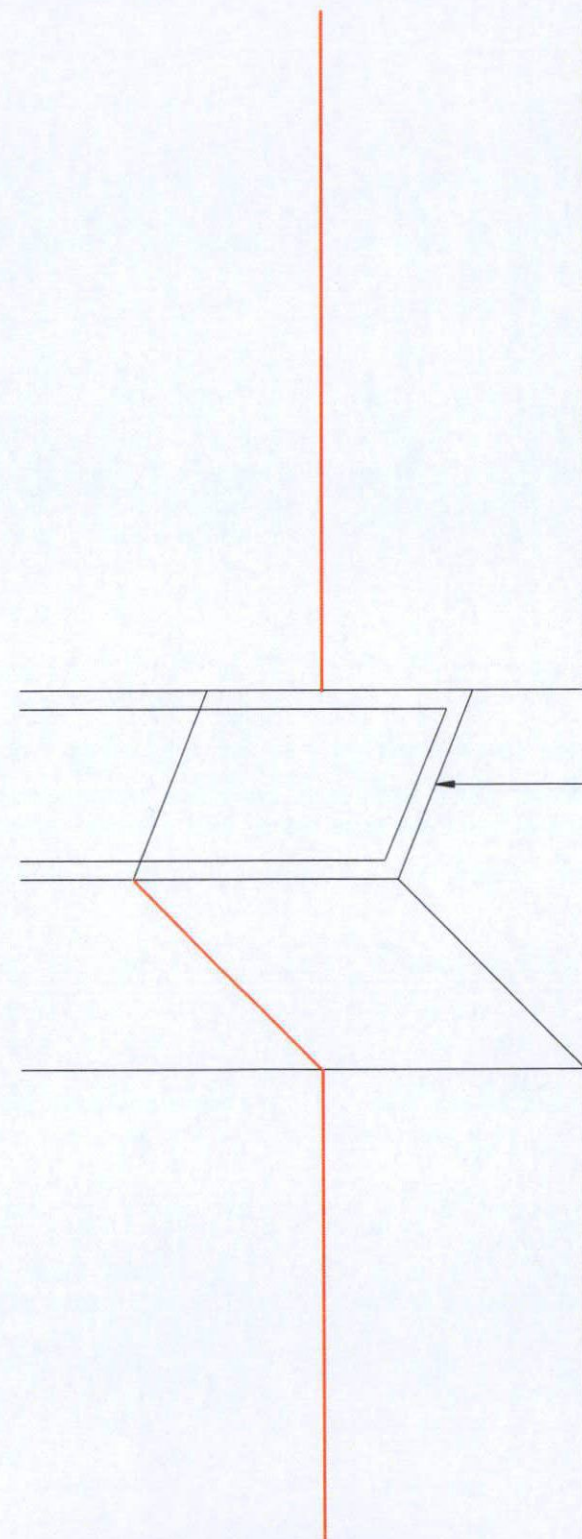

PART ELEVATION OF 3RD FLOOR REPOSITORY WALL/WINDOW

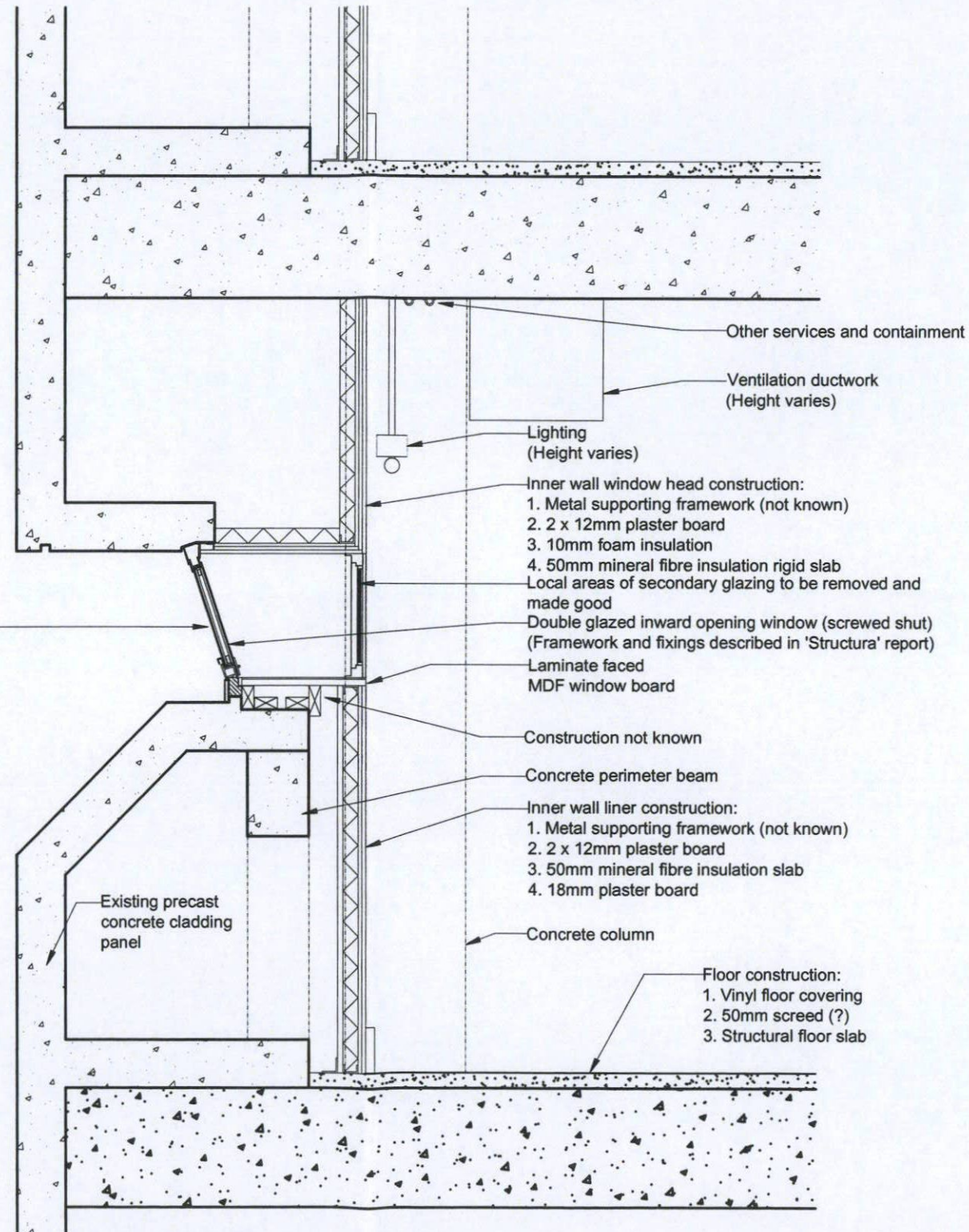

TYPICAL APPROX SECTION THROUGH 3RD FLOOR REPOSITORY WALL/WINDOW

REV	DATE	DESCRIPTION
-----	------	-------------



RAYLEIGH HOUSE 2 RICHMOND HILL, RICHMOND, SURREY TW10 6QX
Tel: 0208 940 3323 Fax: 0208 948 4256 mail@htparchitecture.co.uk

PROJECT
THE NATIONAL ARCHIVES
Q1 BUILDING REPLACEMENT OF
2ND-4TH FLOOR WINDOWS
AND WORKS TO ROOF

DRAWING TITLE
TYPICAL REPOSITORY
WALL/WINDOW SECTION
APPROX AS EXISTING

SCALE	DATE	DRAWN BY
1:20 @A3	AUG 2018	CD
JOB No		DRAWING No
18029		R015