

**Section 5**

**The Proposals**

# Section 5 - The Proposals

## The Proposals

Accommodation is arranged over 6 floors, with specilaist extra care units located from levels 1 to 5, with the ground floor dedicated to all supporting care/treatment, leisure and BOH accommodation.

The proposed breakdown and mix of care unit types is as follows:

	No. Units	Approx. Area (sqm)	Approx Area (sqft)
1 Bed	11	53 - 55	600
2 Bed	6	75	800
2 Bed +	45	80 - 90	900
2 Bed ++	20	90 - 100	1000
2 BED + Study	7	100+	1000+
Total	89		

Out of an approximate GIA of 2000 sqm at ground floor, 1300sqm is allocated to residents care facilities and communal accommodation.

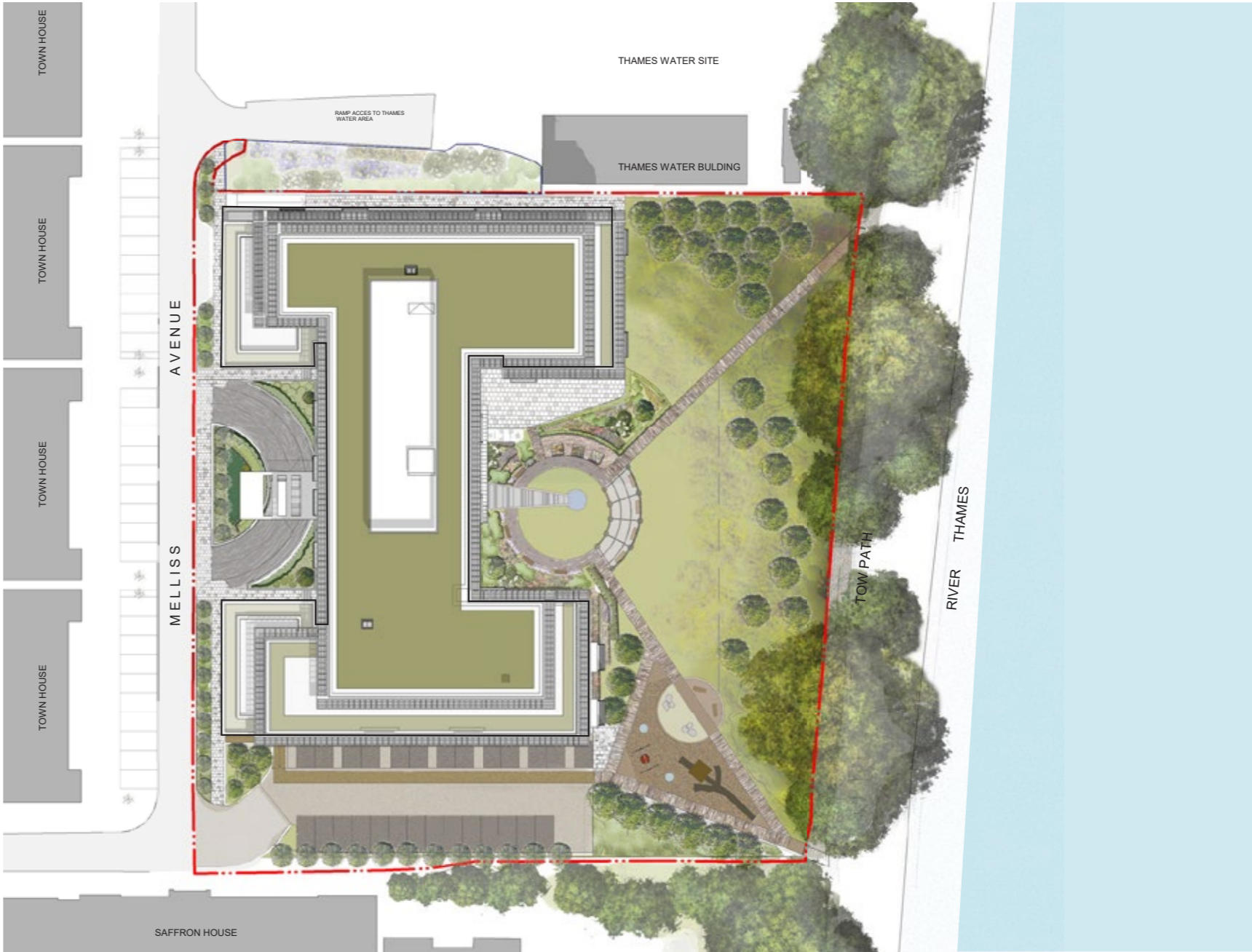

Proposed Site Plan

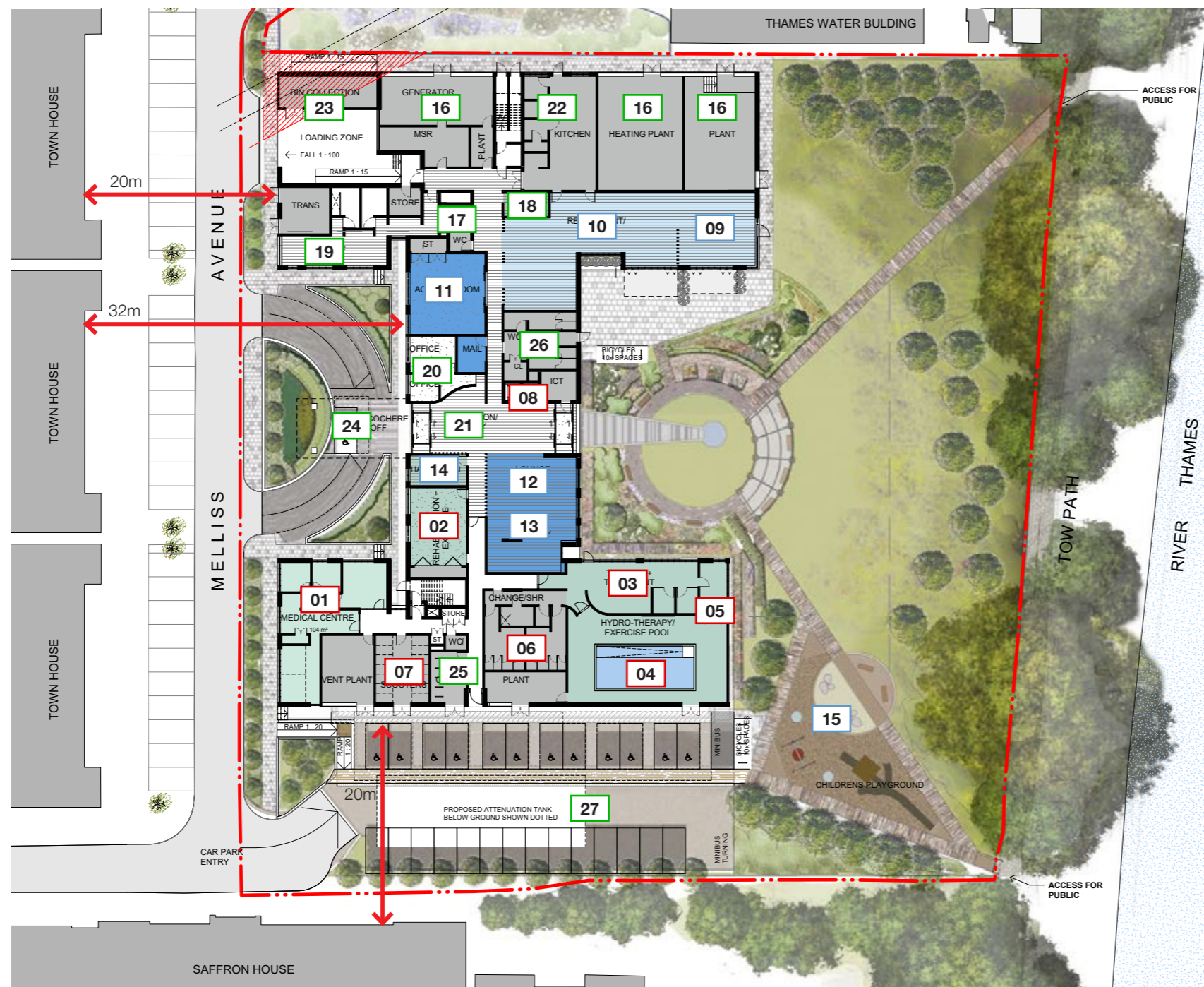

Proposed Ground Floor Plan

## Proposed Ground Floor Accommodation

### Care Facilities

1. Medical Centre
2. Rehabilitation and Exercise Room
3. Therapy and Treatments Rooms
4. Hydro-Therapy and Exercise Pool
5. Hoist Store
6. Changing Facilities
7. Mobility Scooter & Charge Store
8. Centrally Controlled Residents Lift Core

### Leisure / Amenity Facilities

9. Cafe
10. Restaurant / Bar
11. Activity Room
12. Lounge
13. Library
14. Hair Salon
15. Play Area

### BOH and Support Facilities

16. MEP Rooms
17. Service Lift
18. Linen Store / Sluice Room
19. Staff Change and Rest Accommodation
20. Offices
21. Reception / Lobby
22. Kitchen
23. Refuse / Servicing
24. Porte Cochere
25. Cycle Storage
26. WCs
27. Car Park

# Section 5 - The Proposals

## Levels 1 to 3

### Proposed Level 1 Accommodation

2 x 1 Bed	53 - 55 sqm
1 x 2 Bed	75 sqm
11 x 2 Bed +	80 - 90 sqm
5 x 2 Bed ++	90 - 100 sqm
1 x 2 Bed +S	100+ sqm

### Proposed Level 2 Accommodation

2 x 1 Bed	53 - 55 sqm
1 x 2 Bed	75 sqm
11 x 2 Bed +	80 - 90 sqm
5 x 2 Bed ++	90 - 100 sqm
1 x 2 Bed +S	100+ sqm

### Proposed Level 3 Accommodation

2 x 1 Bed	53 - 55 sqm
1 x 2 Bed	75 sqm
11 x 2 Bed +	80 - 90 sqm
5 x 2 Bed ++	90 - 100 sqm
1 x 2 Bed +S	100+ sqm



Proposed Level 1 General Arrangement