



Notes
 1. Drawing not to be scaled for construction or setting out purposes.
 2. To be read in conjunction with Project Risk Register REF: XXX
 3. To be read in conjunction with all other Landscape Architect's drawings

- KEY**
- Full sun planting mix**
 - Cotinus coggygria
 - Deschampsia cespitosa
 - Rudbeckia fulgida var. sullivanti 'Goldsturm'
 - Salvia nemorosa 'Caradonna'
 - Slipa tenuissima
 - Partial sun planting mix**
 - Aster frikartii 'Monch'
 - Geranium macrorrhizum 'White-Ness'
 - Pachysandra terminalis 'Green Carpet'
 - Rudbeckia fulgida var. sullivanti 'Goldsturm'
 - Saxifraga x urbium
 - Entrance herbaceous planting mix**
 - Aster frikartii 'Monch'
 - Calamagrostis x acutiflora 'Karl Foerster'
 - Fatsia japonica
 - Geranium macrorrhizum 'White-Ness'
 - Lavendula angustifolia 'Hidcote'
 - Pachysandra terminalis 'Green Carpet'
 - Amenity grass seeding**
 - Rollawn medallion turf or similar
 - Woodland planting mix**
 - Amalanchier lamarckii
 - Acer campestre
 - Betula pendula
 - Crataegus monogyna
 - Cornus alba
 - Cornus sanguinea
 - Hazel Corylus avellana
 - Hawthorn
 - Lavendula angustifolia
 - Rosa canina
 - Rosmarinus
 - Sambucus nigra
 - Green wall mix**
 - Parthenocissus tricuspidata
 - Clematis armandii
 - Species rich grassland**

Planting Strategy

Species	Density	Girth (cm)	Height (cm)	Clear Stem (cm)	RB
Acer platanoides	As shown	18-20cm	450-500cm	175-200cm	RB, 3x, Extra Heavy
Betula pendula	As shown	18-20cm	450-500cm	175-200cm	RB, 3x, Extra Heavy
Quercus robur 'Fastigiata'	As shown	18-20cm	450-500cm	175-200cm	RB, 3x, Extra heavy
Tilia cordata 'Greenspire'	As shown	18-20cm	450-500cm	175-200cm	RB, 3x, Extra heavy

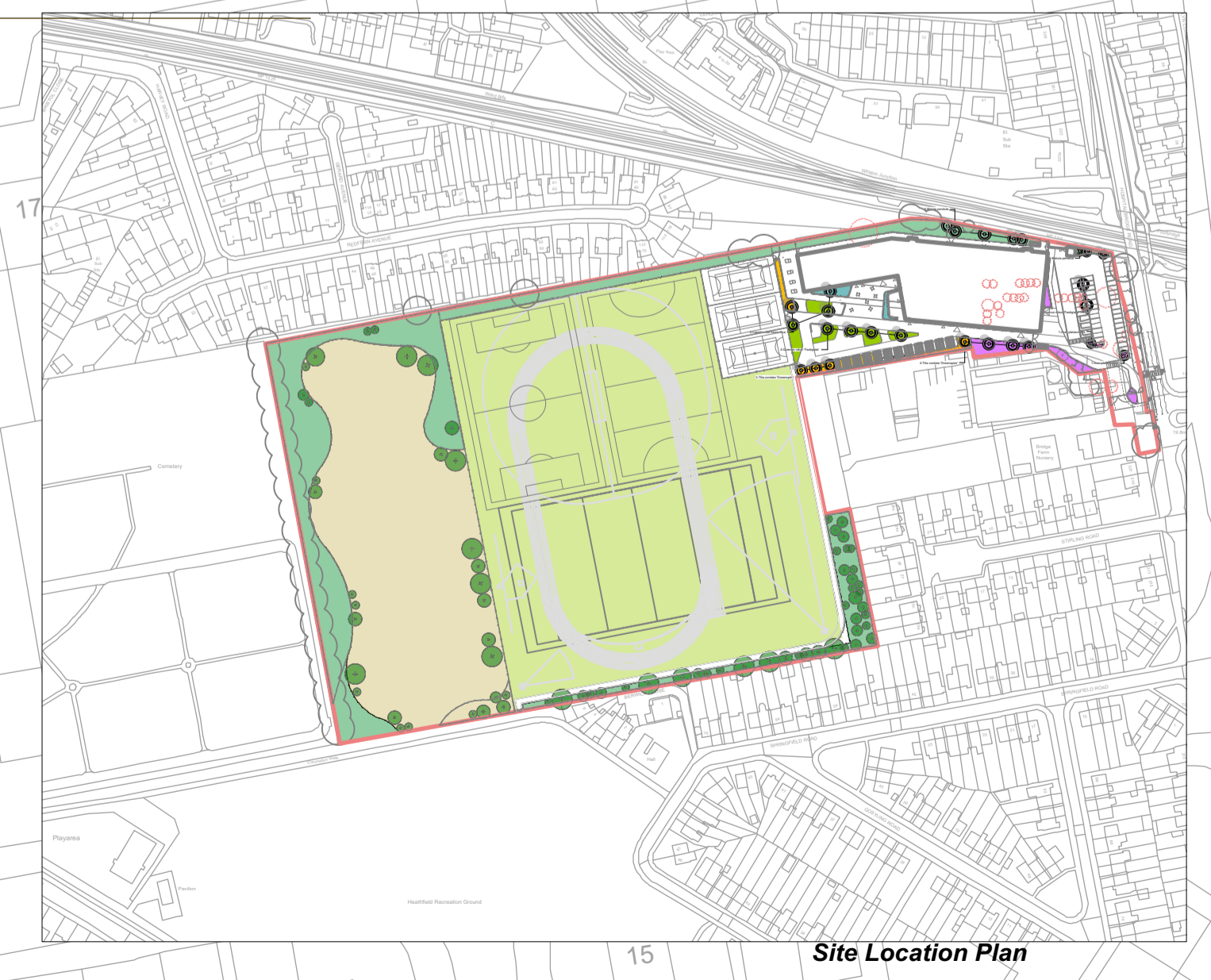

ID	RISK	MITIGATION	Date Mitigated
RESIDUAL PROJECT RISKS			

DATE	SUITABILITY	REV	DESCRIPTION OF REVISION	HT	LA
13.11.18	S2	P02	Highways entrance and adjacent area updated.	HT	LA

REVISIONS

SUITABILITY
S2 - For Planning

ares
 LANDSCAPE ARCHITECTS

Ares Landscape Architects LTD
 Galtcrasher
 51 Eye Lane
 Sheffield
 S1 4RB

t: 0114 276 2000
 e: hello@ares.eu.com
 w: ares.eu.com

CLIENT:
Bowmer and Kirkland

PROJECT TITLE:
Turing House School

DRAWING TITLE:
Planting Strategy

DRAWING SCALE: 1:500
 DRAWN BY: EC
 DATE: 02.03.2018

APPROVED BY: LA

DRAWING NUMBER: **EFATH-ALA-00-XX-DR-L-0014**
 SUITABILITY: **S2**
 REVISION: **P02**