

NOTES  
 1 The Contractor must check and confirm all dimensions  
 2 All discrepancies must be reported and resolved by the Architect before works commence  
 3 This drawing is not to be scaled  
 4 All work and materials to be in accordance with current applicable Statutory Legislation and to comply with all relevant Codes of Practice and British Standards  
 5 This drawing is based on a measured survey by MSA

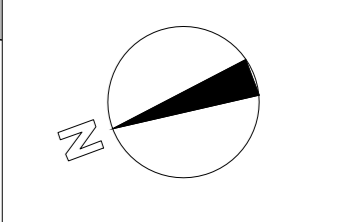

**Legend**  
 Red hatch indicates  
 Extent of external walls /  
 floors to be removed  
 Grey hatch indicates  
 existing structure

**KEY LEGEND:**  
 1. Existing window cill lowered to form new door opening or bigger window  
 2. New window/door opening  
 3. Wall/Floor to be removed  
 4. Existing door opening reduced to form new window opening  
 5. Existing steel stair to be removed  
 6. Existing window to be replaced with matching timber windows  
 7. Alteration to existing roof structure to accommodate new dormers/rooflights  
 8. Existing rooflight/skylight to be removed  
 9. Existing roof removed as part of refurbishment works  
 10. Existing rafter to be replaced to comply with Part K of Building Regs.  
 11. Existing floor level to be lowered

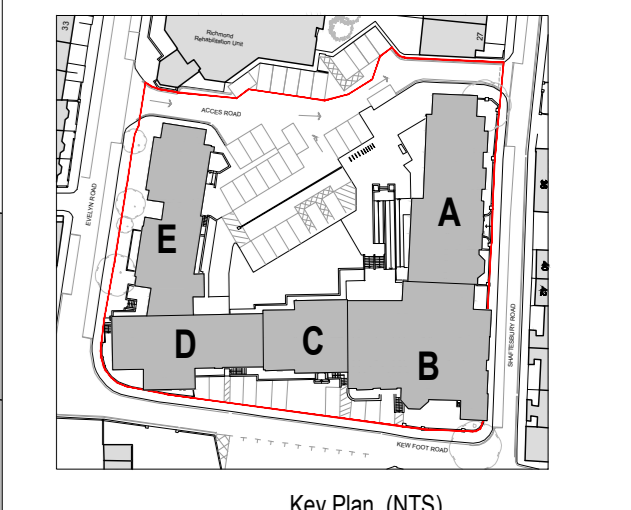

1A Issued for Planning Submission 29/11/18  
 Rev Date

**Rolfe Judd**  
 Architecture Planning Interiors  
 Old Church Court, Claydon Road, The Oval, London SW9 1JZ  
 T 020 7556 1500  
 www.rolfejudd.co.uk

Client  
 UKI Richmond Ltd

Project  
 NHS Site  
 Richmond Royal Hospital Site

Drawing  
 Extent of External Walls/Floors  
 Removed in the Conservation Area  
 Existing Second Floor Plan

Scale: 1:100 (A0) Date: Nov 18  
 Job Number: 5831 Drawing Number: T18P02  
 © 08/11/17, Revised 18/11/2018