

Copyright: Judd 14
 1 The Contractor must check and confirm all dimensions
 2 All discrepancies must be reported and resolved by the Architect before works commence
 3 This drawing is not to be scaled
 4 All work and materials to be in accordance with current applicable Statutory Legislation and to comply with all relevant Codes of Practice and British Standards
 5 This drawing is based on a measured survey by MSA

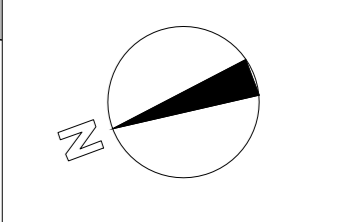

Legend
 Red hatch indicates
 Extent of external walls / floors to be removed
 Grey hatch indicates
 existing structure

KEY LEGEND:
 1. Existing window cill lowered to form new door opening or bigger window
 2. New window/door opening
 3. Wall/Floor to be removed
 4. Existing door opening reduced to form new window opening
 5. Existing steel stair to be removed
 6. Existing window to be replaced with matching timber windows
 7. Alteration to existing roof structure to accommodate new dormers/rooflights
 8. Existing rooflight/skylight to be removed
 9. Existing roof removed as part of refurbishment works
 10. Existing railing to be replaced to comply with Part K of Building Regs.
 11. Existing floor level to be lowered

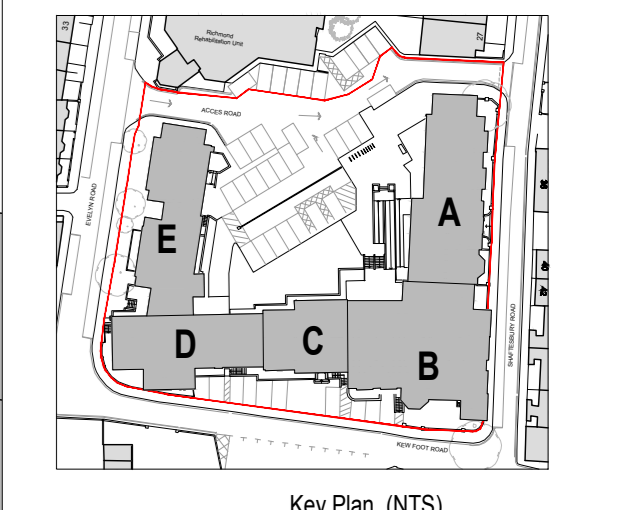
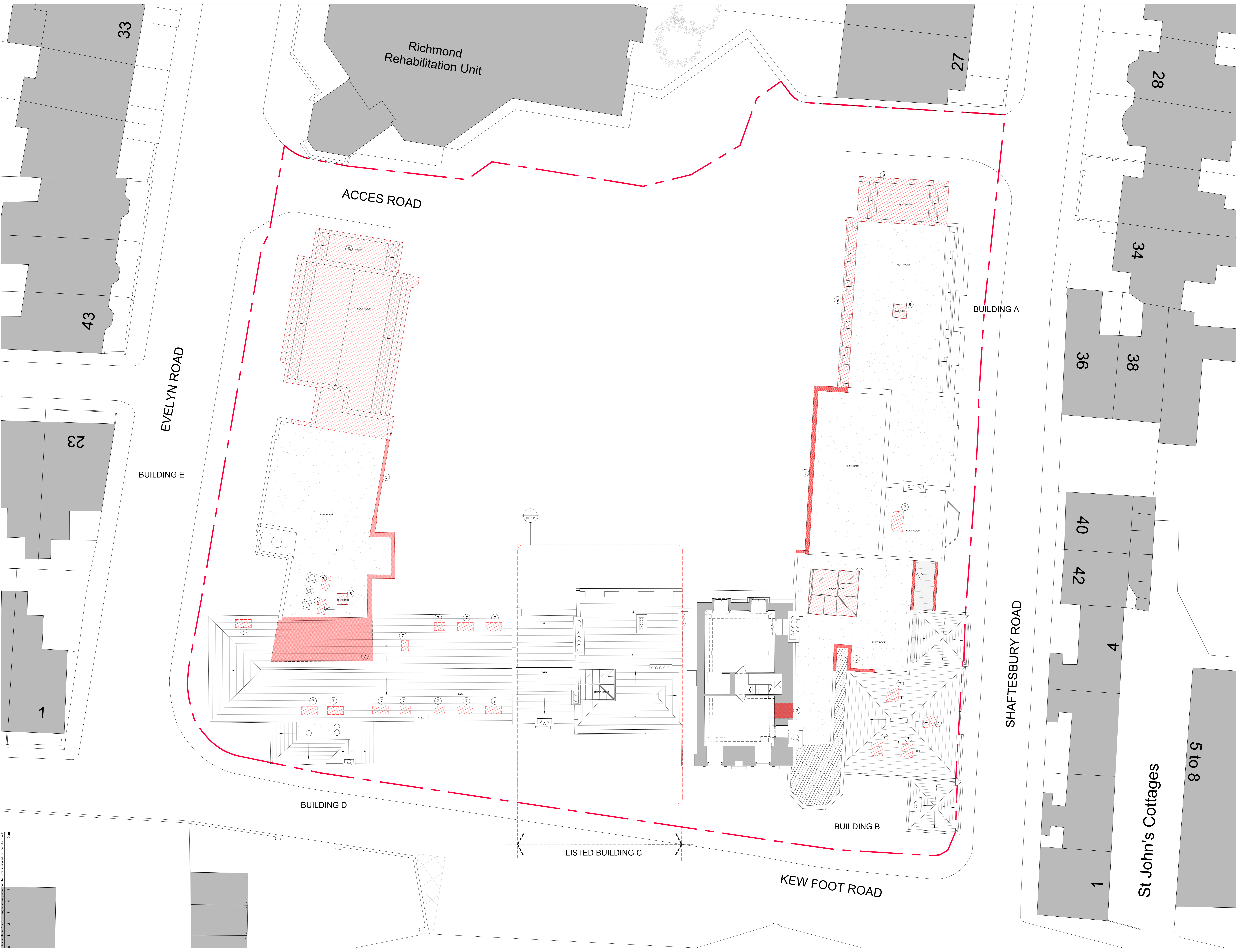

1A Issued for Planning Submission 29/11/18
 Rev Date

Rolfe Judd
 Architecture Planning Interiors
 Old Church Court, Claydon Road, The Oval, London SW9 1JZ
 T 020 7556 1500
 www.rolfe-judd.co.uk

Client
 UKI Richmond Ltd

Project
 NHS Site
 Richmond Royal Hospital Site

Drawing
 Extent of External Walls/Floors
 Removed in the Conservation Area
 Existing Third Floor Plan

Scale: 1:100 (A0) Date: 29/11/18
 Job Number: 5831 Drawing Number: T18P03
 Revision: 1A

© 08/11/17, Revised 17/11/18