

NOTES

- 1 The Contractor must check and confirm all dimensions
- 2 All discrepancies must be reported and resolved by the Architect before works commence
- 3 This drawing is not to be scaled
- 4 All work and materials to be in accordance with current applicable Statutory Legislation and to comply with all relevant Codes of Practice and British Standards
- 5 This drawing is based on a measured survey by MSA

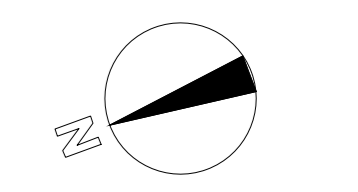
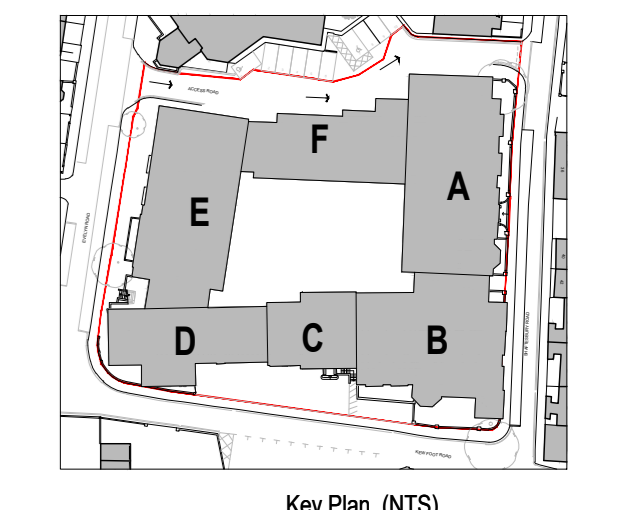

Note:
All noted dimensions, levels, areas & head heights indicative and subject to design development

Legend

- Studio 1 Person
- 1 Bed 2 Person
- 2 Bed 3/4 Person
- 3 Bed 5 Person
- 4 Bed 6 Person



1A Issued for Planning Submission 29/11/18
Rev Date

Rolfe Judd
Architecture Planning Interiors
Old Church Court, Claylands Road, The Oval, London SW16 1JZ
T 020 7556 1500
www.rolfe-judd.co.uk

Client
UKI Richmond Ltd

Project
NHS Site
Richmond Royal Hospital Site

Drawing
Proposed
First Floor Plan

Scale: 1:100 (A0) Date: Nov 18 Status: Planning
Job Number: 5831 Drawing Number: T20P01 Revision: 1A

THIS DRAWING IS THE PROPERTY OF ROLFE JUDD ARCHITECTURE PLANNING INTERIORS. IT IS TO BE USED ONLY FOR THE PROJECT AND SITE SPECIFICALLY IDENTIFIED IN THE DRAWING TITLE. IT IS NOT TO BE REPRODUCED OR TRANSMITTED IN ANY FORM OR BY ANY MEANS, ELECTRONIC OR MECHANICAL, WITHOUT THE WRITTEN PERMISSION OF ROLFE JUDD ARCHITECTURE PLANNING INTERIORS.