

P01 FIRST FLOOR STAIR PLAN – UNIT UG11
 SCALE: 1:25 (A1)

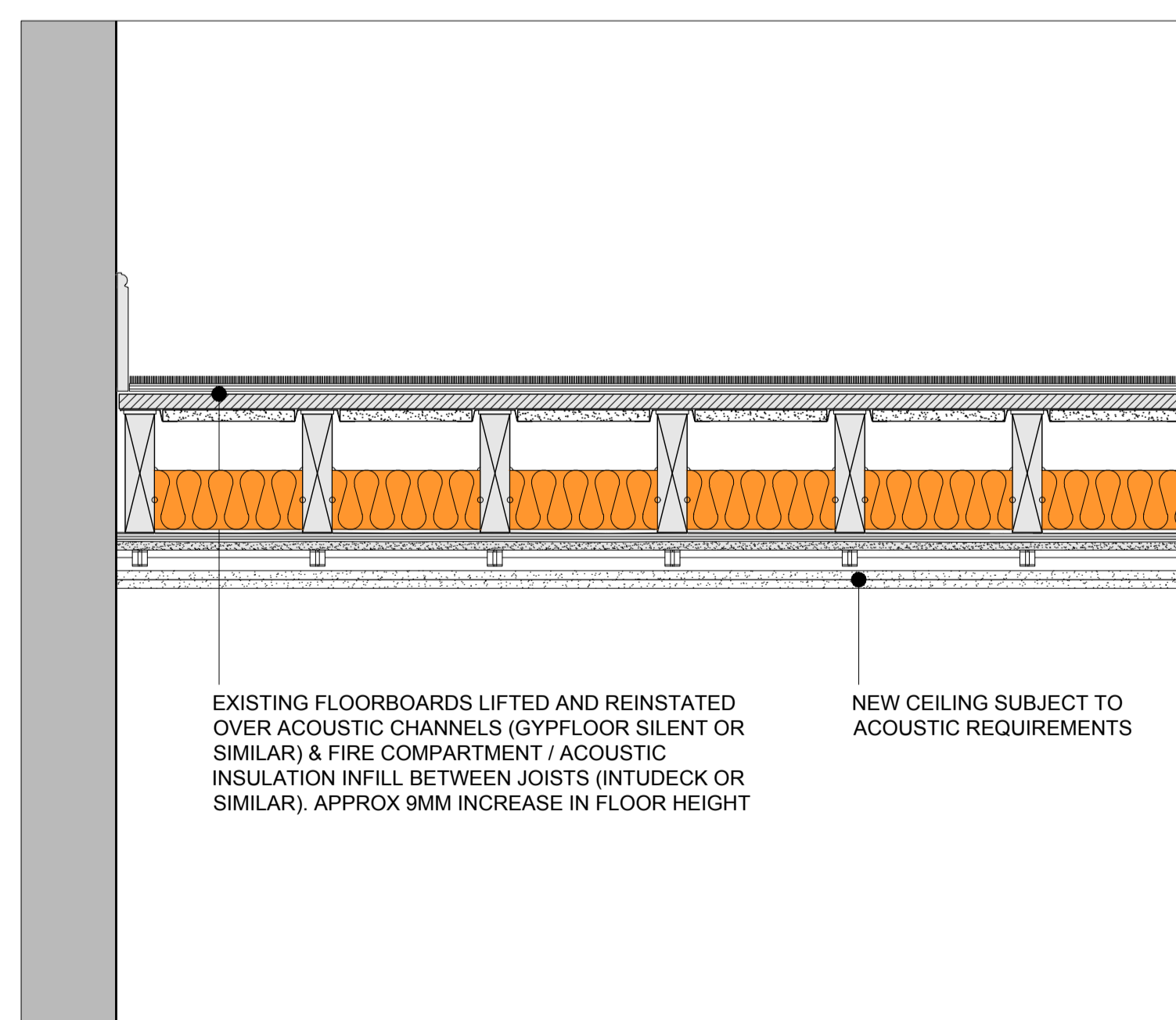

D01 GROUND FLOOR DETAIL
 SCALE: 1:10 (A1)

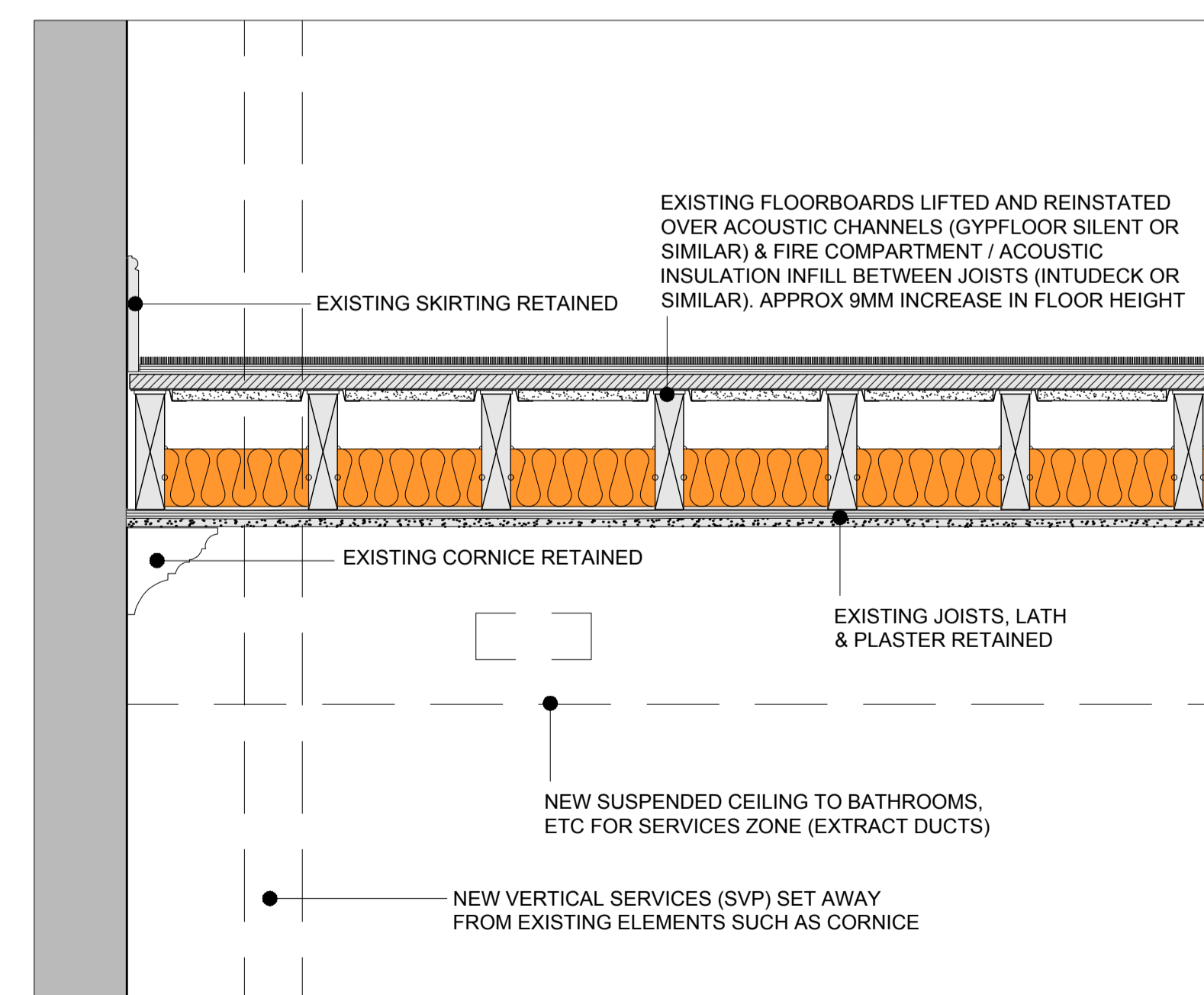

D02 FIRST & SECOND FLOOR DETAIL
 SCALE: 1:10 (A1)

This scale is 10cm in length when printed at the size indicated in the title block

S01 SECTION THROUGH PROPOSED STAIR – UNIT UG11
 SCALE: 1:25 (A1)

1A Issued for Planning Submission 29/11/18
 Rev Date

Rolfe Judd
 Architecture Planning Interiors
 Old Church Court, Claylands Road, The Oval, London SW8 1NZ
 T 020 7556 1500
 www.rolfe-judd.co.uk

Client
 UKI Richmond Limited

Project
 NHS Site
 Richmond Royal Hospital Site

Drawing
 Listed Building Proposed UG11 Stair & Floor Upgrades

| Scale | Date | Status |
|------------|----------------|----------|
| 1:25 (A1) | Nov 18 | Planning |
| Job Number | Drawing Number | Revision |
| 5831 | T24D02 | 1A |

G:\6831\T_Series\T24\T24D02