

- NOTES**
- 1 The Contractor must check and confirm all dimensions—
 - 2 All discrepancies must be reported and resolved by the Architect before works commence
 - 3 This drawing is not to be scaled
 - 4 All work and materials to be in accordance with current applicable Statutory Legislation and to comply with all relevant Codes of Practice and British Standards
 - 5 This drawing is based on a measured survey by MSA

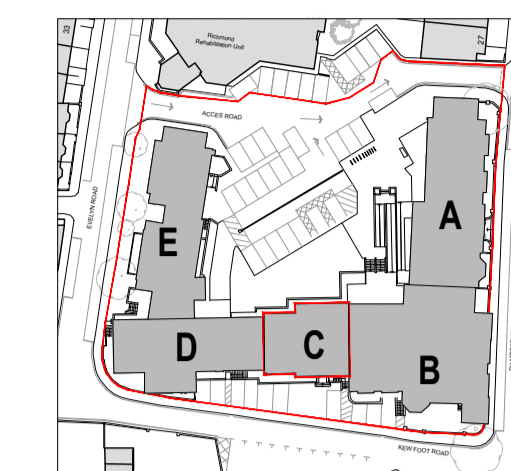

Key Plan (NTS)

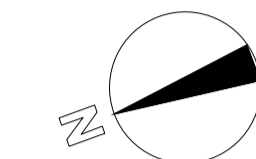

- Legend**
- Red hatch indicates Listed Building - Fabric removal
 - Grey hatch indicates existing structure

- Key Notes**
- 1 Existing window cill lowered to form new door opening or bigger window
 - 2 Existing door opening increased to suit new layout
 - 3 Existing floor level to be lowered
 - 4 Existing wall to be removed
 - 5 Existing internal door to be removed
 - 6 Existing railing to be removed
 - 7 New opening to existing floor to accommodate new staircase
 - 8 Existing rooflight to be replaced for matching rooflight
 - 9 A/C unit and associated pipe work to be removed
 - 10 Letters to front of building to be removed
 - 11 Existing railing to be replaced to comply with Part K of Building Regulations
 - 12 Existing floor level to be lowered

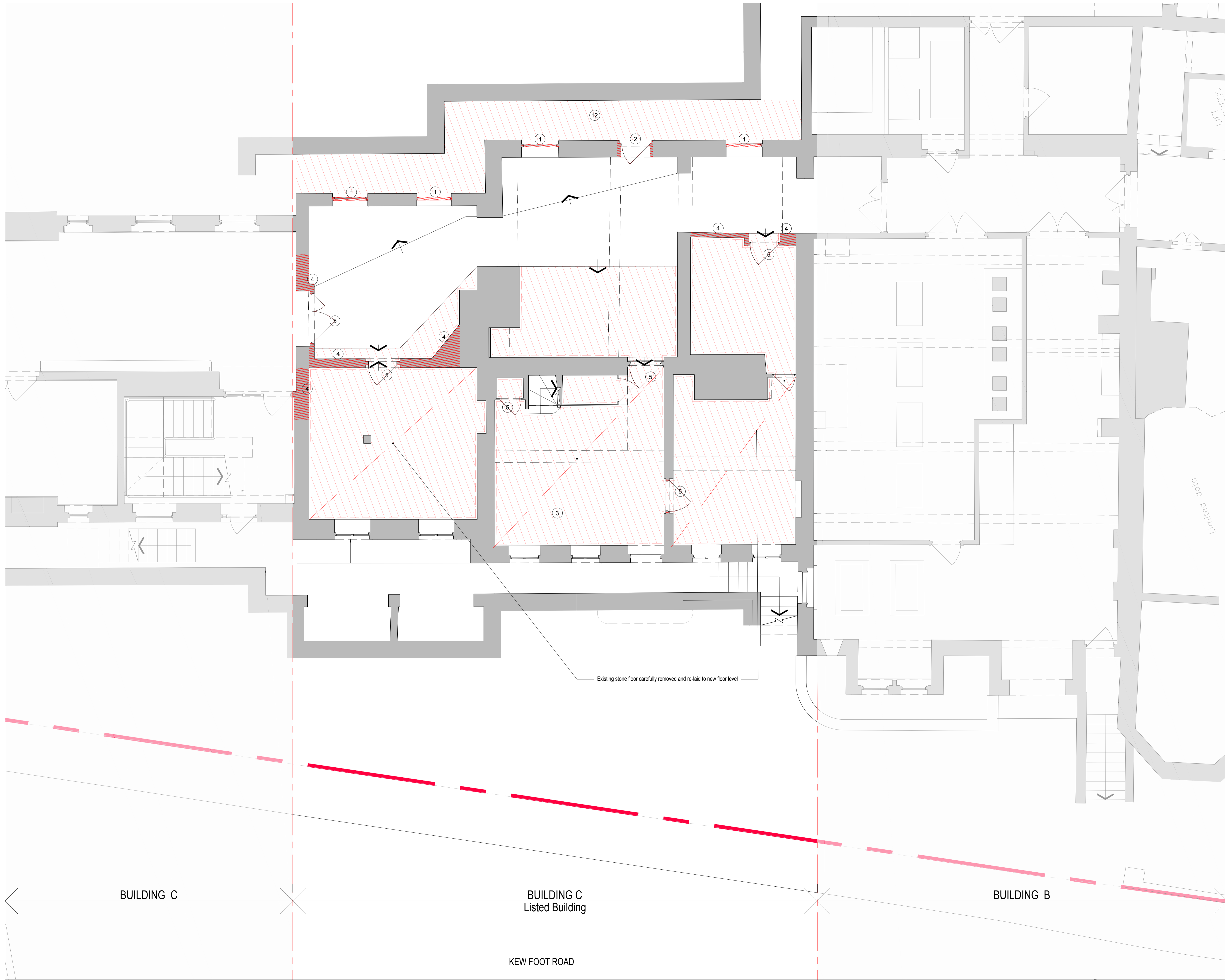

1A Issued for Planning Submission 29/11/18
 Rev _____ Date _____

Rolfe Judd
 Architecture Planning Interiors
 Old Church Court, Claylands Road, The Oval, London SW8 1NZ
 T 020 7556 1500
 www.rolfe-judd.co.uk

Client
 UKI Richmond Limited

Project
 NHS Site
 Richmond Royal Hospital Site

Drawing
 Works of Alteration to the
 Fabric of the Listed Building
 Existing Lower Ground Floor Plan

Scale Date Status
 1:50 (A1) Nov 18 Planning

Job Number Drawing Number Revision
 5831 TLB18P-1 1A

G:\5831\T_Series\T18\TLB18P-1

This scale is 10cm in length when printed at the size indicated in the title block



BUILDING C

BUILDING C
Listed Building

BUILDING B

KEW FOOT ROAD