

SCALE: 1 to 200  
 Note: This may be a reduced sized print, check scales below

**LEGEND**

- SITE APPLICATION BOUNDARY
- OTHER SITE OWNERSHIP
- EXISTING BUILDINGS TO BE DEMOLISHED
- PROPOSED BUILDING OUTLINE ABOVE GROUND LEVEL
- TREES TO BE REMOVED
- TREES TO BE RETAINED
- E ELECTRIC VEHICLE CHARGING POINTS
- PE PASSIVE ELECTRIC VEHICLE CHARGING POINTS

NOTE: XYZ LAND SURVEYS TOPOGRAPHIC SURVEY OVERLAID (GREY) - REFERENCE 2018/063\_02

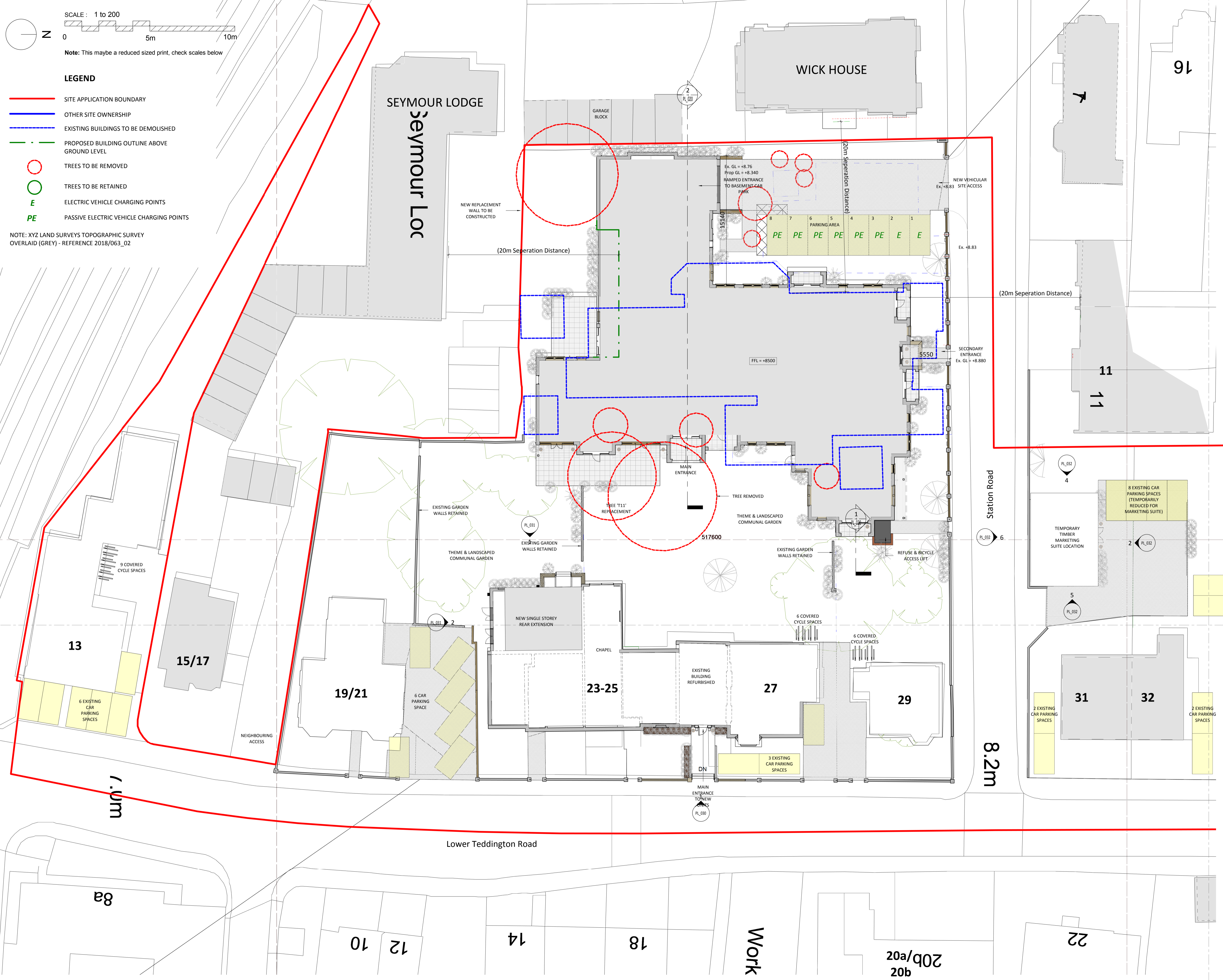

Figured dimensions only are to be used. All dimensions to be checked onsite. Differences between drawings and between drawings and specification or bills of quantities to be reported to the PRC Group.

The copyright of the drawings and designs contained therein remains vested in the PRC Group.

Revisions:	Drawn / Chkd:	Date:
P1 Preliminary Issue 01	-	29/11/18
P2 Preliminary Issue 02	-	29/11/18
P3 Preliminary Issue 03	-	29/11/18
P4 Updated further to pre-application meeting	MAS	29/11/18
P5 Updated to Traffic Consultants e-mail (10/12/18)	MAS	12/12/18
P6 Updated to Council comments. Basement lift added as agreed with client.	MAS	21/12/18
P7 Parking Provision Updated	MAS	08/01/19
P8 Information Issue	MAS	09/01/19

Client:  
 The Sons of Divine Providence Developments Ltd



Project:  
 12-14 Station Road & 13, 19-33 Lower Teddington Road

24 Church St. West, Woking, Surrey, GU21 6HT  
 01483 494 350

info@prc-group.com  
 www.prc-group.com

Drawing Title:  
 Proposed Site Plan

Scale @ A1:	Checked by:	Date:
1:200	MAS	May 2018
Job No.:	Stage_Drawing No.:	Rev.:
10901	PL_100	P8

Issue Status:	Offices
Construction Information <input type="checkbox"/> Preliminary <input type="checkbox"/>	Woking
Information <input checked="" type="checkbox"/> Approval <input type="checkbox"/>	London
Tender <input type="checkbox"/>	Milton Keynes
	Warsaw