

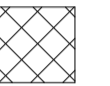

Note: Extent of repair works subject to full conditional survey.

Refer to schedule 4904_4_2600 for external opening sizes.

-  Existing Building Fabric
-  New dense blockwork
-  New brickwork

Fixed post fall restraint system by latches. (O.E.A) ManSafe® Constant Force® Fall Arrest System with Horizontal stainless steel cable and CF posts. Spec & fixing by manufacturer

Refer to drawing 2520 for roof access & maintenance details.

Existing extension walls to be retained. New roof and stone coping.

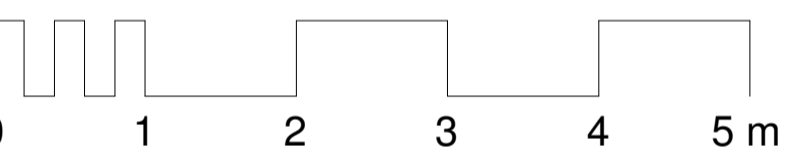
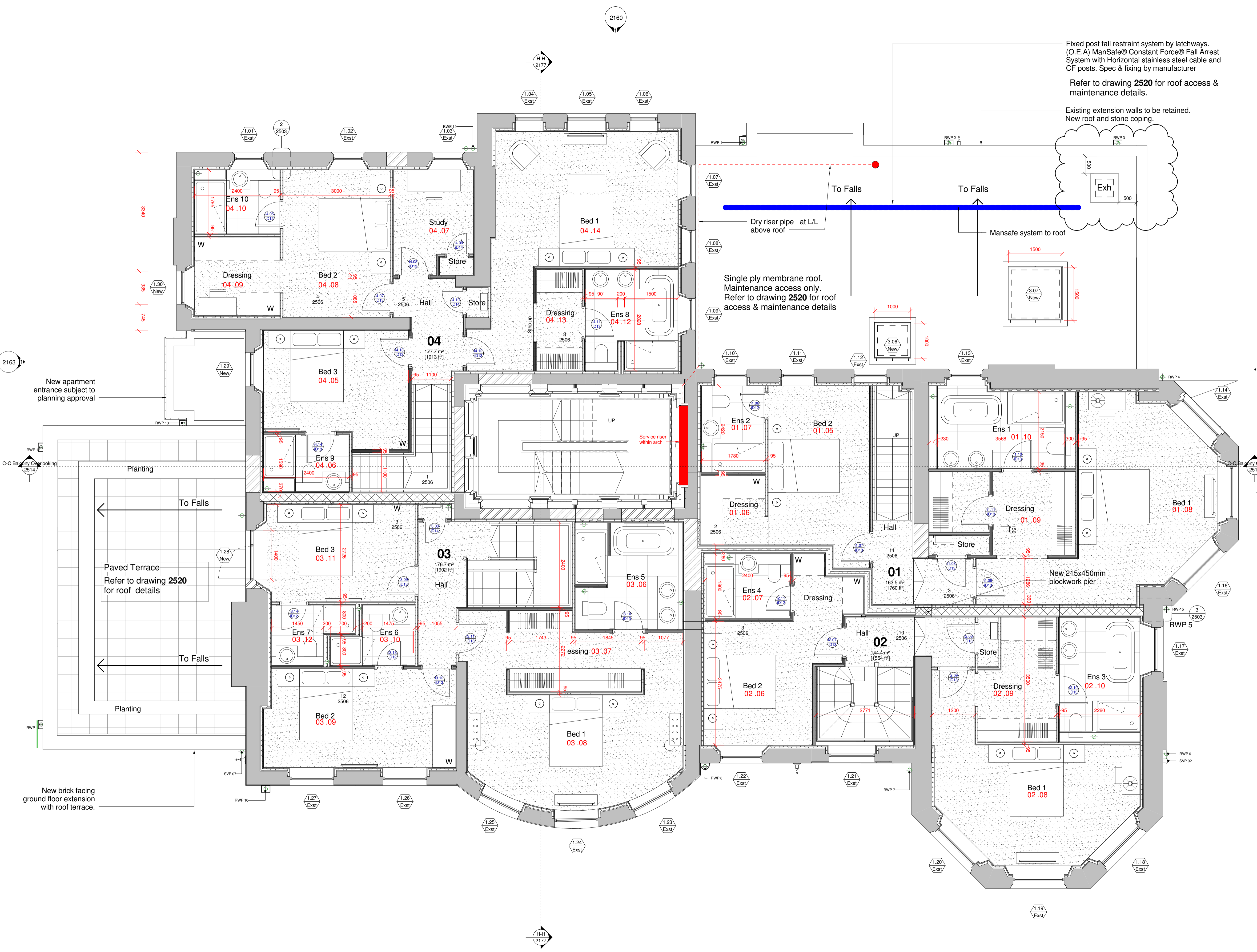
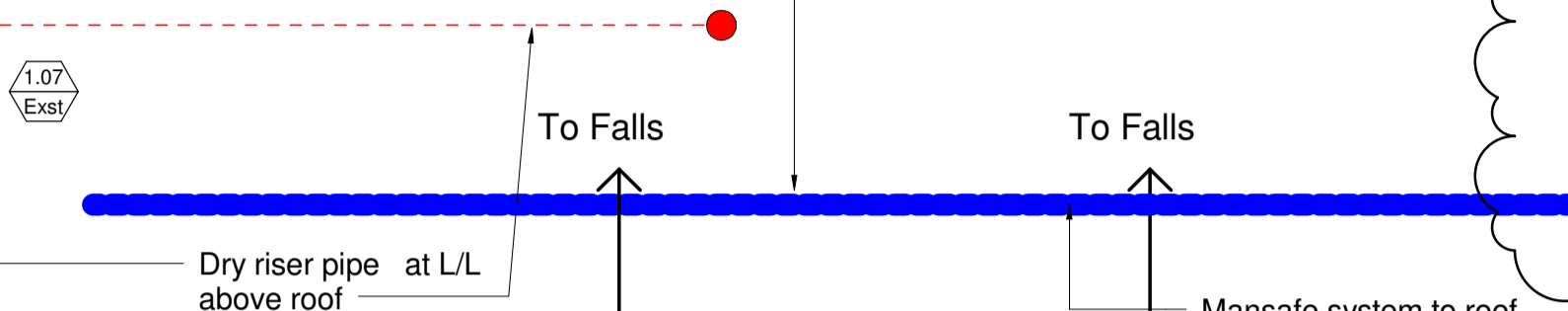

FOR CONSTRUCTION

Rev	Description	Issued	Dwn	Chk
D	Internal Junction IDs. Exhaust to front roof.	12.11.18	PN	PN
C	Door IDs changed to match door schedule	02.11.18	PN	PN
B	Internal changes Unit 1.2 & 3	23.10.18	PN	PN
A	Construction	24.09.18	PN	PN

Client
Berkeley Homes

Project
Latchmere House Refurb
Latchmere Lane
Kingston KT2 5NX

Drawing
GA Plan
First Floor

Scale
1 : 50@A1

Date
Oct '17

Drawn
AO

Checked
TL

Brookes Architects

Upstairs at The Grange
Bank Lane, London SW15 5JT

T 020 8487 1223
F 020 8876 4172
E info@brookesarchitects.co.uk
www.brookesarchitects.co.uk