

Existing 09:00am

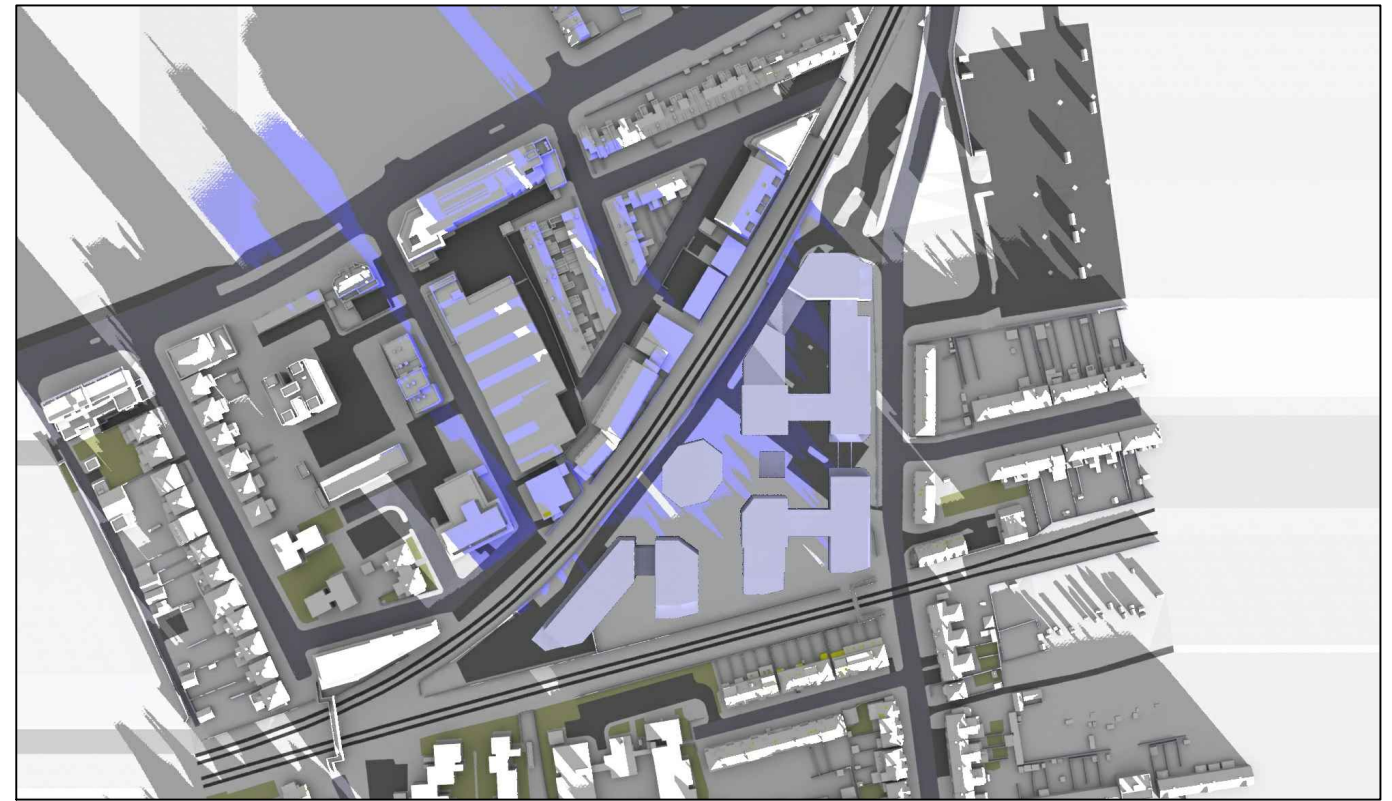

Proposed 09:00am

December 21st (GMT)

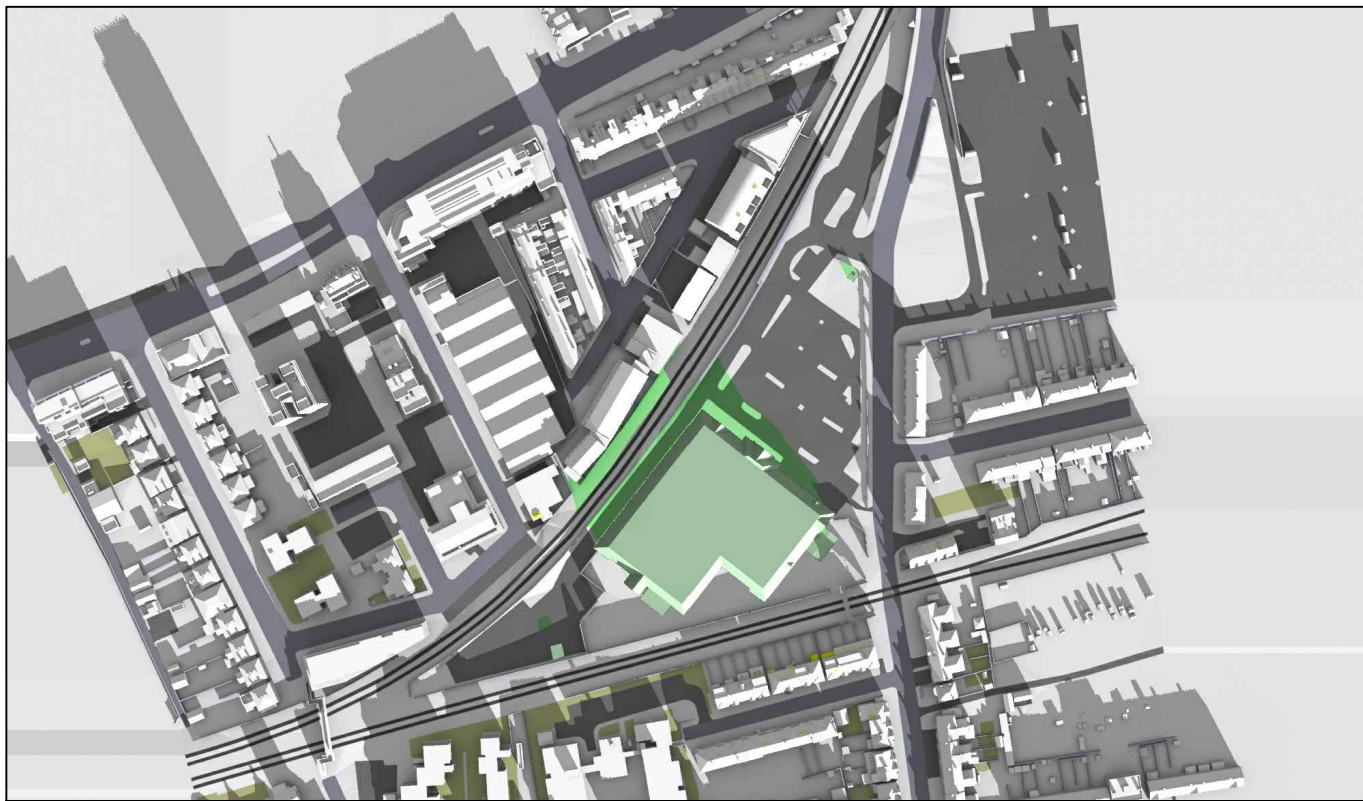

Existing 10:00am

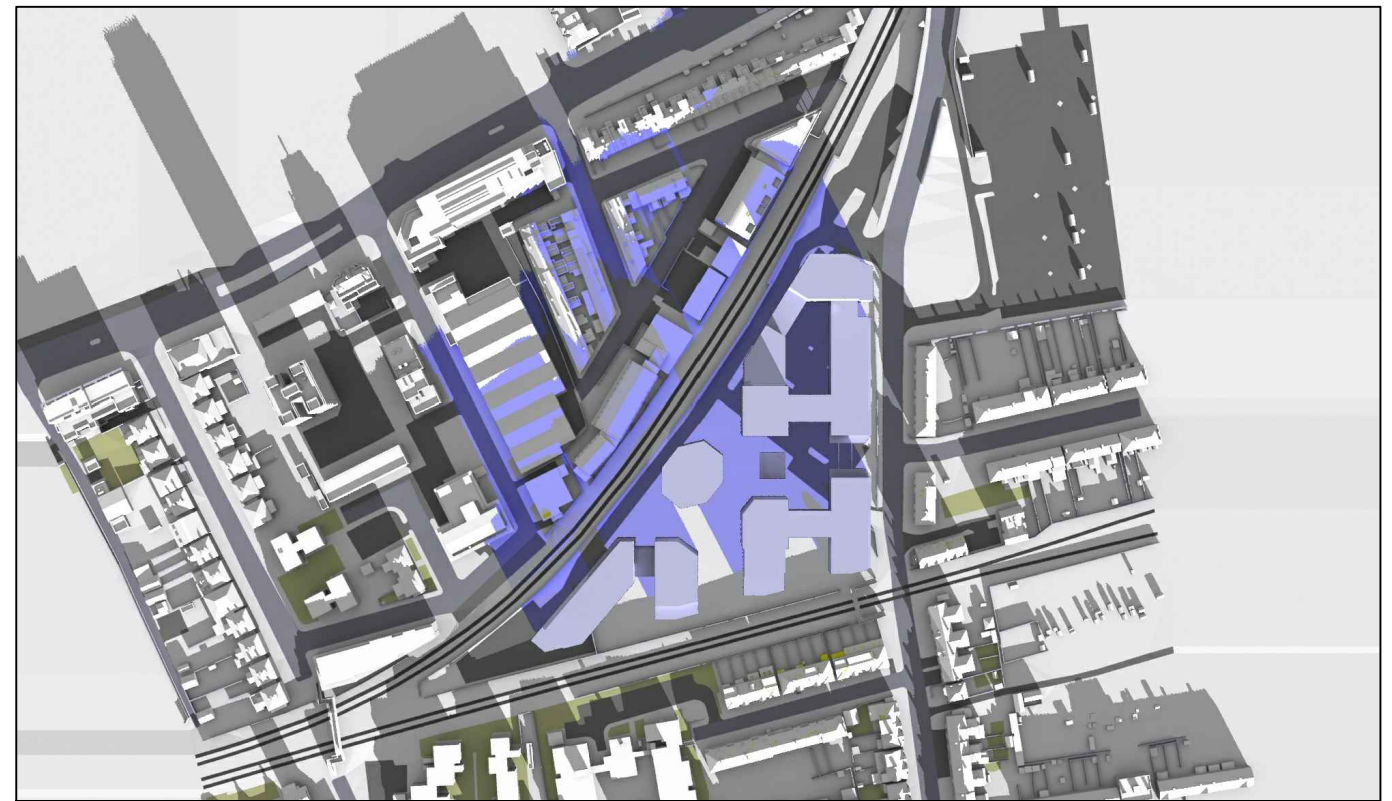

Proposed 10:00am

Sources: Point 2 Surveyors
 Survey Info
 Point Cloud Data
 Assael Architecture Limited
 Proposed Info (received 10/01/19)
 A3004_Combined Model_Simple.skp

Key:

- Grey shadows are those caused by buildings which are not on the site under development.
- Green shadows are those caused specifically by the consented buildings on the site.
- Blue shadows are those caused specifically by the proposed development.

Project: Homebase
 Richmond

Title: Transient Overshadowing

Point 2 Surveyors Ltd,
 3rd Floor,
 17 Slingsby Place,
 London WC2E 9AB,
 0207 836 5828
 www.point2surveyors.com

Drawn By: SDJ

Scale: NTS

Date: Jan 19

Dwg No: **P1685/DEC01/01**

Rel: 06

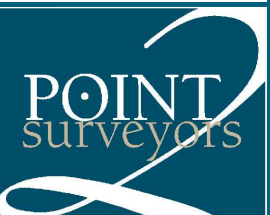

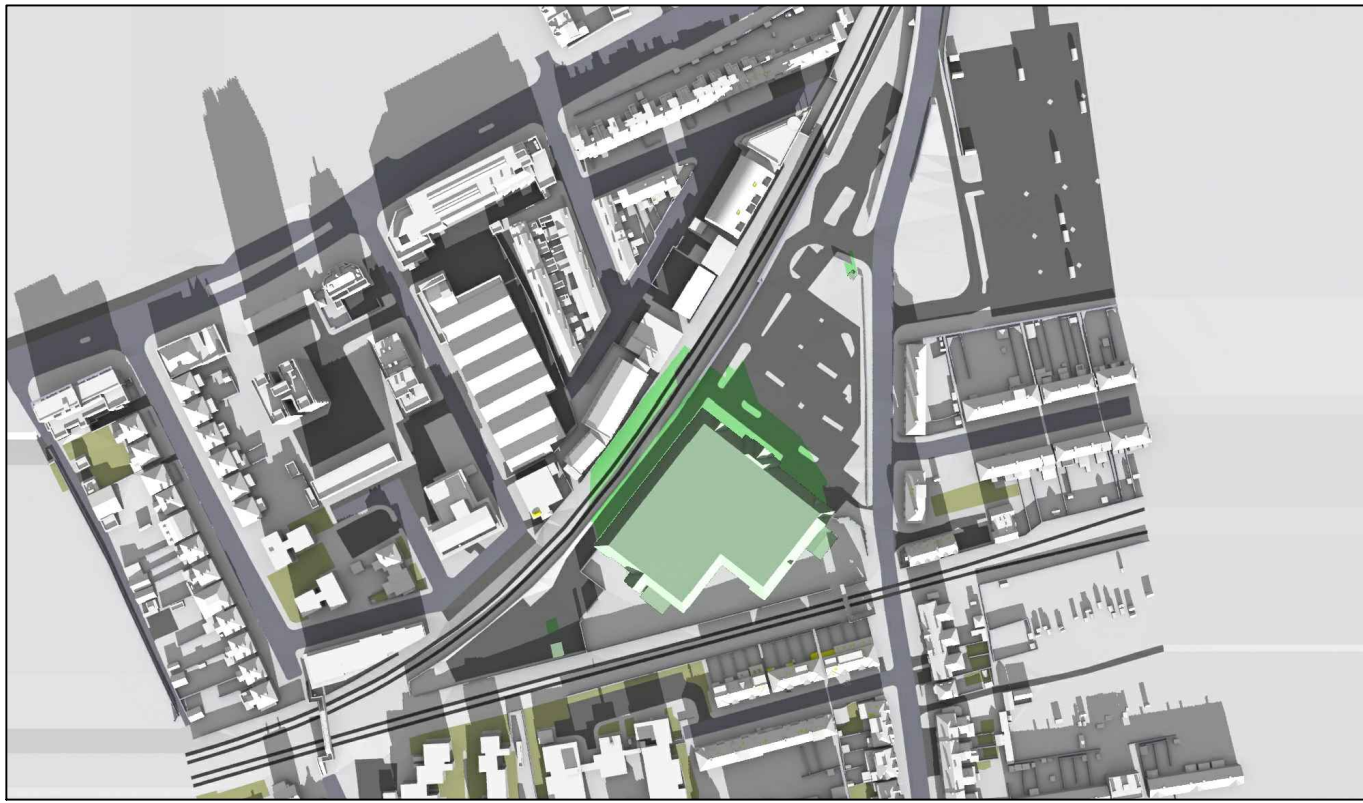

Existing 11:00am

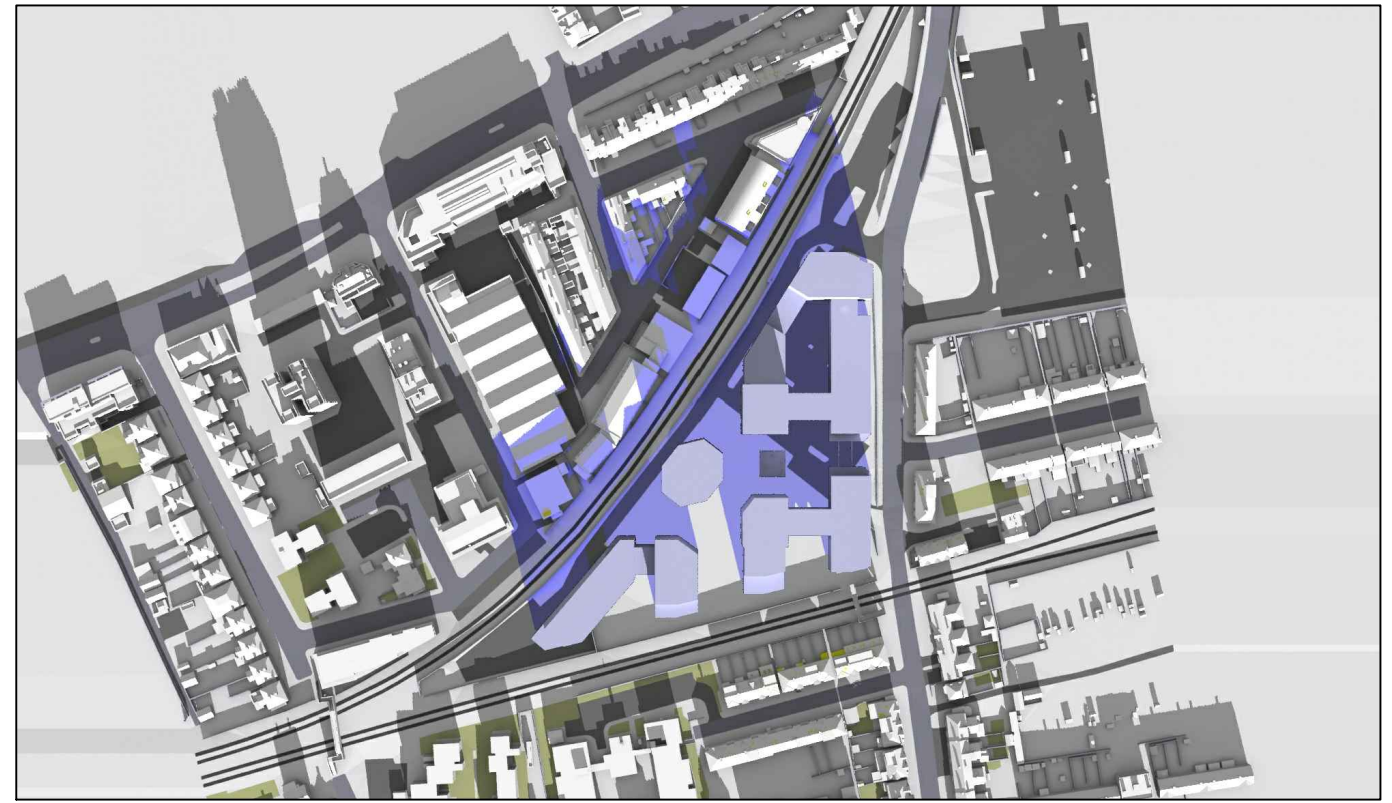

Proposed 11:00am

December 21st (GMT)

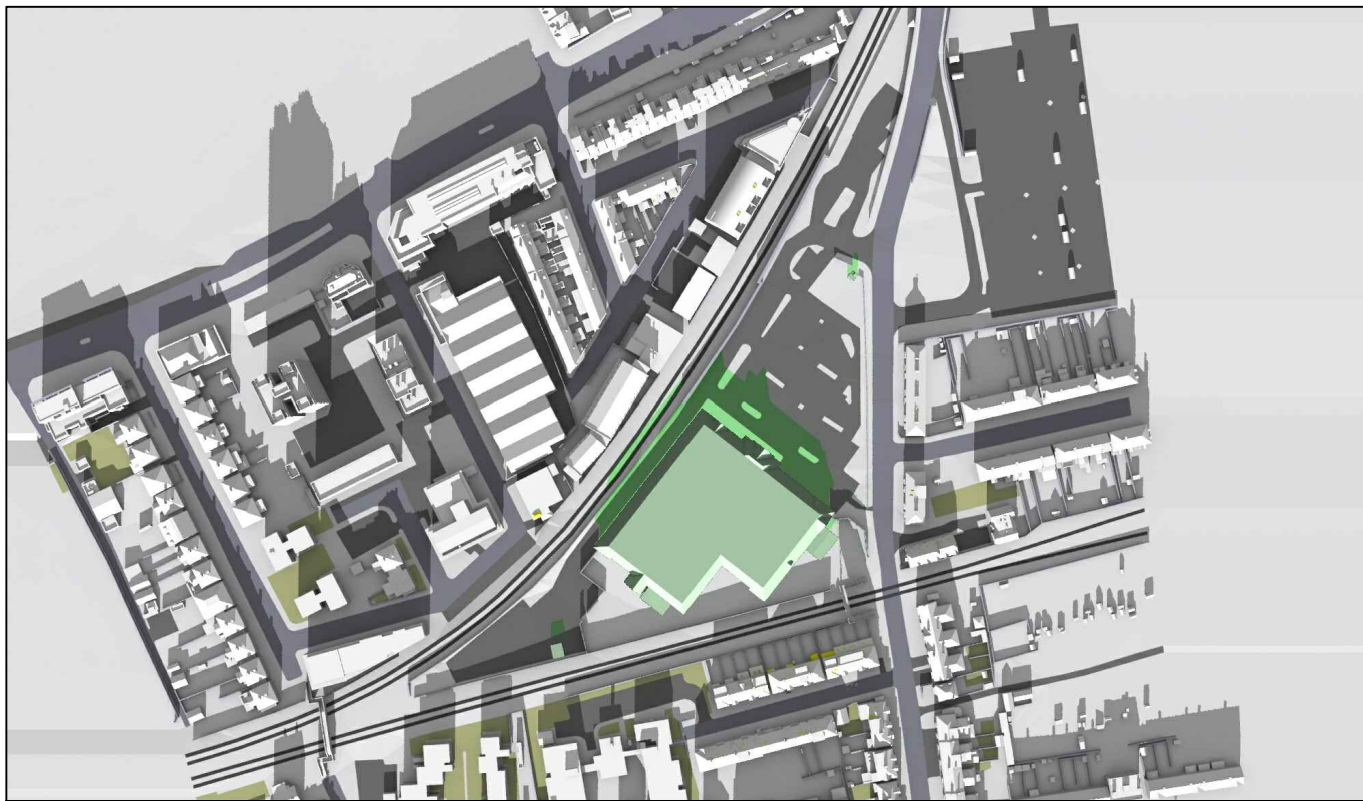

Existing 12:00pm

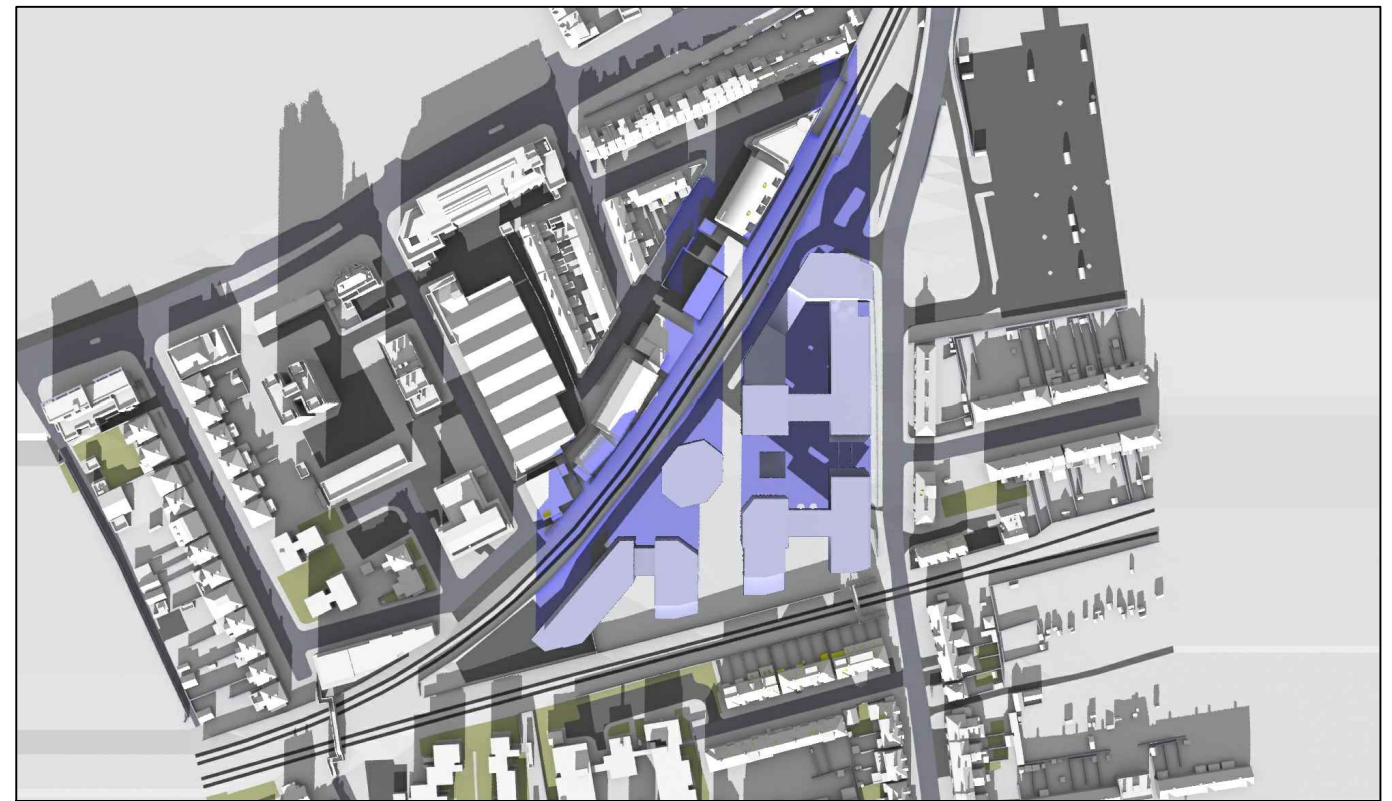

Proposed 12:00pm

Sources: Point 2 Surveyors
 Survey Info
 Point Cloud Data
 Assael Architecture Limited
 Proposed Info (received 10/01/19)
 A3004_Combined Model_Simple.skp

Key:

- Grey shadows are those caused by buildings which are not on the site under development.
- Green shadows are those caused specifically by the consented buildings on the site.
- Blue shadows are those caused specifically by the proposed development.

Project: Homebase
 Richmond

Title: Transient Overshadowing

Point 2 Surveyors Ltd,
 3rd Floor,
 17 Slingsby Place,
 London WC2E 9AB,
 0207 836 5828
 www.point2surveyors.com

Drawn By: SDJ

Scale: NTS

Date: Jan 19

Dwg No: **P1685/DEC01/02**

Rel: 06

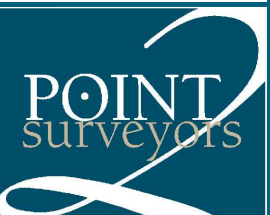



Existing 01:00pm

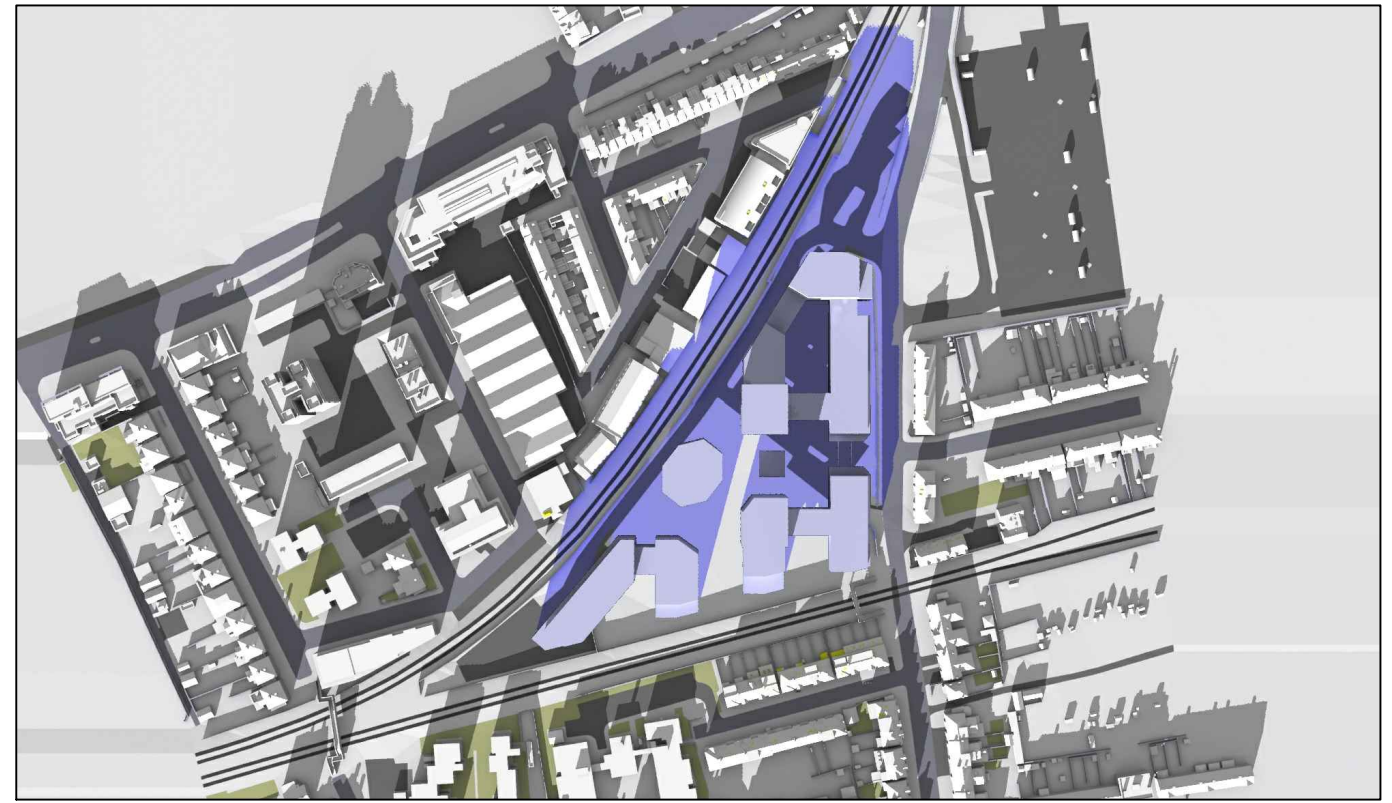

Proposed 01:00pm

December 21st (GMT)

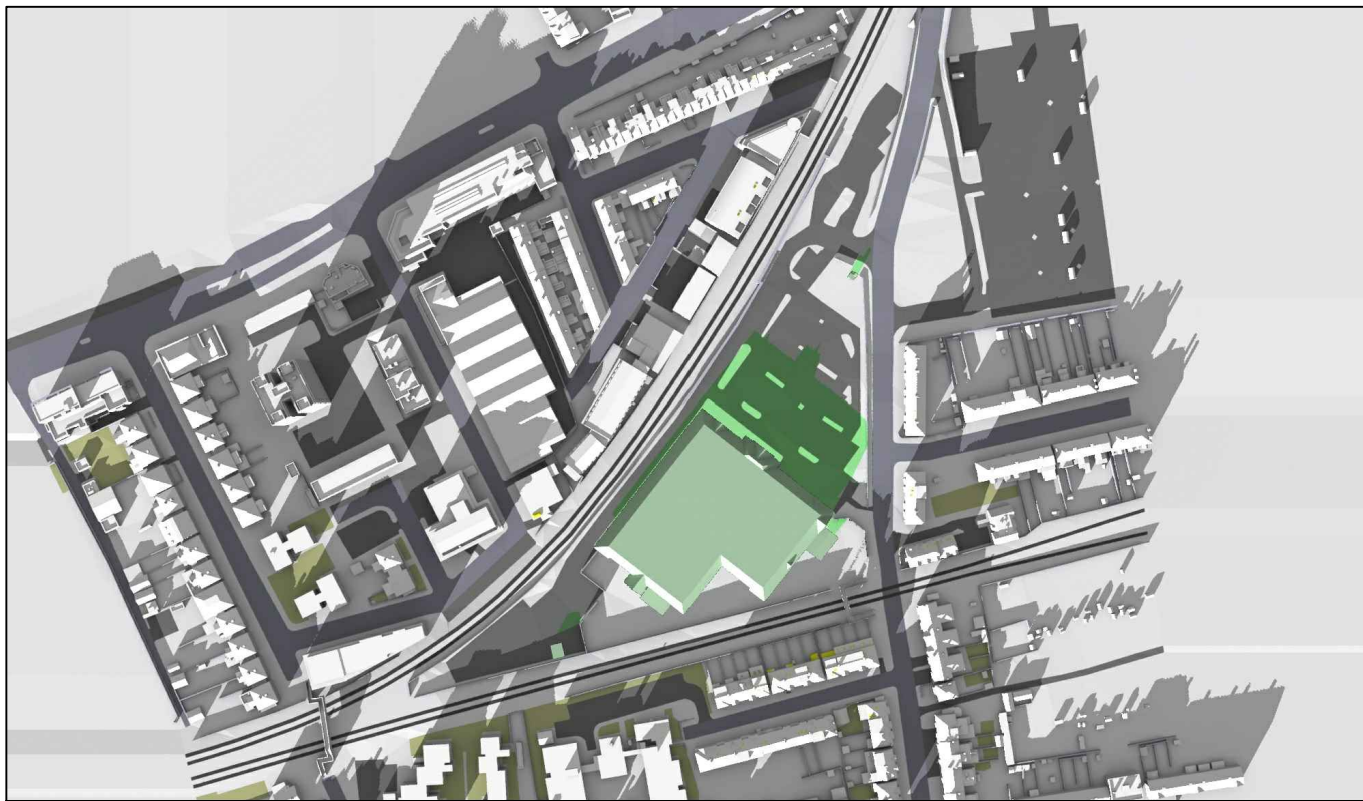

Existing 02:00pm

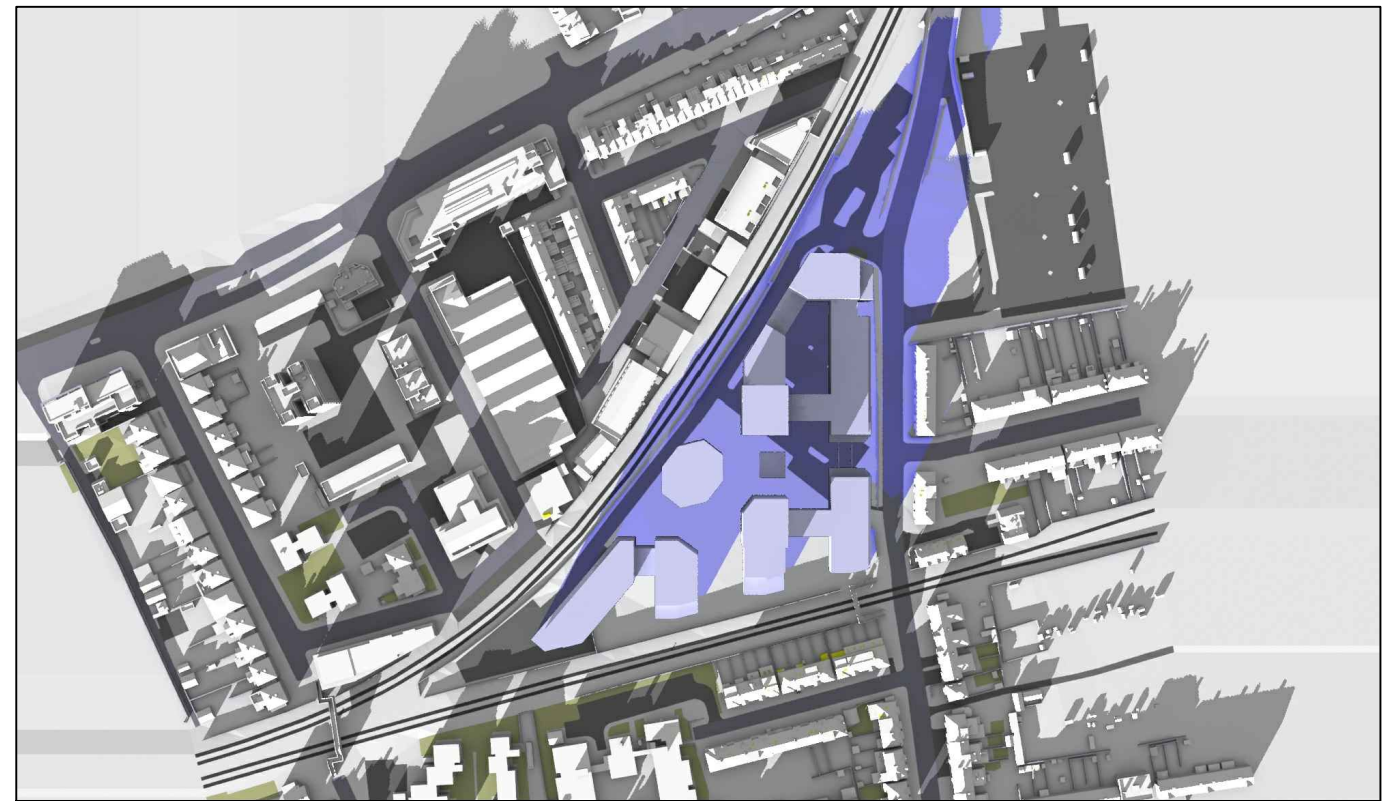

Proposed 02:00pm

Sources: Point 2 Surveyors
Survey Info
Point Cloud Data
Assael Architecture Limited
Proposed Info (received 10/01/19)
A3004_Combined Model_Simple.skp

Key:

- Grey shadows are those caused by buidings which are not on the site under development.
- Green shadows are those caused specifically by the consented buildings on the site.
- Blue shadows are those caused specifically by the proposed development.

Project: Homebase
Richmond

Title: Transient Overshadowing

Point 2 Surveyors Ltd,
3rd Floor,
17 Slingsby Place,
London WC2E 9AB,
0207 836 5828
www.point2surveyors.com

Drawn By: SDJ

Scale: NTS

Date: Jan 19

Dwg No: **P1685/DEC01/03**

Rel: 06



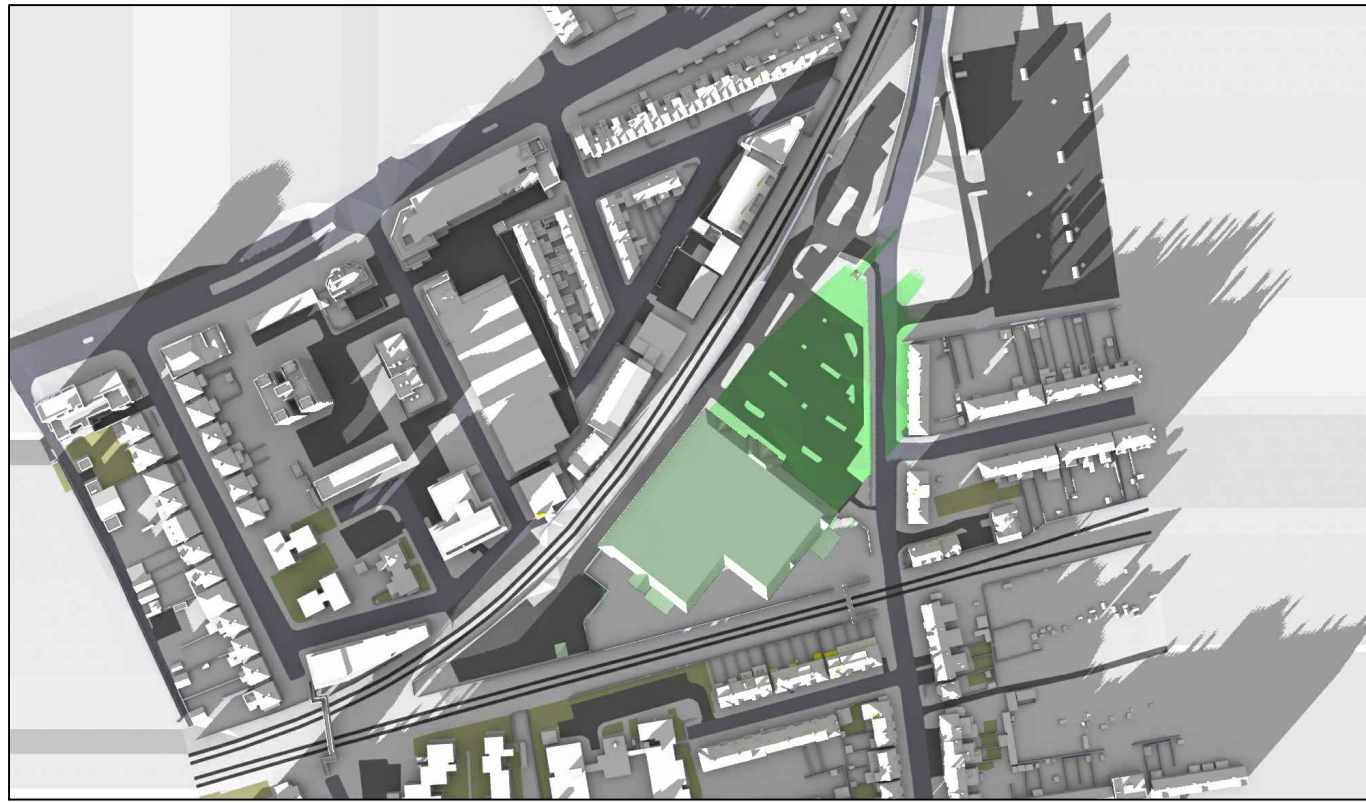

Existing 03:00pm

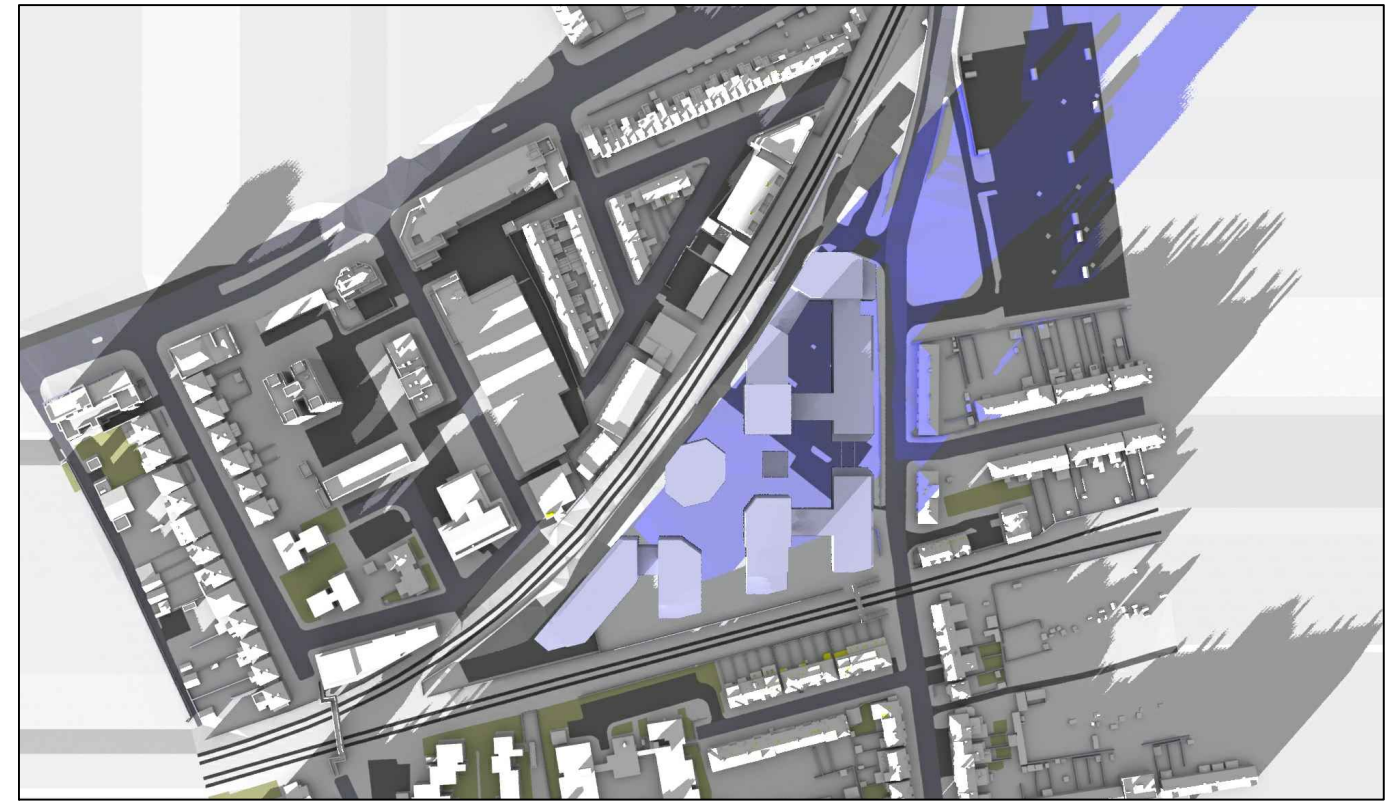

Proposed 03:00pm

December 21st (GMT)

Sources: Point 2 Surveyors
 Survey Info
 Point Cloud Data
 Assael Architecture Limited
 Proposed Info (received 10/01/19)
 A3004_Combined Model_Simple.skp

Key:

- Grey shadows are those caused by buidings which are not on the site under development.
- Green shadows are those caused specifically by the consented buildings on the site.
- Blue shadows are those caused specifically by the proposed development.

Project: Homebase
 Richmond

Title: Transient Overshadowing

Point 2 Surveyors Ltd,
 3rd Floor,
 17 Slingsby Place,
 London WC2E 9AB,
 0207 836 5828
 www.point2surveyors.com

Drawn By: SDJ

Scale: NTS

Date: Jan 19

Dwg No: **P1685/DEC01/04**

Rel: 06





Existing 07:00am

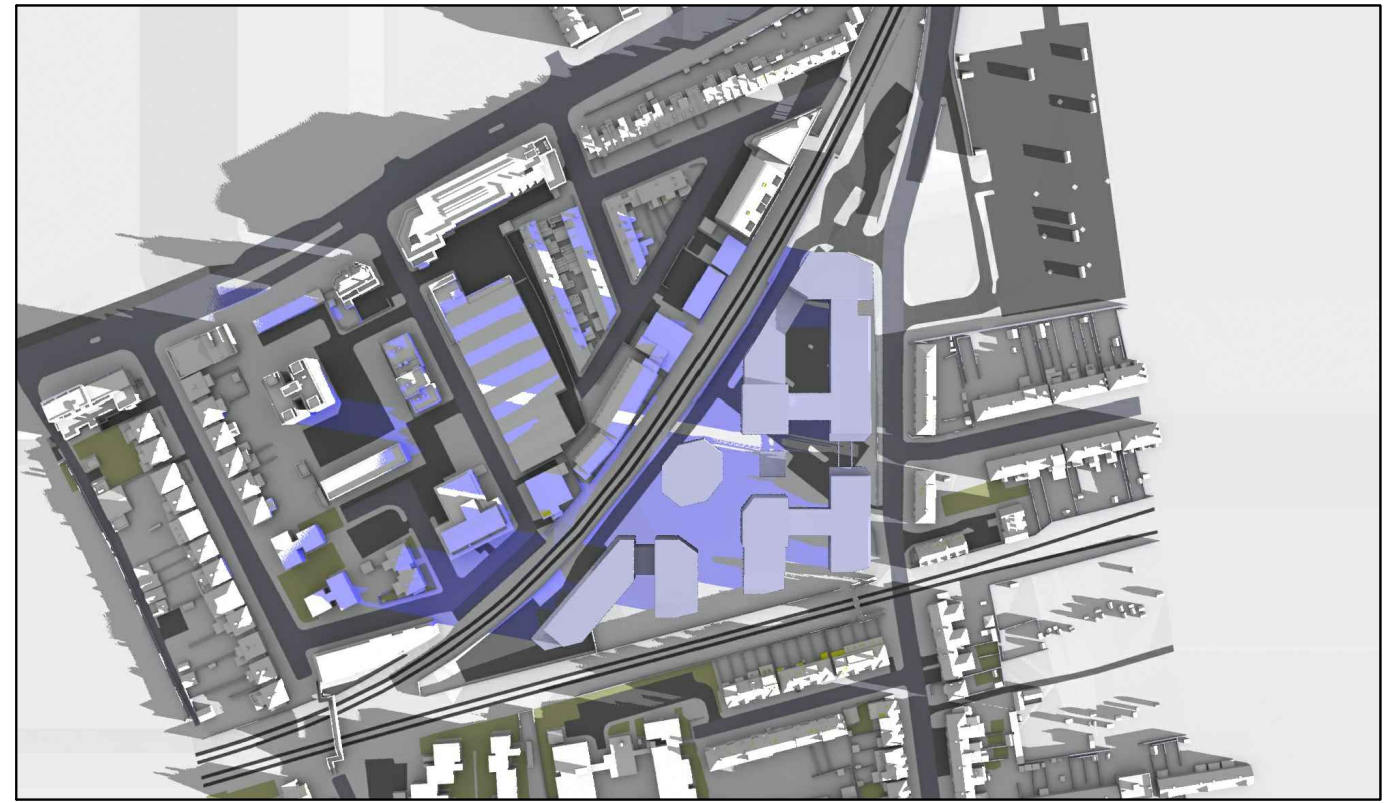

Proposed 07:00am

March 21st (GMT)

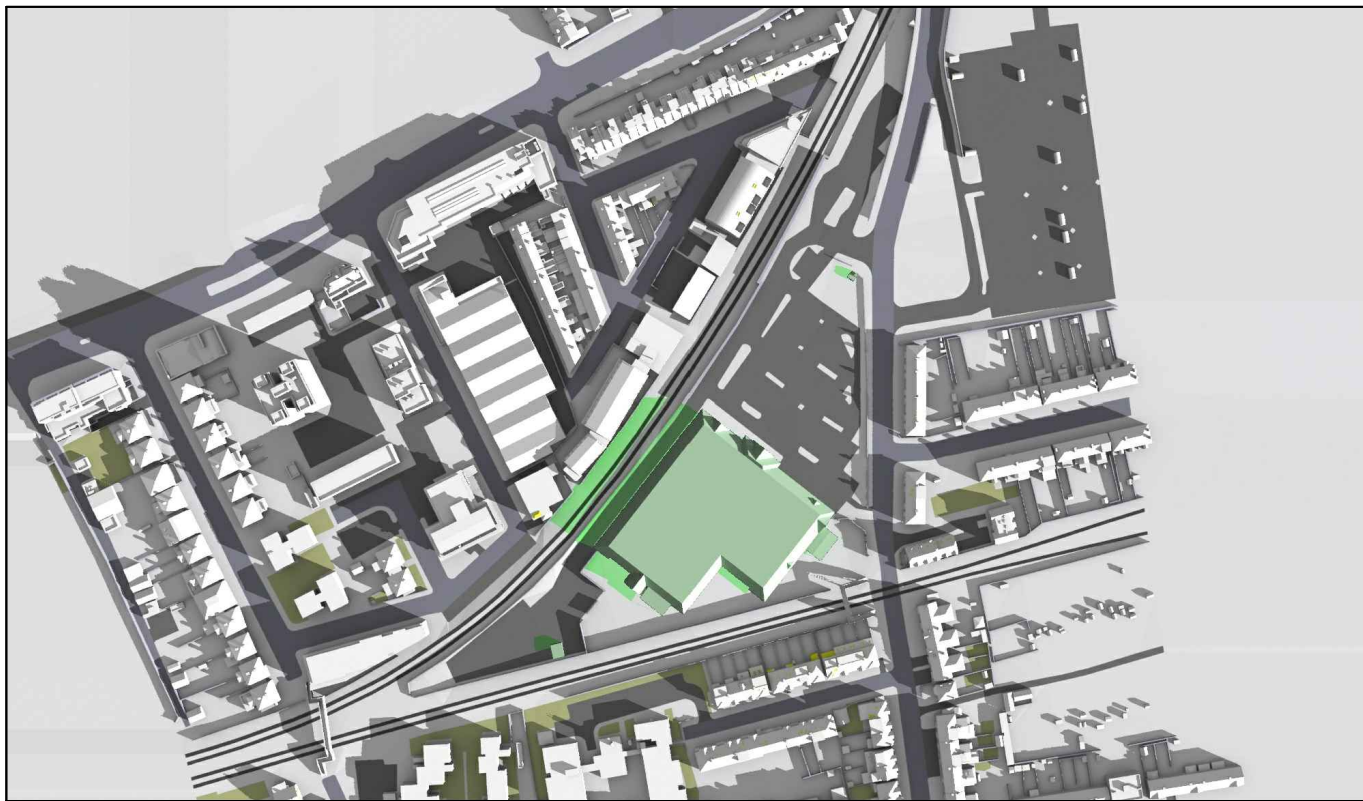

Existing 08:00am

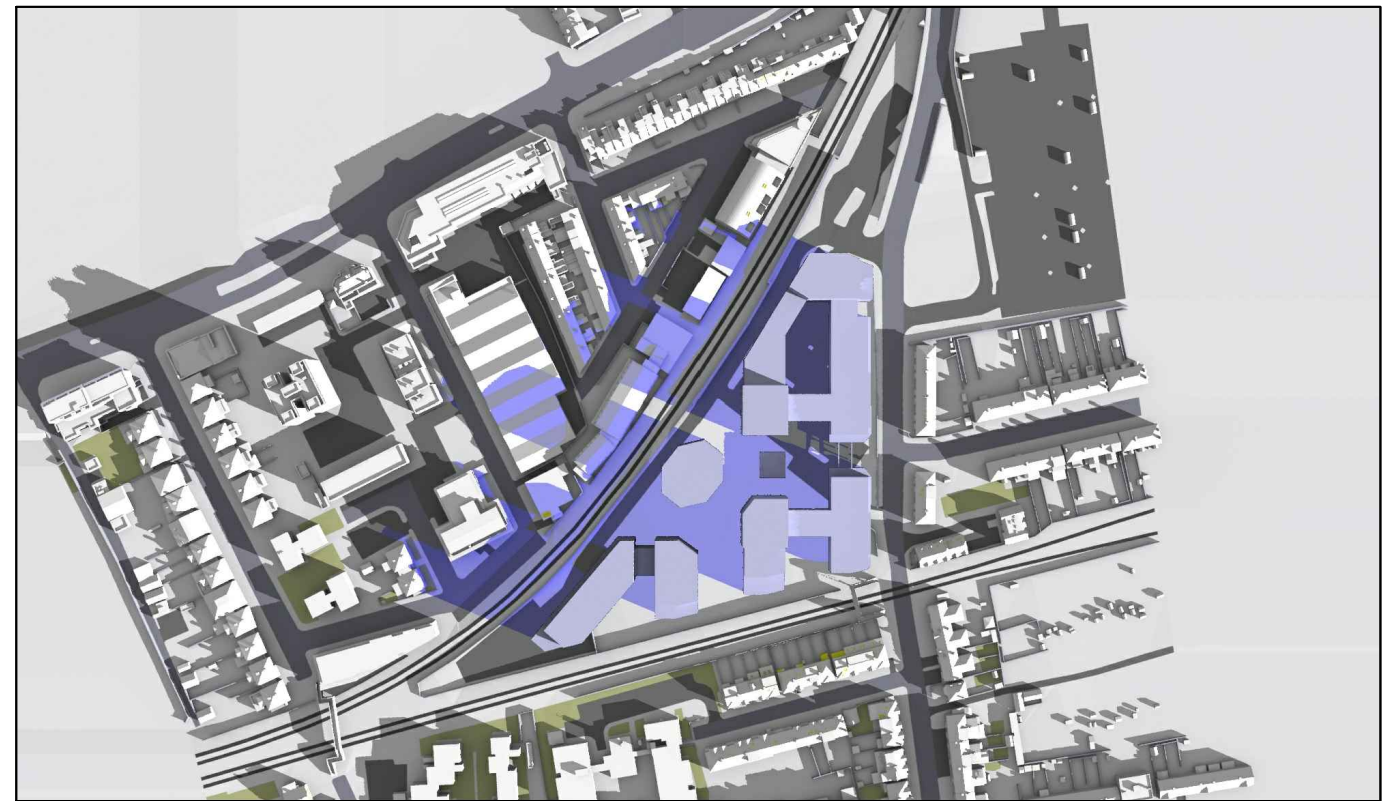

Proposed 08:00am

Sources: Point 2 Surveyors
 Survey Info
 Point Cloud Data
 Assael Architecture Limited
 Proposed Info (received 10/01/19)
 A3004_Combined Model_Simple.skp

Key:

- Grey shadows are those caused by buidings which are not on the site under development.
- Green shadows are those caused specifically by the consented buildings on the site.
- Blue shadows are those caused specifically by the proposed development.

Project: Homebase
 Richmond

Title: Transient Overshadowing

Point 2 Surveyors Ltd,
 3rd Floor,
 17 Slingsby Place,
 London WC2E 9AB,
 0207 836 5828
 www.point2surveyors.com

Drawn By: SDJ

Scale: NTS

Date: Jan 19

Dwg No: **P1685/MAR01/ 01**

Rel: 06

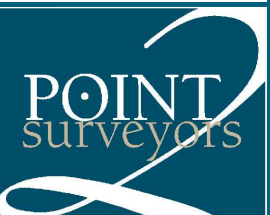



Existing 09:00am



Proposed 09:00am

March 21st (GMT)



Existing 10:00am



Proposed 10:00am

Sources: Point 2 Surveyors
Survey Info
Point Cloud Data
Assael Architecture Limited
Proposed Info (received 10/01/19)
A3004_Combined Model_Simple.skp

- Key:
- Grey shadows are those caused by buidings which are not on the site under development.
 - Green shadows are those caused specifically by the consented buildings on the site.
 - Blue shadows are those caused specifically by the proposed development.

Project: Homebase
Richmond

Title: Transient Overshadowing

Point 2 Surveyors Ltd,
3rd Floor,
17 Slingsby Place,
London WC2E 9AB,
0207 836 5828
www.point2surveyors.com

Drawn By: SDJ

Scale: NTS

Date: Jan 19

Dwg No: **P1685/MAR01/ 02**

Rel: 06





Existing 11:00am

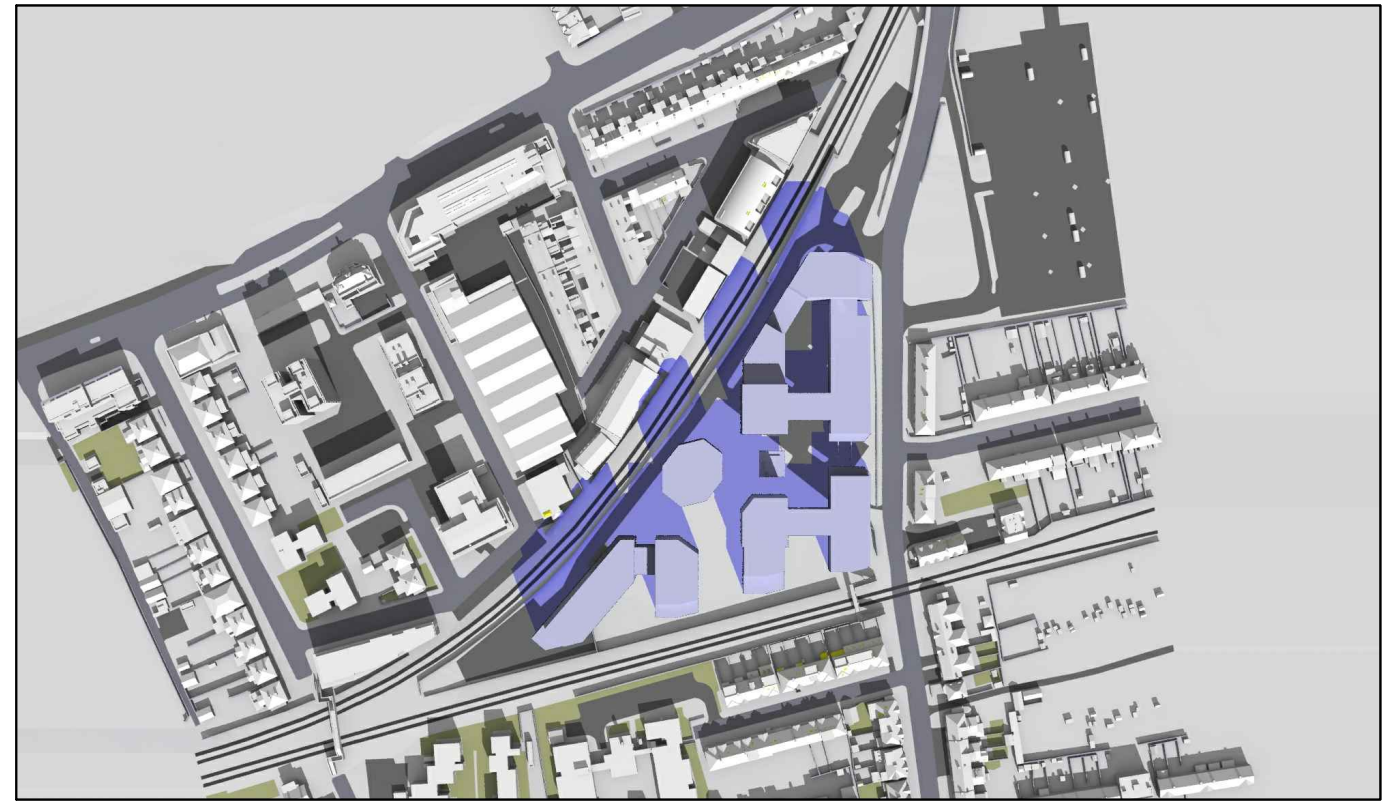

Proposed 11:00am

March 21st (GMT)



Existing 12:00pm



Proposed 12:00pm

Sources: Point 2 Surveyors
 Survey Info
 Point Cloud Data
 Assael Architecture Limited
 Proposed Info (received 10/01/19)
 A3004_Combined Model_Simple.skp

Key:

- Grey shadows are those caused by buidings which are not on the site under development.
- Green shadows are those caused specifically by the consented buildings on the site.
- Blue shadows are those caused specifically by the proposed development.

Project: Homebase
 Richmond

Title: Transient Overshadowing

Point 2 Surveyors Ltd,
 3rd Floor,
 17 Slingsby Place,
 London WC2E 9AB,
 0207 836 5828
 www.point2surveyors.com

Drawn By: SDJ

Scale: NTS

Date: Jan 19

Dwg No: **P1685/MAR01/ 03**

Rel: 06

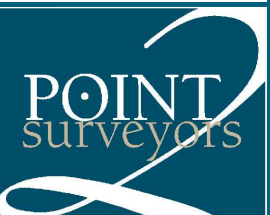



Existing 01:00pm



Proposed 01:00pm

March 21st (GMT)



Existing 02:00pm

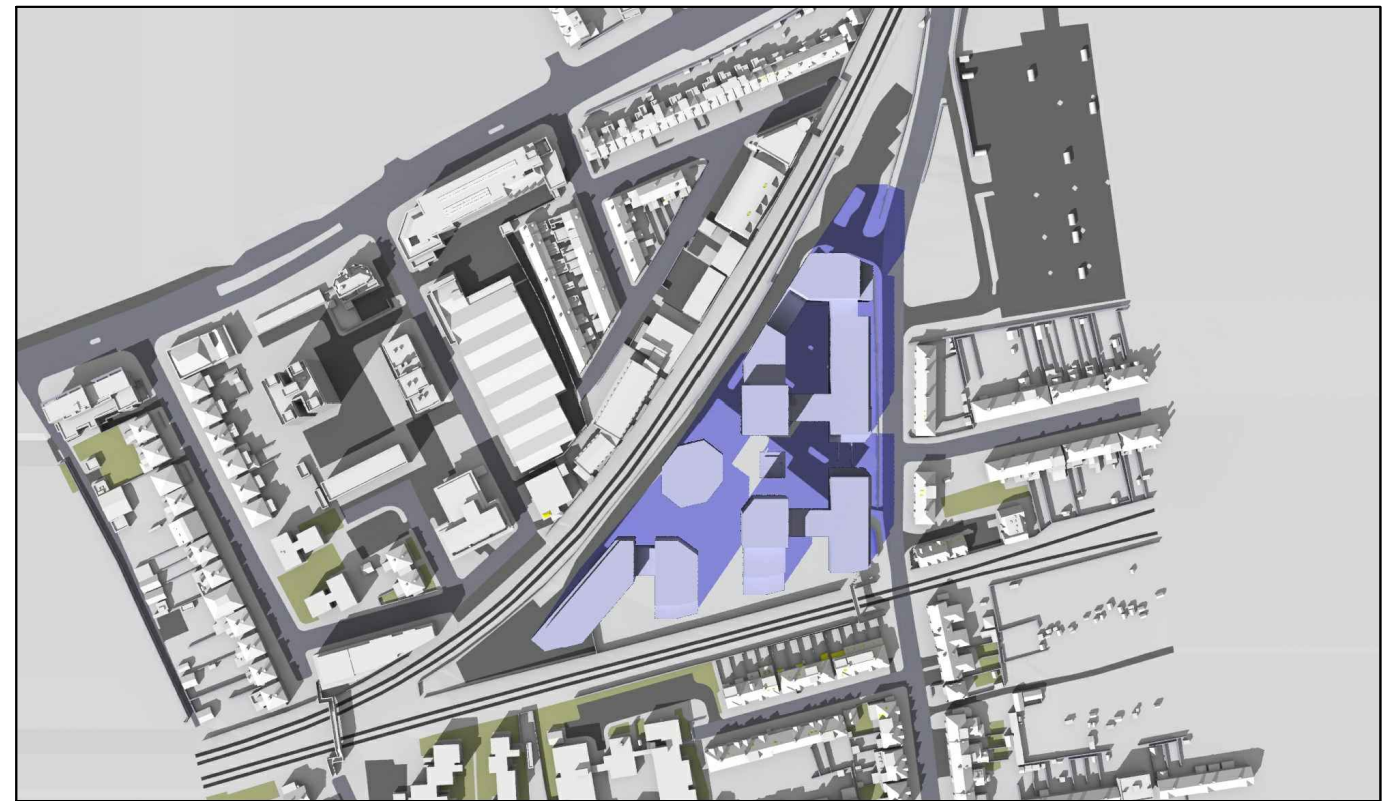

Proposed 02:00pm

Sources: Point 2 Surveyors
 Survey Info
 Point Cloud Data
 Assael Architecture Limited
 Proposed Info (received 10/01/19)
 A3004_Combined Model_Simple.skp

Key:

- Grey shadows are those caused by buildings which are not on the site under development.
- Green shadows are those caused specifically by the consented buildings on the site.
- Blue shadows are those caused specifically by the proposed development.

Project: Homebase
 Richmond

Title: Transient Overshadowing

Point 2 Surveyors Ltd,
 3rd Floor,
 17 Slingsby Place,
 London WC2E 9AB,
 0207 836 5828
 www.point2surveyors.com

Drawn By: SDJ

Scale: NTS

Date: Jan 19

Dwg No: **P1685/MAR01/ 04** Rel: 06

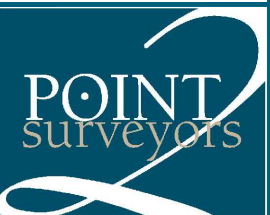



Existing 03:00pm

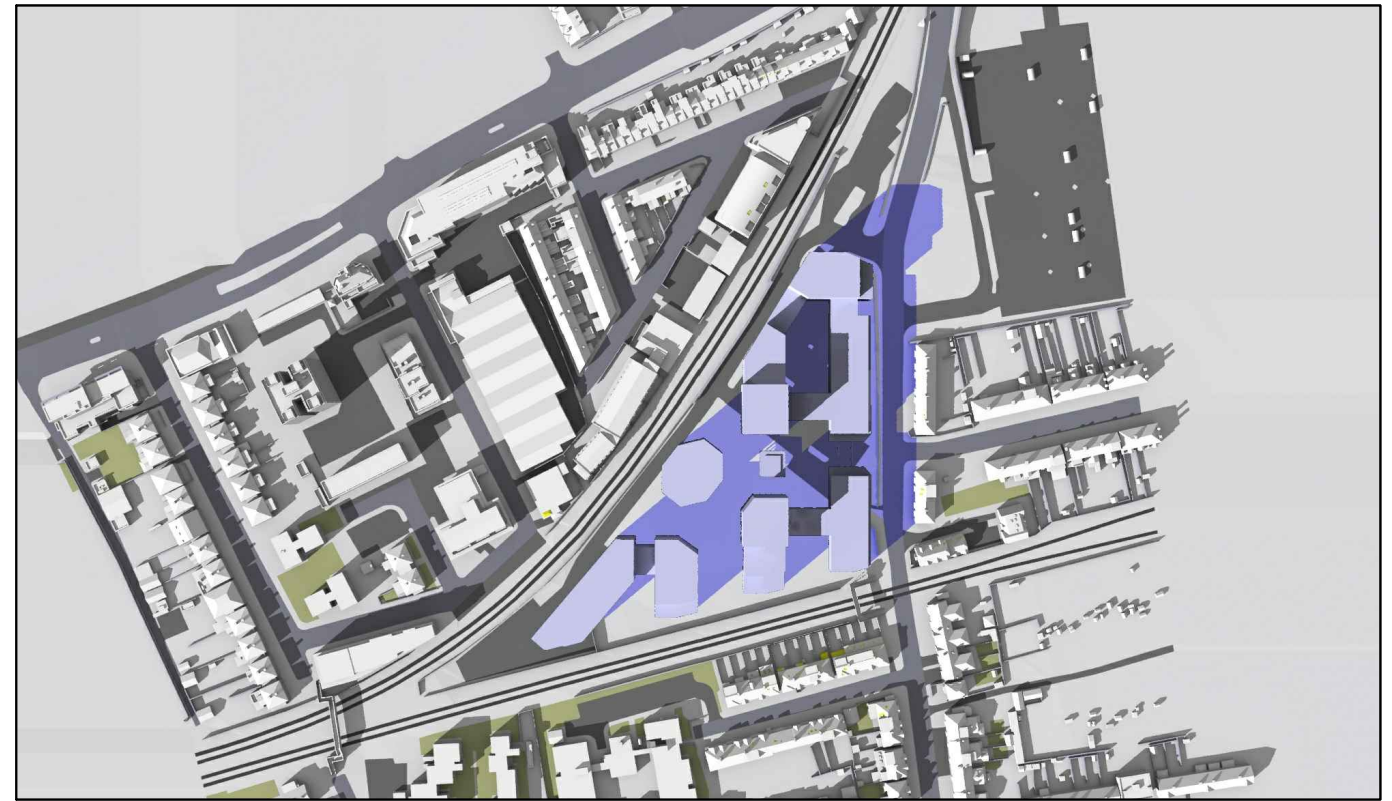

Proposed 03:00pm

March 21st (GMT)

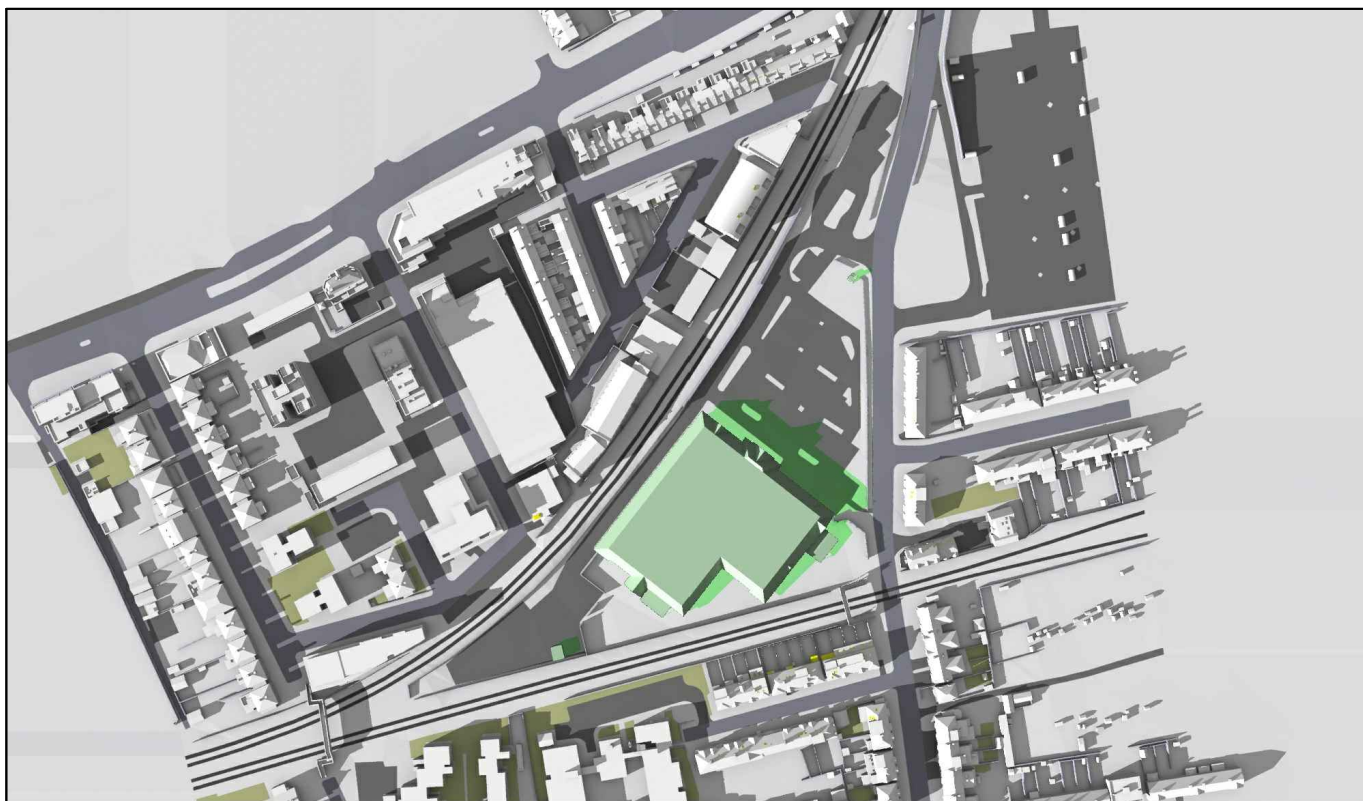

Existing 04:00pm

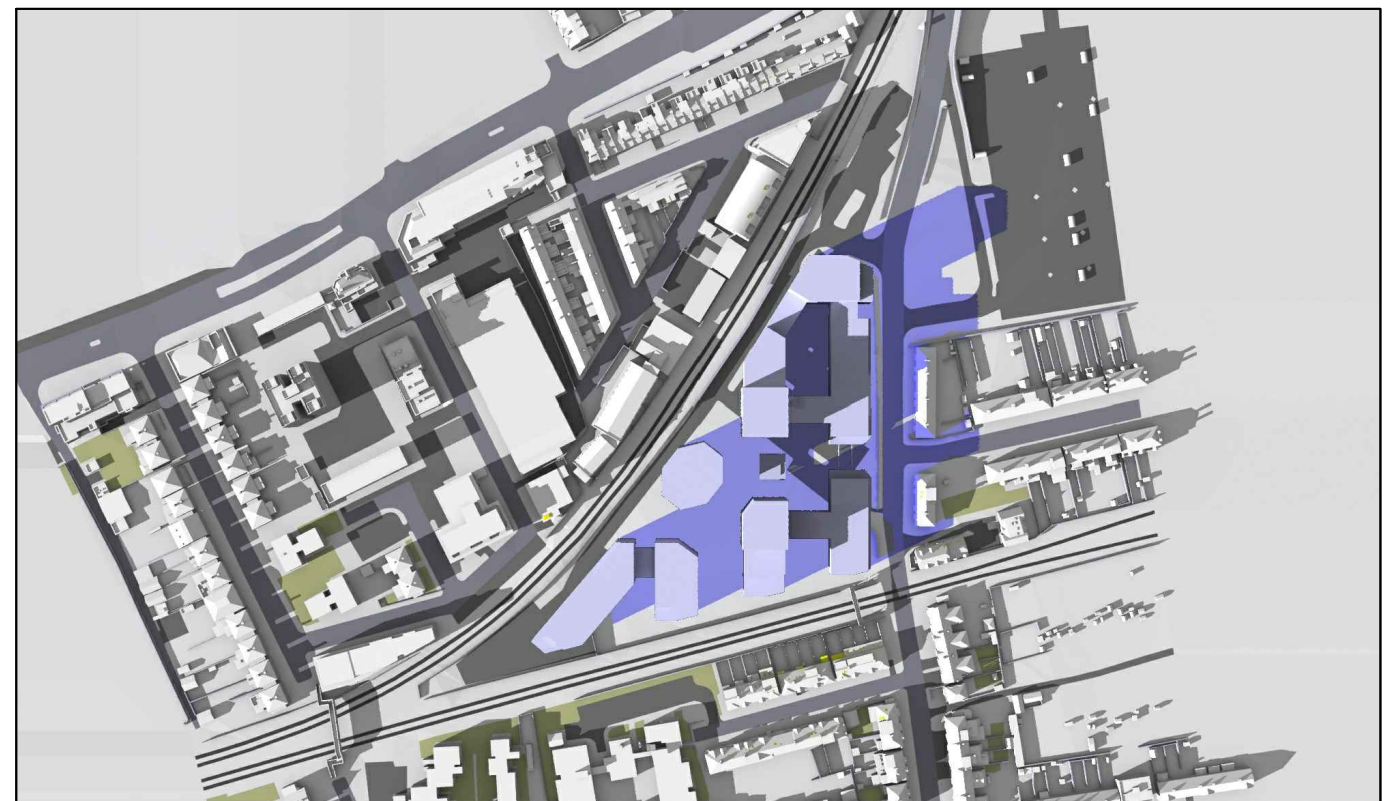

Proposed 04:00pm

Sources: Point 2 Surveyors
Survey Info
Point Cloud Data
Assael Architecture Limited
Proposed Info (received 10/01/19)
A3004_Combined Model_Simple.skp

- Key:
- Grey shadows are those caused by buidings which are not on the site under development.
 - Green shadows are those caused specifically by the consented buildings on the site.
 - Blue shadows are those caused specifically by the proposed development.

Project: Homebase
Richmond

Title: Transient Overshadowing

Point 2 Surveyors Ltd,
3rd Floor,
17 Slingsby Place,
London WC2E 9AB,
0207 836 5828
www.point2surveyors.com

Drawn By: SDJ

Scale: NTS

Date: Jan 19

Dwg No: **P1685/MAR01/ 05**

Rel: 06



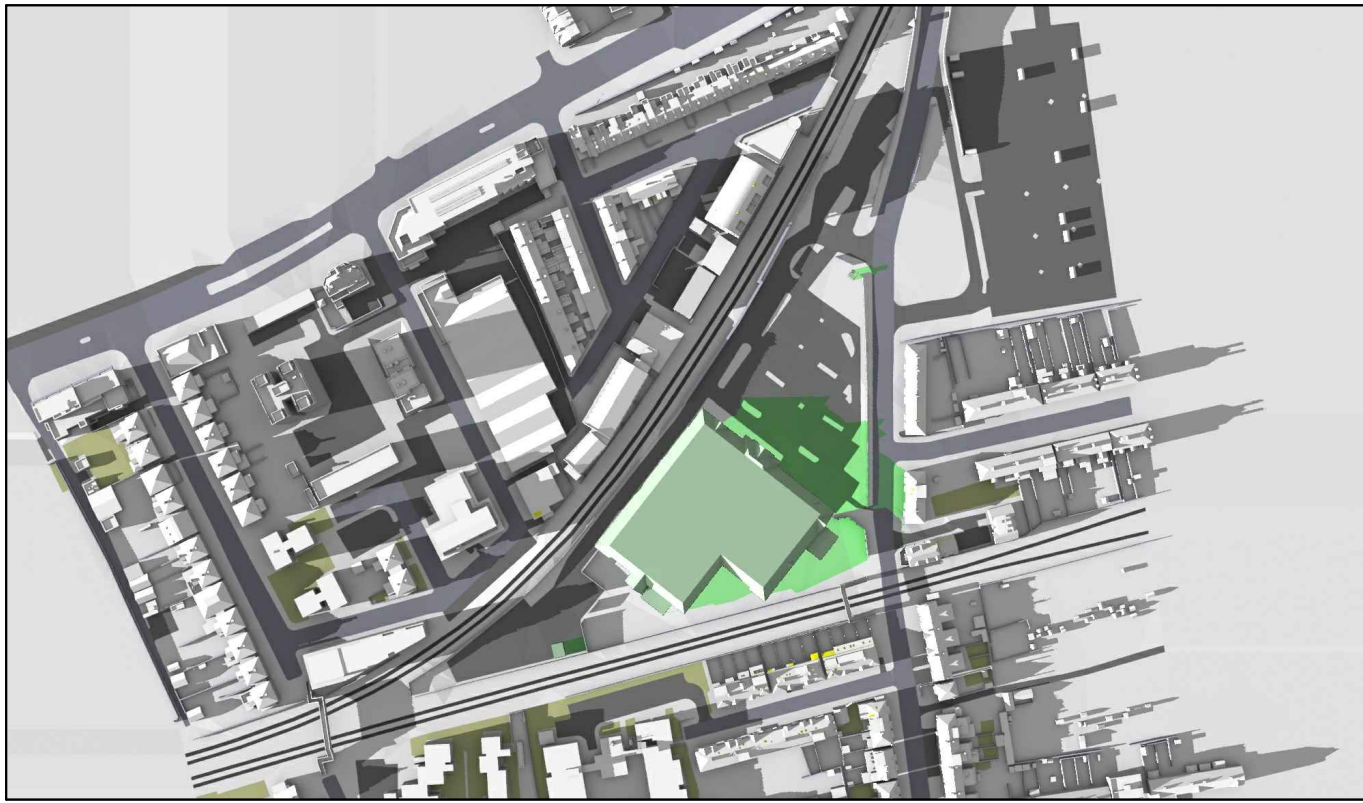

Existing 05:00pm

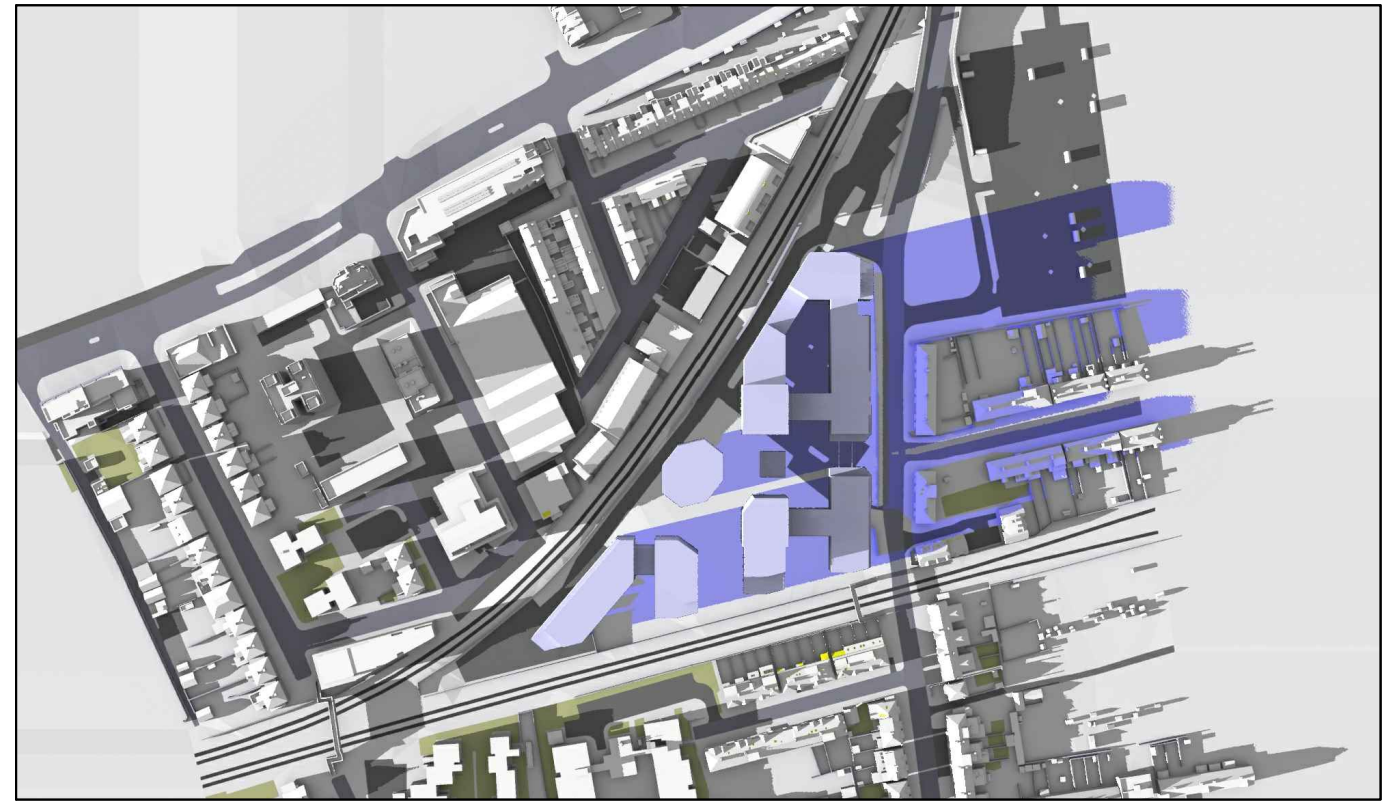

Proposed 05:00pm

March 21st (GMT)

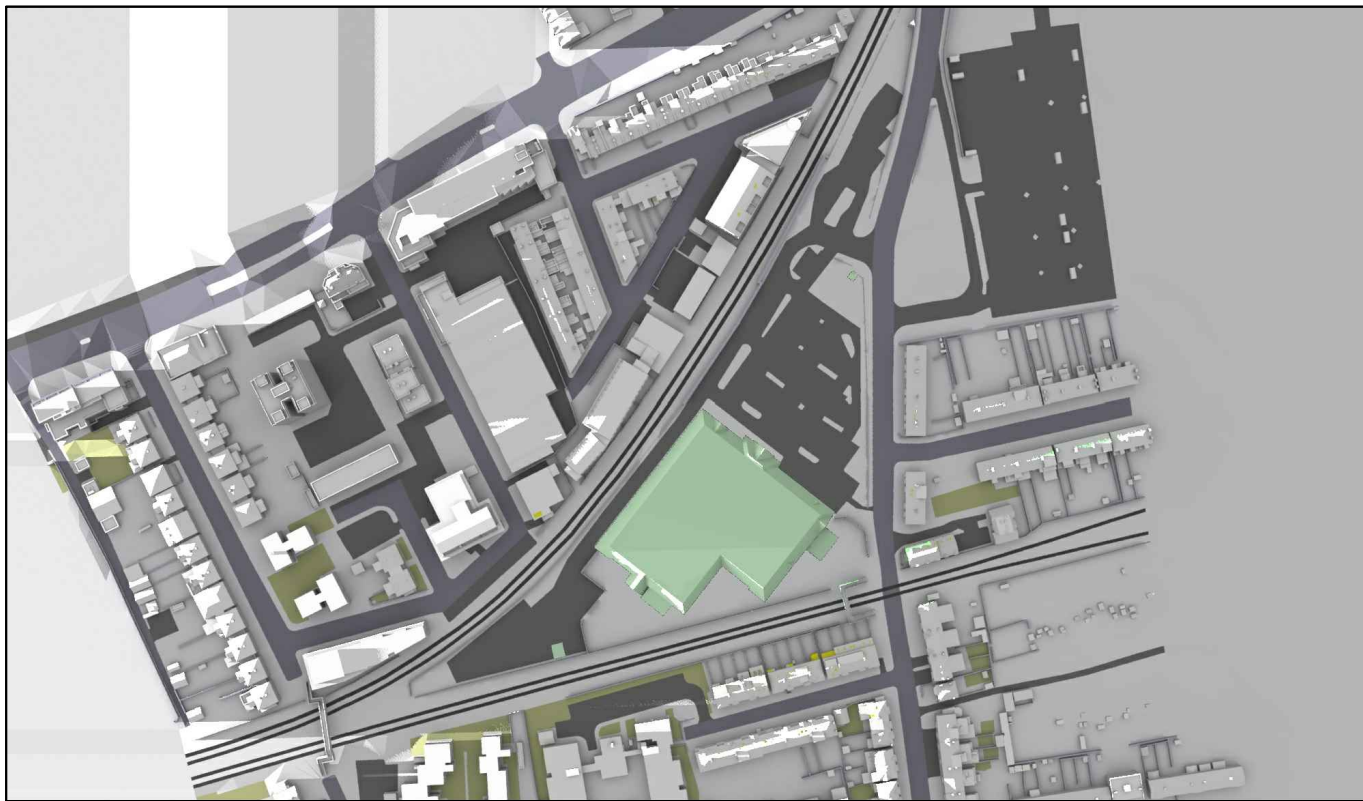

Existing 06:00pm

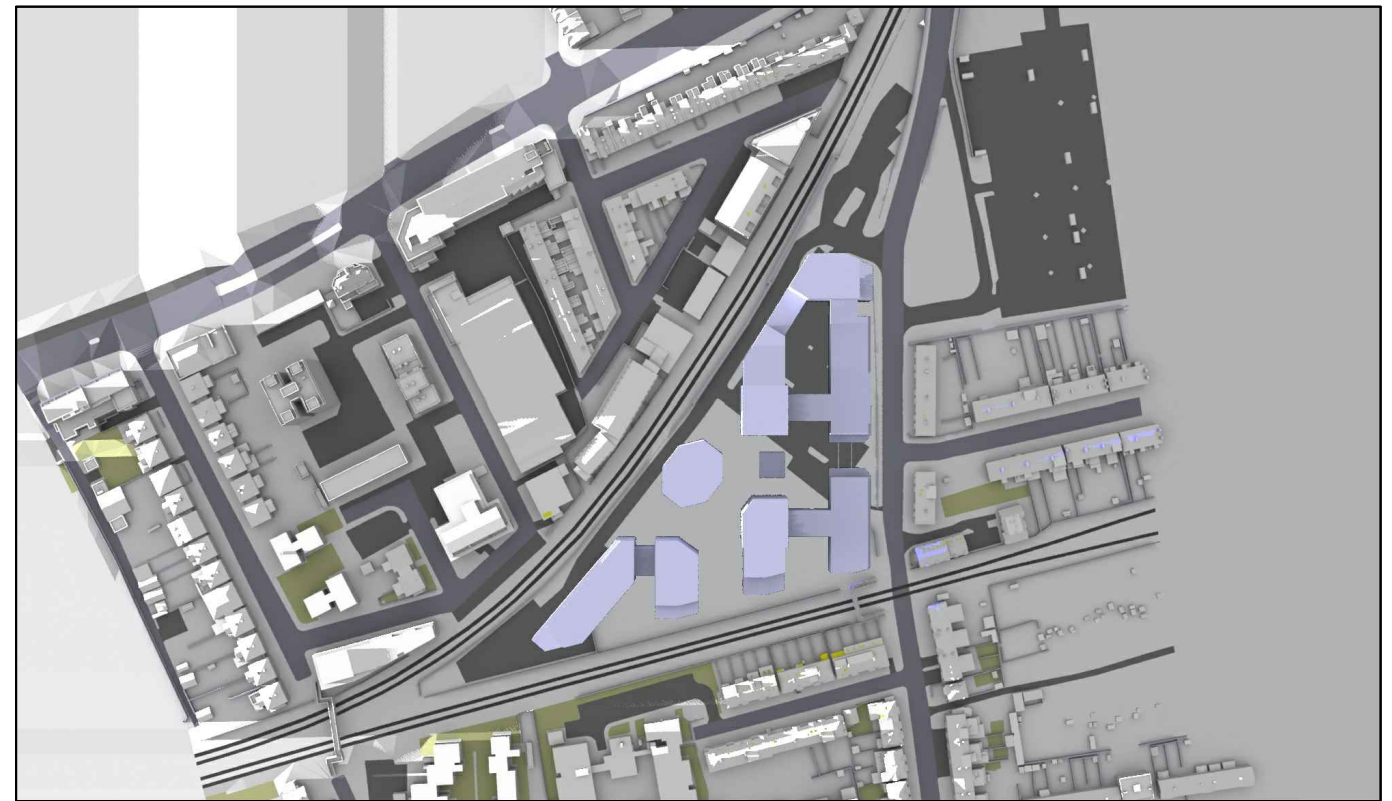

Proposed 06:00pm

Sources: Point 2 Surveyors
Survey Info
Point Cloud Data
Assael Architecture Limited
Proposed Info (received 10/01/19)
A3004_Combined Model_Simple.skp

- Key:
- Grey shadows are those caused by buildings which are not on the site under development.
 - Green shadows are those caused specifically by the consented buildings on the site.
 - Blue shadows are those caused specifically by the proposed development.

Project: Homebase
Richmond

Title: Transient Overshadowing

Point 2 Surveyors Ltd,
3rd Floor,
17 Slingsby Place,
London WC2E 9AB,
0207 836 5828
www.point2surveyors.com

Drawn By: SDJ

Scale: NTS

Date: Jan 19

Dwg No: **P1685/MAR01/ 06**

Rel: 06

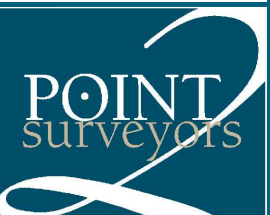



Existing 06:00am

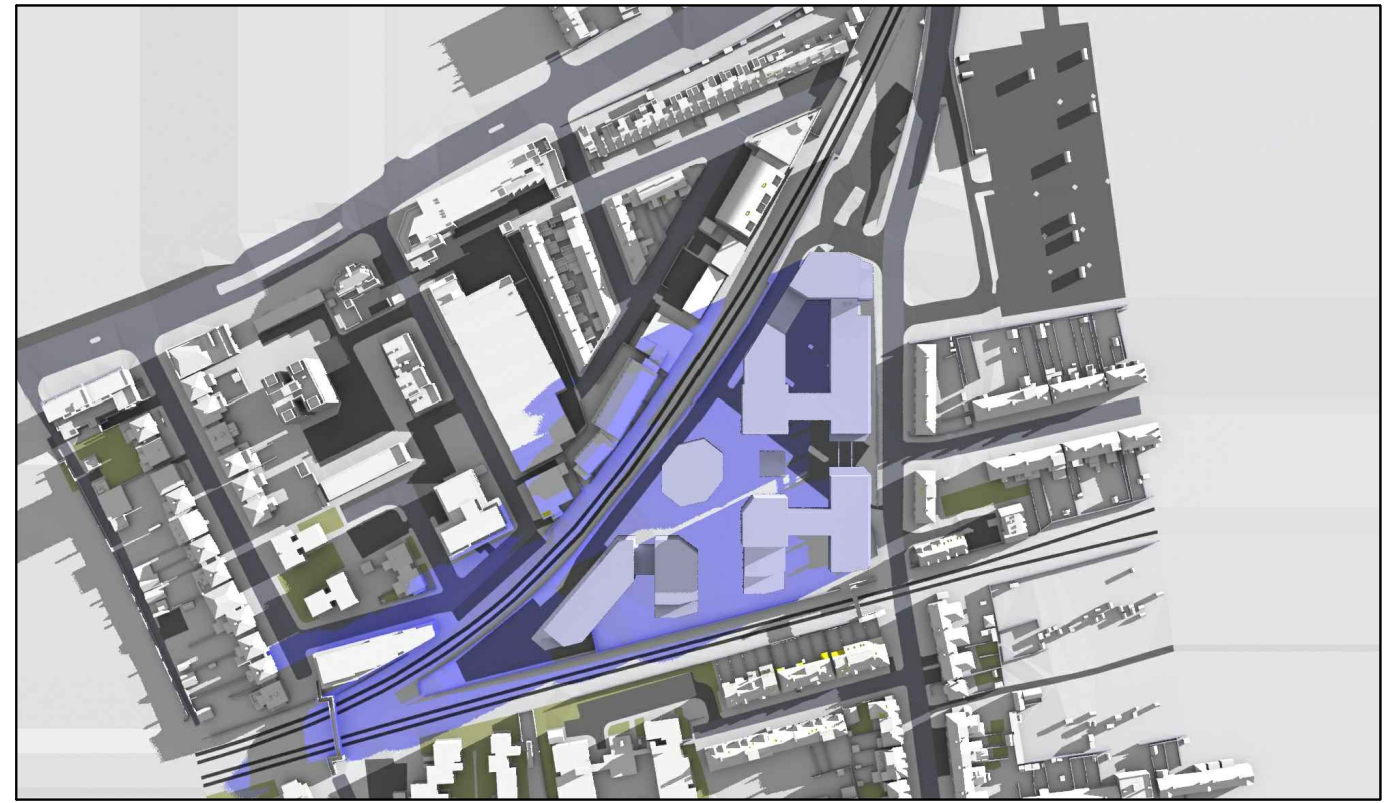

Proposed 06:00am

June 21st (BST)



Existing 07:00am

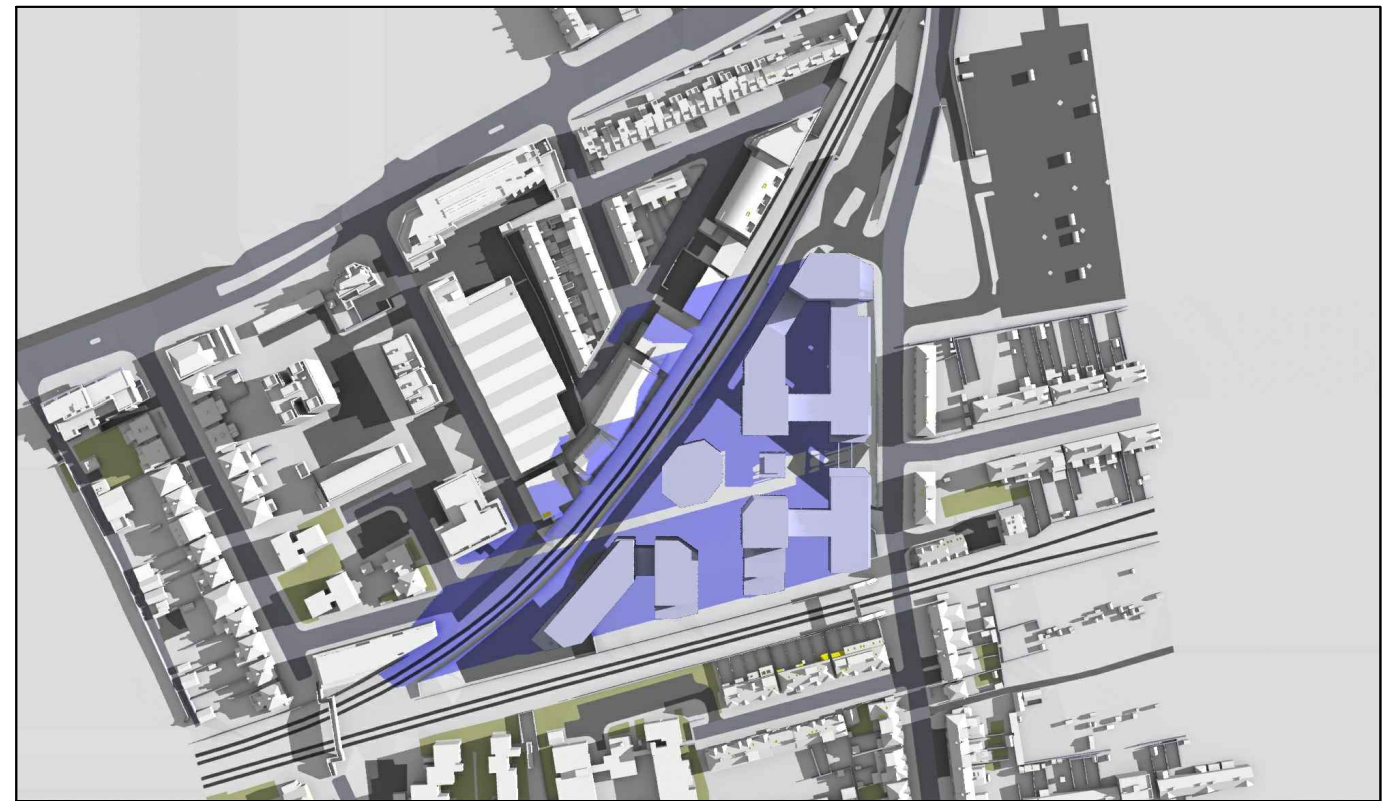

Proposed 07:00am

Sources: Point 2 Surveyors
 Survey Info
 Point Cloud Data
 Assael Architecture Limited
 Proposed Info (received 10/01/19)
 A3004_Combined Model_Simple.skp

- Key:
- Grey shadows are those caused by buildings which are not on the site under development.
 - Green shadows are those caused specifically by the consented buildings on the site.
 - Blue shadows are those caused specifically by the proposed development.

Project: Homebase
 Richmond

Title: Transient Overshadowing

Point 2 Surveyors Ltd,
 3rd Floor,
 17 Slingsby Place,
 London WC2E 9AB,
 0207 836 5828
 www.point2surveyors.com

Drawn By: SDJ

Scale: NTS

Date: Jan 19

Dwg No: **P1685/JUN01/01**

Rel: 06

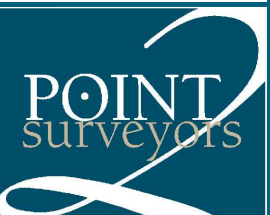



Existing 08:00am

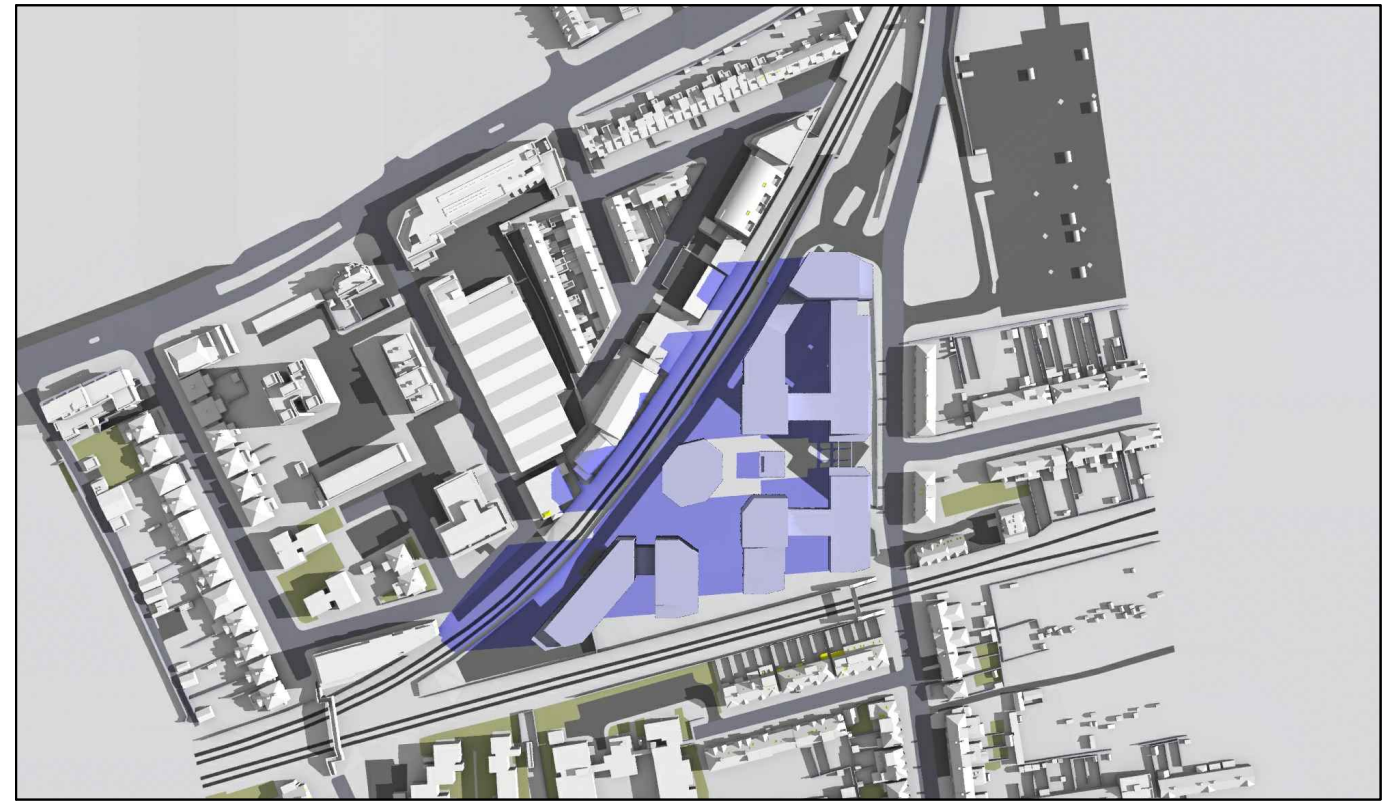

Proposed 08:00am

June 21st (BST)



Existing 09:00am



Proposed 09:00am

Sources: Point 2 Surveyors
Survey Info
Point Cloud Data
Assael Architecture Limited
Proposed Info (received 10/01/19)
A3004_Combined Model_Simple.skp

- Key:
- Grey shadows are those caused by buidings which are not on the site under development.
 - Green shadows are those caused specifically by the consented buildings on the site.
 - Blue shadows are those caused specifically by the proposed development.

Project: Homebase
Richmond

Title: Transient Overshadowing

Point 2 Surveyors Ltd,
3rd Floor,
17 Slingsby Place,
London WC2E 9AB,
0207 836 5828
www.point2surveyors.com

Drawn By: SDJ

Scale: NTS

Date: Jan 19

Dwg No: **P1685/JUN01/02**

Rel: 06

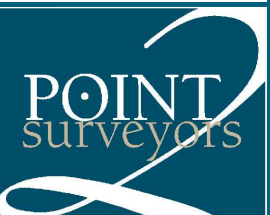



Existing 10:00am



Proposed 10:00am

June 21st (BST)



Existing 11:00am



Proposed 11:00am

Sources: Point 2 Surveyors
Survey Info
Point Cloud Data
Assael Architecture Limited
Proposed Info (received 10/01/19)
A3004_Combined Model_Simple.skp

- Key:
- Grey shadows are those caused by buildings which are not on the site under development.
 - Green shadows are those caused specifically by the consented buildings on the site.
 - Blue shadows are those caused specifically by the proposed development.

Project: Homebase
Richmond

Title: Transient Overshadowing

Point 2 Surveyors Ltd,
3rd Floor,
17 Slingsby Place,
London WC2E 9AB,
0207 836 5828
www.point2surveyors.com

Drawn By: SDJ

Scale: NTS

Date: Jan 19

Dwg No: **P1685/JUN01/03**

Rel: 06

