

Existing 12:00pm

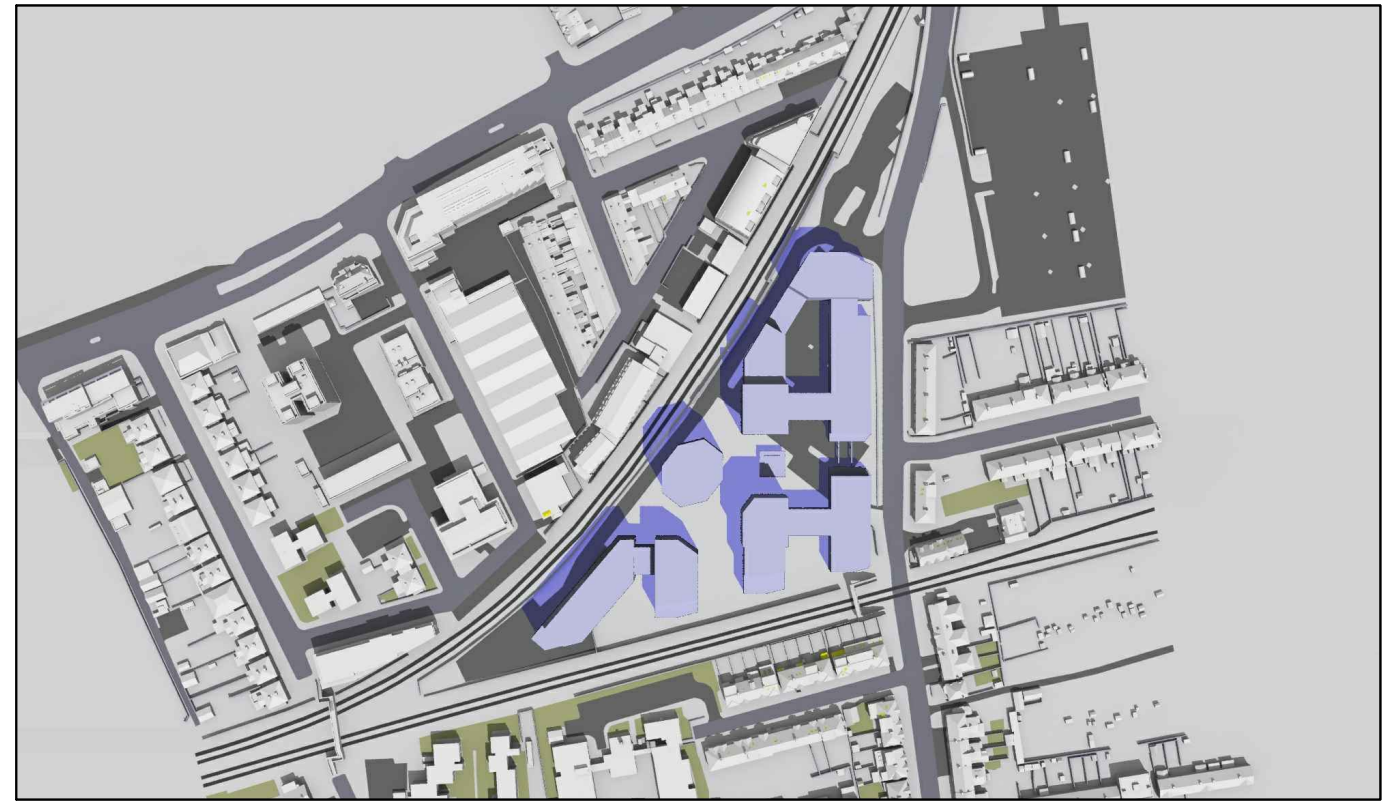

Proposed 12:00pm

June 21st (BST)

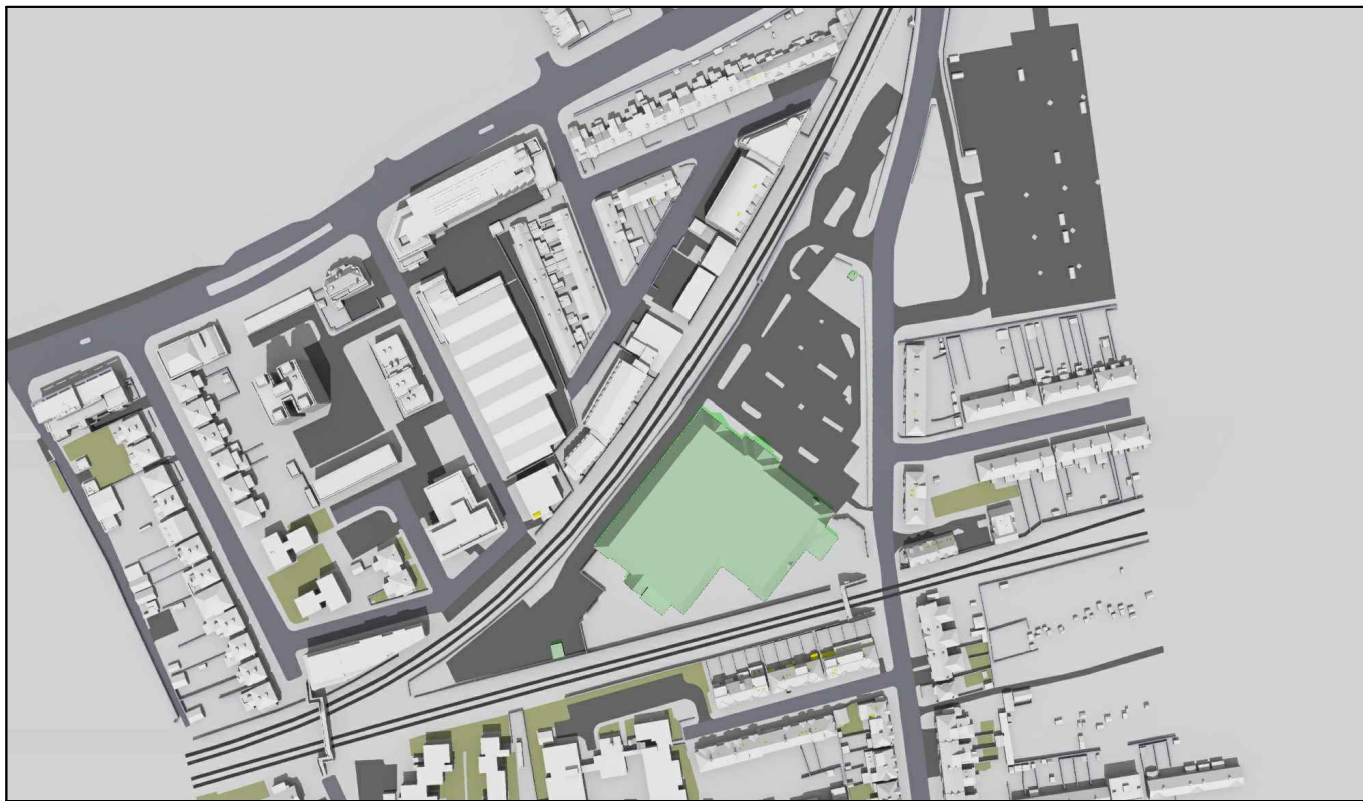

Existing 01:00pm

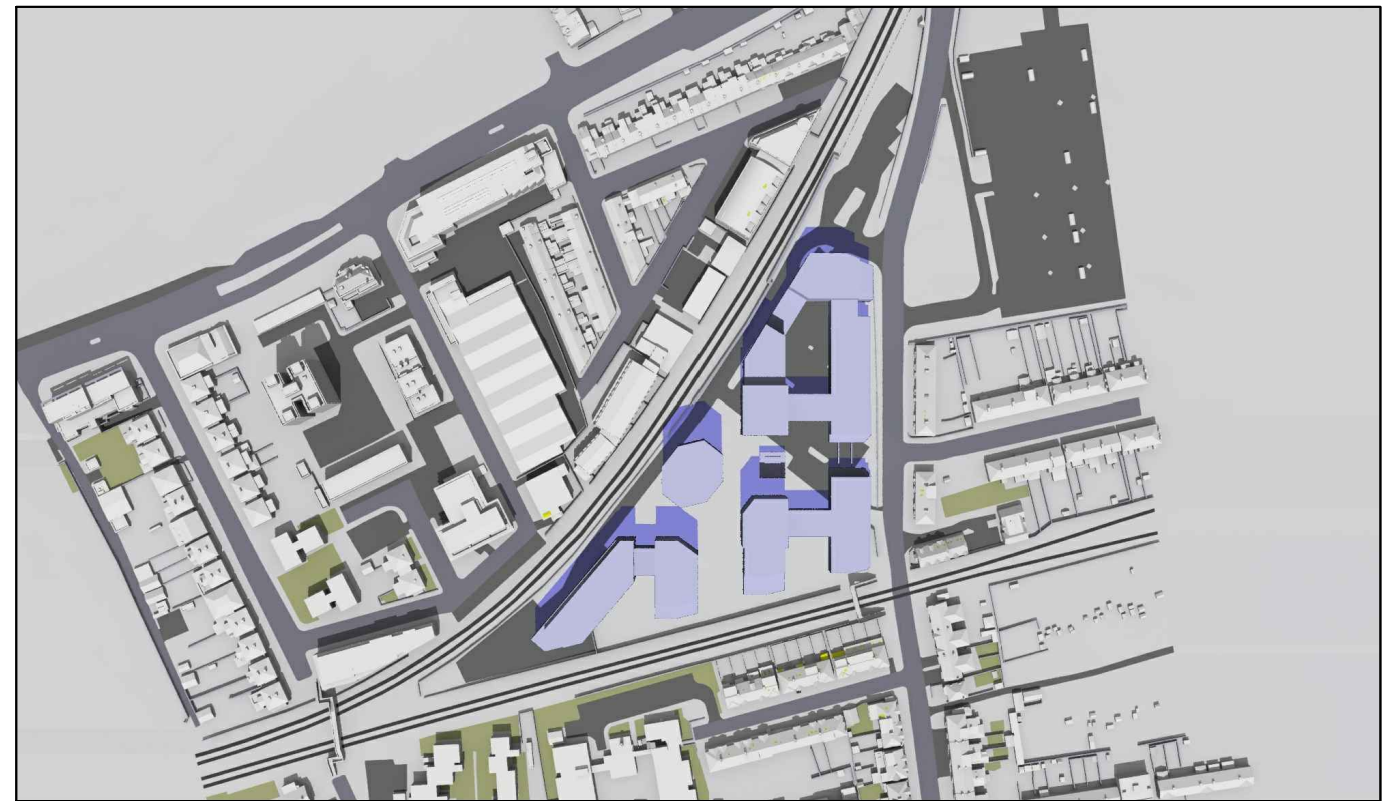

Proposed 01:00pm

Sources: Point 2 Surveyors
Survey Info
Point Cloud Data
Assael Architecture Limited
Proposed Info (received 10/01/19)
A3004_Combined Model_Simple.skp

- Key:
- Grey shadows are those caused by buildings which are not on the site under development.
 - Green shadows are those caused specifically by the consented buildings on the site.
 - Blue shadows are those caused specifically by the proposed development.

Project: Homebase
Richmond

Title: Transient Overshadowing

Point 2 Surveyors Ltd,
3rd Floor,
17 Slingsby Place,
London WC2E 9AB,
0207 836 5828
www.point2surveyors.com

Drawn By: SDJ

Scale: NTS

Date: Jan 19

Dwg No: **P1685/JUN01/04**

Rel: 06

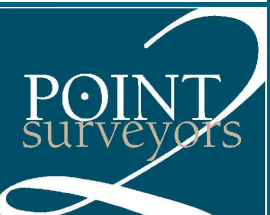



Existing 02:00pm

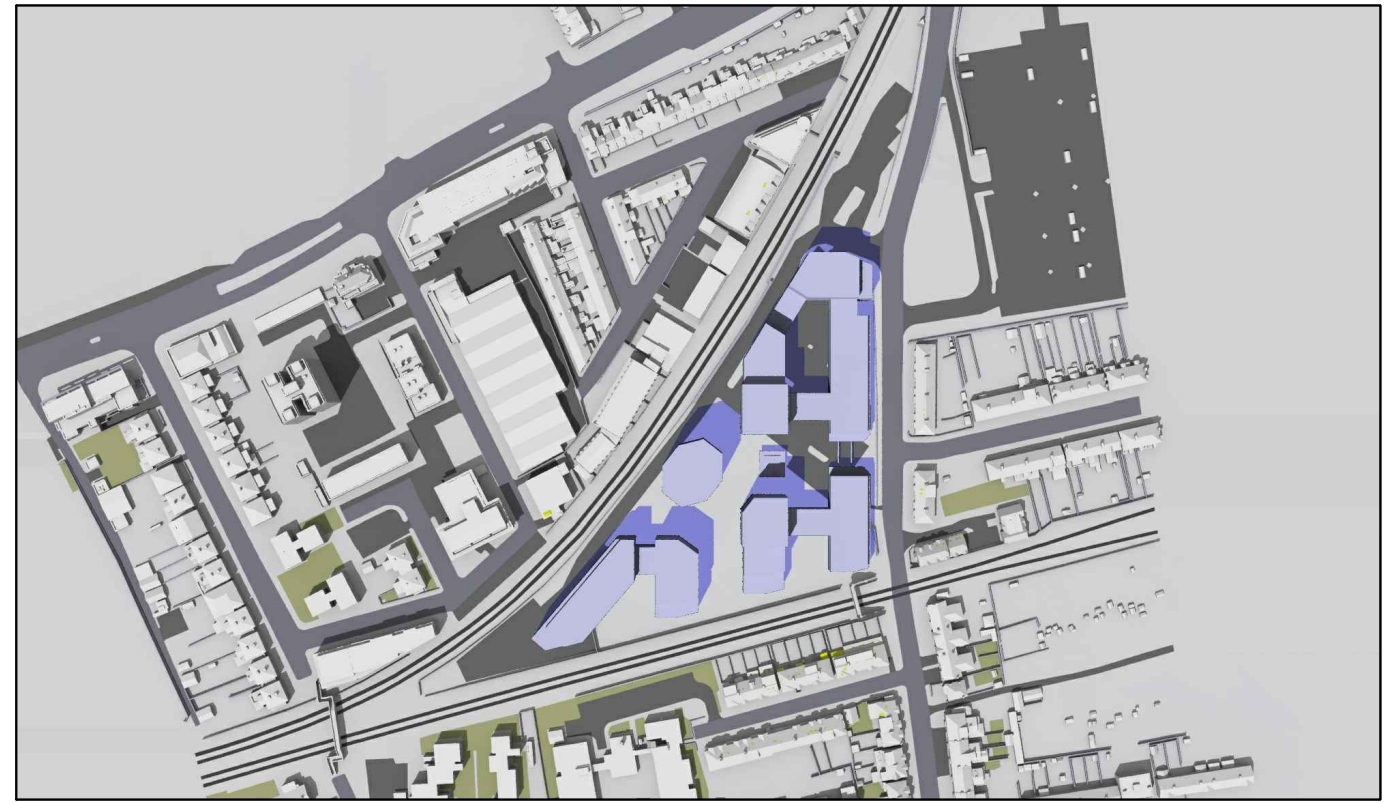

Proposed 02:00pm

June 21st (BST)



Existing 03:00pm

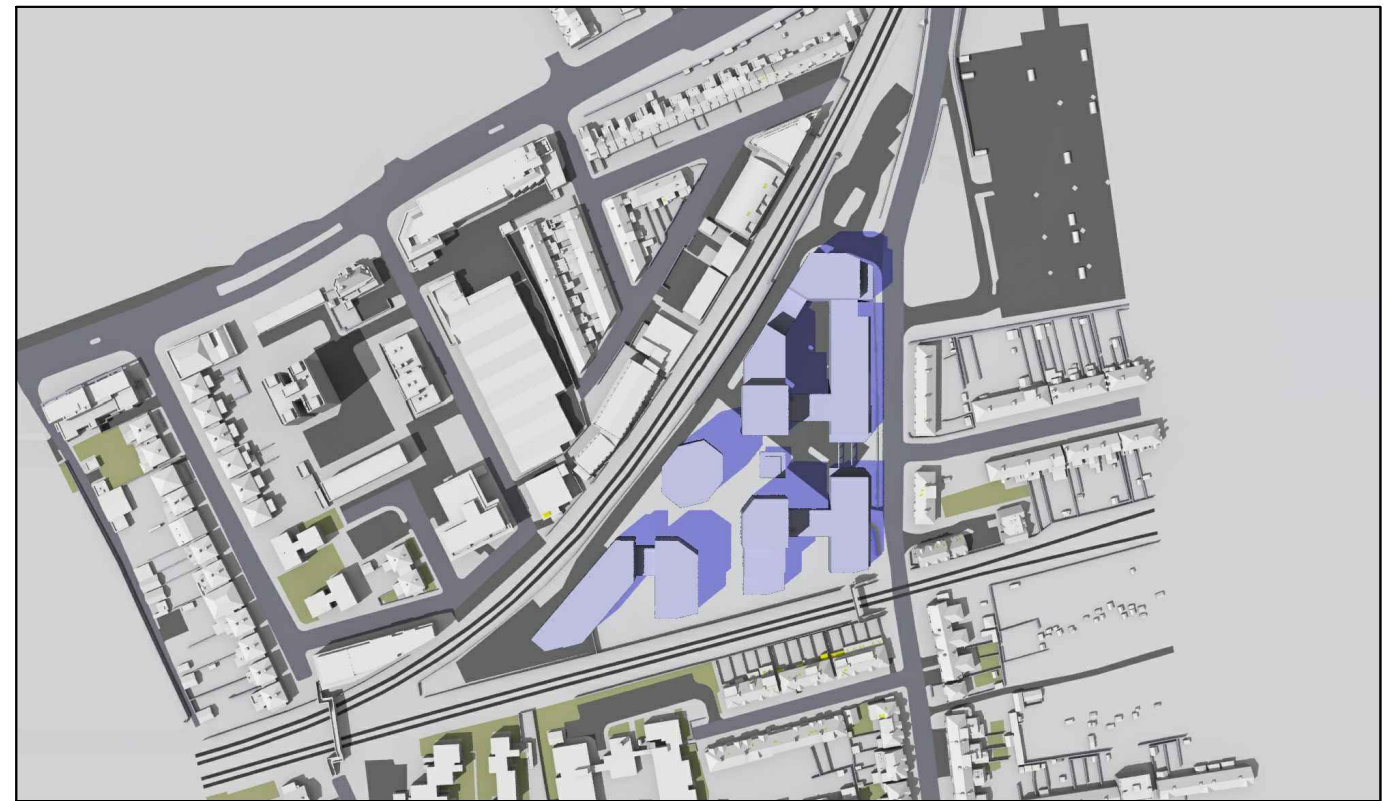

Proposed 03:00pm

Sources: Point 2 Surveyors
 Survey Info
 Point Cloud Data
 Assael Architecture Limited
 Proposed Info (received 10/01/19)
 A3004_Combined Model_Simple.skp

Key:

- Grey shadows are those caused by buildings which are not on the site under development.
- Green shadows are those caused specifically by the consented buildings on the site.
- Blue shadows are those caused specifically by the proposed development.

Project: Homebase
 Richmond

Title: Transient Overshadowing

Point 2 Surveyors Ltd,
 3rd Floor,
 17 Slingsby Place,
 London WC2E 9AB,
 0207 836 5828
 www.point2surveyors.com

Drawn By: SDJ

Scale: NTS

Date: Jan 19

Dwg No: **P1685/JUN01/05**

Rel: 06

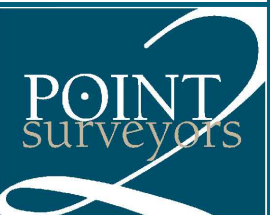

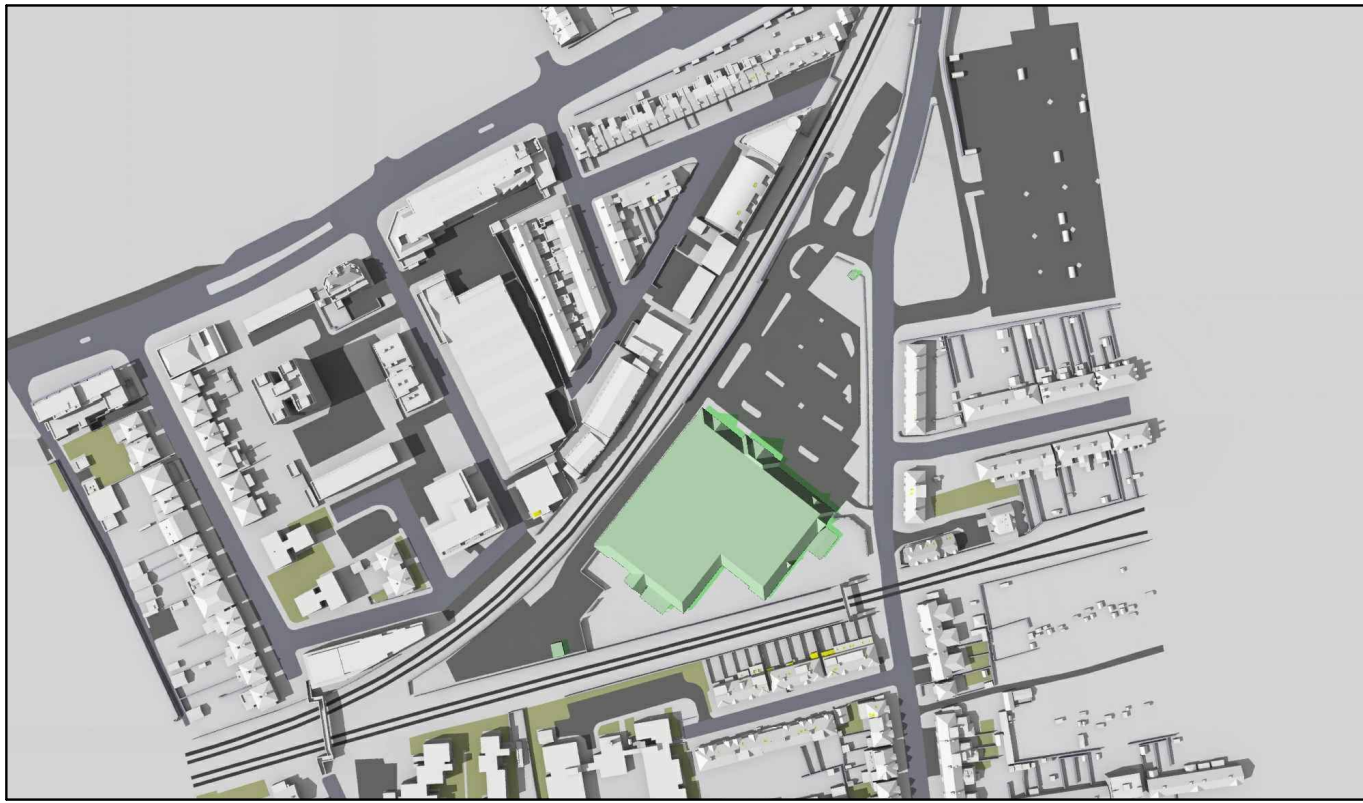

Existing 04:00pm

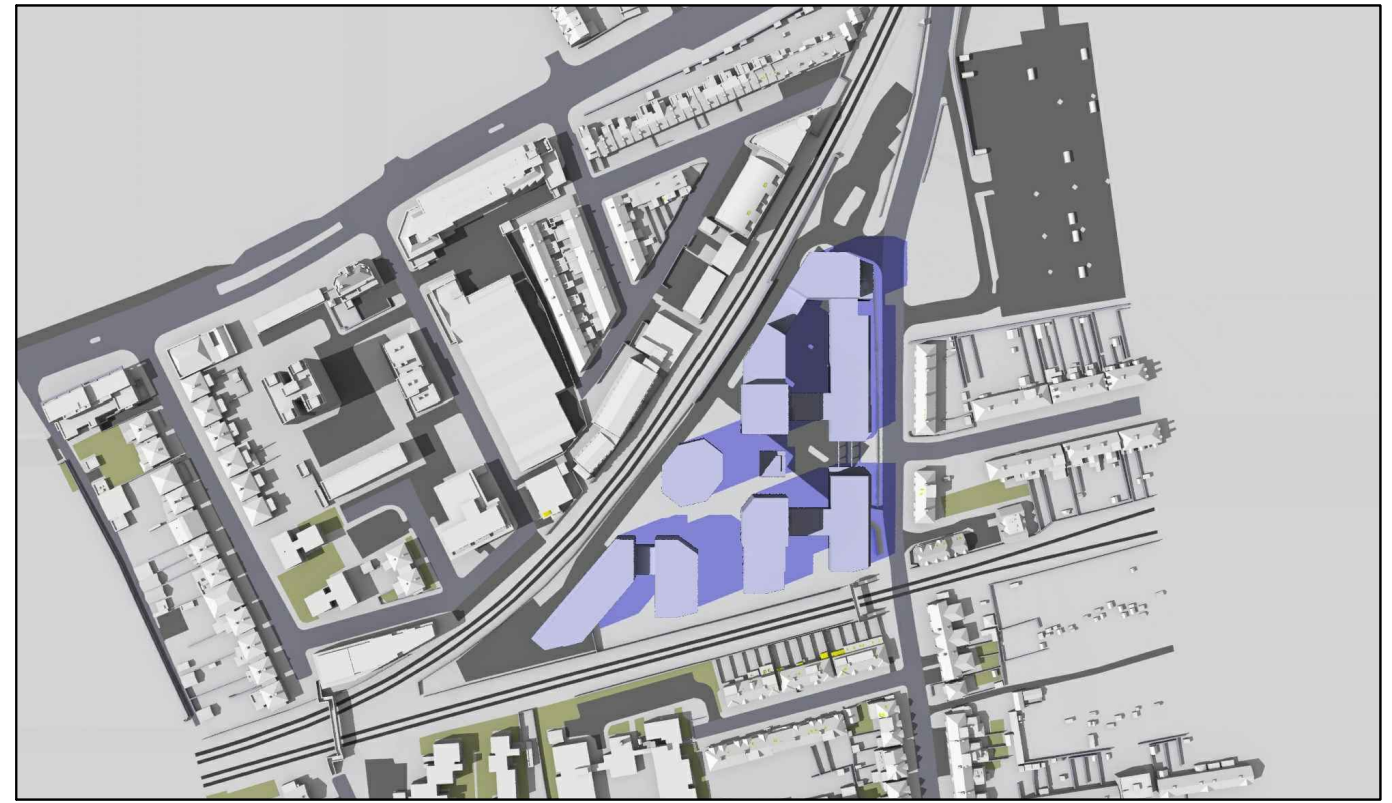

Proposed 04:00pm

June 21st (BST)

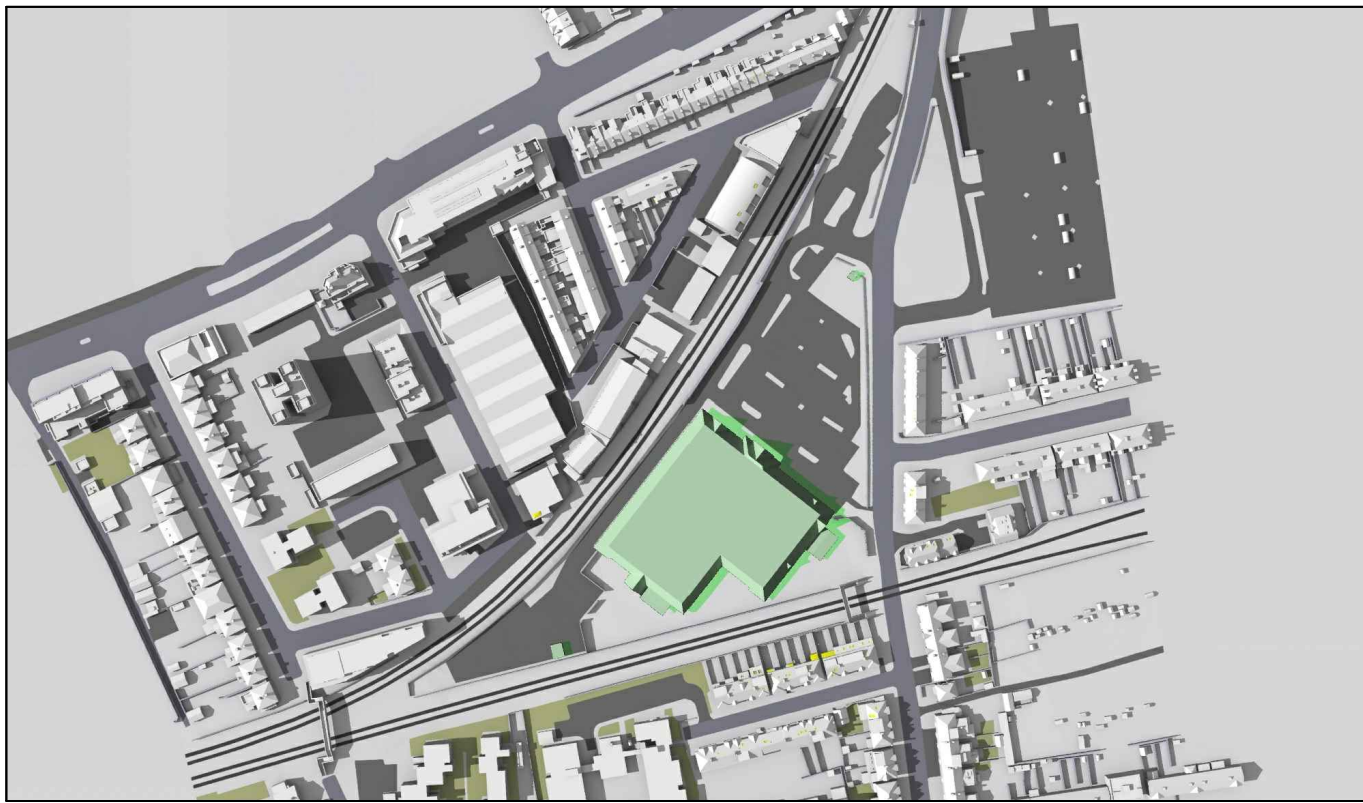

Existing 05:00pm

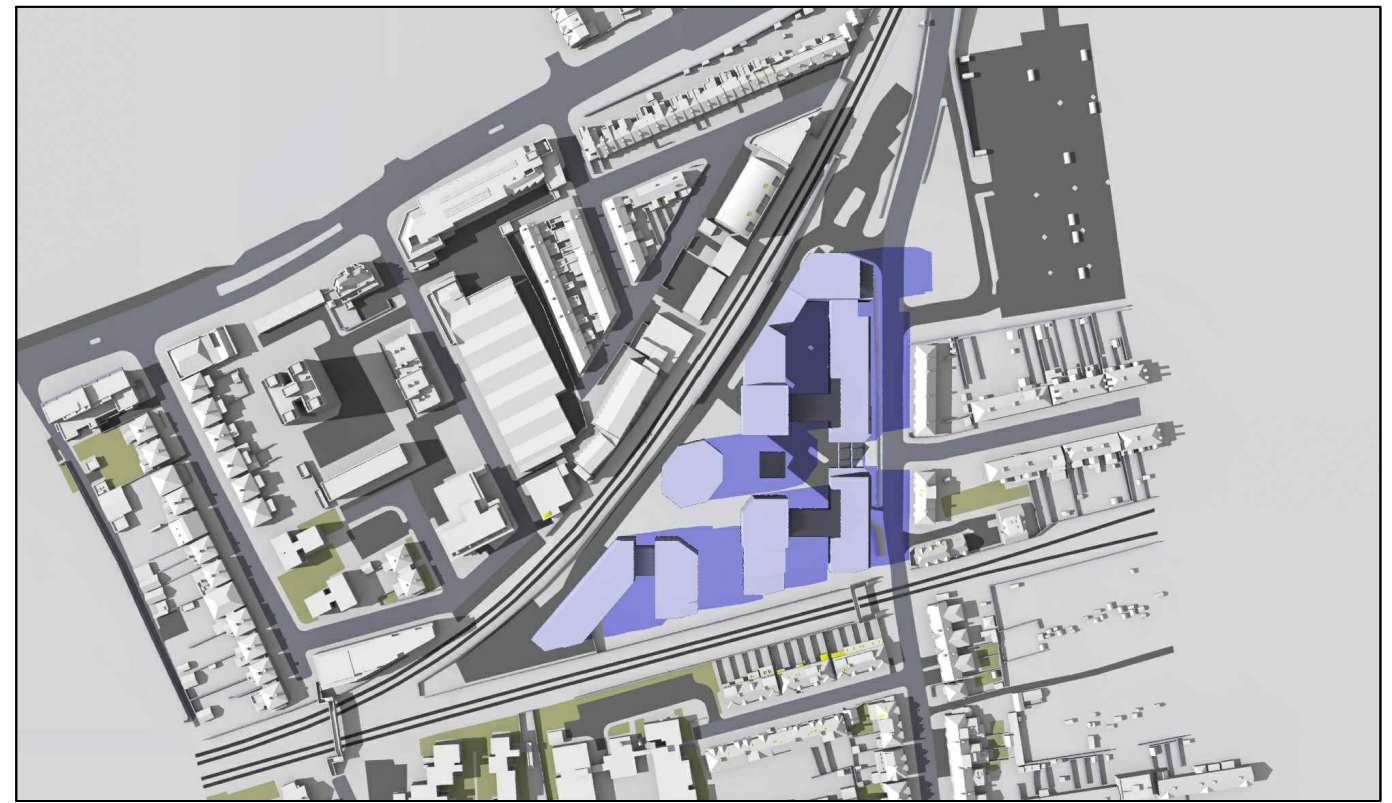

Proposed 05:00pm

Sources: Point 2 Surveyors
Survey Info
Point Cloud Data
Assael Architecture Limited
Proposed Info (received 10/01/19)
A3004_Combined Model_Simple.skp

- Key:
- Grey shadows are those caused by buidings which are not on the site under development.
 - Green shadows are those caused specifically by the consented buildings on the site.
 - Blue shadows are those caused specifically by the proposed development.

Project: Homebase
Richmond

Title: Transient Overshadowing

Point 2 Surveyors Ltd,
3rd Floor,
17 Slingsby Place,
London WC2E 9AB,
0207 836 5828
www.point2surveyors.com

Drawn By: SDJ

Scale: NTS

Date: Jan 19

Dwg No: **P1685/JUN01/06**

Rel: 06



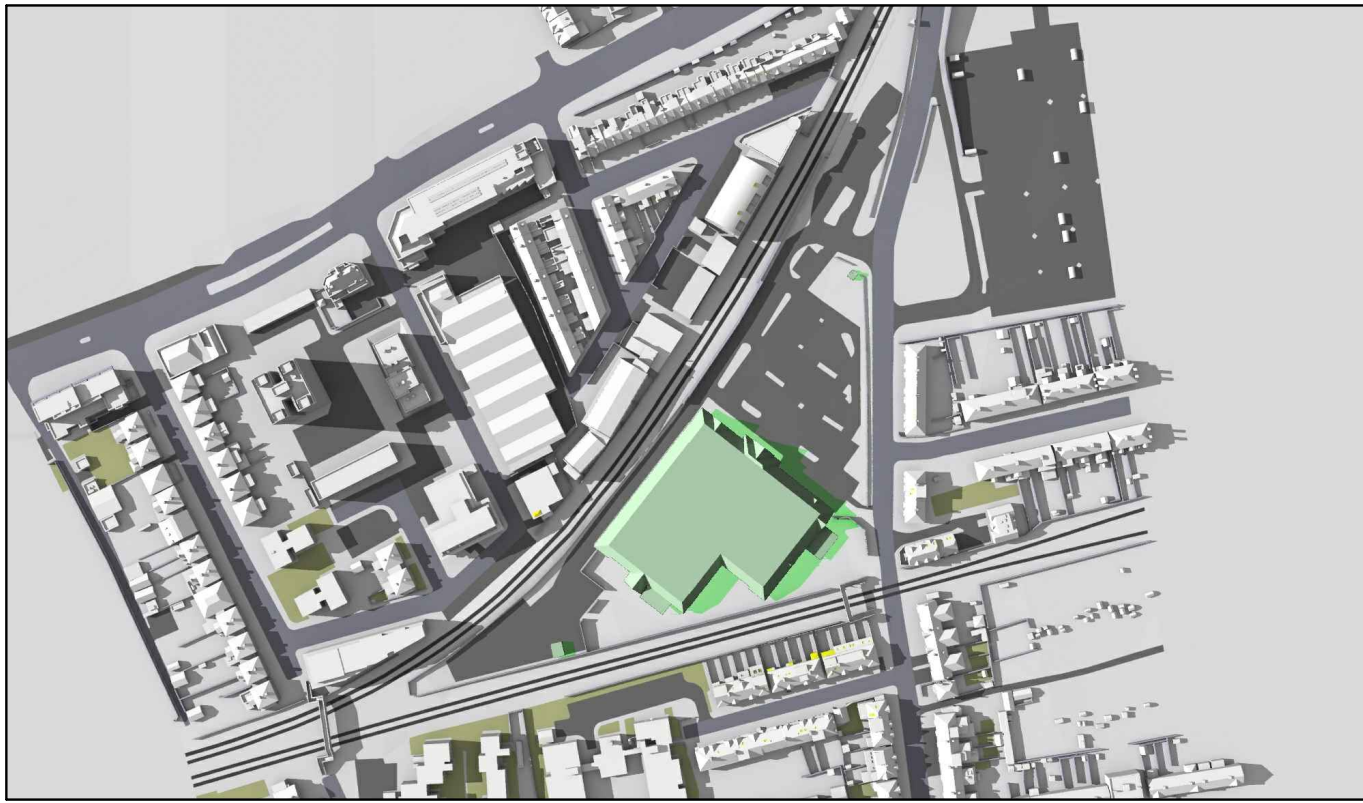

Existing 06:00pm

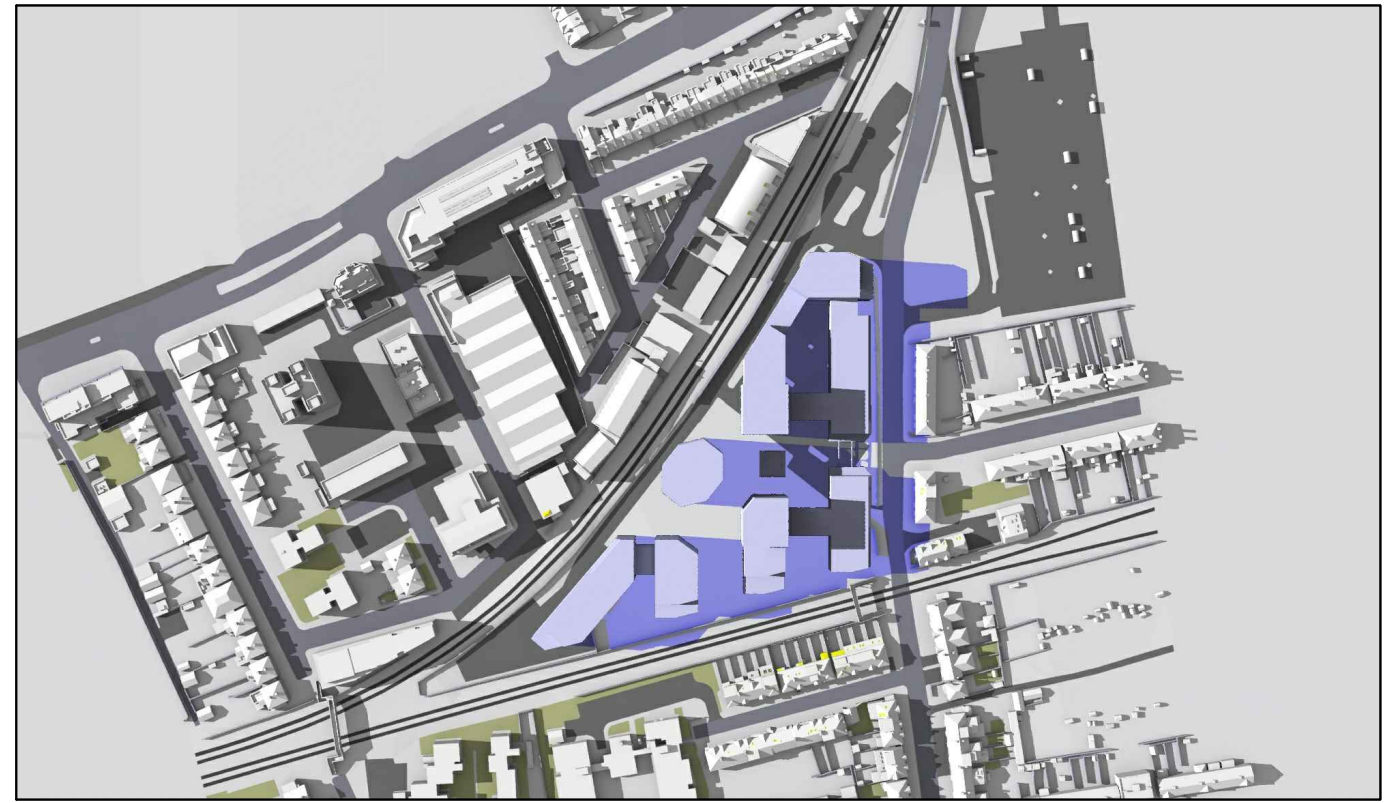

Proposed 06:00pm

June 21st (BST)

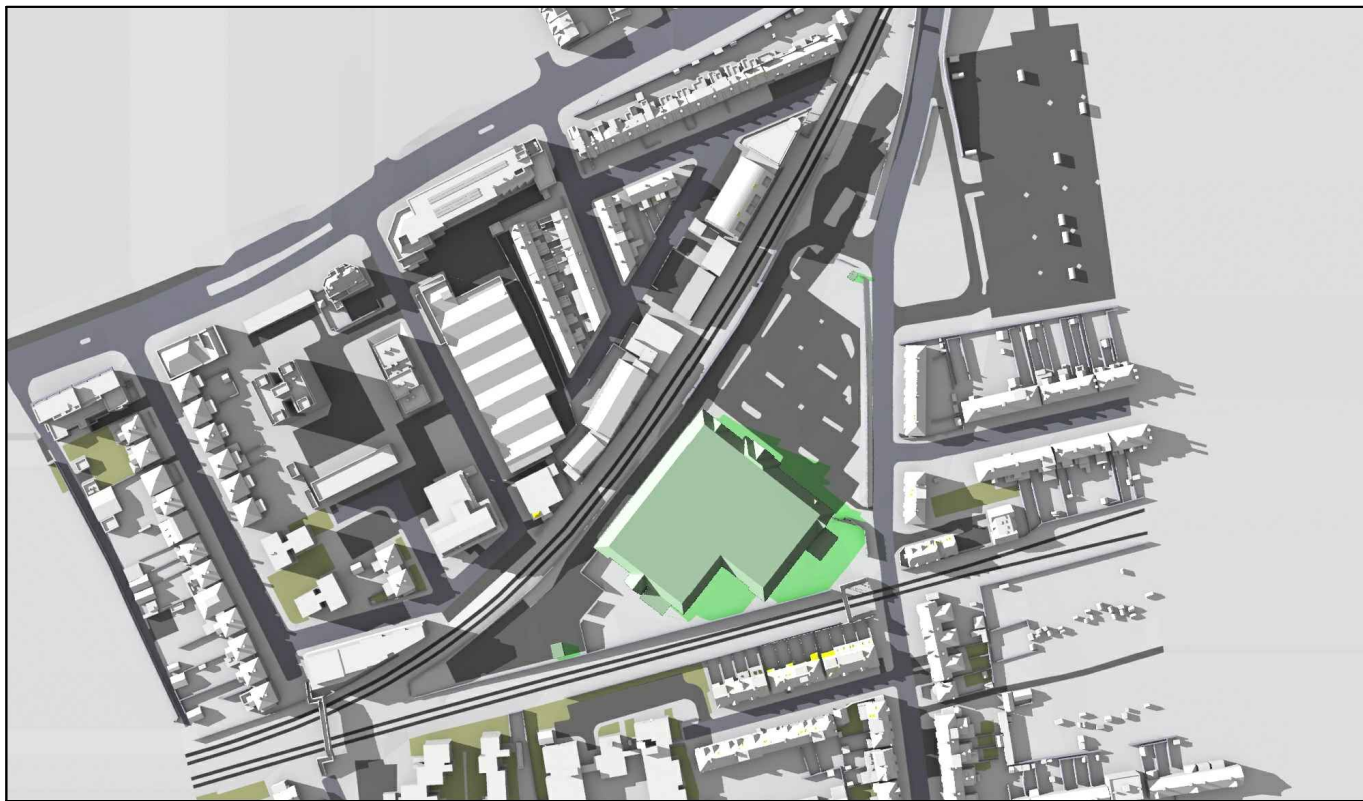

Existing 07:00pm

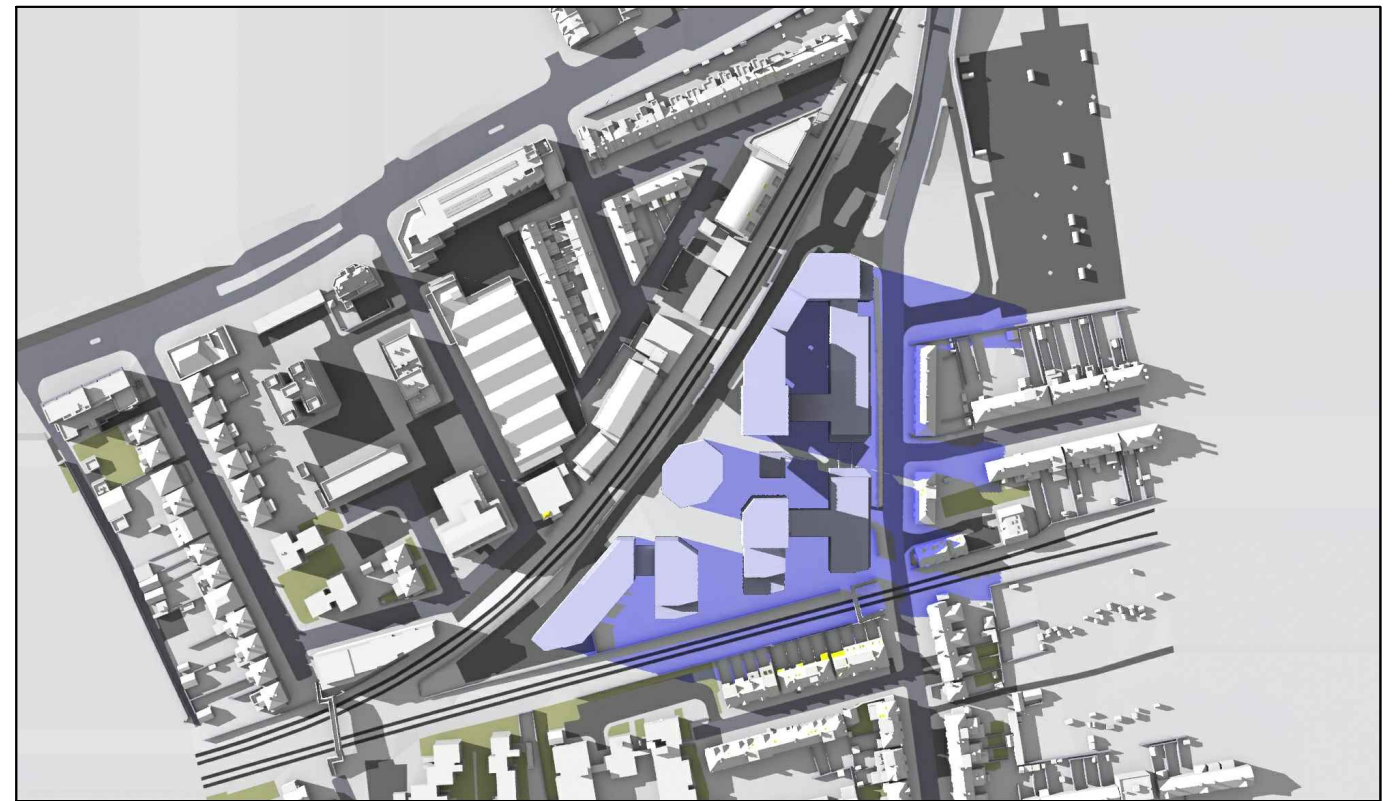

Proposed 07:00pm

Sources: Point 2 Surveyors
Survey Info
Point Cloud Data
Assael Architecture Limited
Proposed Info (received 10/01/19)
A3004_Combined Model_Simple.skp

- Key:
- Grey shadows are those caused by buidings which are not on the site under development.
 - Green shadows are those caused specifically by the consented buildings on the site.
 - Blue shadows are those caused specifically by the proposed development.

Project: Homebase
Richmond

Title: Transient Overshadowing

Point 2 Surveyors Ltd,
3rd Floor,
17 Slingsby Place,
London WC2E 9AB,
0207 836 5828
www.point2surveyors.com

Drawn By: SDJ

Scale: NTS

Date: Jan 19

Dwg No: **P1685/JUN01/07**

Rel: 06



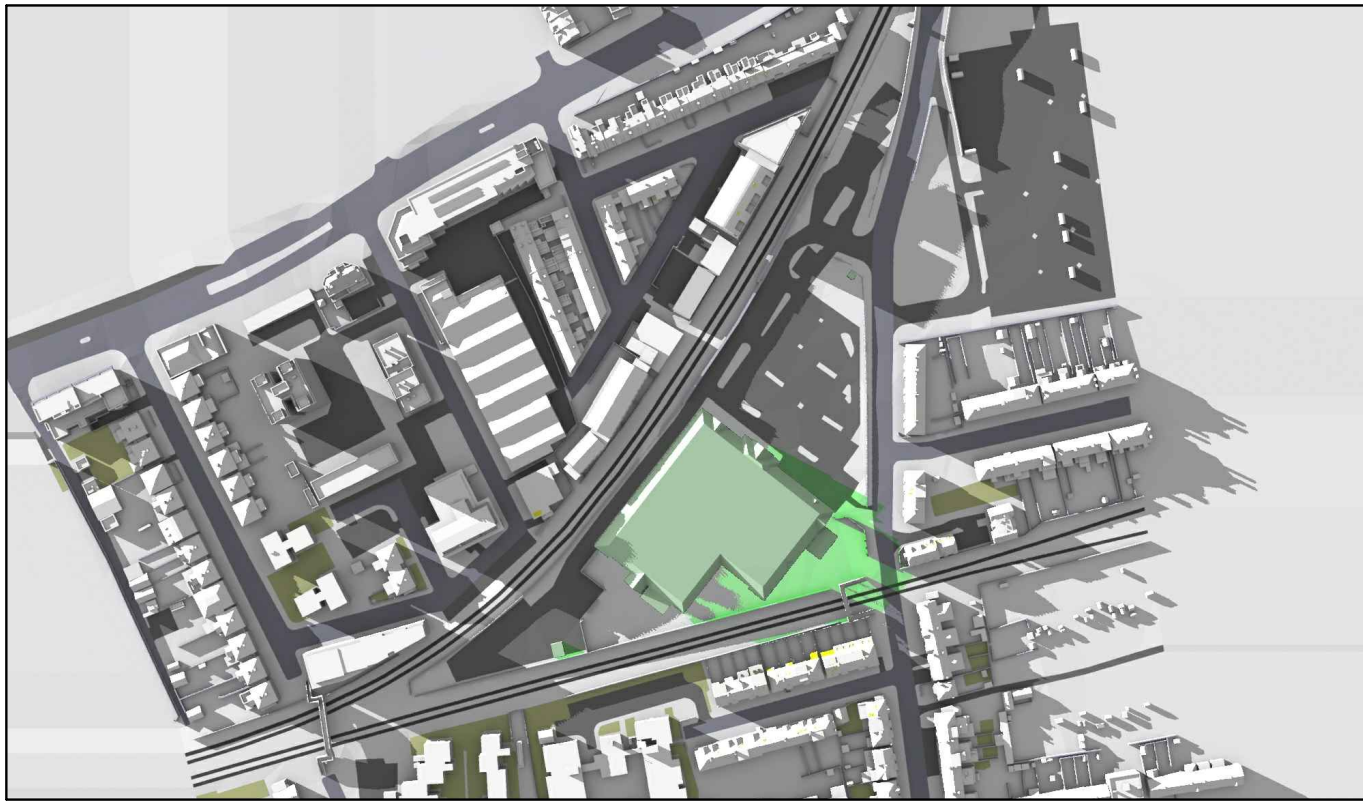

Existing 08:00pm

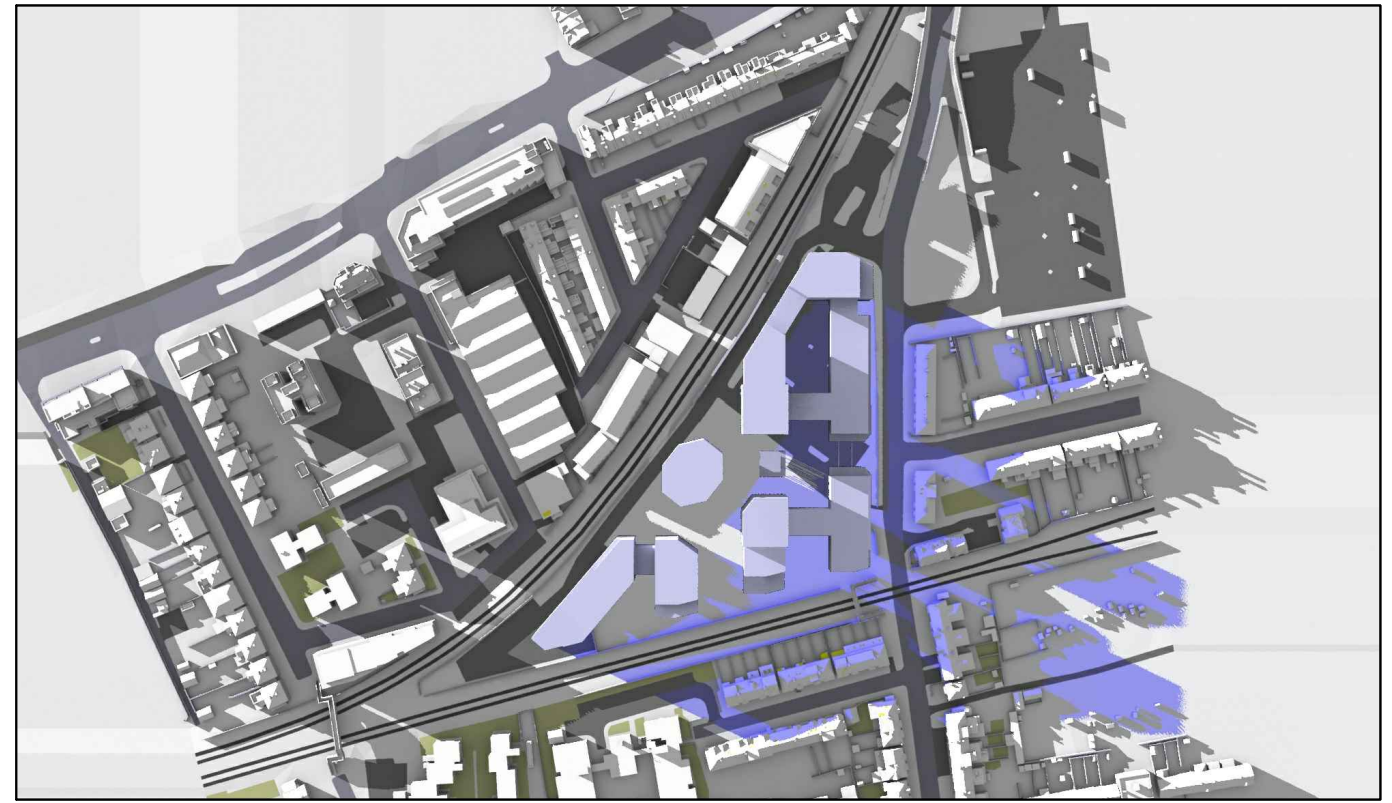

Proposed 08:00pm

June 21st (BST)



Existing 09:00pm

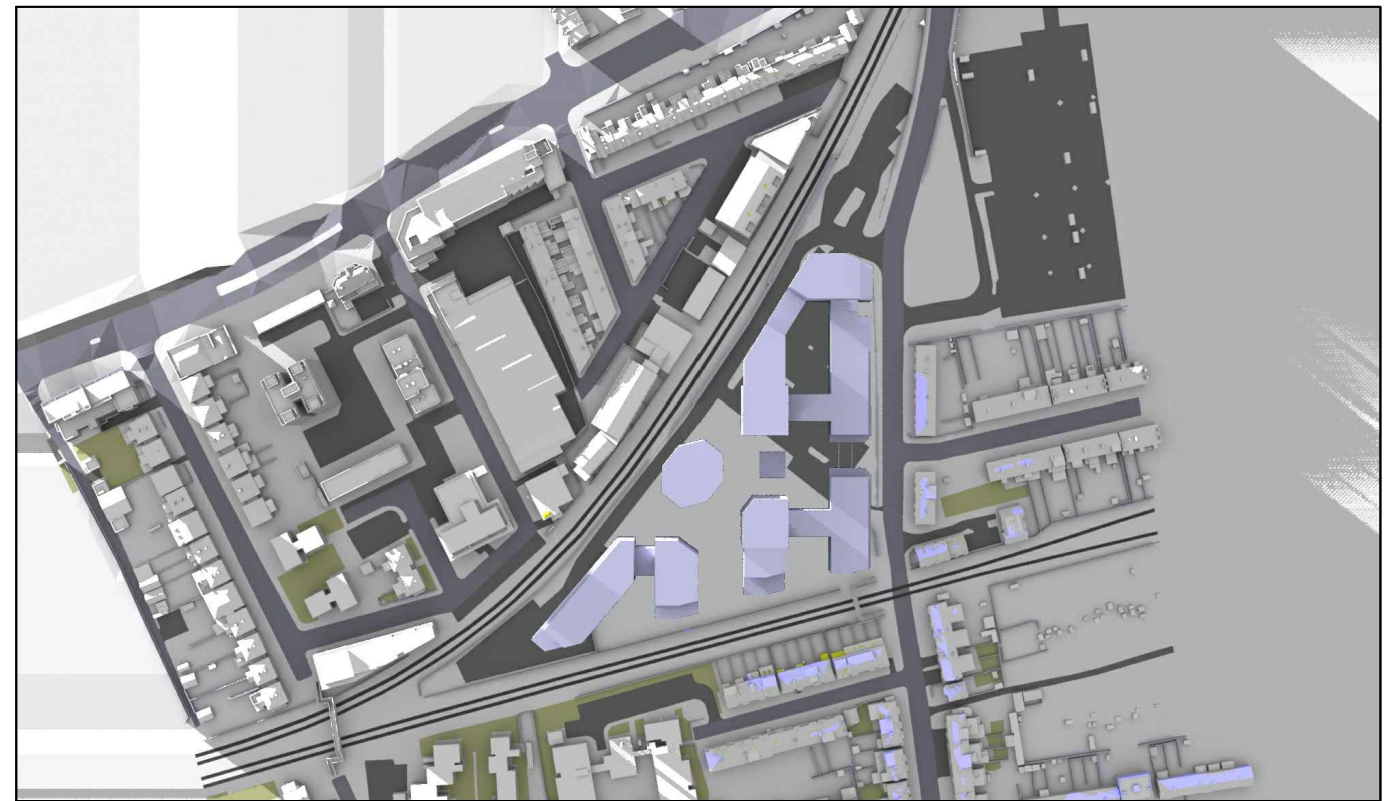

Proposed 09:00pm

Sources: Point 2 Surveyors
 Survey Info
 Point Cloud Data
 Assael Architecture Limited
 Proposed Info (received 10/01/19)
 A3004_Combined Model_Simple.skp

Key:

- Grey shadows are those caused by buildings which are not on the site under development.
- Green shadows are those caused specifically by the consented buildings on the site.
- Blue shadows are those caused specifically by the proposed development.

Project: Homebase
 Richmond

Title: Transient Overshadowing

Point 2 Surveyors Ltd,
 3rd Floor,
 17 Slingsby Place,
 London WC2E 9AB,
 0207 836 5828
 www.point2surveyors.com

Drawn By: SDJ

Scale: NTS

Date: Jan 19

Dwg No: **P1685/JUN01/08**

Rel: 06

