

518200

518400

518600

518800

176000

176000

175800

175800

175600

175600

FAIRHURST

Historical Aerial Photography

Published 1999

This aerial photography was produced by Getmapping, these vertical aerial photographs provide a seamless, full colour survey of the whole of Great Britain



Historical Aerial Photography - Segment A10

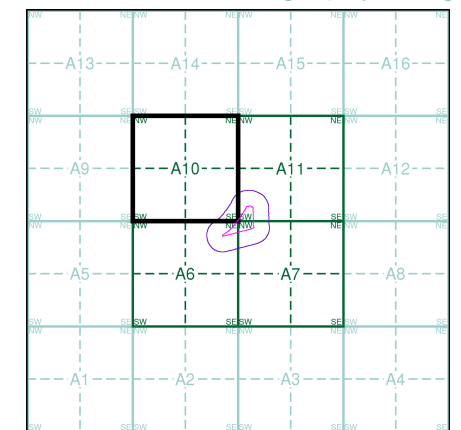

Order Details

Order Number: 142584674_1_1
 Customer Ref: Homebase, Richmond
 National Grid Reference: 518890, 175430
 Slice: A
 Site Area (Ha): 1.58
 Search Buffer (m): 100

Site Details

Homebase Ltd, 84, Manor Road, RICHMOND, TW9 1YB

Landmark
 INFORMATION GROUP

Tel: 0844 844 9952
 Fax: 0844 844 9951
 Web: www.envirocheck.co.uk

Historical Mapping Legends

Ordnance Survey County Series and Ordnance Survey Plan 1:2,500

Quarry **Gravel Pit** **Sand Pit**
Clay Pit **Shingle** **Refuse Heap**
Sloping Masonry **Flat Rock**
Marsh **Reeds** **Osiers**
Rough Pasture **Furze** **Wood**
Mixed Wood **Brushwood** **Orchard**
Fir **Ford** **Stepping Stones**
Ferry **Waterfall** **Lock**
Trig. Station **Altitude at Trig. Station**
B.M. 325.9 **Bench Mark** **Surface Level**
Arrow denotes flow of water **Antiquities (site of)**
Cutting **Embankment**
Railway crossing Road **Level Crossing** **Road crossing Railway**
Railway crossing River or Canal **Road over single stream** **Road over River or Canal**
County Boundary (Geographical)
County & Civil Parish Boundary
Administrative County & Civil Parish Boundary
County Borough Boundary (England)
County Burgh Boundary (Scotland)
Co. Boro. Bdy.
Co. Burgh Bdy.
BP BS Boundary Post or Stone **P.C.B** Police Call Box
B.R. Bridle Road **P** Pump
E.P Electricity Pylon **S.P** Signal Post
F.B. Foot Bridge **SL** Sluice
F.P. Foot Path **Sp.** Spring
G.P Guide Post or Board **T.C.B** Telephone Call Box
M.S Mile Stone **Tr.** Trough
M.P M.R Mooring Post or Ring **W** Well

Ordnance Survey Plan, Additional SIMs and Supply of Unpublished Survey Information 1:2,500 and 1:1,250

Inactive Quarry, Chalk Pit or Clay Pit **Active Quarry, Chalk Pit or Clay Pit**
Rock **Boulders**
Cliff **Slopes** **Top**
Roofed Building **Glazed Roof Building**
Sloping Masonry **Archway**
Non-Coniferous Tree (surveyed) **Coniferous Tree (surveyed)**
Non-Coniferous Trees (not surveyed) **Coniferous Trees (not surveyed)**
Orchard Tree **Scrub** **Bracken**
Coppice, Osier **Reeds** **Marsh, Saltings**
Rough Grassland **Heath** **Culvert**
Direction of water flow **Bench Mark** **Antiquity (site of)**
Cave Entrance **Triangulation Station** **Electricity Pylon**
Electricity Transmission Line
County Boundary (Geographical)
County & Civil Parish Boundary
Civil Parish Boundary
Admin. County or County Bor. Boundary
London Borough Boundary
Symbol marking point where boundary mereing changes
BH Beer House **P** Pillar, Pole or Post
BP, BS Boundary Post or Stone **PO** Post Office
Cn, C Capstan, Crane **PC** Public Convenience
Chy Chimney **PH** Public House
D Fn Drinking Fountain **Pp** Pump
EI P Electricity Pillar or Post **SB, S Br** Signal Box or Bridge
FAP Fire Alarm Pillar **SP, SL** Signal Post or Light
FB Foot Bridge **Spr** Spring
GP Guide Post **Tk** Tank or Track
H Hydrant or Hydraulic **TCB** Telephone Call Box
LC Level Crossing **TCP** Telephone Call Post
MH Manhole **Tr** Trough
MP Mile Post or Mooring Post **Wr Pt, Wr T** Water Point, Water Tap
MS Mile Stone **W** Well
NTL Normal Tidal Limit **Wd Pp** Wind Pump

Large-Scale National Grid Data 1:2,500 and 1:1,250

Cliff **Slopes** **Top**
Rock **Rock (scattered)**
Boulders **Boulders (scattered)**
Positioned Boulder **Scree**
Non-Coniferous Tree (surveyed) **Coniferous Tree (surveyed)**
Non-Coniferous Trees (not surveyed) **Coniferous Trees (not surveyed)**
Orchard Tree **Scrub** **Bracken**
Coppice, Osier **Reeds** **Marsh, Saltings**
Rough Grassland **Heath** **Culvert**
Direction of water flow **Triangulation Station** **Antiquity (site of)**
Electricity Transmission Line **Electricity Pylon**
B.M. 231.60m Bench Mark **Buildings with Building Seed**
Roofed Building **Glazed Roof Building**
Civil parish/community boundary
District boundary
County boundary
Boundary post/stone
Boundary mereing symbol (note: these always appear in opposed pairs or groups of three)
Bks Barracks **P** Pillar, Pole or Post
Bty Battery **PO** Post Office
Cemy Cemetery **PC** Public Convenience
Chy Chimney **Pp** Pump
Cis Cistern **Ppg Sta** Pumping Station
Dismtd Rly Dismantled Railway **PW** Place of Worship
EI Gen Sta Electricity Generating Station **Sewage Ppg Sta** Sewage Pumping Station
EI P Electricity Pole, Pillar **SB, S Br** Signal Box or Bridge
EI Sub Sta Electricity Sub Station **SP, SL** Signal Post or Light
FB Filter Bed **Spr** Spring
Fn / D Fn Fountain / Drinking Ftn. **Tk** Tank or Track
Gas Gov Gas Valve Compound **Tr** Trough
GVC Gas Governor **Wd Pp** Wind Pump
GP Guide Post **Wr Pt, Wr T** Water Point, Water Tap
MH Manhole **Wks** Works (building or area)
MP, MS Mile Post or Mile Stone **W** Well

FAIRHURST

Historical Mapping & Photography included:

Mapping Type	Scale	Date	Pg
Surrey	1:2,500	1869 - 1879	2
Middlesex	1:2,500	1871	3
London	1:2,500	1896	4
Surrey	1:2,500	1898	5
Surrey	1:2,500	1913	6
Middlesex	1:2,500	1915	7
Surrey	1:2,500	1935 - 1936	8
Middlesex	1:2,500	1935	9
Historical Aerial Photography	1:1,250	1947	10
Ordnance Survey Plan	1:1,250	1959 - 1960	11
Additional SIMs	1:1,250	1959 - 1980	12
Ordnance Survey Plan	1:2,500	1960	13
Additional SIMs	1:2,500	1960	14
Supply of Unpublished Survey Information	1:1,250	1973 - 1974	15
Additional SIMs	1:1,250	1973 - 1991	16
Ordnance Survey Plan	1:1,250	1974 - 1991	17
Additional SIMs	1:1,250	1983	18
Additional SIMs	1:1,250	1989	19
Large-Scale National Grid Data	1:1,250	1991	20
Large-Scale National Grid Data	1:1,250	1992	21
Historical Aerial Photography	1:2,500	1999	22

Historical Map - Segment A7

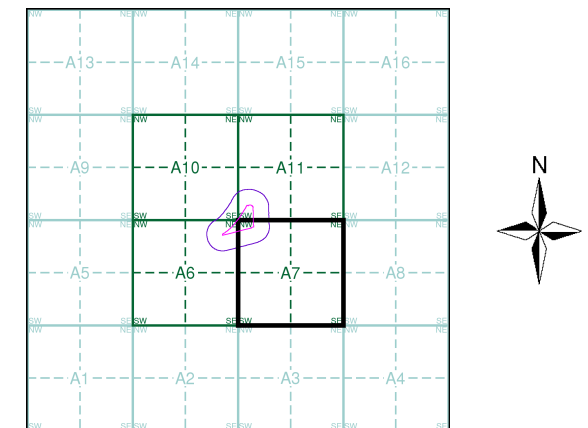

Order Details

Order Number: 142584674_1_1
 Customer Ref: Homebase, Richmond
 National Grid Reference: 518890, 175430
 Slice: A
 Site Area (Ha): 1.58
 Search Buffer (m): 100

Site Details

Homebase Ltd, 84, Manor Road, RICHMOND, TW9 1YB

Landmark
 INFORMATION GROUP

Tel: 0844 844 9952
 Fax: 0844 844 9951
 Web: www.envirocheck.co.uk

FAIRHURST

Middlesex

Published 1871

Source map scale - 1:2,500

The historical maps shown were reproduced from maps predominantly held at the scale adopted for England, Wales and Scotland in the 1840's. In 1854 the 1:2,500 scale was adopted for mapping urban areas and by 1896 it covered the whole of what were considered to be the cultivated parts of Great Britain. The published date given below is often some years later than the surveyed date. Before 1938, all OS maps were based on the Cassini Projection, with independent surveys of a single county or group of counties, giving rise to significant inaccuracies in outlying areas.

Map Name(s) and Date(s)

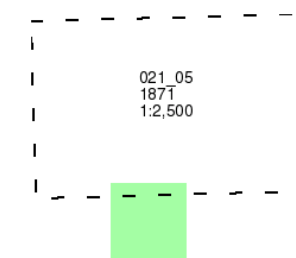

Historical Map - Segment A7

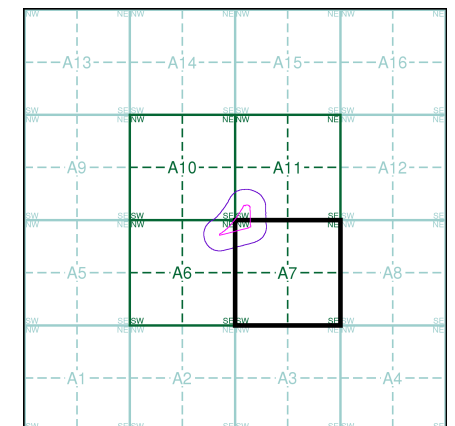

Order Details

Order Number: 142584674_1_1
Customer Ref: Homebase, Richmond
National Grid Reference: 518890, 175430
Slice: A
Site Area (Ha): 1.58
Search Buffer (m): 100

Site Details

Homebase Ltd, 84, Manor Road, RICHMOND, TW9 1YB

Landmark[®]
INFORMATION GROUP

Tel: 0844 844 9952
Fax: 0844 844 9951
Web: www.envirocheck.co.uk

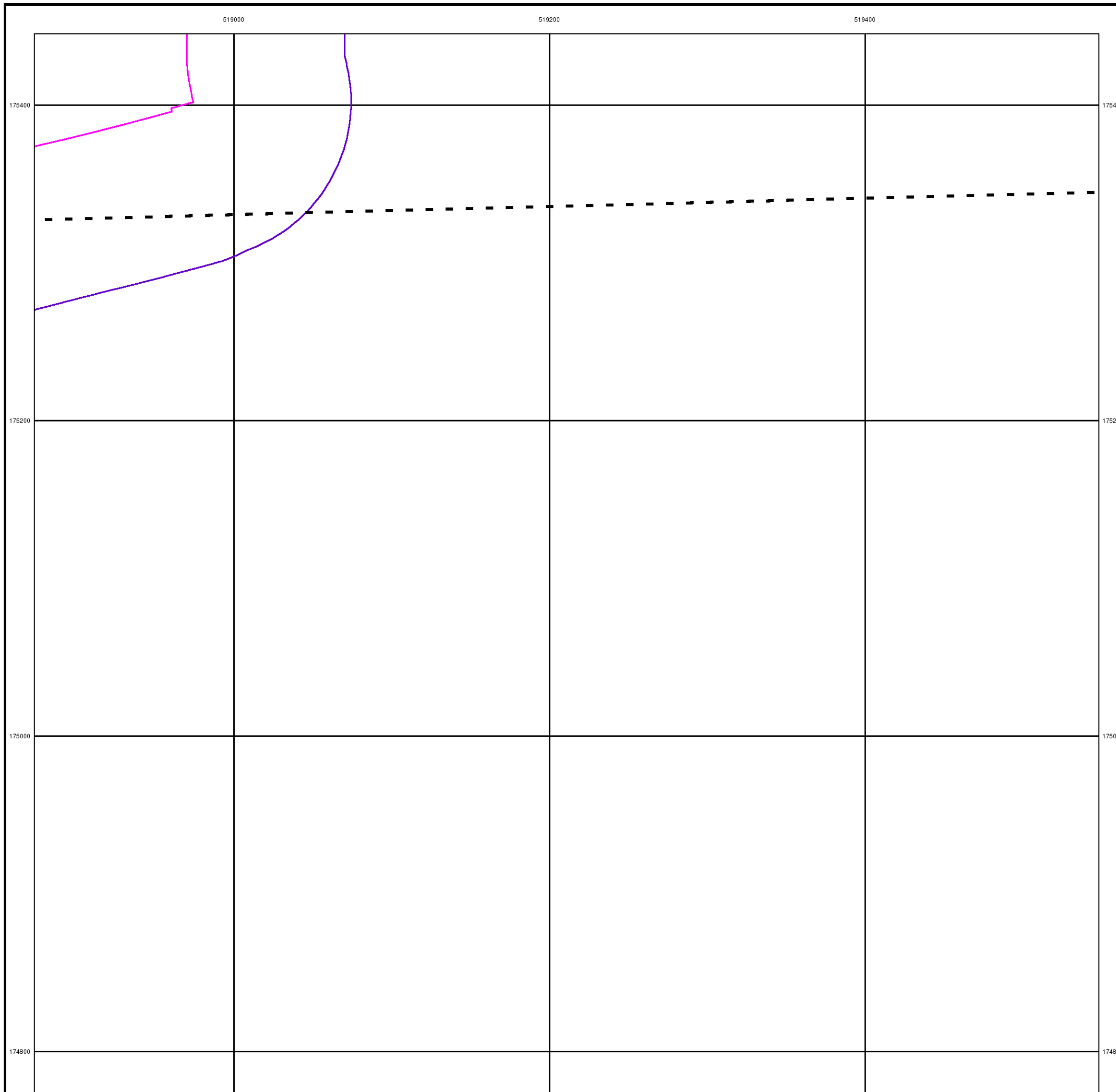

FAIRHURST

London

Published 1896

Source map scale - 1:2,500

The historical maps shown were reproduced from maps predominantly held at the scale adopted for England, Wales and Scotland in the 1840's. In 1854 the 1:2,500 scale was adopted for mapping urban areas and by 1896 it covered the whole of what were considered to be the cultivated parts of Great Britain. The published date given below is often some years later than the surveyed date. Before 1938, all OS maps were based on the Cassini Projection, with independent surveys of a single county or group of counties, giving rise to significant inaccuracies in outlying areas.

Map Name(s) and Date(s)

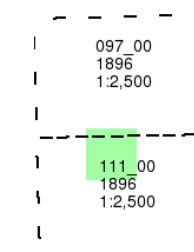

Historical Map - Segment A7

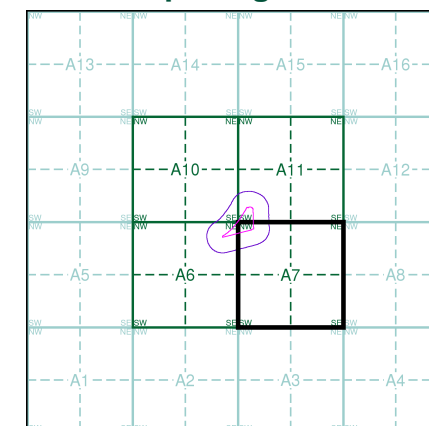

Order Details

Order Number: 142584674_1_1
Customer Ref: Homebase, Richmond
National Grid Reference: 518890, 175430
Slice: A
Site Area (Ha): 1.58
Search Buffer (m): 100

Site Details

Homebase Ltd, 84, Manor Road, RICHMOND, TW9 1YB

Landmark
INFORMATION GROUP

Tel: 0844 844 9952
Fax: 0844 844 9951
Web: www.envirocheck.co.uk

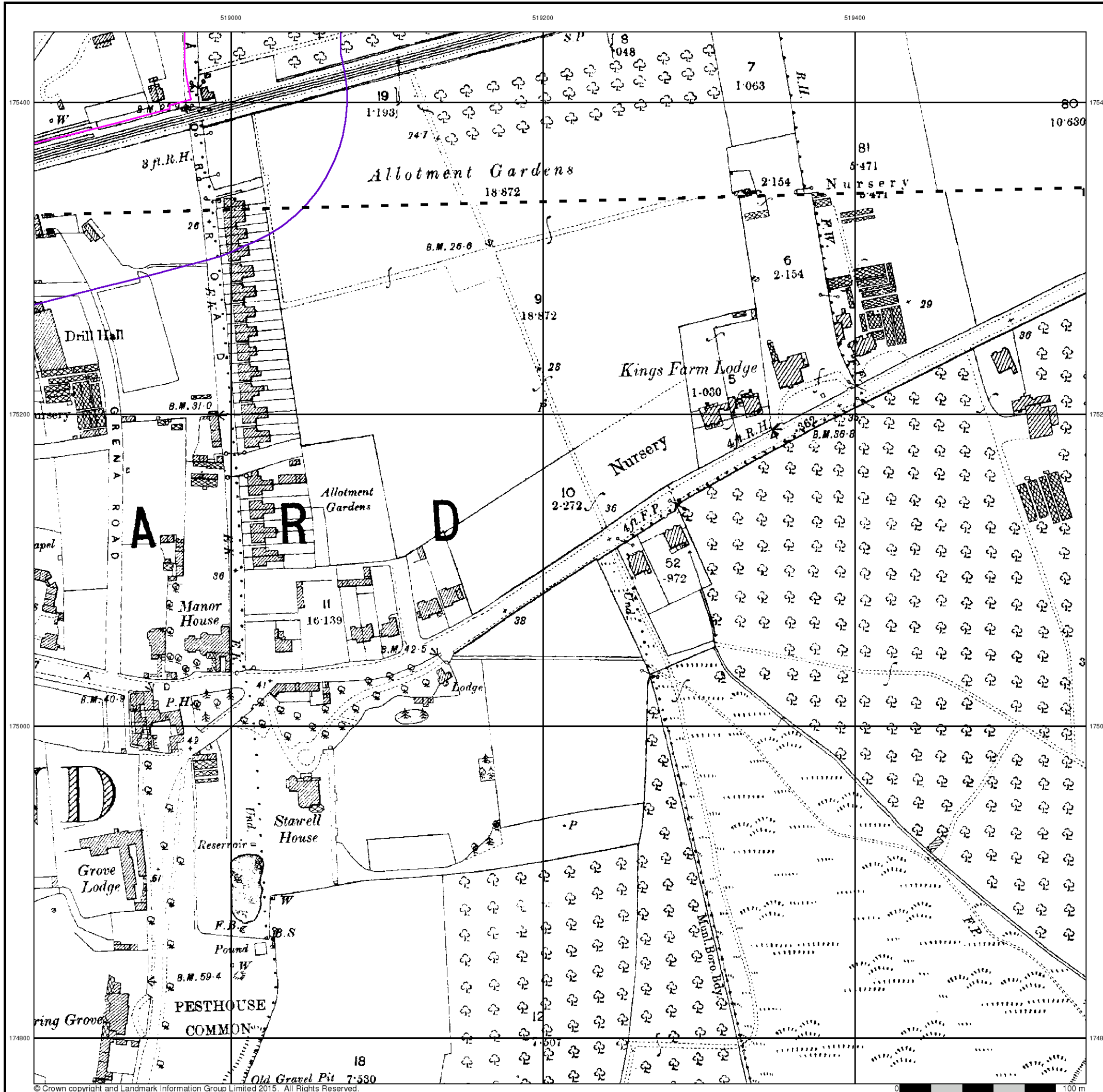

FAIRHURST

Surrey

Published 1898

Source map scale - 1:2,500

The historical maps shown were reproduced from maps predominantly held at the scale adopted for England, Wales and Scotland in the 1840's. In 1854 the 1:2,500 scale was adopted for mapping urban areas and by 1896 it covered the whole of what were considered to be the cultivated parts of Great Britain. The published date given below is often some years later than the surveyed date. Before 1938, all OS maps were based on the Cassini Projection, with independent surveys of a single county or group of counties, giving rise to significant inaccuracies in outlying areas.

Map Name(s) and Date(s)

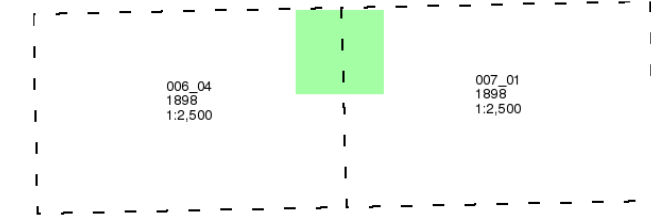

Historical Map - Segment A7

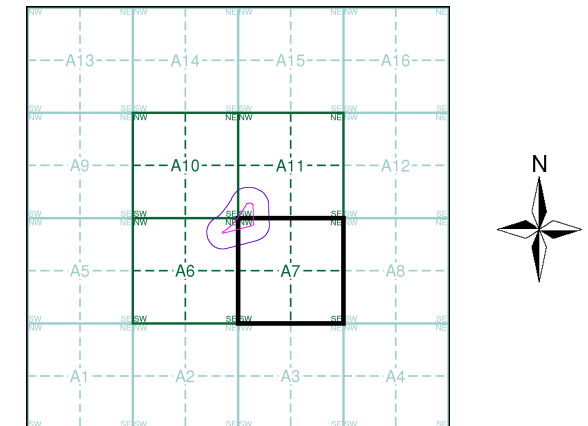

Order Details

Order Number: 142584674_1_1
 Customer Ref: Homebase, Richmond
 National Grid Reference: 518890, 175430
 Slice: A
 Site Area (Ha): 1.58
 Search Buffer (m): 100

Site Details

Homebase Ltd, 84, Manor Road, RICHMOND, TW9 1YB

Landmark
 INFORMATION GROUP

Tel: 0844 844 9952
 Fax: 0844 844 9951
 Web: www.envirocheck.co.uk

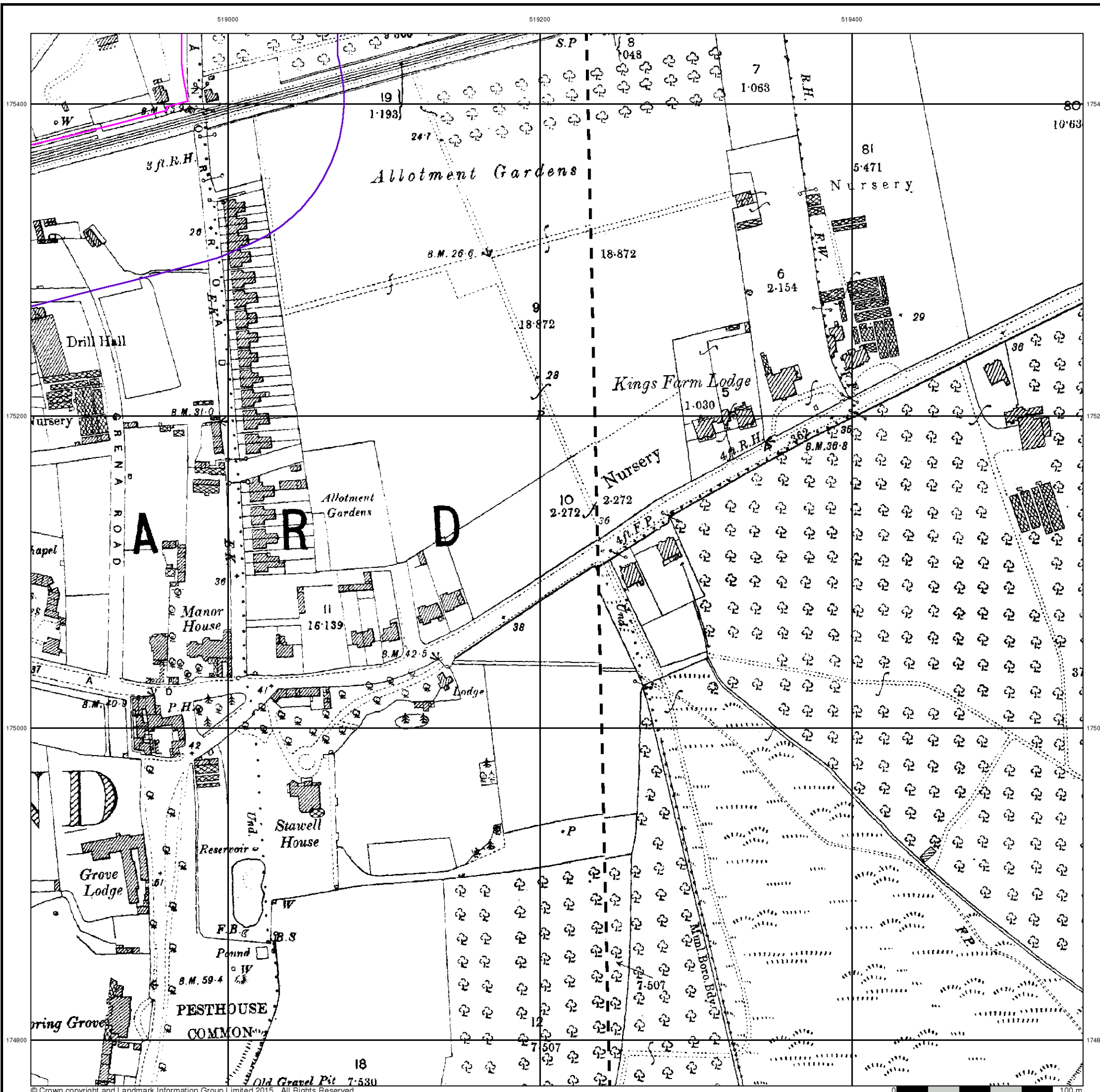

FAIRHURST

Surrey

Published 1913

Source map scale - 1:2,500

The historical maps shown were reproduced from maps predominantly held at the scale adopted for England, Wales and Scotland in the 1840's. In 1854 the 1:2,500 scale was adopted for mapping urban areas and by 1896 it covered the whole of what were considered to be the cultivated parts of Great Britain. The published date given below is often some years later than the surveyed date. Before 1938, all OS maps were based on the Cassini Projection, with independent surveys of a single county or group of counties, giving rise to significant inaccuracies in outlying areas.

Map Name(s) and Date(s)

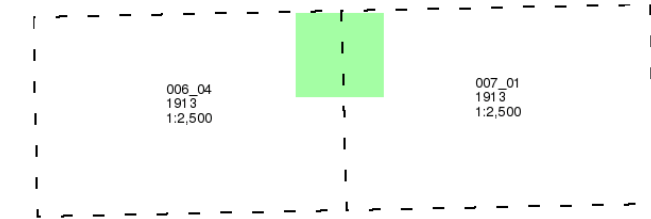

Historical Map - Segment A7

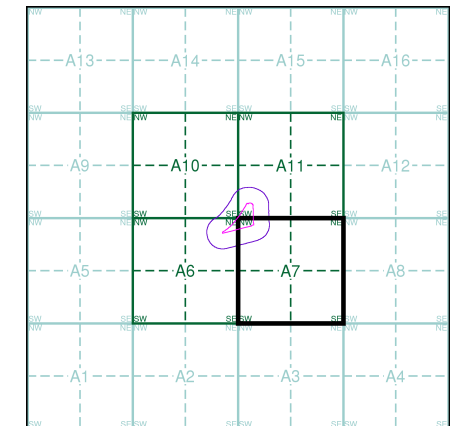

Order Details

Order Number: 142584674_1_1
Customer Ref: Homebase, Richmond
National Grid Reference: 518890, 175430
Slice: A
Site Area (Ha): 1.58
Search Buffer (m): 100

Site Details

Homebase Ltd, 84, Manor Road, RICHMOND, TW9 1YB

Landmark
INFORMATION GROUP

Tel: 0844 844 9952
Fax: 0844 844 9951
Web: www.envirocheck.co.uk

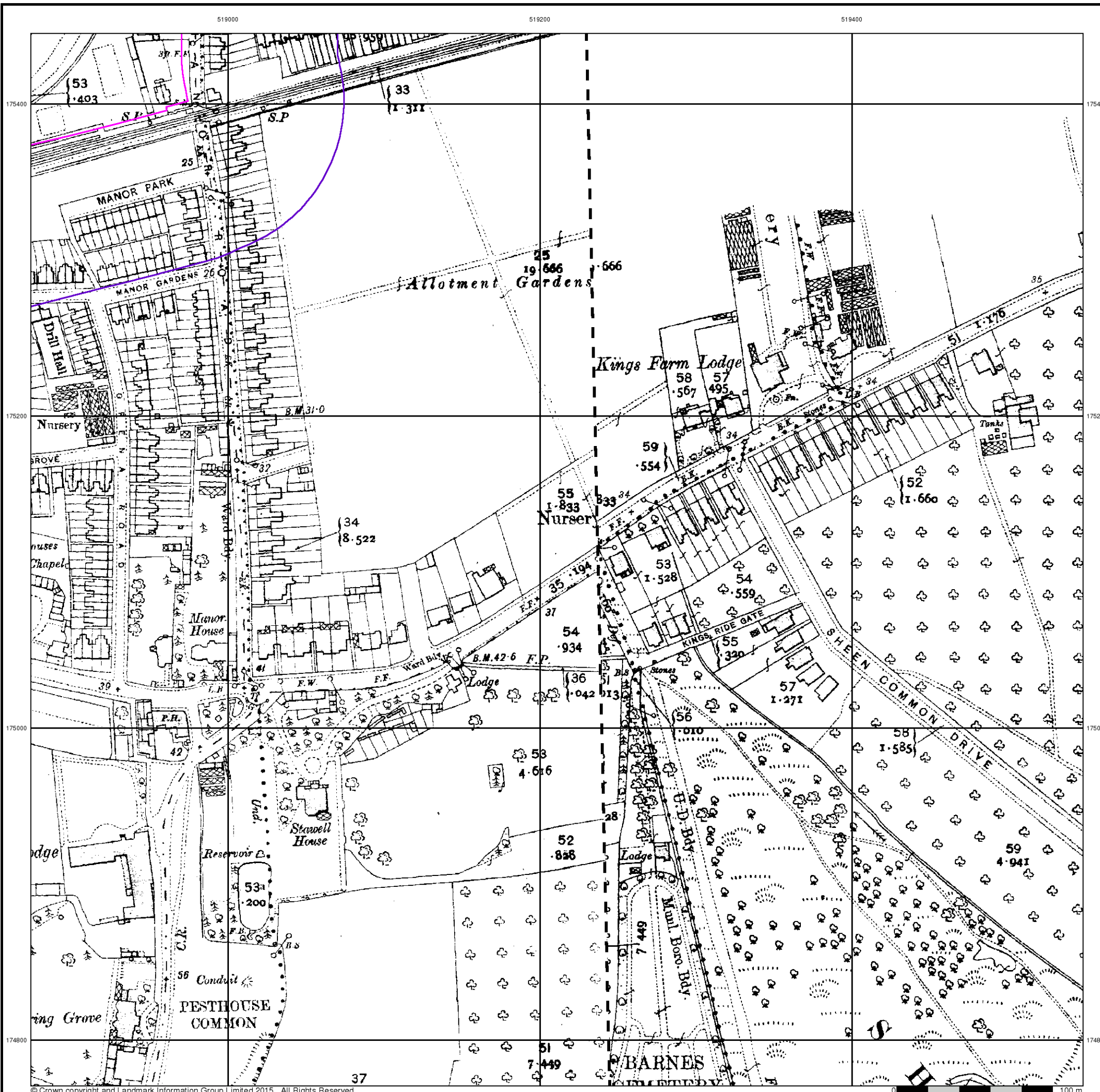

FAIRHURST

Middlesex

Published 1915

Source map scale - 1:2,500

The historical maps shown were reproduced from maps predominantly held at the scale adopted for England, Wales and Scotland in the 1840's. In 1854 the 1:2,500 scale was adopted for mapping urban areas and by 1896 it covered the whole of what were considered to be the cultivated parts of Great Britain. The published date given below is often some years later than the surveyed date. Before 1938, all OS maps were based on the Cassini Projection, with independent surveys of a single county or group of counties, giving rise to significant inaccuracies in outlying areas.

Map Name(s) and Date(s)

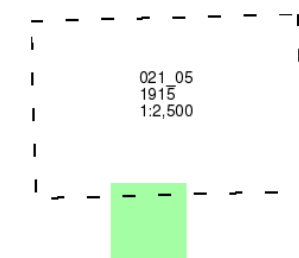

Historical Map - Segment A7

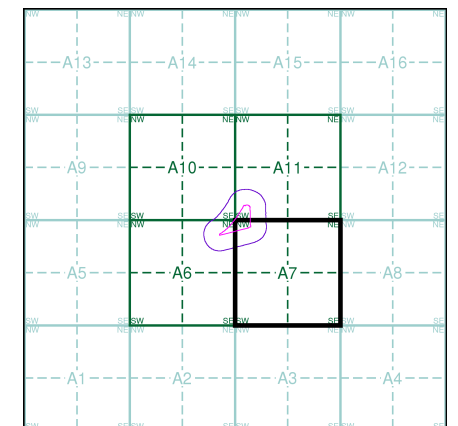

Order Details

Order Number: 142584674_1_1
Customer Ref: Homebase, Richmond
National Grid Reference: 518890, 175430
Slice: A
Site Area (Ha): 1.58
Search Buffer (m): 100

Site Details

Homebase Ltd, 84, Manor Road, RICHMOND, TW9 1YB

Landmark
INFORMATION GROUP

Tel: 0844 844 9952
Fax: 0844 844 9951
Web: www.envirocheck.co.uk

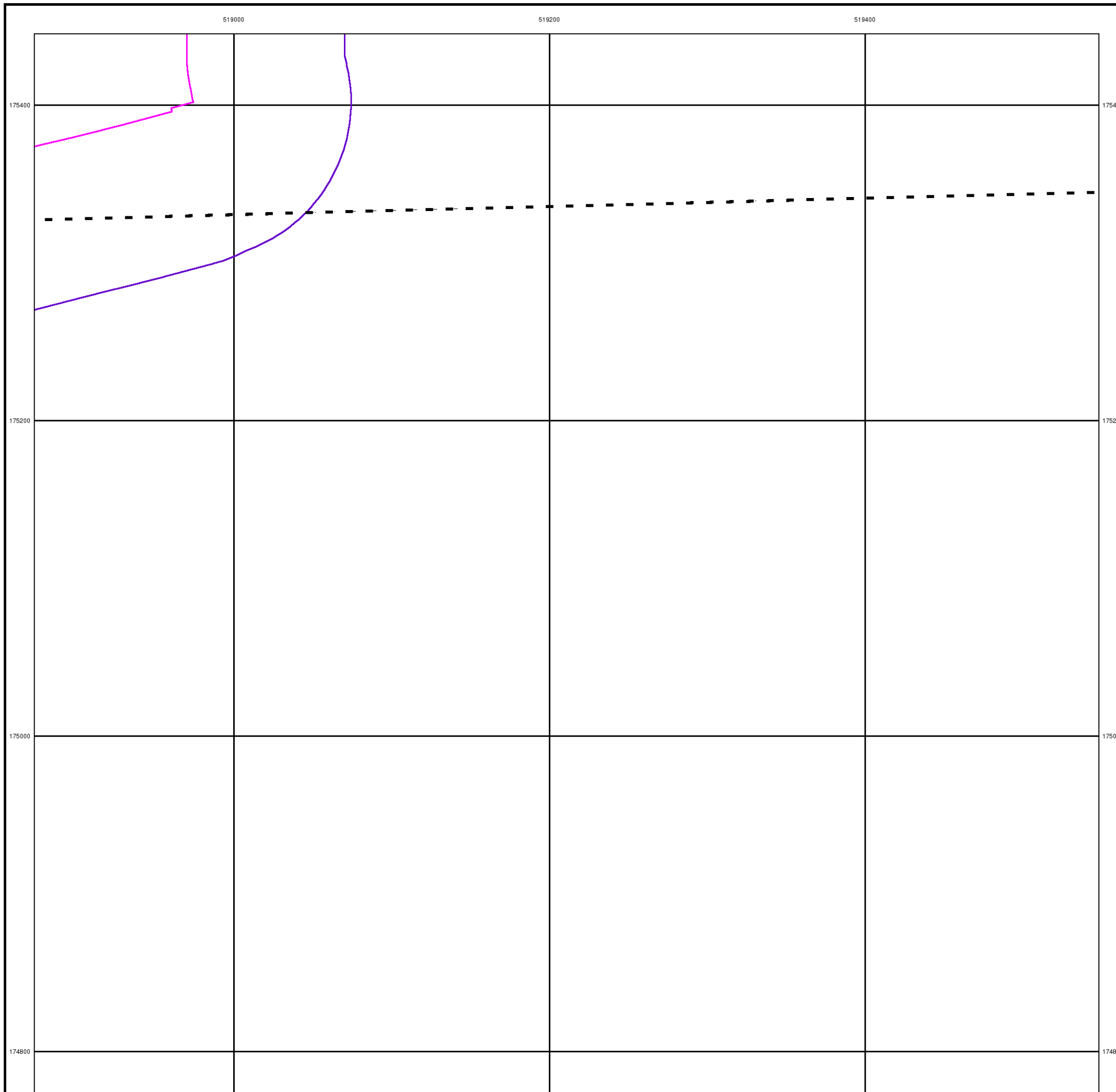

FAIRHURST

Surrey

Published 1935 - 1936

Source map scale - 1:2,500

The historical maps shown were reproduced from maps predominantly held at the scale adopted for England, Wales and Scotland in the 1840's. In 1854 the 1:2,500 scale was adopted for mapping urban areas and by 1896 it covered the whole of what were considered to be the cultivated parts of Great Britain. The published date given below is often some years later than the surveyed date. Before 1938, all OS maps were based on the Cassini Projection, with independent surveys of a single county or group of counties, giving rise to significant inaccuracies in outlying areas.

Map Name(s) and Date(s)

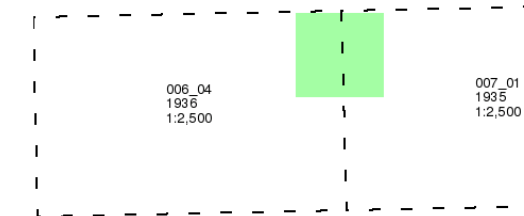

Historical Map - Segment A7

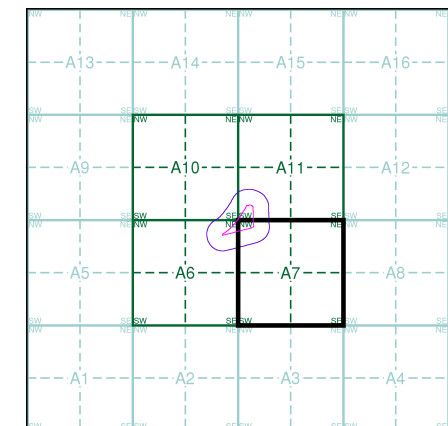

Order Details

Order Number: 142584674_1_1
Customer Ref: Homebase, Richmond
National Grid Reference: 518890, 175430
Slice: A
Site Area (Ha): 1.58
Search Buffer (m): 100

Site Details

Homebase Ltd, 84, Manor Road, RICHMOND, TW9 1YB

Landmark
INFORMATION GROUP

Tel: 0844 844 9952
Fax: 0844 844 9951
Web: www.envirocheck.co.uk

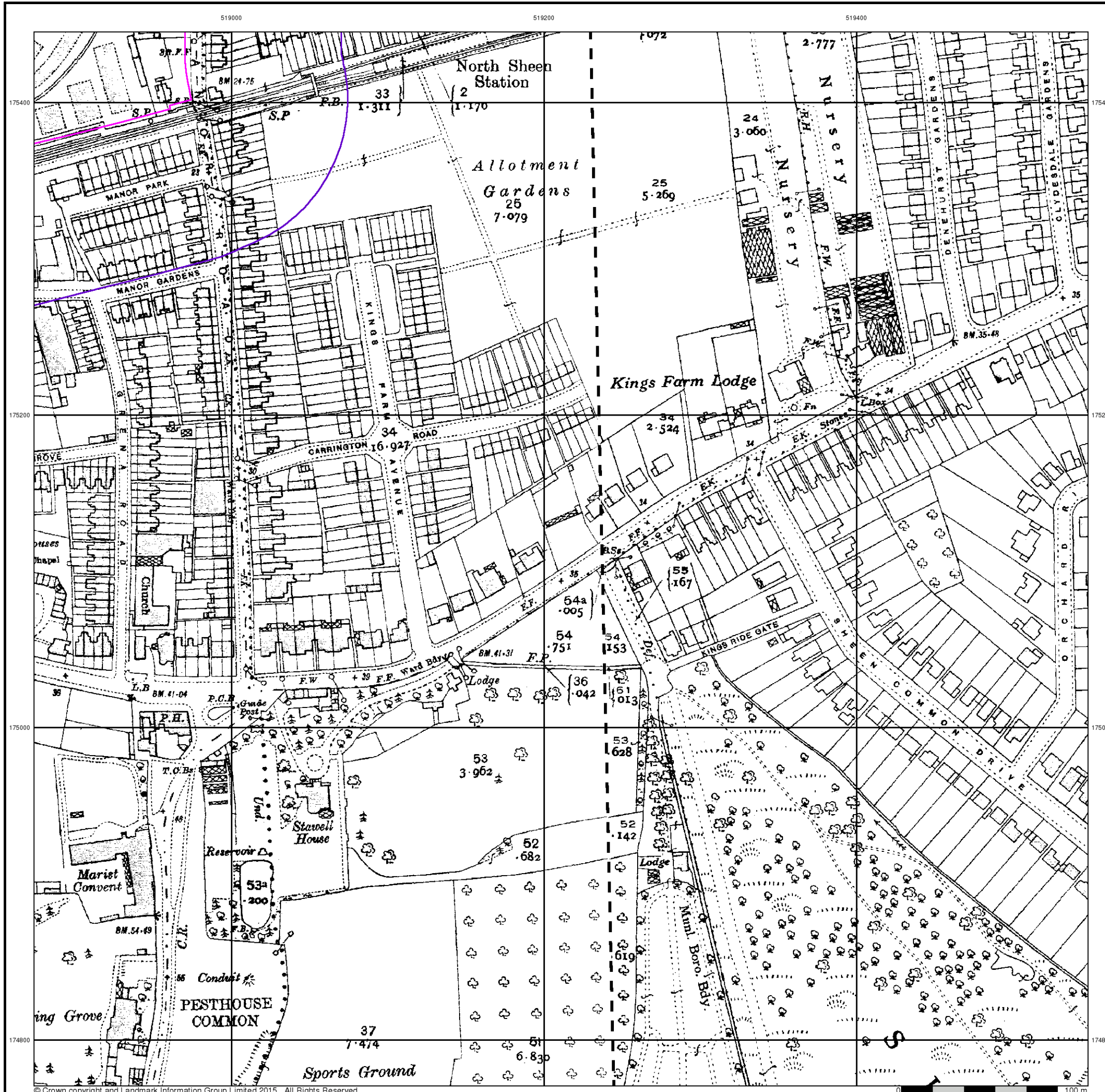

FAIRHURST

Middlesex

Published 1935

Source map scale - 1:2,500

The historical maps shown were reproduced from maps predominantly held at the scale adopted for England, Wales and Scotland in the 1840's. In 1854 the 1:2,500 scale was adopted for mapping urban areas and by 1896 it covered the whole of what were considered to be the cultivated parts of Great Britain. The published date given below is often some years later than the surveyed date. Before 1938, all OS maps were based on the Cassini Projection, with independent surveys of a single county or group of counties, giving rise to significant inaccuracies in outlying areas.

Map Name(s) and Date(s)

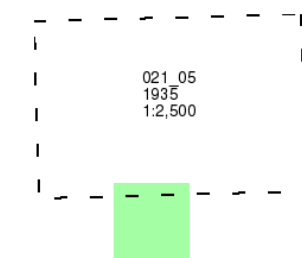

Historical Map - Segment A7

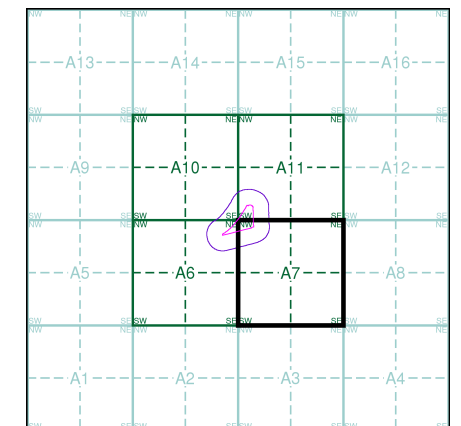

Order Details

Order Number: 142584674_1_1
Customer Ref: Homebase, Richmond
National Grid Reference: 518890, 175430
Slice: A
Site Area (Ha): 1.58
Search Buffer (m): 100

Site Details

Homebase Ltd, 84, Manor Road, RICHMOND, TW9 1YB

Landmark
INFORMATION GROUP

Tel: 0844 844 9952
Fax: 0844 844 9951
Web: www.envirocheck.co.uk

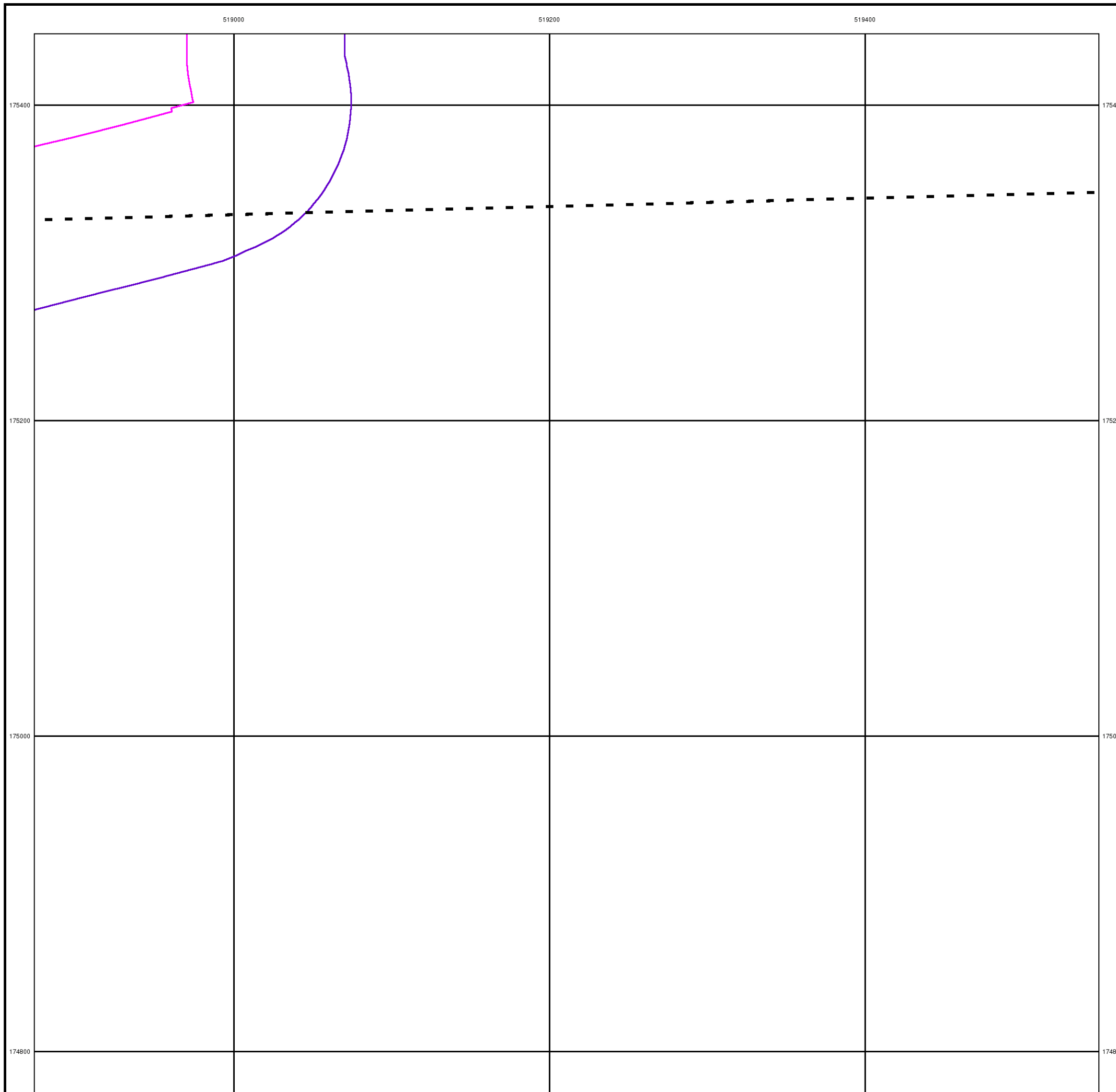

FAIRHURST

Historical Aerial Photography

Published 1947

Source map scale - 1:1,250

The Historical Aerial Photos were produced by the Ordnance Survey at a scale of 1:1,250 and 1:10,560 from Air Force photography. They were produced between 1944 and 1951 as an interim measure, pending preparation of conventional mapping, due to post war resource shortages. New security measures in the 1950's meant that every photograph was re-checked for potentially unsafe information with security sites replaced by fake fields or clouds. The original editions were withdrawn and only later made available after a period of fifty years although due to the accuracy of the editing, without viewing both revisions it is not easy to spot the edits. Where available Landmark have included both revisions.

© THE BRITISH LIBRARY BOARD. ALL RIGHTS RESERVED. Licence No:8048

Map Name(s) and Date(s)

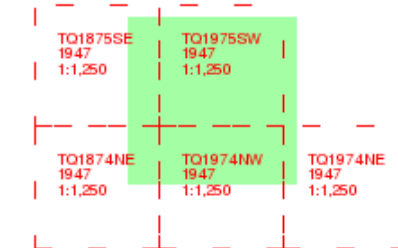

Historical Aerial Photography - Segment A7

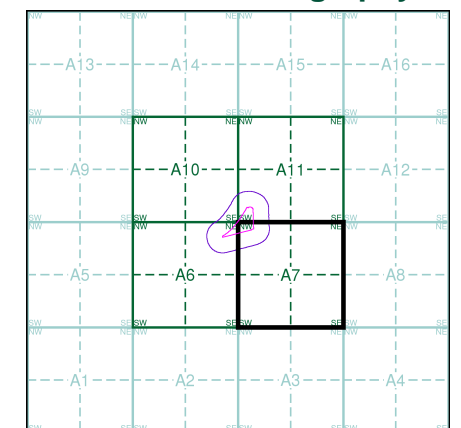

LIBRARY
HSILIRB

Order Details

Order Number: 142584674_1_1
Customer Ref: Homebase, Richmond
National Grid Reference: 518890, 175430
Slice: A
Site Area (Ha): 1.58
Search Buffer (m): 100

Site Details

Homebase Ltd, 84, Manor Road, RICHMOND, TW9 1YB

Landmark
INFORMATION GROUP

Tel: 0844 844 9952
Fax: 0844 844 9951
Web: www.envirocheck.co.uk

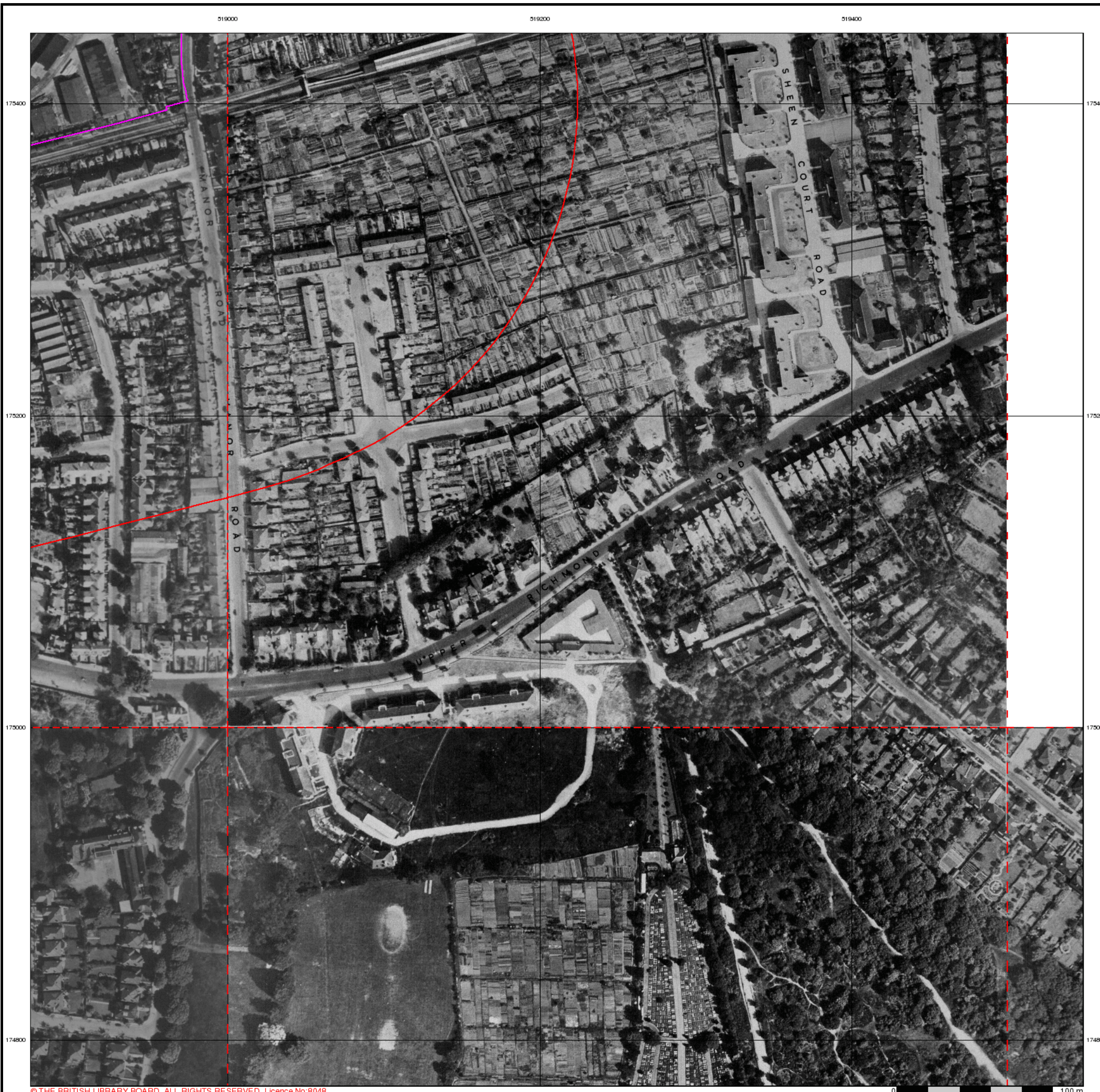

© THE BRITISH LIBRARY BOARD. ALL RIGHTS RESERVED. Licence No:8048

FAIRHURST

Ordnance Survey Plan

Published 1959 - 1960

Source map scale - 1:1,250

The historical maps shown were reproduced from maps predominantly held at the scale adopted for England, Wales and Scotland in the 1840's. In 1854 the 1:2,500 scale was adopted for mapping urban areas and by 1896 it covered the whole of what were considered to be the cultivated parts of Great Britain. The published date given below is often some years later than the surveyed date. Before 1938, all OS maps were based on the Cassini Projection, with independent surveys of a single county or group of counties, giving rise to significant inaccuracies in outlying areas.

Map Name(s) and Date(s)

TQ1875SE 1960 1:1,250	TQ1975SW 1960 1:1,250	TQ1975SE 1960 1:1,250
TQ1874NE 1960 1:1,250	TQ1974NW 1959 1:1,250	TQ1974NE 1959 1:1,250

Historical Map - Segment A7

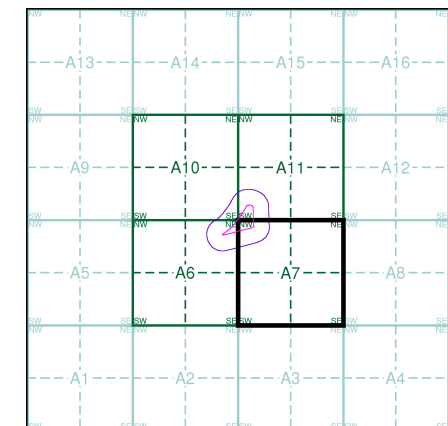

Order Details

Order Number: 142584674_1_1
 Customer Ref: Homebase, Richmond
 National Grid Reference: 518890, 175430
 Slice: A
 Site Area (Ha): 1.58
 Search Buffer (m): 100

Site Details

Homebase Ltd, 84, Manor Road, RICHMOND, TW9 1YB

Landmark
 INFORMATION GROUP

Tel: 0844 844 9952
 Fax: 0844 844 9951
 Web: www.envirocheck.co.uk

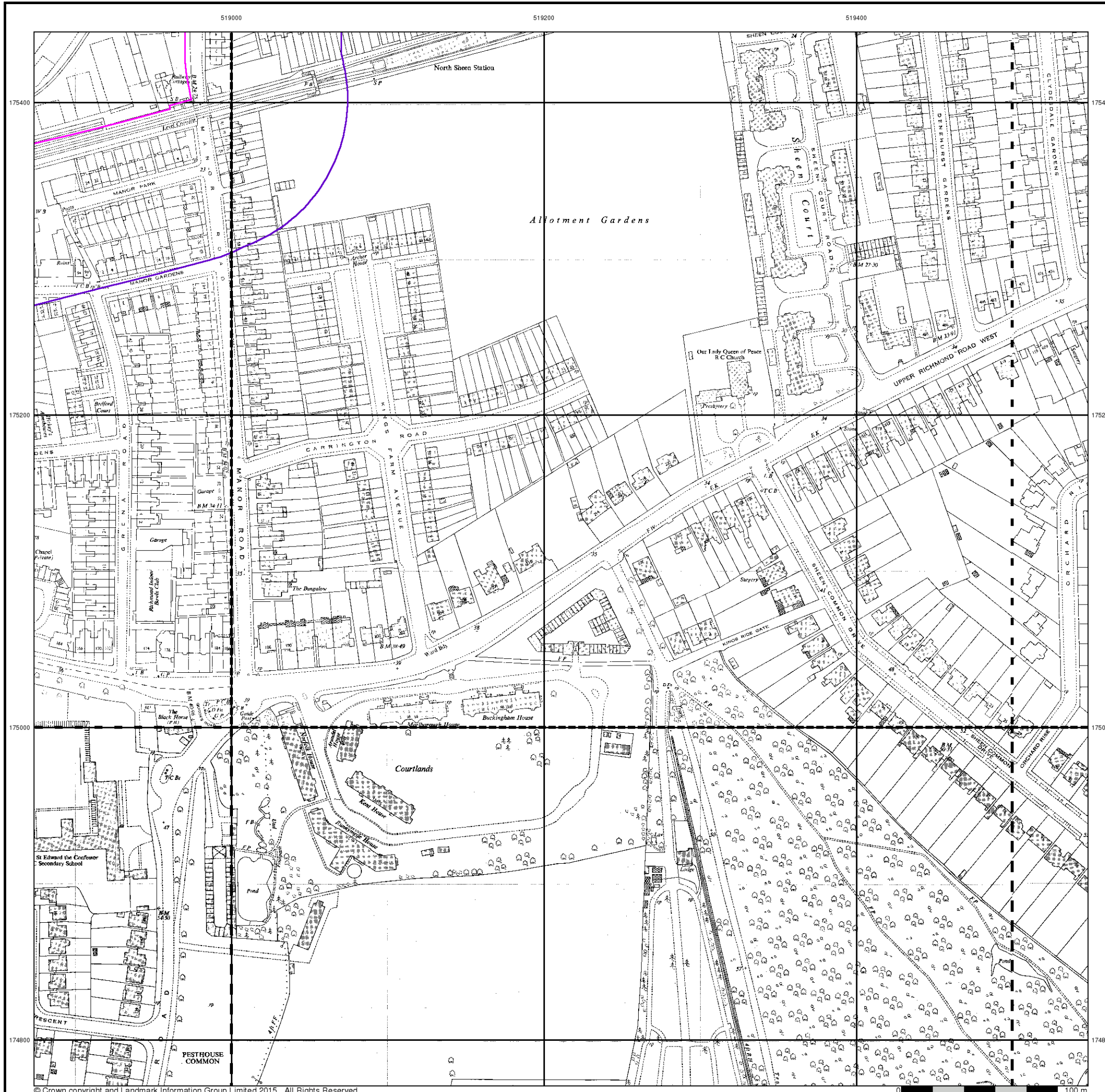

FAIRHURST

Additional SIMs

Published 1959 - 1980

Source map scale - 1:1,250

The SIM cards (Ordnance Survey's 'Survey of Information on Microfilm') are further, minor editions of mapping which were produced and published in between the main editions as an area was updated. They date from 1947 to 1994, and contain detailed information on buildings, roads and land-use. These maps were produced at both 1:2,500 and 1:1,250 scales.

Map Name(s) and Date(s)

TQ1875SE 1960 1:1,250	TQ1975SW 1980 1:1,250	TQ1975SE 1960 1:1,250
TQ1874NE 1971 1:1,250	TQ1974NW 1974 1:1,250	TQ1974NE 1959 1:1,250

Historical Map - Segment A7

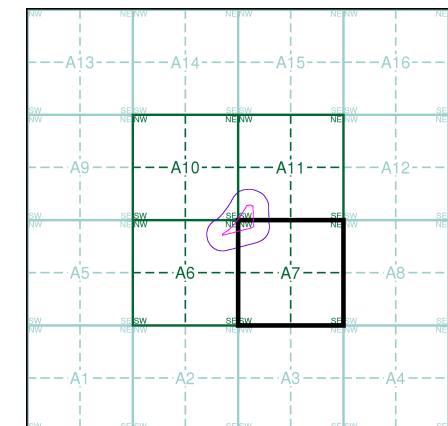

Order Details

Order Number: 142584674_1_1
Customer Ref: Homebase, Richmond
National Grid Reference: 518890, 175430
Slice: A
Site Area (Ha): 1.58
Search Buffer (m): 100

Site Details

Homebase Ltd, 84, Manor Road, RICHMOND, TW9 1YB

Landmark
INFORMATION GROUP

Tel: 0844 844 9952
Fax: 0844 844 9951
Web: www.envirocheck.co.uk

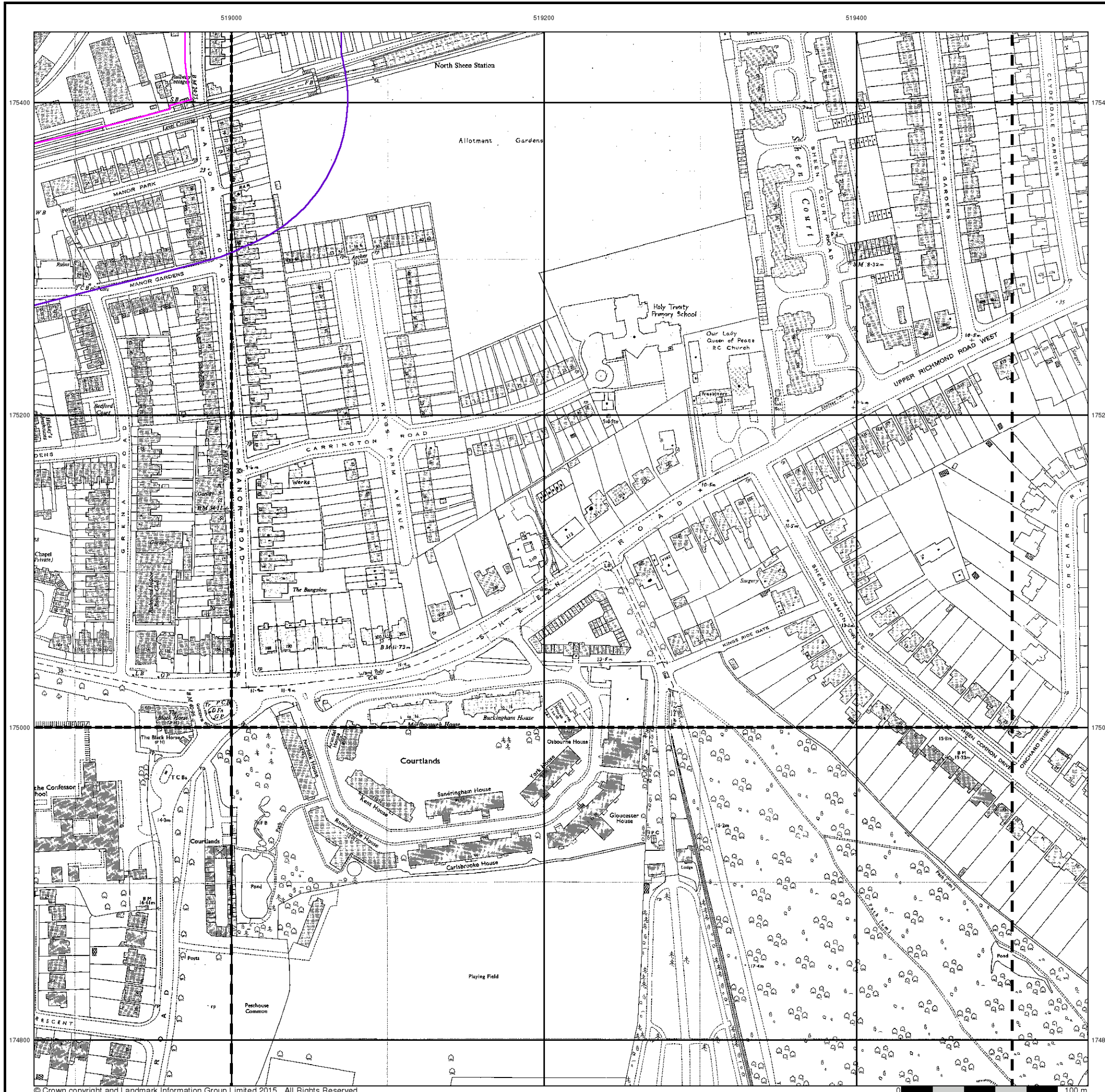

FAIRHURST

Ordnance Survey Plan

Published 1960

Source map scale - 1:2,500

The historical maps shown were reproduced from maps predominantly held at the scale adopted for England, Wales and Scotland in the 1840's. In 1854 the 1:2,500 scale was adopted for mapping urban areas and by 1896 it covered the whole of what were considered to be the cultivated parts of Great Britain. The published date given below is often some years later than the surveyed date. Before 1938, all OS maps were based on the Cassini Projection, with independent surveys of a single county or group of counties, giving rise to significant inaccuracies in outlying areas.

Map Name(s) and Date(s)

TQ1875 1960 12,500	TQ1975 1960 12,500
TQ1874 1960 12,500	TQ1974 1960 12,500

Historical Map - Segment A7

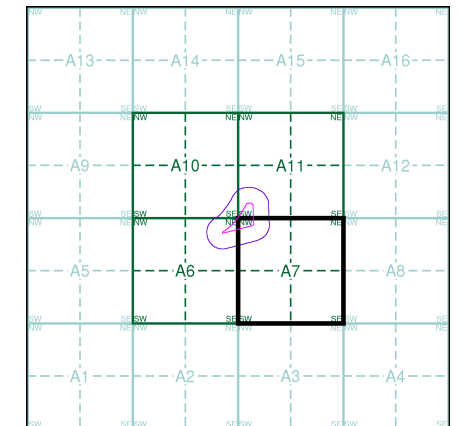

Order Details

Order Number: 142584674_1_1
Customer Ref: Homebase, Richmond
National Grid Reference: 518890, 175430
Slice: A
Site Area (Ha): 1.58
Search Buffer (m): 100

Site Details

Homebase Ltd, 84, Manor Road, RICHMOND, TW9 1YB

Landmark
INFORMATION GROUP

Tel: 0844 844 9952
Fax: 0844 844 9951
Web: www.envirocheck.co.uk

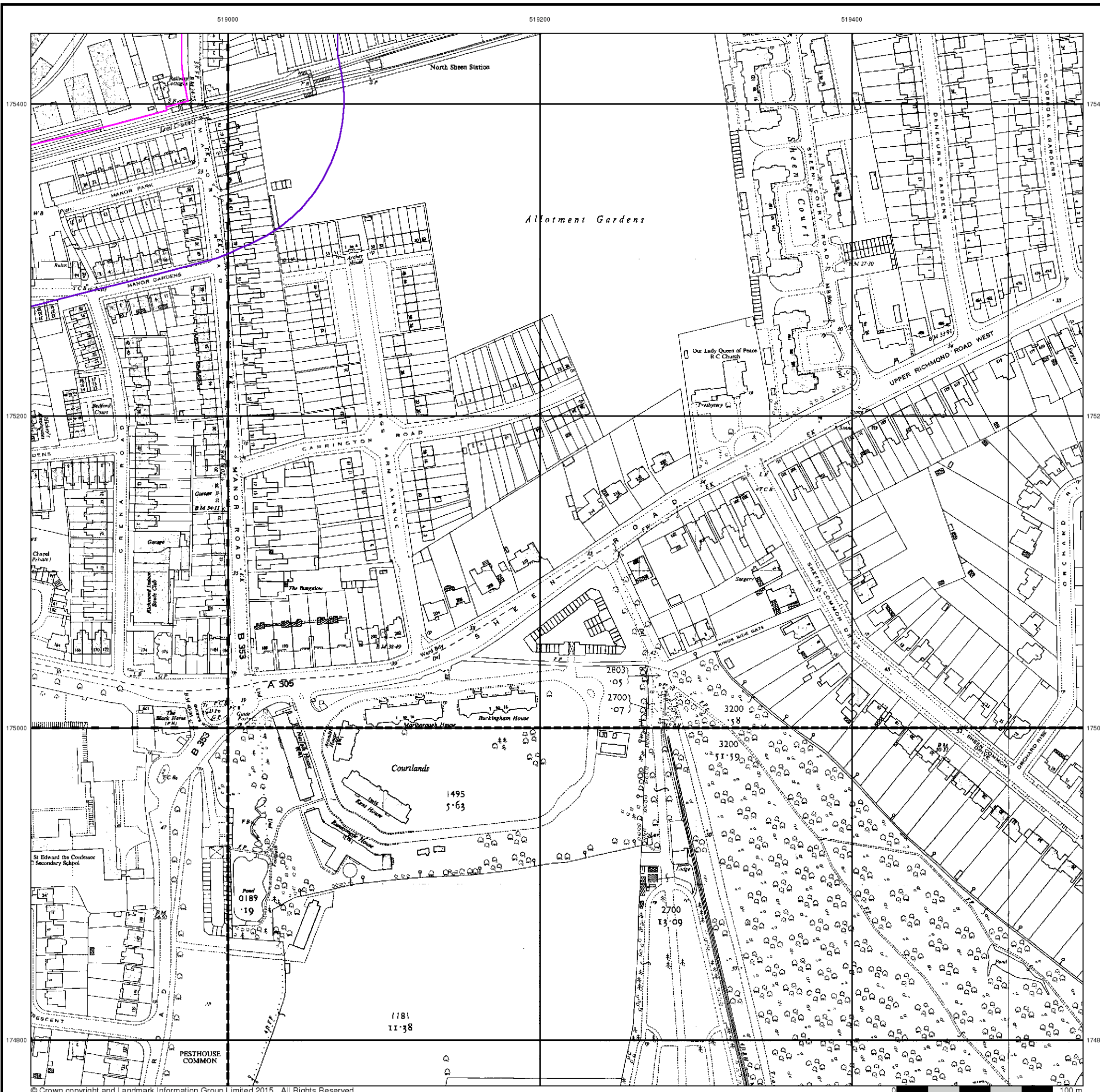

FAIRHURST

Additional SIMs

Published 1960

Source map scale - 1:2,500

The SIM cards (Ordnance Survey's 'Survey of Information on Microfilm') are further, minor editions of mapping which were produced and published in between the main editions as an area was updated. They date from 1947 to 1994, and contain detailed information on buildings, roads and land-use. These maps were produced at both 1:2,500 and 1:1,250 scales.

Map Name(s) and Date(s)

TQ1875 1960 12,500	TQ1975 1960 12,500
TQ1874 1960 12,500	TQ1974 1960 12,500

Historical Map - Segment A7

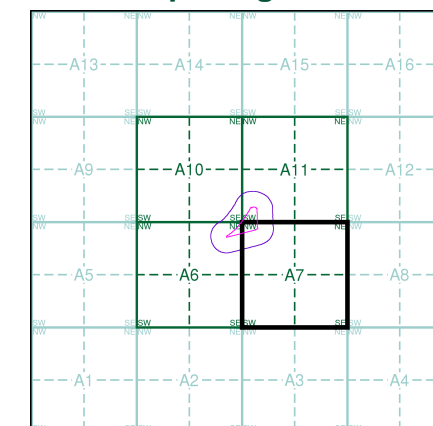

Order Details

Order Number: 142584674_1_1
Customer Ref: Homebase, Richmond
National Grid Reference: 518890, 175430
Slice: A
Site Area (Ha): 1.58
Search Buffer (m): 100

Site Details

Homebase Ltd, 84, Manor Road, RICHMOND, TW9 1YB

Landmark
INFORMATION GROUP

Tel: 0844 844 9952
Fax: 0844 844 9951
Web: www.envirocheck.co.uk



FAIRHURST

Supply of Unpublished Survey Information

Published 1973 - 1974

Source map scale - 1:1,250

SUSI maps (Supply of Unpublished Survey Information) were produced between 1972 and 1977, mainly for internal use at Ordnance Survey. These were more of a 'work-in-progress' plan as they showed updates of individual areas on a map. These maps were unpublished, and they do not represent a single moment in time. They were produced at both 1:2,500 and 1:1,250 scales.

Map Name(s) and Date(s)

TQ1875SE 1974 1:1,250	TQ1975SW 1974 1:1,250
TQ1974NW 1973 1:1,250	TQ1974NE 1973 1:1,250

Historical Map - Segment A7

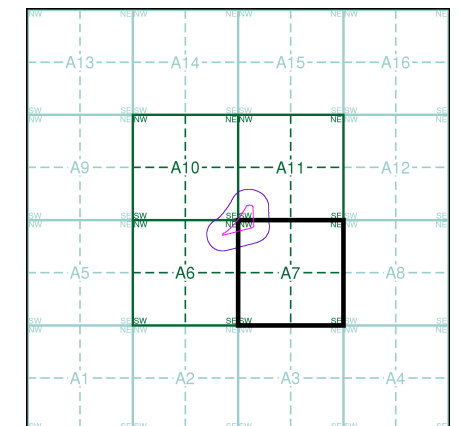

Order Details

Order Number: 142584674_1_1
Customer Ref: Homebase, Richmond
National Grid Reference: 518890, 175430
Slice: A
Site Area (Ha): 1.58
Search Buffer (m): 100

Site Details

Homebase Ltd, 84, Manor Road, RICHMOND, TW9 1YB

Landmark
INFORMATION GROUP

Tel: 0844 844 9952
Fax: 0844 844 9951
Web: www.envirocheck.co.uk



FAIRHURST

Additional SIMs

Published 1973 - 1991

Source map scale - 1:1,250

The SIM cards (Ordnance Survey's 'Survey of Information on Microfilm') are further, minor editions of mapping which were produced and published in between the main editions as an area was updated. They date from 1947 to 1994, and contain detailed information on buildings, roads and land-use. These maps were produced at both 1:2,500 and 1:1,250 scales.

Map Name(s) and Date(s)

TQ1875SE 1974 1:1,250	TQ1975SE 1973 1:1,250
TQ1874NE 1991 1:1,250	

Historical Map - Segment A7

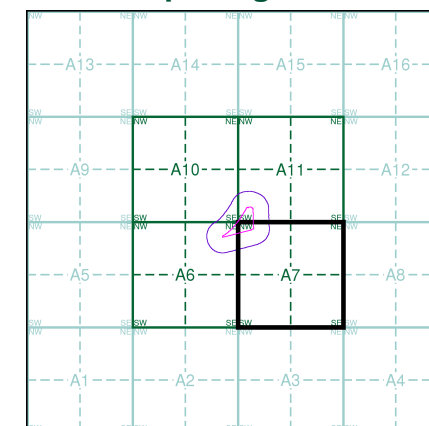

Order Details

Order Number: 142584674_1_1
Customer Ref: Homebase, Richmond
National Grid Reference: 518890, 175430
Slice: A
Site Area (Ha): 1.58
Search Buffer (m): 100

Site Details

Homebase Ltd, 84, Manor Road, RICHMOND, TW9 1YB

Landmark
INFORMATION GROUP

Tel: 0844 844 9952
Fax: 0844 844 9951
Web: www.envirocheck.co.uk

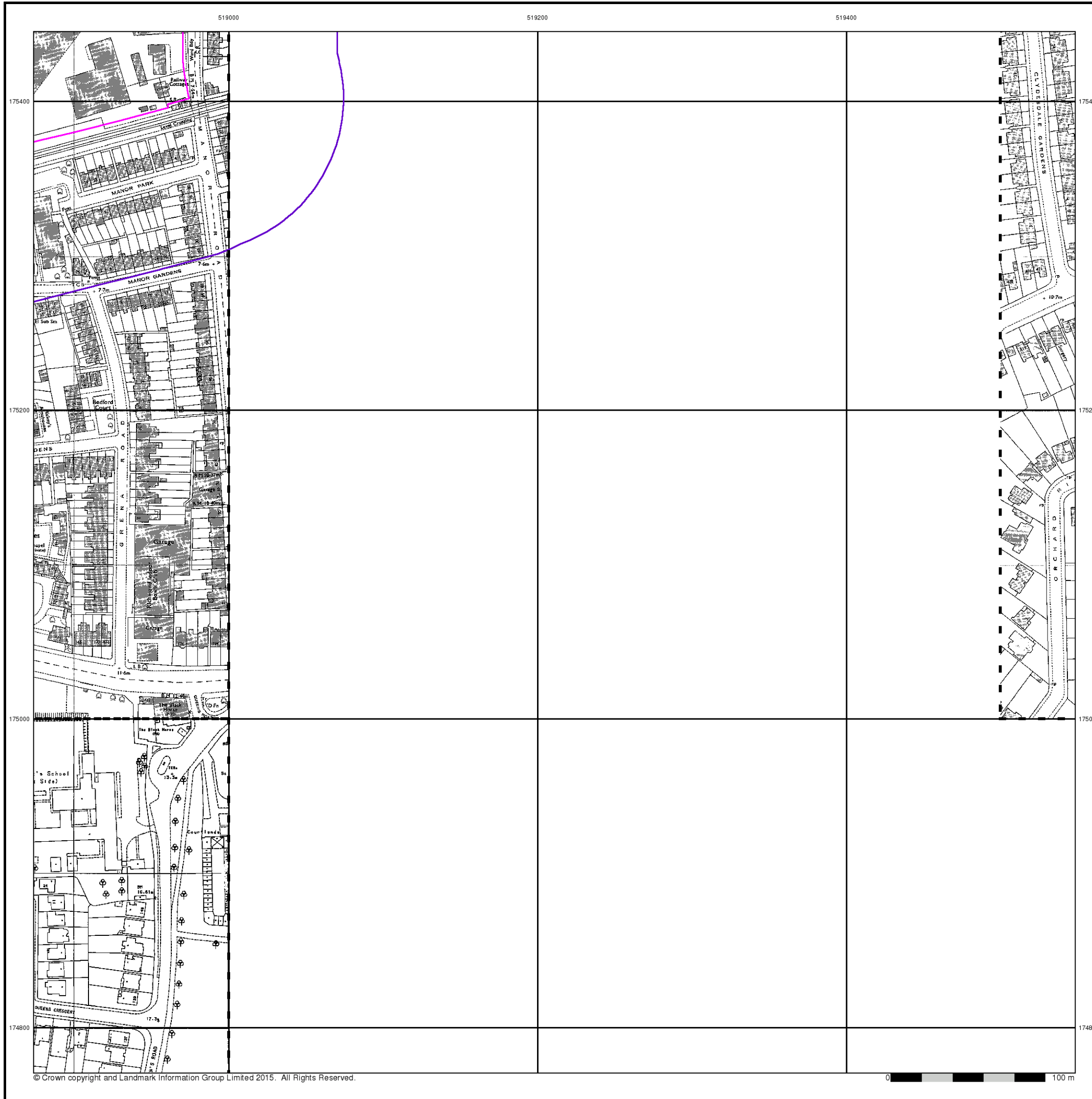

FAIRHURST

Ordnance Survey Plan

Published 1974 - 1991

Source map scale - 1:1,250

The historical maps shown were reproduced from maps predominantly held at the scale adopted for England, Wales and Scotland in the 1840's. In 1854 the 1:2,500 scale was adopted for mapping urban areas and by 1896 it covered the whole of what were considered to be the cultivated parts of Great Britain. The published date given below is often some years later than the surveyed date. Before 1938, all OS maps were based on the Cassini Projection, with independent surveys of a single county or group of counties, giving rise to significant inaccuracies in outlying areas.

Map Name(s) and Date(s)

TQ1875SE
1974
1:1,250

TQ1874NE
1991
1:1,250

Historical Map - Segment A7

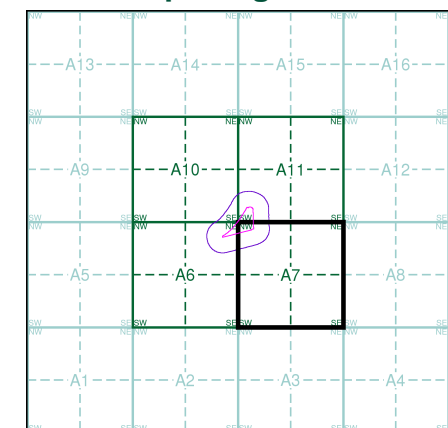

Order Details

Order Number: 142584674_1_1
Customer Ref: Homebase, Richmond
National Grid Reference: 518890, 175430
Slice: A
Site Area (Ha): 1.58
Search Buffer (m): 100

Site Details

Homebase Ltd, 84, Manor Road, RICHMOND, TW9 1YB

Landmark
INFORMATION GROUP

Tel: 0844 844 9952
Fax: 0844 844 9951
Web: www.envirocheck.co.uk

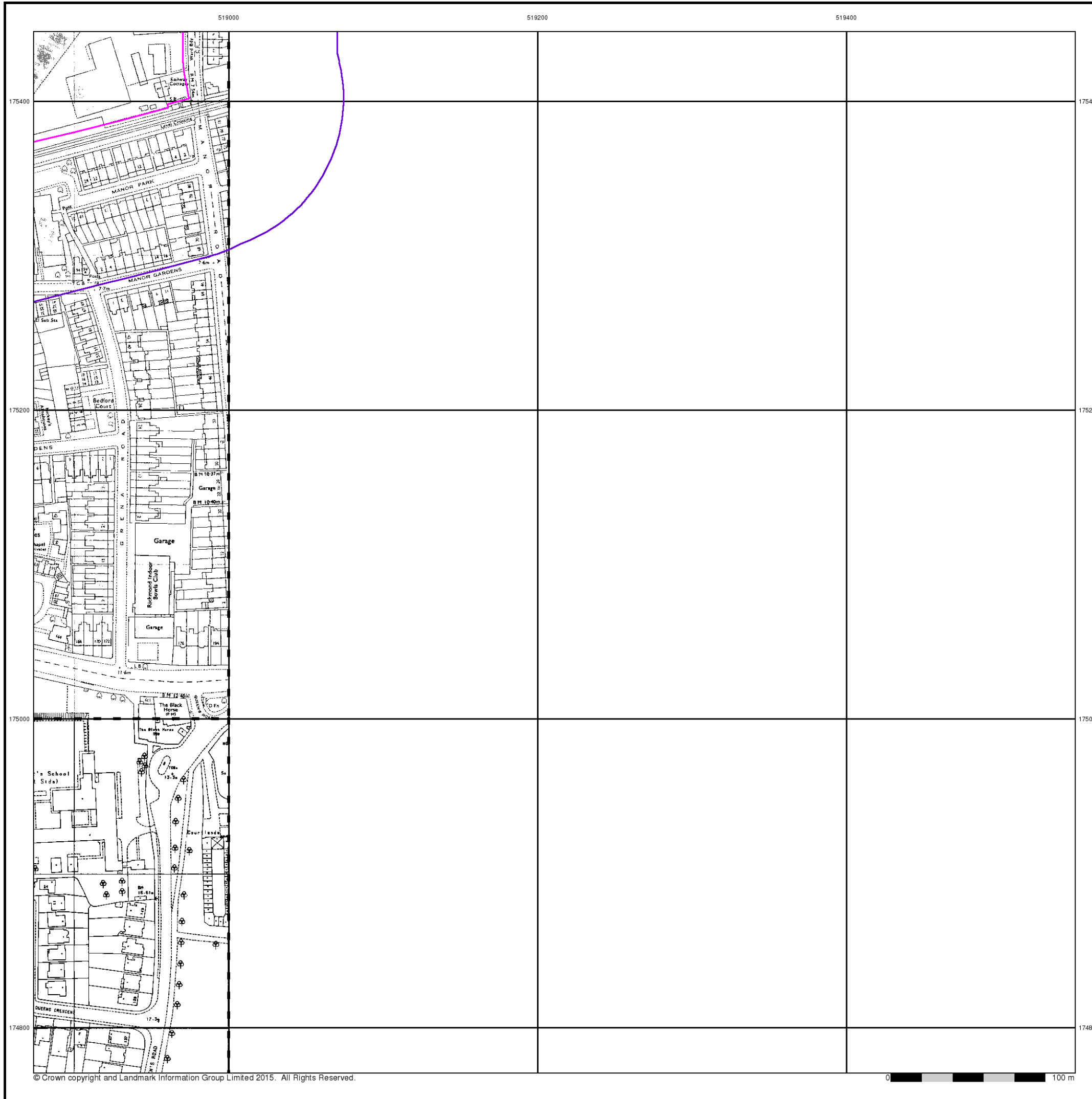

519000

519200

519400

FAIRHURST

Additional SIMs

Published 1983

Source map scale - 1:1,250

The SIM cards (Ordnance Survey's 'Survey of Information on Microfilm') are further, minor editions of mapping which were produced and published in between the main editions as an area was updated. They date from 1947 to 1994, and contain detailed information on buildings, roads and land-use. These maps were produced at both 1:2,500 and 1:1,250 scales.

Map Name(s) and Date(s)

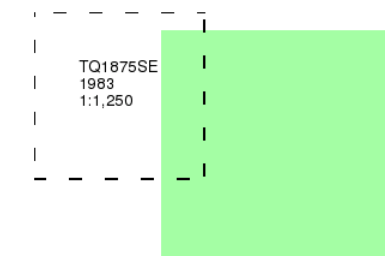

Historical Map - Segment A7

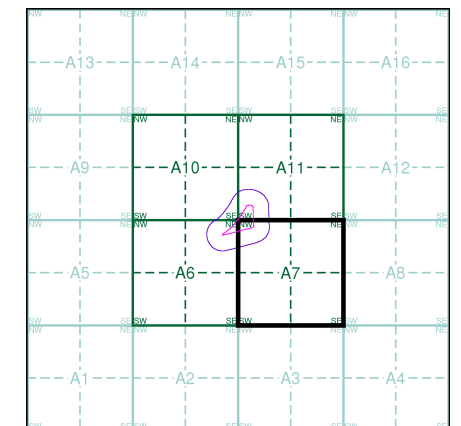

Order Details

Order Number: 142584674_1_1
Customer Ref: Homebase, Richmond
National Grid Reference: 518890, 175430
Slice: A
Site Area (Ha): 1.58
Search Buffer (m): 100

Site Details

Homebase Ltd, 84, Manor Road, RICHMOND, TW9 1YB

Landmark
INFORMATION GROUP

Tel: 0844 844 9952
Fax: 0844 844 9951
Web: www.envirocheck.co.uk

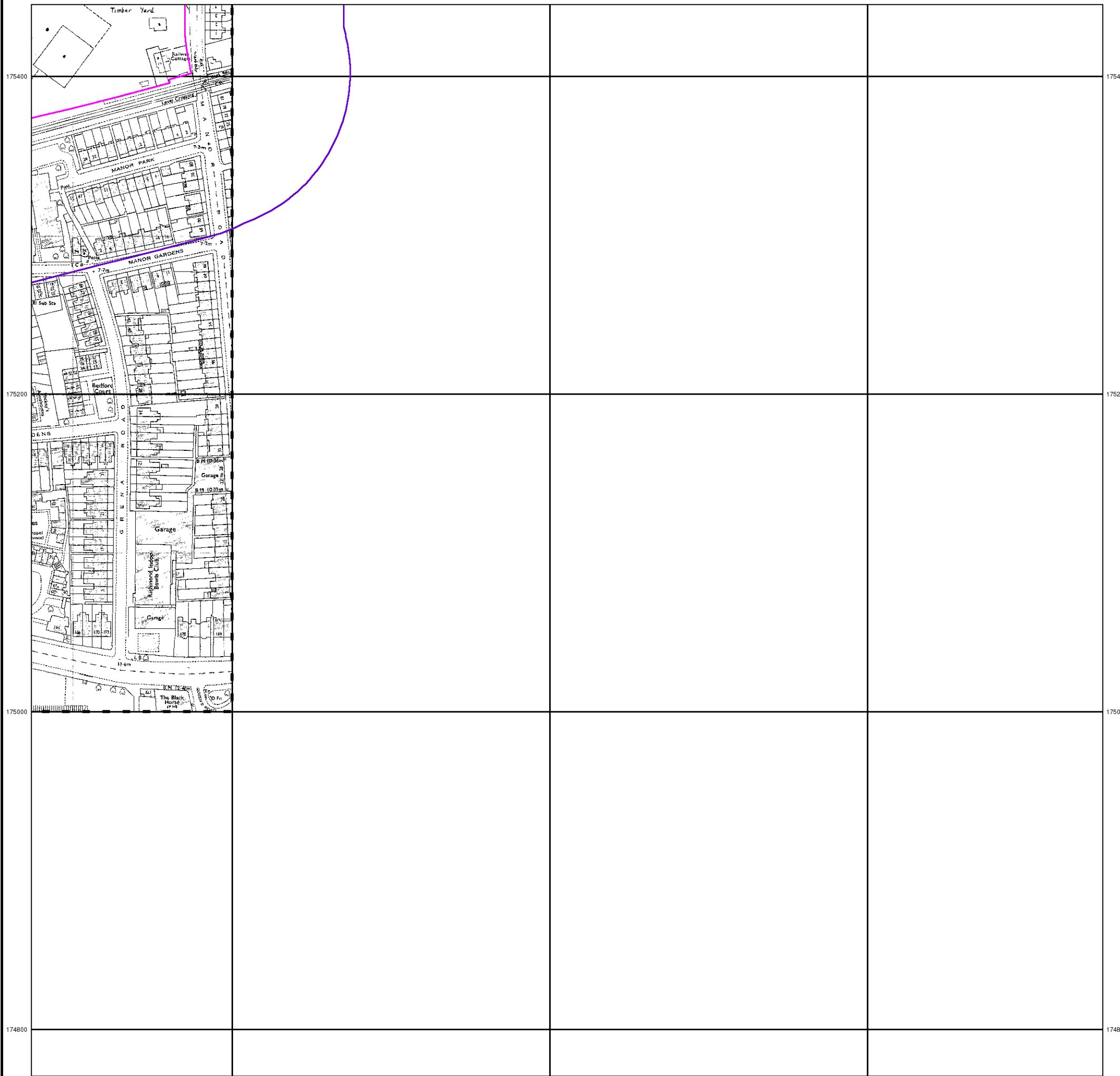

519000

519200

519400

FAIRHURST

Additional SIMs

Published 1989

Source map scale - 1:1,250

The SIM cards (Ordnance Survey's 'Survey of Information on Microfilm') are further, minor editions of mapping which were produced and published in between the main editions as an area was updated. They date from 1947 to 1994, and contain detailed information on buildings, roads and land-use. These maps were produced at both 1:2,500 and 1:1,250 scales.

Map Name(s) and Date(s)

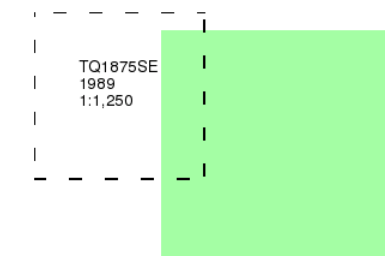

Historical Map - Segment A7

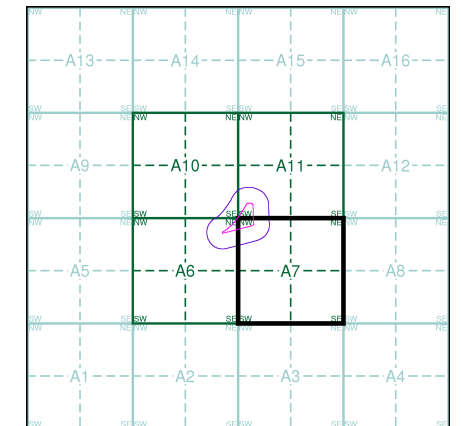

Order Details

Order Number: 142584674_1_1
 Customer Ref: Homebase, Richmond
 National Grid Reference: 518890, 175430
 Slice: A
 Site Area (Ha): 1.58
 Search Buffer (m): 100

Site Details

Homebase Ltd, 84, Manor Road, RICHMOND, TW9 1YB

Landmark
 INFORMATION GROUP

Tel: 0844 844 9952
 Fax: 0844 844 9951
 Web: www.envirocheck.co.uk

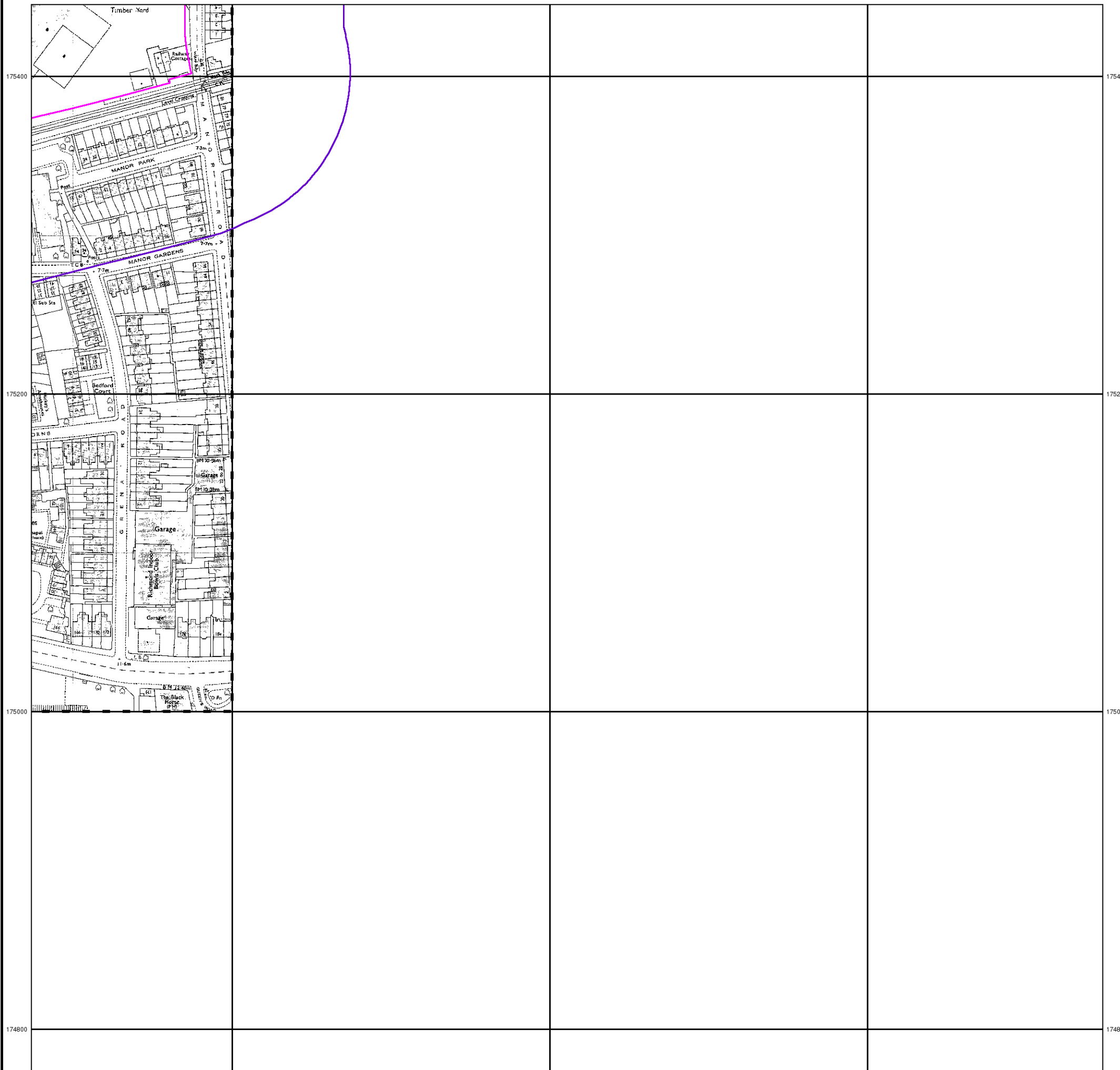

FAIRHURST

Large-Scale National Grid Data

Published 1991

Source map scale - 1:1,250

'Large Scale National Grid Data' superseded SIM cards (Ordnance Survey's 'Survey of Information on Microfilm') in 1992, and continued to be produced until 1999. These maps were the fore-runners of digital mapping and so provide detailed information on houses and roads, but tend to show less topographic features such as vegetation. These maps were produced at both 1:2,500 and 1:1,250 scales.

Map Name(s) and Date(s)

TQ1875SE 1991 1:1,250	TQ1975SW 1991 1:1,250	TQ1975SE 1991 1:1,250
TQ1874NE 1991 1:1,250	TQ1974NW 1991 1:1,250	TQ1974NE 1991 1:1,250

Historical Map - Segment A7

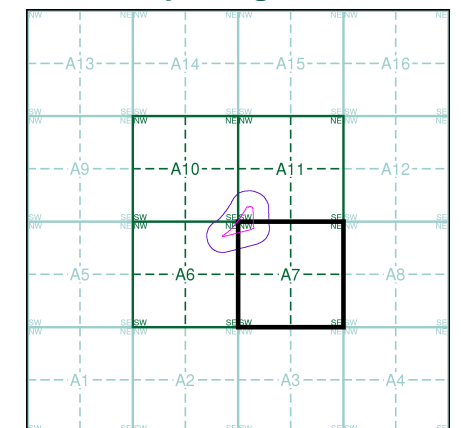

Order Details

Order Number: 142584674_1_1
 Customer Ref: Homebase, Richmond
 National Grid Reference: 518890, 175430
 Slice: A
 Site Area (Ha): 1.58
 Search Buffer (m): 100

Site Details

Homebase Ltd, 84, Manor Road, RICHMOND, TW9 1YB

Landmark
 INFORMATION GROUP

Tel: 0844 844 9952
 Fax: 0844 844 9951
 Web: www.envirocheck.co.uk



FAIRHURST

Large-Scale National Grid Data

Published 1992

Source map scale - 1:1,250

'Large Scale National Grid Data' superseded SIM cards (Ordnance Survey's 'Survey of Information on Microfilm') in 1992, and continued to be produced until 1999. These maps were the fore-runners of digital mapping and so provide detailed information on houses and roads, but tend to show less topographic features such as vegetation. These maps were produced at both 1:2,500 and 1:1,250 scales.

Map Name(s) and Date(s)

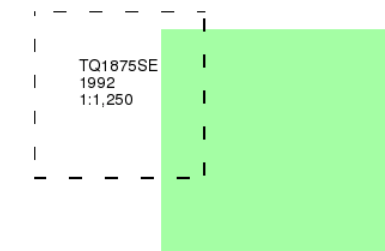

Historical Map - Segment A7

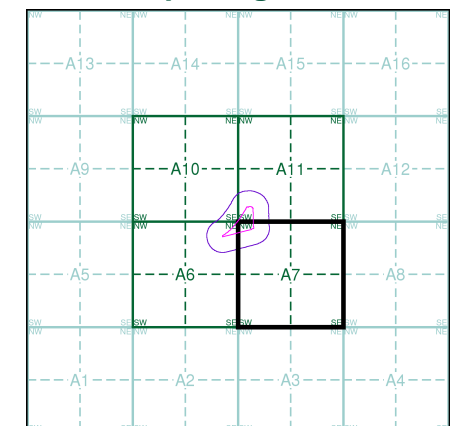

Order Details

Order Number: 142584674_1_1
Customer Ref: Homebase, Richmond
National Grid Reference: 518890, 175430
Slice: A
Site Area (Ha): 1.58
Search Buffer (m): 100

Site Details

Homebase Ltd, 84, Manor Road, RICHMOND, TW9 1YB

Landmark
INFORMATION GROUP

Tel: 0844 844 9952
Fax: 0844 844 9951
Web: www.envirocheck.co.uk

