



Red & Yellow Specialist Extra Care Melliss Avenue - Kew

Addendum to DAS
April 2019

marchesepartners
masterplanning | architecture | interior design | engineering



Revision to DAS - Section 5

The Proposals

Section 5 - The Proposals

The Proposals

Design Changes:

- A greater setbacks to MOL have been introduced to upper Levels

Accommodation is arranged over 6 floors, with specilaist extra care units located from levels 1 to 5, with the ground floor dedicated to all supporting care/ treatment, leisure and BOH accommodation.

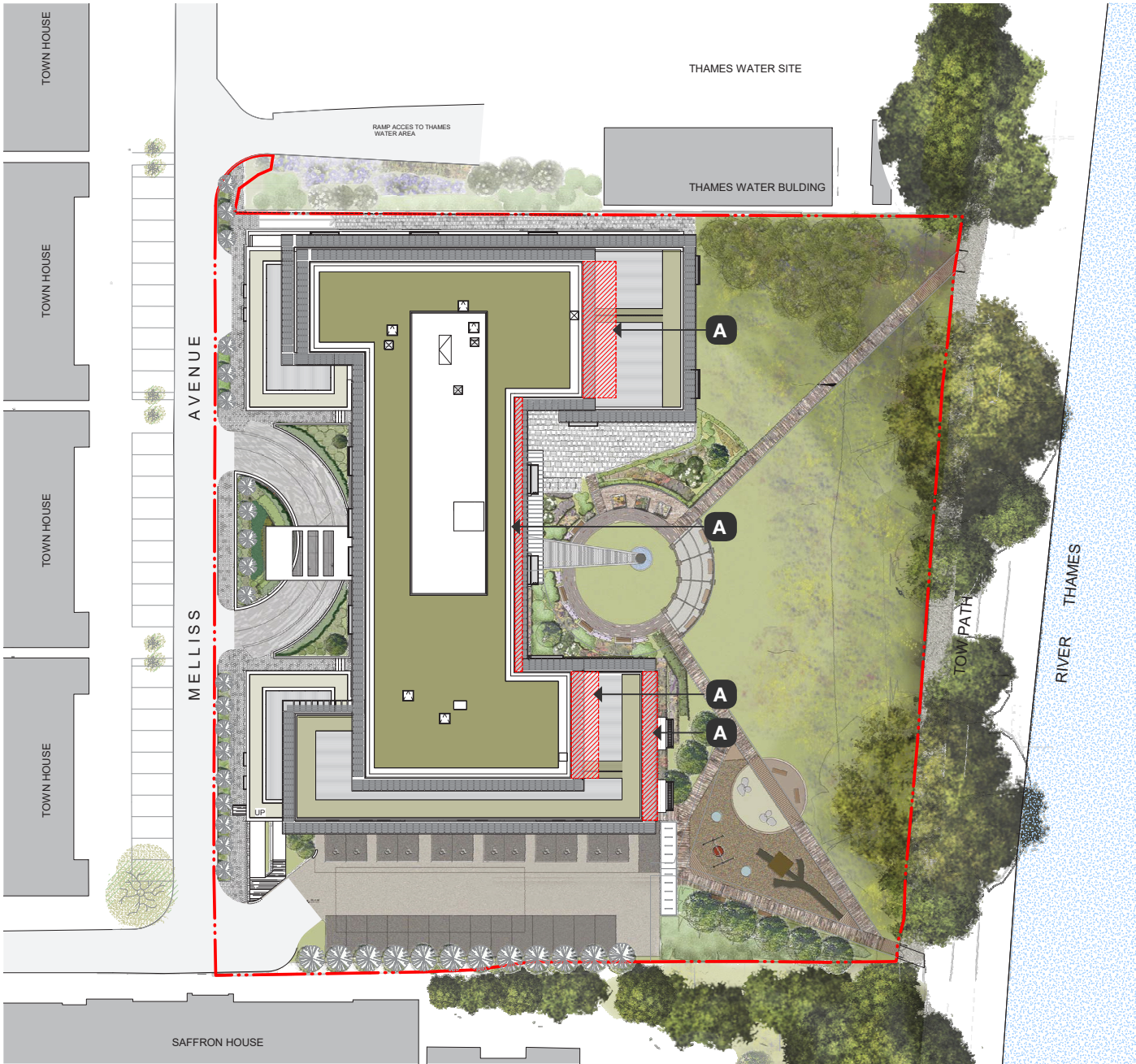

Proposed Site Plan



marchesepartners



Section 5 - The Proposals

Accommodation Schedule

	1 Bed	2 Bed	2 Bed +	2 Bed ++	2 Bed + Study	Total	Communal Area (Inc. in GIA)	NSA (sqm)	GIA (sqm)
Ground Floor							1,415	0	2,179
First Floor	2	1	11	5	1	20		1,699	2,164
Second Floor	2	1	11	5	1	20		1,699	2,164
Third Floor	2	1	11	5	1	20		1,699	2,164
Fourth Floor	4	1	7	3	2	18		1,423	1,869
Fifth Floor	3	3	1	2	2	11		911	1,220
Total	13	7	41	20	7	88	1,415	7,431	11,760
Unit Mix Ratio	15%	8%	47%	23%	8%				

