

Pupil Access

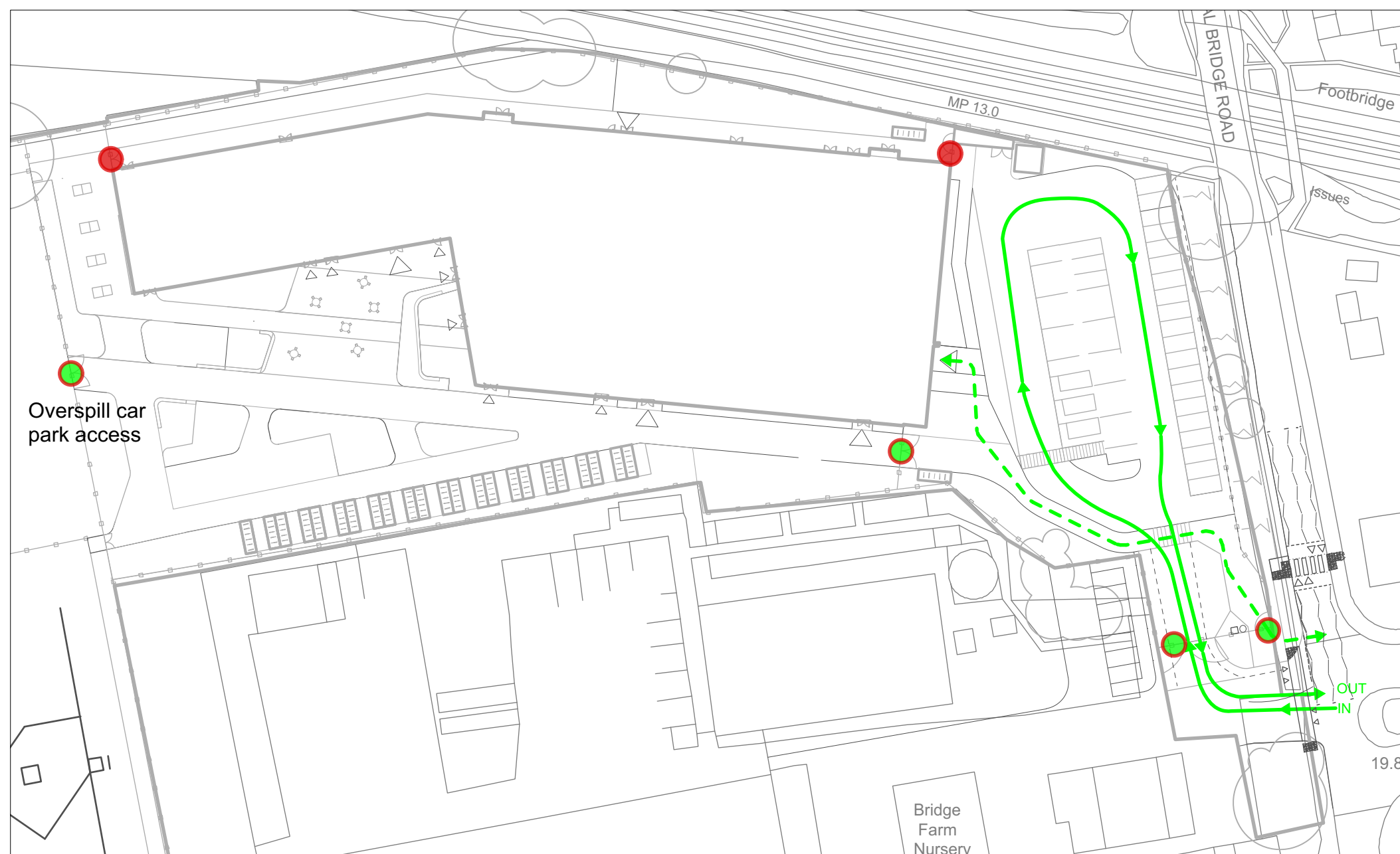

Visitor Access & Overspill Parking

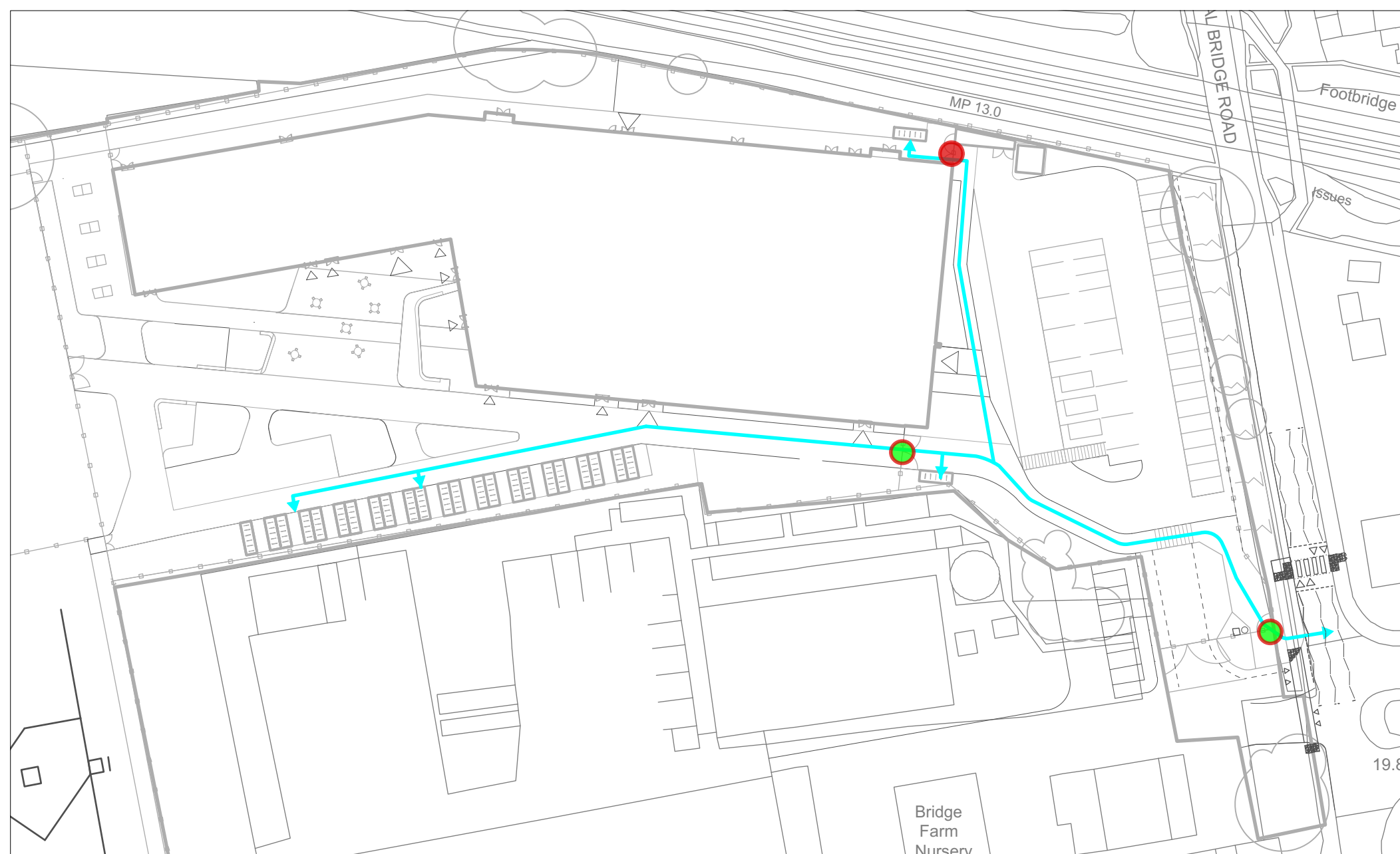

Cycle Access

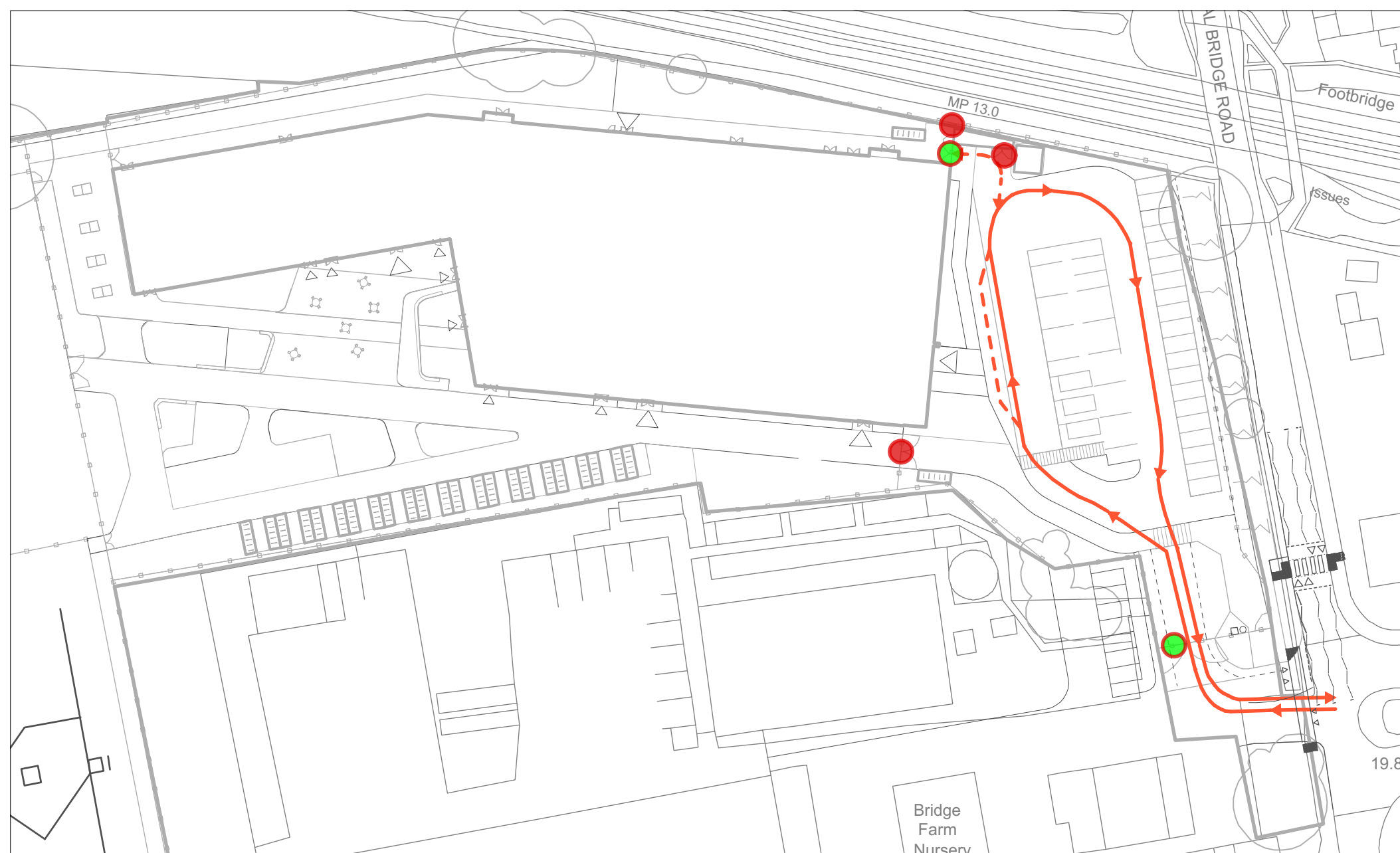

Deliveries Access

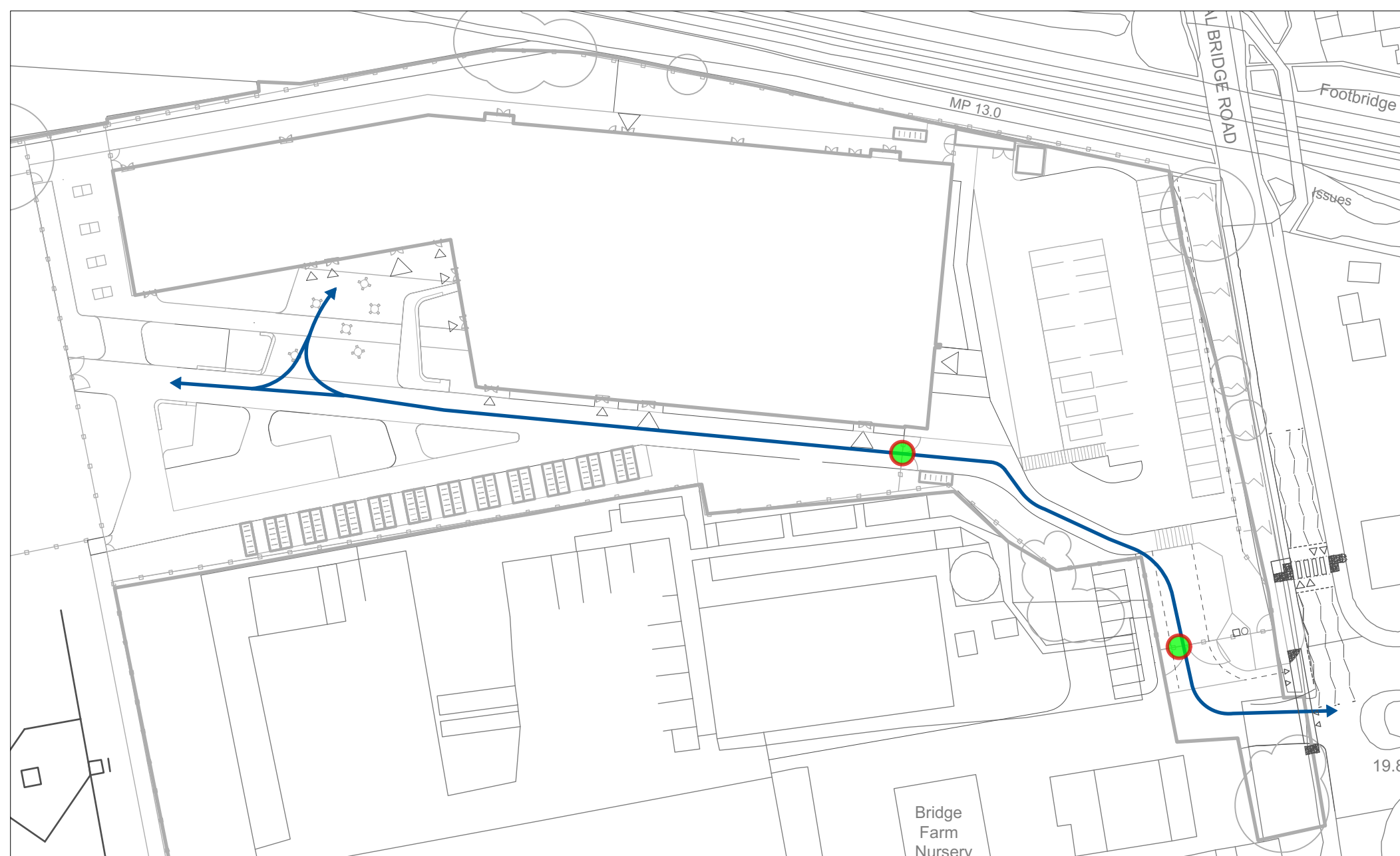

Fire Tender Access

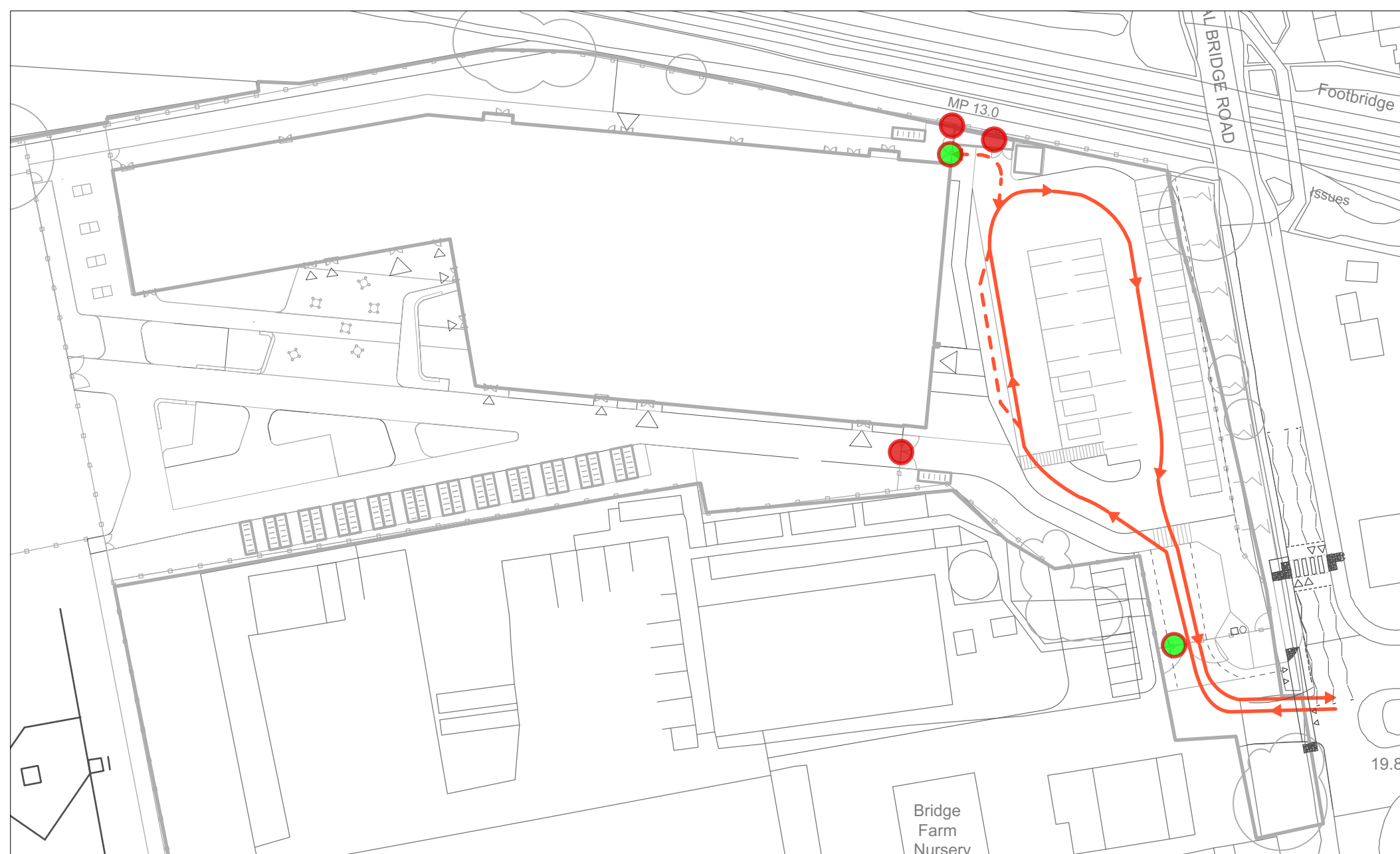

Maintenance/Bin Collection Access

Notes
 1. Drawing not to be scaled for construction or setting out purposes.
 2. To be read in conjunction with Project Risk Register REF: XXX
 3. To be read in conjunction with all other Landscape Architect's drawings

KEY
 ● Gate Open
 ● Gate Closed

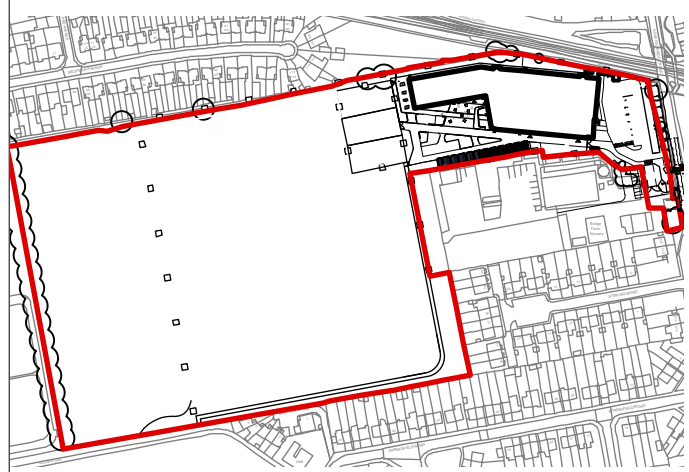

Location Plan

RESIDUAL PROJECT RISKS

ID	RISK	MITIGATION	Date Mitigated
07.02.19	S2	P03	Red Line Amended
13.11.18	S2	P02	Highways entrance and adjacent area updated

REVISIONS

SUITABILITY
S2 - FOR PLANNING

ares LANDSCAPE ARCHITECTS
 Ares Landscape Architects LTD
 Galtersher
 51 Eye Lane
 Sheffield
 S1 4RB
 t: 0114 276 2000
 e: hello@ares.eu.com
 w: ares.eu.com

CLIENT:
Bowmer and Kirkland

PROJECT TITLE:
Turing House School

DRAWING TITLE:
Access and Circulation

DRAWING SCALE: Illustrative Purposes Only
 DRAWN BY: EC
 APPROVED BY: LA
 DRAWN DATE: 11.04.2018

DRAWING NUMBER: **EFATH-ALA-00-XX-DR-L-0007**
 SUITABILITY: **S2**
 REVISION: **P03**