

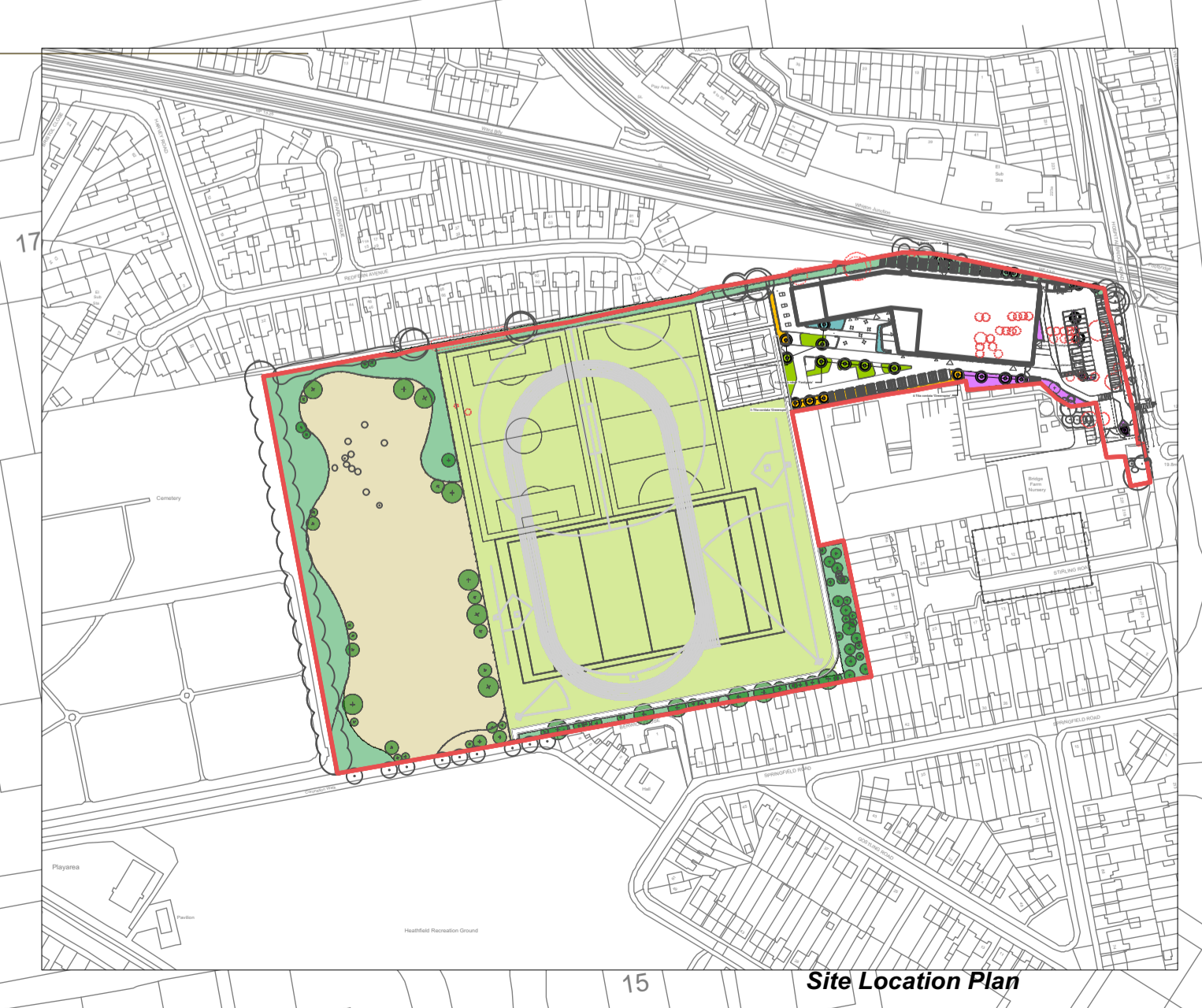

**Planting Strategy**

Species	Density	Girth (cm)	Height (cm)	Clear Stem (cm)	RB
Acer platanoides	As shown	18-20cm	450-500cm	175-200cm	RB, 3x, Extra Heavy
Betula pendula	As shown	18-20cm	450-500cm	175-200cm	RB, 3x, Extra Heavy
Quercus robur 'Fastigiata'	As shown	18-20cm	450-500cm	175-200cm	RB, 3x, Extra heavy
Tilia cordata 'Greenspire'	As shown	18-20cm	450-500cm	175-200cm	RB, 3x, Extra heavy



**Notes**  
 1. Drawing not to be scaled for construction or setting out purposes.  
 2. To be read in conjunction with Project Risk Register REF: XXX  
 3. To be read in conjunction with all other Landscape Architect's drawings

**KEY**

**Full sun planting mix**

- Cotinus coggygria
- Deschampsia cespitosa
- Rudbeckia fulgida var. sullivanti 'Goldsturm'
- Salvia nemorosa 'Caradonna'
- Stipa tenuissima

**Partial sun planting mix**

- Aster frikartii 'Monch'
- Geranium macrorrhizum 'White-Ness'
- Pachysandra terminalis 'Green Carpet'
- Rudbeckia fulgida var. sullivanti 'Goldsturm'
- Saxifraga x urbium

**Entrance herbaceous planting mix**

- Aster frikartii 'Monch'
- Calamagrostis x acutiflora 'Karl Foerster'
- Fatsia japonica
- Geranium macrorrhizum 'White-Ness'
- Lavendula angustifolia 'Hidcote'
- Pachysandra terminalis 'Green Carpet'

**Amenity grass seeding**

- Rollawn medallion turf or similar

**Woodland planting mix**

- Amalanchier lamarckii
- Acer campestre
- Betula pendula
- Crataegus monogyna
- Cornus alba
- Cornus sanguinea
- Hazel Corylus avellana
- Hawthorn
- Lavendula angustifolia
- Rosa canina
- Rosmarinus
- Sambucus nigra

**Green wall mix**

- Parthenocissus tricuspidata
- Clematis amandii

**Species rich grassland**

ID	RISK	MITIGATION	Date Mitigated
<b>RESIDUAL PROJECT RISKS</b>			

DATE	SUITABILITY	REV	DESCRIPTION OF REVISION	DRAWN BY	APPROVED BY
02.04.19	S2	P04	Car parking and tree removal strategy amended to reflect updated tree survey and bin store and substitution moved to accommodate ecology comments	LA	LA
07.02.19	S2	P03	Red Line Amended	HT	LA
13.11.18	S2	P02	Highways entrance and adjacent area updated	HT	LA

**REVISIONS**

SUITABILITY  
**S2 - For Planning**

**ares**  
 LANDSCAPE ARCHITECTS

Ares Landscape Architects LTD  
 Giltcrusher  
 51 Eye Lane  
 Sheffield  
 S1 4RB

t: 0114 276 2000  
 e: hello@ares.eu.com  
 w: ares.eu.com

CLIENT:  
**Bowmer and Kirkland**

PROJECT TITLE:  
**Turing House School**

DRAWING TITLE:  
**Planting Strategy**

DRAWING SCALE: 1:500  
 DRAWN BY: EC  
 DRAWN DATE: 02.03.2018

FRAME SIZE: A1  
 APPROVED BY: LA

DRAWING NUMBER: **EFATH-ALA-00-XX-DR-L-0014**  
 SUITABILITY: **S2**  
 REVISION: **P04**