

GENERAL NOTES:

1. THIS DRAWING IS TO BE READ IN CONJUNCTION WITH ALL RELEVANT ARCHITECTS AND ENGINEERS DRAWINGS AND SPECIFICATIONS.
2. DO NOT SCALE THIS DRAWING. ANY AMBIGUITIES, OMISSIONS AND ERRORS ON DRAWINGS SHALL BE BROUGHT TO THE ENGINEERS ATTENTION IMMEDIATELY. ALL DIMENSIONS MUST BE CHECKED / VERIFIED ON SITE.
3. ALL DIMENSIONS ARE IN MILLIMETRES UNLESS NOTED OTHERWISE.
4. FOR GENERAL NOTES REFER TO DRAWING.

TO BE READ IN CONJUNCTION WITH THE DRAWINGS:

- FS0316-CUR-ZZ-00-DR-C-9200_SURFACE WATER DRAINAGE LAYOUT KEY PLAN
- FS0316-CUR-ZZ-00-DR-C-9202_SURFACE WATER DRAINAGE LAYOUT SHEET 1 OF 2
- FS0316-CUR-ZZ-00-DR-C-9201_FOUL WATER DRAINAGE LAYOUT

KEY

- PROPOSED SURFACE WATER DRAIN
- PROPOSED SURFACE RAIN WATER PIPE
- PROPOSED SURFACE WATER SIPHONIC DRAIN PIPE
- PROPOSED SURFACE WATER GULLY
- PROPOSED LINEAR DRAINAGE CHANNEL (LDC) WITH A SUMP UNIT AT OUTFALL
- PROPOSED GATIC (OR EQUIVALENT) DRAINAGE CHANNEL WITH A SUMP UNIT AT OUTFALL
- PROPOSED FILTER DRAIN
- PROPOSED ATTENUATION SUB-BASE WITH PERFORATED PIPE
- PROPOSED SURFACE WATER ATTENUATION TANK
- POWER SUPPLY FOR PUMP STATIONS (TBC)
- EXISTING PUBLIC SURFACE WATER SEWER
- PROPOSED DISHED CHANNEL (CD2)
- PUMP CHAMBER
- PROPOSED RAIN GARDEN

DESIGN NOTES:

1. ALL LEVELS ARE IN METRES ABOVE ORDNANCE DATUM.
2. G3 TREES HAVE BEEN ASSUMED TO BE REMOVED - SUBJECT TO NETWORK RAIL APPROVAL TO BE CONFIRMED BY THE LANDSCAPE ARCHITECT.
3. LEVELS BY LANDSCAPE ARCHITECT - DETAILED LEVELS FOR CONSTRUCTION MAY RESULT IN CHANGES TO DRAINAGE FEATURES (TYPE AND LOCATION).
4. SIPHONIC DRAIN PIPES LOCATIONS ASSUMED FOR THE PURPOSES OF SURFACE WATER DESIGN. LOCATIONS TO BE CONFIRMED BY AN M&E AT A LATER DESIGN STAGE.
5. ALL MANHOLES/INSPECTION CHAMBERS WITHIN TRAFFICKED HARD STANDING AREAS TO HAVE HEAVY DUTY COVERS (D400 GRADE).
6. RAIN WATER DOWNPIPES LOCATIONS HAVE BEEN BASED ON DRAWING FS0316-STL-XX-00-DR-A-1003-GROUND FLOOR GA PLAN-WEST-P01 ISSUED ON 11.04.18 BY THE ARCHITECT.
7. NO INFILTRATION ALLOWED AS PER INFILTRATION TEST RESULTS PROVIDED BY DELTA SIMONS IN APRIL 2018.
8. CONNECTION TO THE EXISTING SURFACE WATER PUBLIC SEWER SUBJECT TO SECTION 106 AGREEMENT WITH THAMES WATER BY CONTRACTOR.
9. DISCHARGE RATE BASED ON GREENFIELD RUNOFF RATES.
10. ATTENUATION VOLUME BASED ON 100 YEARS +40%CC STORM EVENT.
11. SURFACE WATER PUMPING STATION INDICATIVE ONLY. PUMP TO BE DESIGNED BY A SPECIALIST.
12. DESIGN BASED ON LANDSCAPE ARCHITECT DRAWINGS FS0316-ALA-00-XX-DR-L-0016/0017/0018 ISSUED ON 10.01.19. ANY CHANGES TO THIS DESIGN MAY AFFECT THE SURFACE WATER DRAINAGE PROPOSALS.

Rev	Description	Date	By	Chkd
P08	REVISED TO PLANNING COMMENTS.	03.04.19	ID	BB
P07	GULLY RECONNECTED, CP ISSUE	14.02.19	ID	AW
P06	CONTRACTOR'S PROPOSAL	22.01.19	BB	AW
P05	CONTRACTOR'S PROPOSAL	22.01.19	JW	BB
P04	Revised to new layout. Attenuation volume amended. Planning issue.	22.11.18	ID	RJ
P03	PLANNING ISSUE	01.08.18	RJ	AW
P02	REVISED AS PER ITT CLARIFICATIONS	01.05.18	AS	AW
P01	ISSUED FOR ITT	17.04.18	AS	AW

55 The Ropewalk, Nottingham NG1 5DW
0115 941 5551
nottingham@curtins.com
www.curtins.com

Civils & Structures • Transport Planning • Environmental • Infrastructure • Geotechnical • Conservation & Heritage • Principal Designer
Birmingham • Bristol • Cambridge • Cardiff • Dublin • Edinburgh • Glasgow • Kenton • Leeds • Liverpool • London • Manchester • Nottingham

Status: **PLANNING**

Project: **TURING HOUSE SCHOOL**

Dwg Title: **SURFACE WATER DRAINAGE LAYOUT SHEET 2 OF 2**

Size	Date	Drawn By	Designed By	Checked By
A1	06.04.18	AS	AS	AW

Scale: 1:200

Project No.	Originator	Zone	Level	Type	Discipline	Category / Number	Rev
FS0316 - CUR - ZZ - 00 - DR - C -						9203	-P08

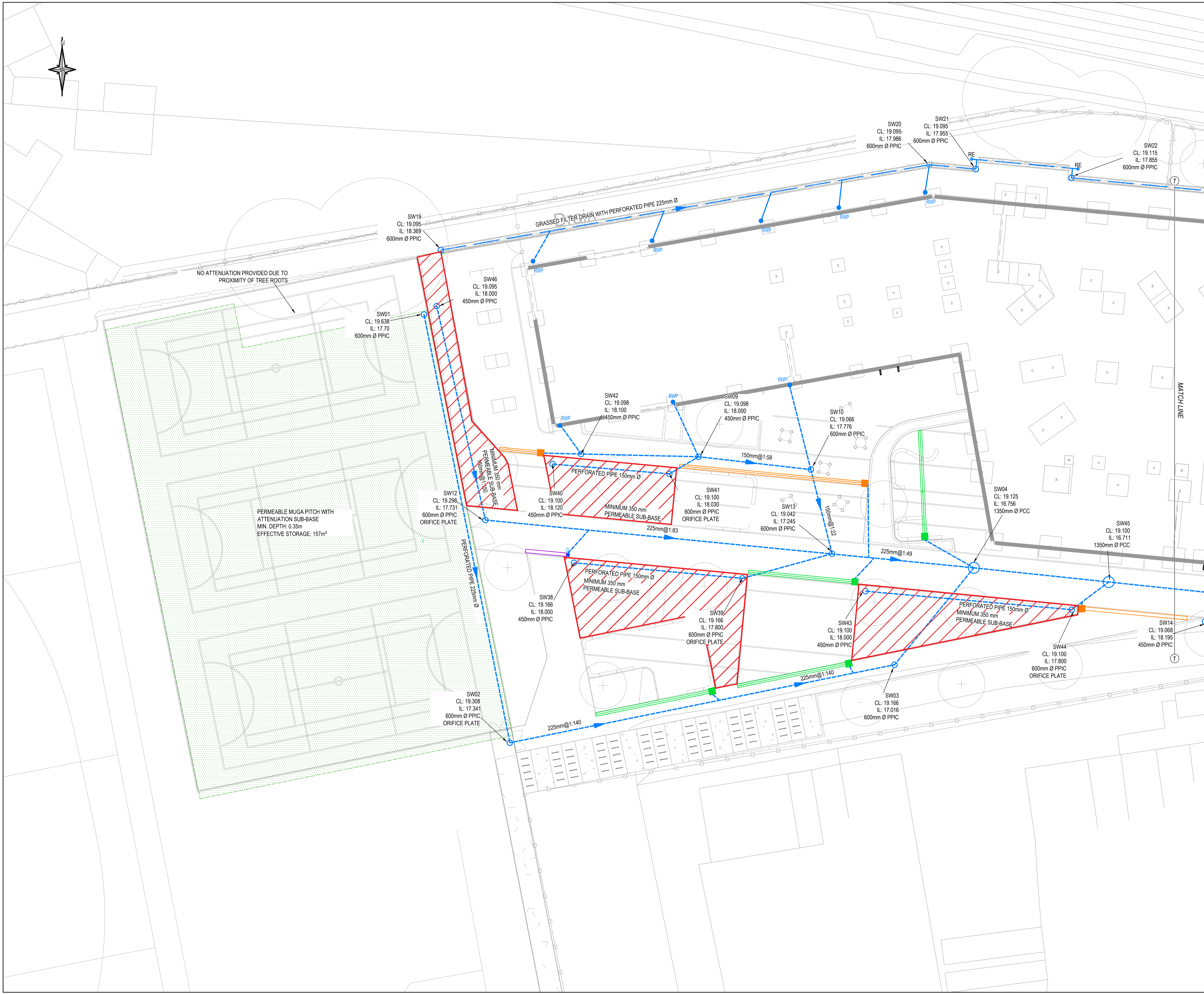

NO ATTENUATION PROVIDED DUE TO PROXIMITY OF TREE ROOTS

PERMEABLE MUGA PITCH WITH ATTENUATION SUB-BASE
MIN. DEPTH: 0.35m
EFFECTIVE STORAGE: 157m³

MATCH LINE