



Client's Logo :



Contractor's Logo :

LIDL GROUND FLOOR AREA

LIDL SALES AREA	1206m <sup>2</sup>
WAREHOUSE AREA	118m <sup>2</sup>
MANAGER'S OFFICE	10m <sup>2</sup>
BAKERY	57m <sup>2</sup>
FREEZER	56m <sup>2</sup>
CHILLER	41m <sup>2</sup>
CUSTOMER WC	4m <sup>2</sup>
STAIRS AND LIFTS	86m <sup>2</sup>
UTILITIES	9m <sup>2</sup>

LIDL STORE GF G.I.A (INCLUDING INTERNAL WALLS)

1595m<sup>2</sup>

LIDL BASEMENT FLOOR AREA

LIDL BASEMENT PARKING	1170m <sup>2</sup>
LOBBY	140m <sup>2</sup>
WELFARE	45m <sup>2</sup>
LIFT STAIRCASES AND CIRCULATION	83m <sup>2</sup>
WAREHOUSE	120m <sup>2</sup>

LIDL STORE B G.I.A (INCLUDING INTERNAL WALLS)

1336m<sup>2</sup>

TOTAL G.I.A OF LIDL

2931m<sup>2</sup>

NEW SCHOOL AREAS

GF G.I.A 163m<sup>2</sup>

FF G.I.A 1414m<sup>2</sup>

2ND FLOOR 1014m<sup>2</sup>

TOTAL G.I.A. OF SCHOOL 2991m<sup>2</sup>

<b>SHARED PARKING</b>	
Standard Parking	38
Active Super Charging (ACT-S)	2
Active Fast Charging (ACT-F)	4
Passive Fast Charging (PAS-F)	3
Active Fast Charging (ACT-F) / Parent & Child	1
Parent & Child	1
Disabled Parking	4
<b>Total Parking</b>	<b>53</b>
<b>CYCLE PARKING</b>	
Short Stay	22
Long Stay	12
<b>Total</b>	<b>34</b>

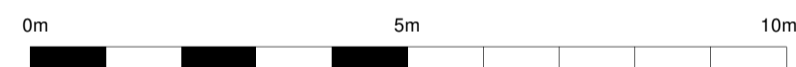

REV	DATE	DESCRIPTION	BY
15	05.06.19	Planning Issue	ARD
14	05.03.19	balustrade added; Fence and Shutter updated	LM
13	21.12.18	Updated for construction with latest package information	JC
12	03.10.18	GA plan general update	TN
11	28.08.18	Pedestrian routes and barriers indicated - Planning Issue	ARD

IN CASE OF DOUBT OR DISCREPANCIES PLEASE REFER TO ARCHITECT FOR INSTRUCTIONS. DRAWING AND SUITABILITY NUMBERS IN ACCORDANCE WITH BS1192:2007. THIS DRAWING SHOULD NOT BE SCALED. THIS DRAWING IS COPYRIGHT.

<b>SUITABILITY NUMBER KEY:</b>	
WIP	50 - Work in Progress*
SHARED	S1 - Fit for co-ordination**
	S2 - Fit for information
	S3 - Fit for internal review and comment
	S4 - Fit for construction approval
<b>DOCUMENTATION:</b>	
	D1 - Fit for costing
	D2 - Fit for tender
	D3 - Fit for contractor design
	D4 - Fit for manufacturer procurement
<b>DOCUMENTATION - SIGN-OFF</b>	
A	- Fit for construction
B	- Fit for construction, with comments
C	- Comprehensive revisions needed
ARCHIVE	AB - As Built
	AC - As Constructed
	FC - Final Construction
* For internal pre-issue usage only.	
** For model file usage only.	

4th Floor, Greyfriars House  
Greyfriars Road, Cardiff CF10 3AL  
Tel: 029 2055 8900 Fax: 029 2039 9592  
www.boyesrees.co.uk  
Registered office: As above Reg No. 295  
1683 (England & Wales)

PROJECT TITLE : Proposed LIDL store on Richmond Road Twickenham

DRAWING TITLE : GA Ground Floor Plan

DRAWN BY : ADT SCALE : 1 : 100 @ A1  
JOB NO : 4862 DATE : 05/05/16

SUITABILITY :	S4	REVISION :	15
PROJECT ORIGIN :	BRA	VOLUME :	00
LEVEL :	00	TYPE :	DR
DISCIPLINE :	A	NUMBER :	0100

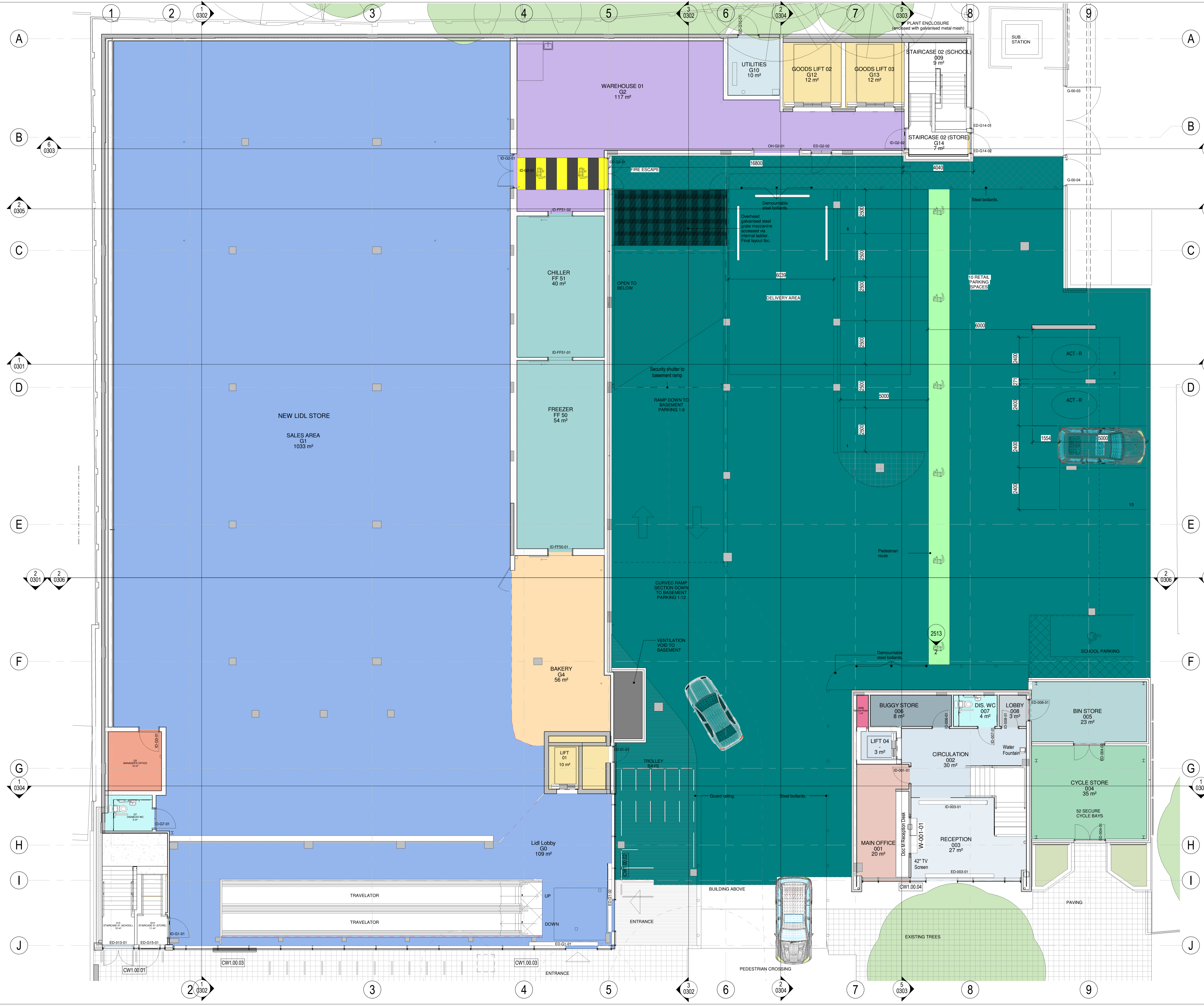

C:\Users\adnison\Documents\4862\_BRA-00-XK-M3-A-090001-RICHMOND LIDL STORE\_adnison(Recovery).bvt