

Amended First Floor Planning Drawing

Walls

- 1 Proposed Change: Glazed stair core omitted and rear escape combined with store staircase.
Reasons: Rear escape stair rationalised to reduce wasted space and avoid exposed unoccupied space. Removing the stairwell also reduces massing.

Curtain Walls, Windows and Door Openings

- 1 Proposed Change: Window / louvre design rationalised and aligned.
Reasons: Opening rationalized to suit revised elevation and CDM requirement.

Facade Material Change

- 1 Proposed Change: Cladding changed to render.
Reasons: Brick cladding replaced to reduce massing in combination with hall area.
- 2 Proposed Change: Cladding changed to brick.
Reasons: Render replaced to create differentiation with plant room.
- 3 Proposed Change: Green roof position moved to main roof level.
Reasons: Green roofs combined on top floor for improved maintenance access.

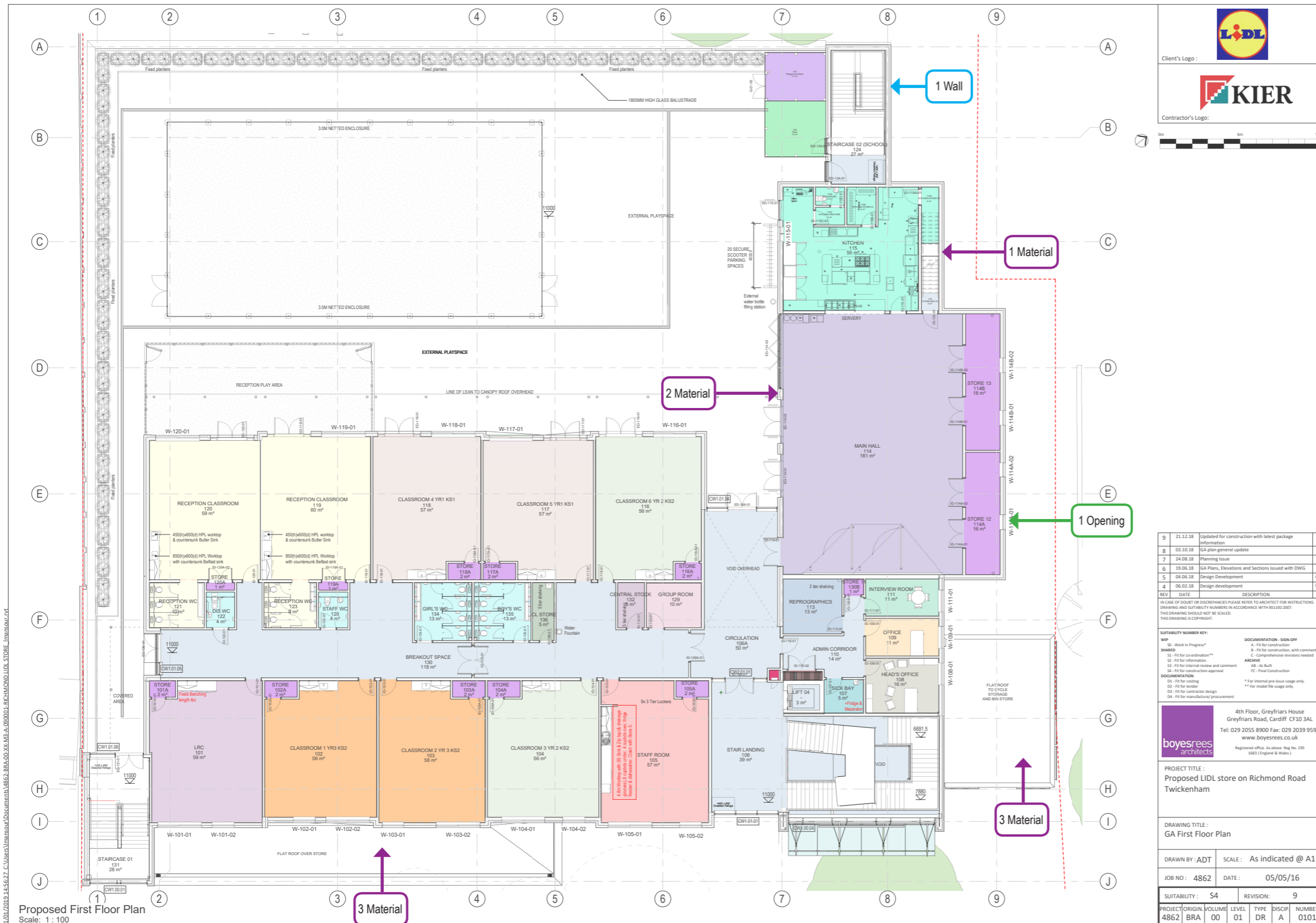

Client's Logo:

Contractor's Logo:

Scale: 0m, 5m, 10m

REV	DATE	DESCRIPTION	BY
9	21.12.18	Updated for construction with latest package information	JC
8	03.10.18	GA plan general update	TN
7	24.08.18	Planning Issue	JC
6	19.06.18	GA Plans, Elevations and Sections issued with DWG	JC
5	04.06.18	Design Development	SCP
4	06.02.18	Design development	WW

IN CASE OF DOUBT OR DISCREPANCIES PLEASE REFER TO ARCHITECT FOR INSTRUCTIONS. DRAWING AND SUITABILITY NUMBERS IN ACCORDANCE WITH BS192:2007. THIS DRAWING SHOULD NOT BE SCALED. THIS DRAWING IS COPYRIGHT.

SUITABILITY NUMBER KEY:	DOCUMENTATION - SIGN OFF
WP - Work in Progress**	A - Fit for construction
SD - Fit for co-ordination**	B - Fit for construction, with comments
S2 - Fit for information**	C - Comprehensive revisions needed
S3 - Fit for external review and comment	AB - As Built
S4 - Fit for construction approval	FC - Final Construction

DOCUMENTATION
 D1 - Fit for building
 D2 - Fit for tender
 D3 - Fit for contractor design
 D4 - Fit for manufacturing/procurement

* For internal pre-issue usage only
 ** For model file usage only

boyesrees architects
 4th Floor, Greyfriars House
 Greyfriars Road, Cardiff CF10 3AL
 Tel: 029 2055 8900 Fax: 029 2039 9592
 www.boyesrees.co.uk
 Registered office: Alabau Reg No 295
 1883 (England & Wales)

PROJECT TITLE:
 Proposed LIDL store on Richmond Road
 Twickenham

DRAWING TITLE:
 GA First Floor Plan

DRAWN BY: ADT SCALE: As indicated @ A1

JOB NO: 4862 DATE: 05/05/16

SUITABILITY: S4 REVISION: 9

PROJECT ORIGIN	VOLUME	LEVEL	TYPE	DISCIPLINE	NUMBER
4862	BRA	00	01	DR	A 0101