

Scenario 4

Large linked tree pits

Canopy diameter: 8m

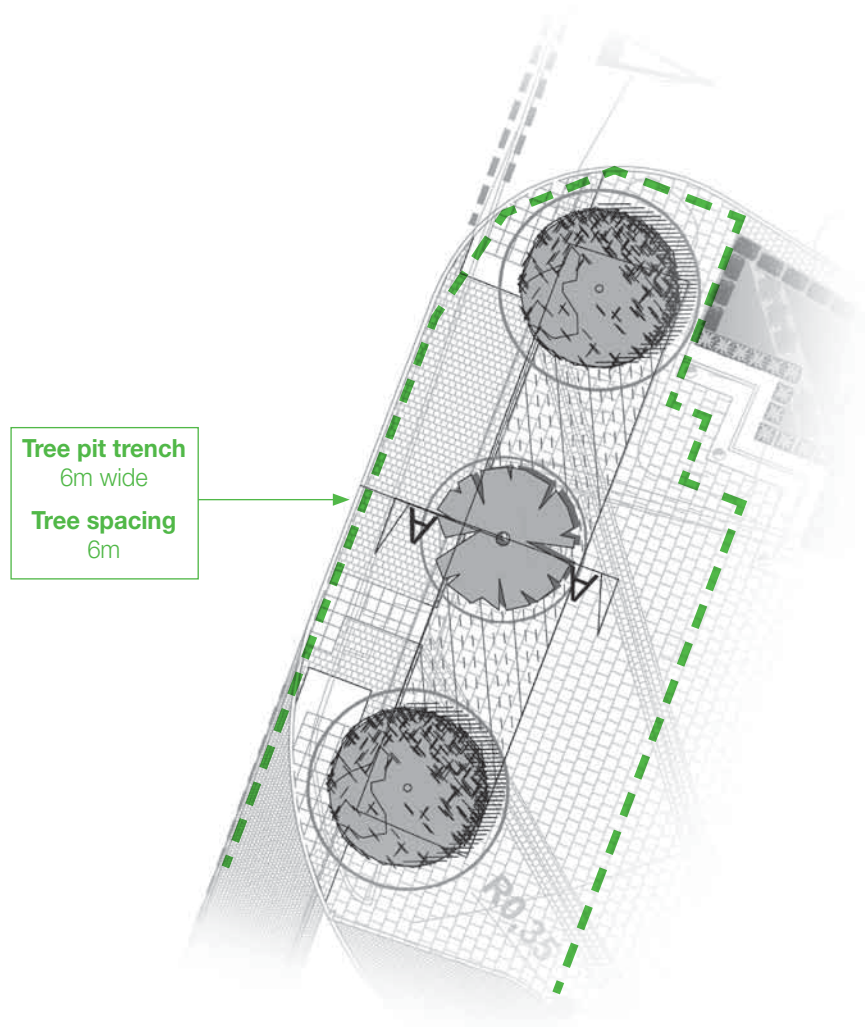

Calc 1	Projected Mature Canopy Diameter (metres)	= 8 (Diameter)
Calc 2	Projected Mature Canopy Area (square metres), ($\pi \times \text{Radius}^2$)	= 50 (Area)
Calc 3	Target Soil Volume (cubic metres), (Area x 0.6m)	= 30 (Volume)
	Target soil volume for my large tree	= 30 m³

Utilising **StrataCell** structural soil modules installed to a depth of 750mm (stacked 3 high) and based on the above plan dimensions, we can achieve in excess of 27 cubic metres of uncompacted soil volume. When trees are linked together, target soil volumes can be reduced by up to 20% as the roots will ultimately share each other's soil volume.