



**Notes**  
 1. Drawing not to be scaled for construction or setting out purposes.  
 2. To be read in conjunction with Project Risk Register REF: XXX  
 3. To be read in conjunction with all other Landscape Architect's drawings

**KEY**

- Full sun planting mix**  
 Cotinus coggygria  
 Deschampsia cespitosa  
 Rudbeckia fulgida var. sullivanti 'Goldsturm'  
 Salvia nemorosa 'Caradonna'  
 Stipa tenuissima
- Partial sun planting mix**  
 Aster frikartii 'Monch'  
 Geranium macrorrhizum 'White-Ness'  
 Pachysandra terminalis 'Green Carpet'  
 Rudbeckia fulgida var. sullivanti 'Goldsturm'  
 Saxifraga x urbium
- Entrance herbaceous planting mix**  
 Aster frikartii 'Monch'  
 Calamagrostis x acutiflora 'Karl Foerster'  
 Fatsia japonica  
 Geranium macrorrhizum 'White-Ness'  
 Lavendula angustifolia 'Hidcote'  
 Pachysandra terminalis 'Green Carpet'
- Amenity grass seeding**  
 Rolawn medallion turf or similar
- Woodland planting mix**  
 Amalanchier lamarkii  
 Acer campestre  
 Betula pendula  
 Crataegus monogyna  
 Cornus alba  
 Cornus sanguinea  
 Hazel Corylus avellana  
 Hawthorn  
 Lavendula angustifolia  
 Rosa canina  
 Rosmarinus  
 Sambucus nigra
- Green wall mix**  
 Euonymus fortunei 'Dart's Blanket'  
 Hedera helix 'Woerner'  
 Hedera helix 'Green Ripple'  
 Hedera hibernica  
 Parthenocissus tricuspidata
- Species rich grassland**
- Woodland Tree Mix**  
 Acer campestre  
 Acer platanoides  
 Betula pendula  
 Carpinus betulus  
 Prunus padus  
 Pinus sylvestris  
 Populus nigra  
 Tilia cordata  
 Tilia platyphyllos

**Planting Strategy**

Species	Density	Girth (cm)	Height (cm)	Clear Stem (cm)	RB
Acer platanoides	Standard (Extra)	18 - 20 cm	15 - 35 ft	250 cm	
Betula pendula		18-20cm	450-500cm	175-200cm	RB, 3x, Extra Heavy
Betulus carpinus 'Fastigiata'	As shown	18-20cm	450-500cm	1750-200cm	RB, 3x, Extra heavy
Carpinus betulus 'Fastigiata'	Standard (Extra)	18-20	35 - 50 ft	2m	
Tilia cordata 'Greenspire'		18-20cm	450-500cm	175-200cm	RB, 3x, Extra heavy

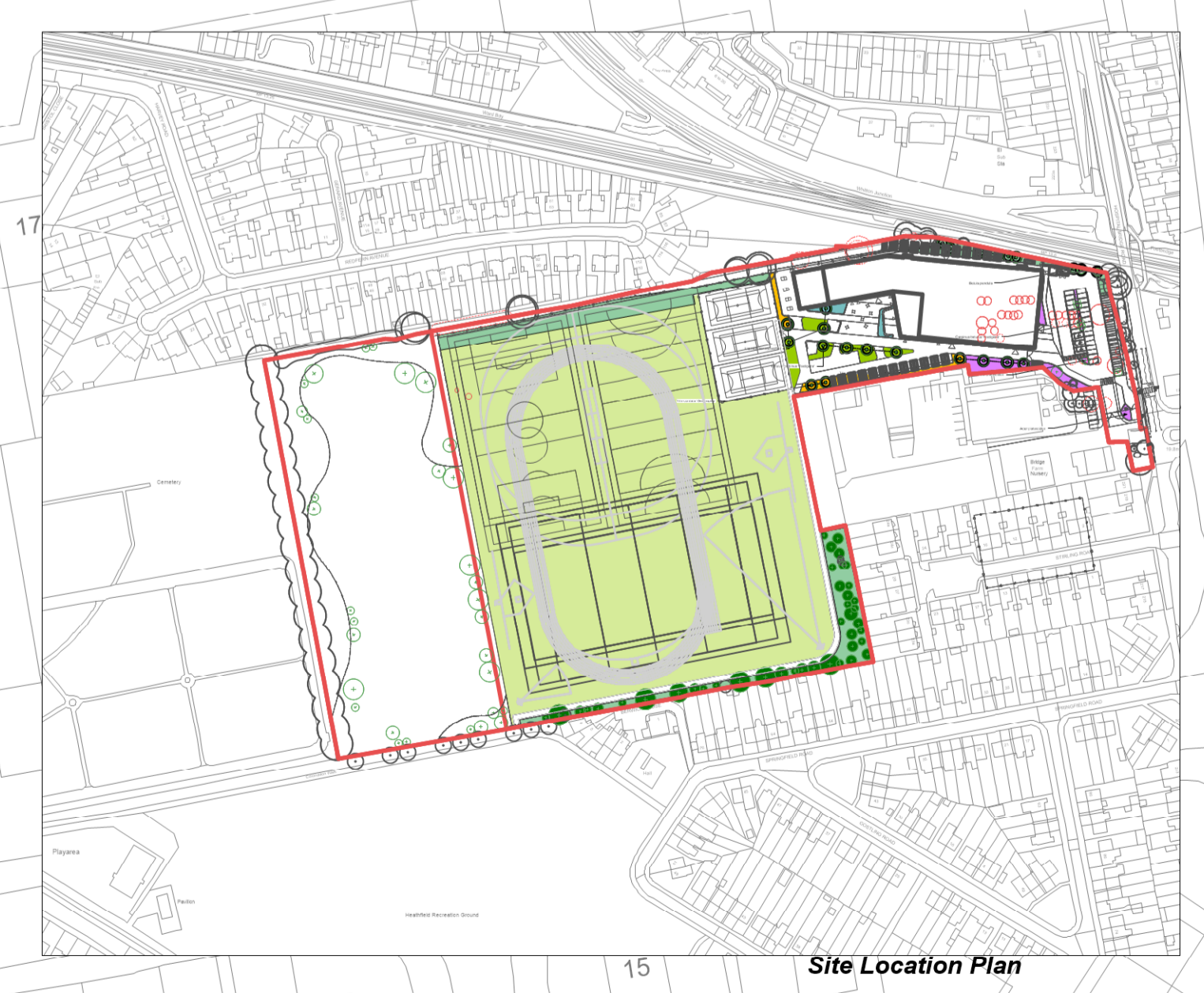

**RESIDUAL PROJECT RISKS**

ID	RISK	MITIGATION	Date Mitigated		
26.06.19	S2	P07	Fence line amended to protect Habitat Corridor	EZ	RA
31.05.19	S2	P06	Species amended to green screen	LA	LA
22.05.19	S2	P05	Fence line amended at 115 Berwick Ave Parking spaces amended	LA	LA
02.04.19	S2	P04	Car parking and tree removal strategy amended to reflect updated tree survey and be store and installation moved to accommodate ecology comments	LA	LA
07.02.19	S2	P03	Red Line Amended	HT	LA
13.11.18	S2	P02	Highways entrance and adjacent area updated	HT	LA

**REVISIONS**

SUITABILITY: **S2 - For Planning**

**ares** LANDSCAPE ARCHITECTS  
 Ares Landscape Architects LTD  
 Galecrasher  
 51 Eyre Lane  
 Sheffield  
 S1 4RB  
 t: 0114 276 2000  
 e: hello@ares.eu.com  
 w: ares.eu.com

CLIENT: **Bowmer and Kirkland**

PROJECT TITLE: **Turing House School**

DRAWING TITLE: **Planting Strategy**

DRAWING SCALE: 1:500  
 DRAWN BY: EC  
 DRAWN DATE: 02.03.2018  
 FRAME SIZE: A1  
 APPROVED BY: LA

DRAWING NUMBER: **EFATH-ALA-00-XX-DR-L-0014**  
 SUITABILITY: **S2**  
 REVISION: **P07**

