

Pupil Access

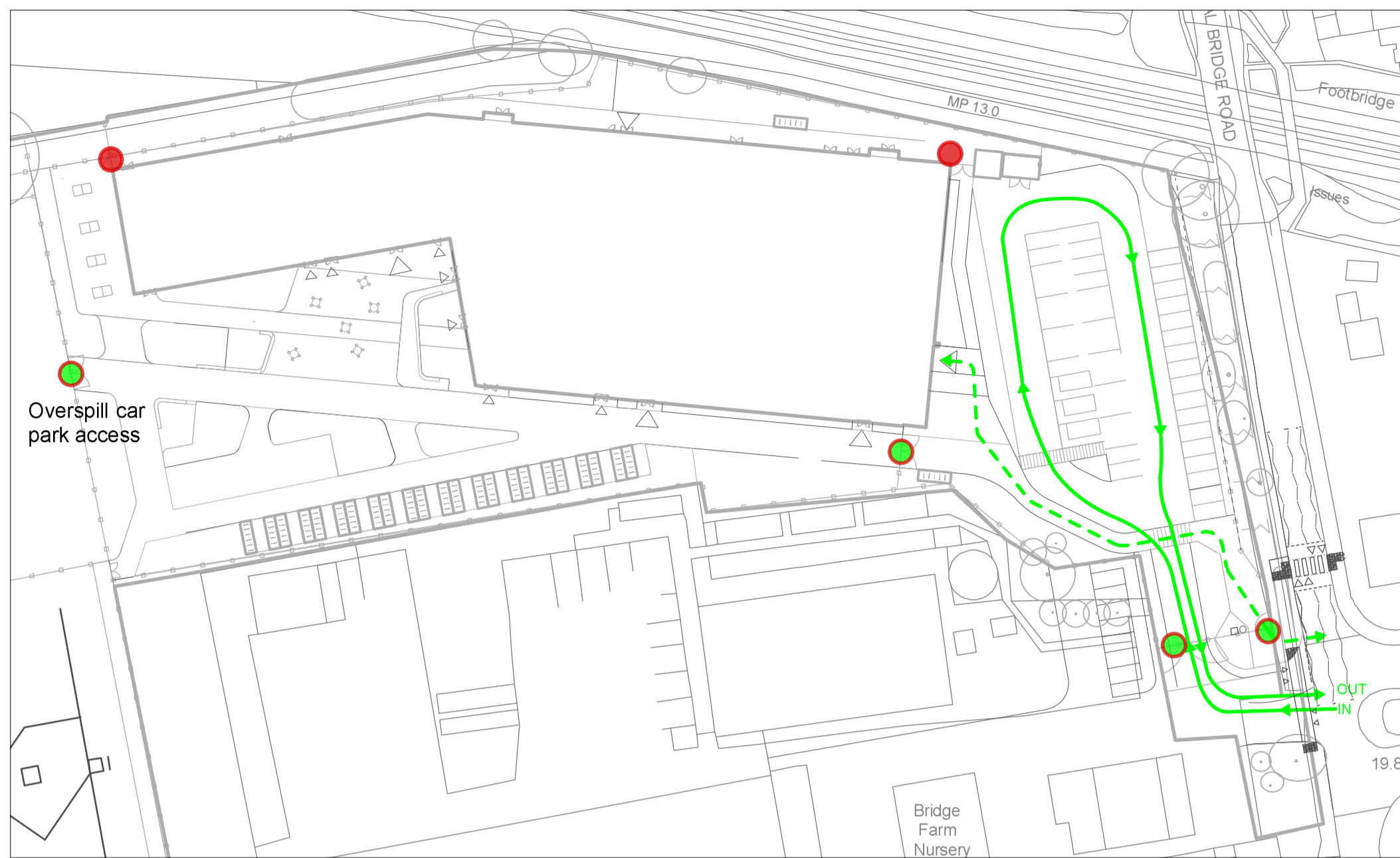

Visitor Access & Overspill Parking

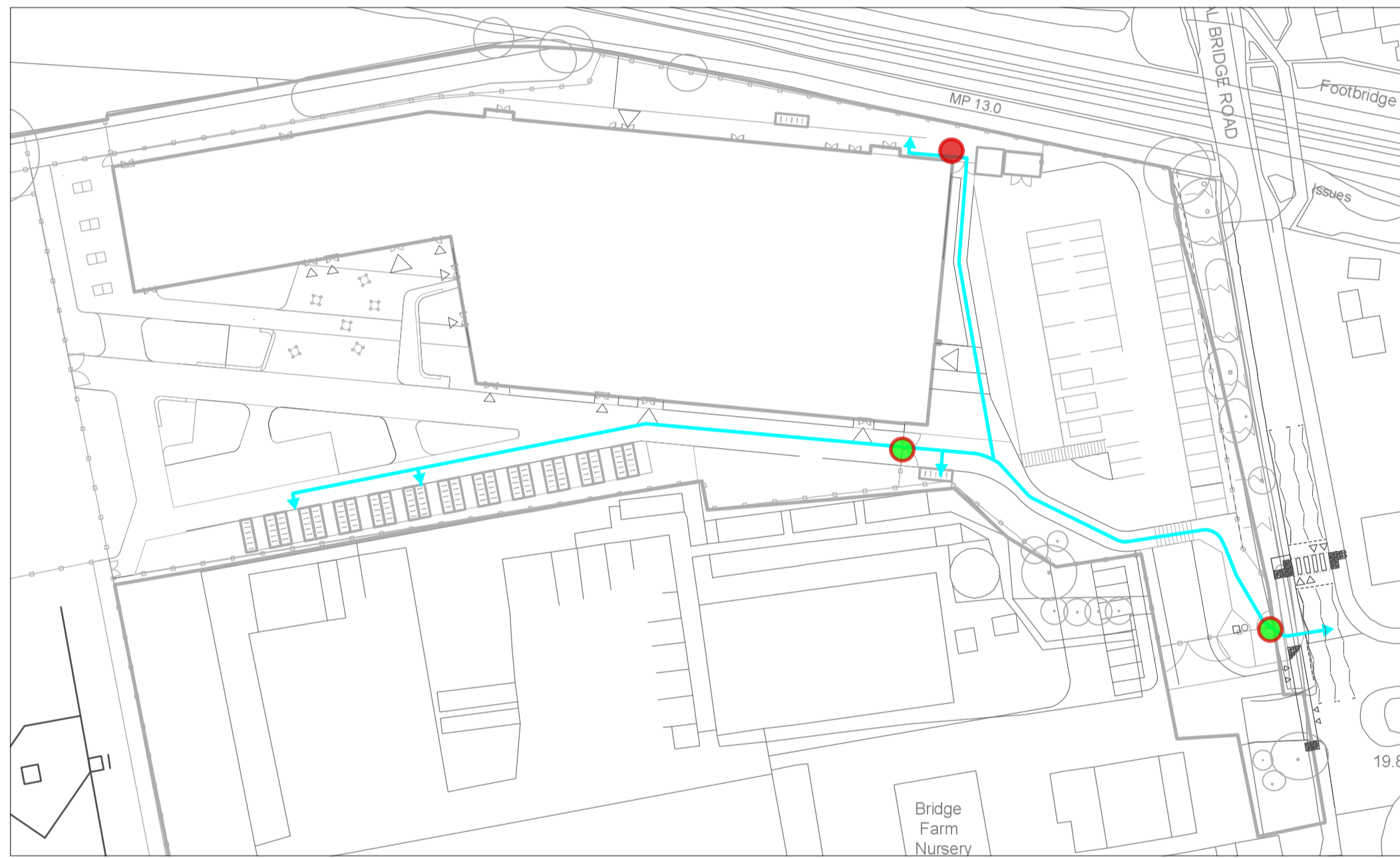

Cycle Access

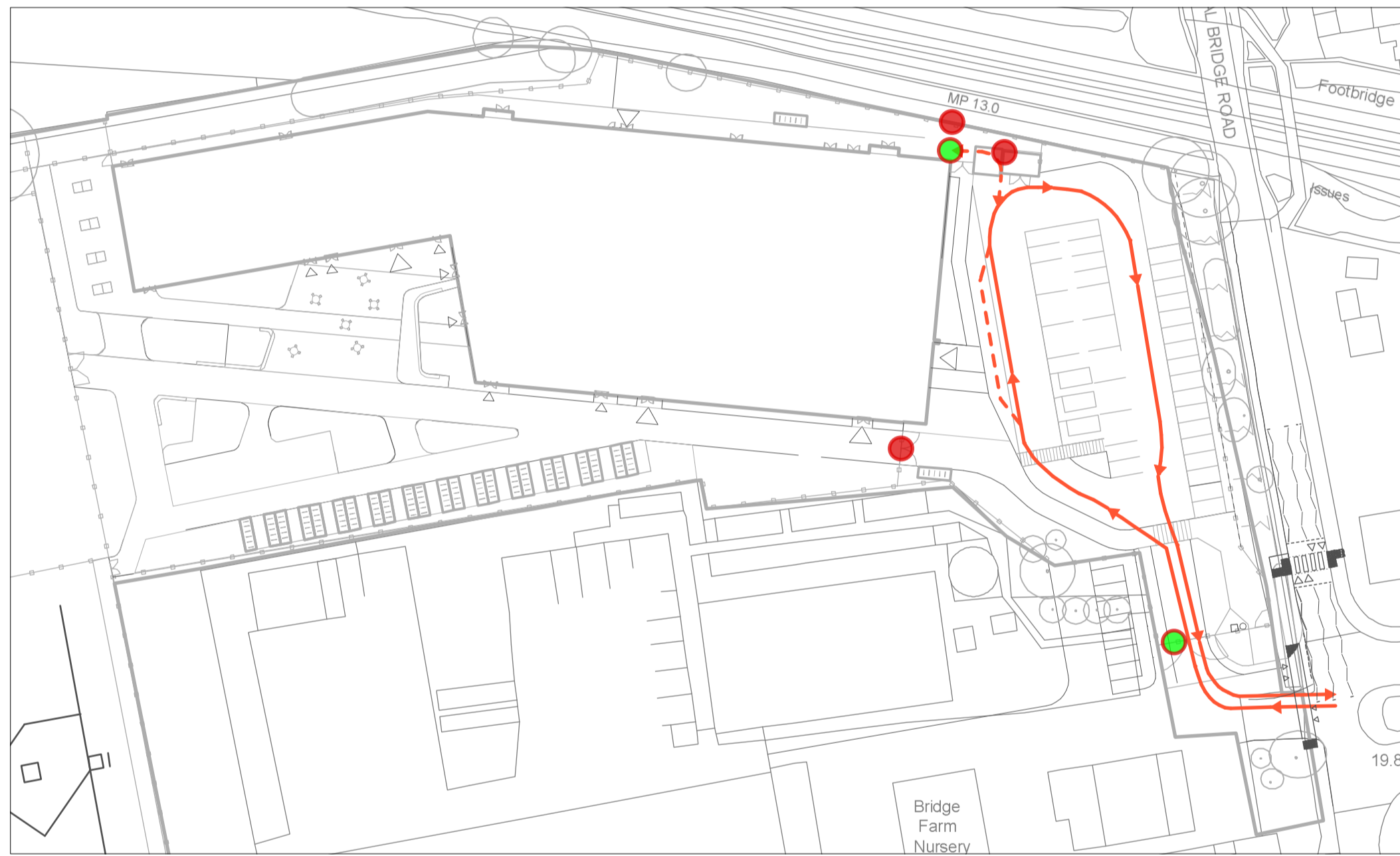

Deliveries Access

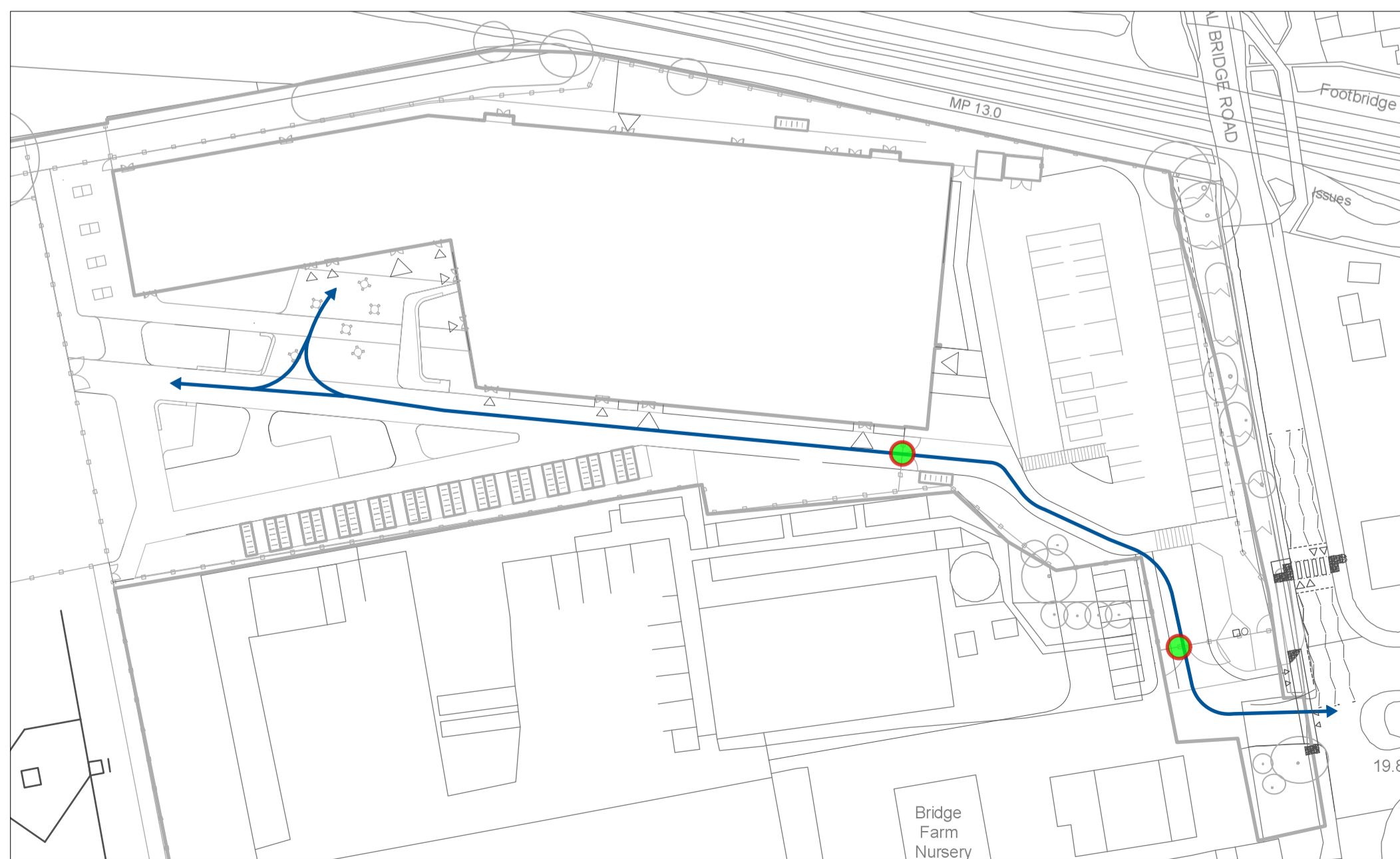

Fire Tender Access

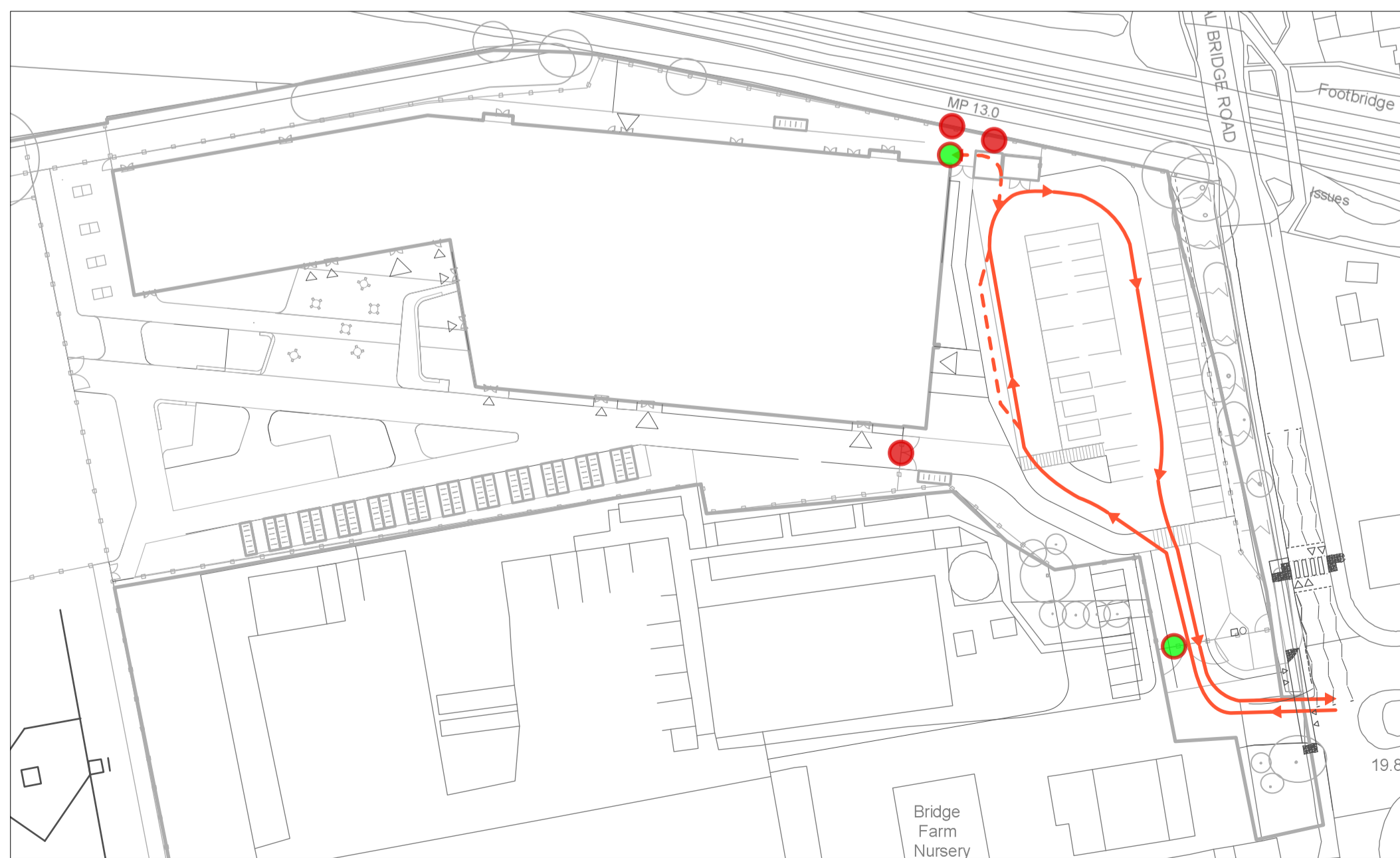

Maintenance/Bin Collection Access

Notes
 1. Drawing not to be scaled for construction or setting out purposes.
 2. To be read in conjunction with Project Risk Register REF: XXX
 3. To be read in conjunction with all other Landscape Architect's drawings

KEY

Gate Open
 Gate Closed

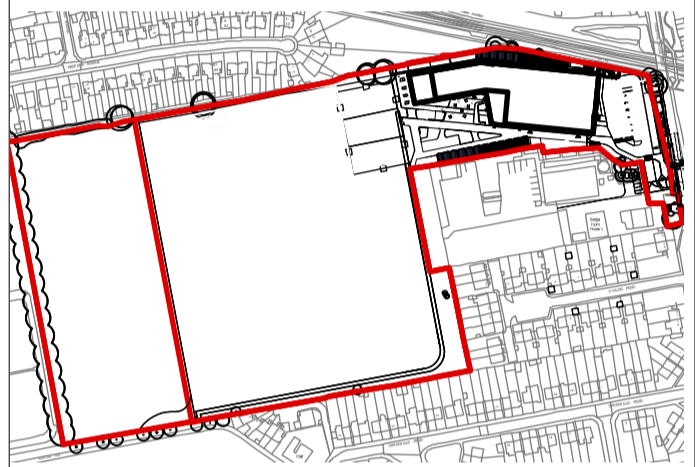

Location Plan

RESIDUAL PROJECT RISKS

ID	RISK	MITIGATION	Date Mitigated		
26.06.19	S2	P05	Face the amended to protect Habitat Corridor	EZ	RA
14.08.19	S2	P04	MOSA and pitches reserved to allow for 10m habitat corridor to the northern boundary	LA	LA
07.02.19	S2	P03	Red Line Amended	HT	LA
13.11.18	S2	P02	Highways entrance and adjacent area updated	HT	LA

REVISIONS

SUITABILITY
S2 - FOR PLANNING

ares LANDSCAPE ARCHITECTS
 Ares Landscape Architects LTD
 Galbraith
 51 Eyre Lane
 Sheffield
 S1 4RB
 t: 0114 276 2000
 e: hello@ares.eu.com
 w: ares.eu.com

CLIENT:
Bowmer and Kirkland

PROJECT TITLE:
Turing House School

DRAWING TITLE:
Access and Circulation

DRAWING SCALE: Illustrative Purposes Only
 DRAWN BY: EC
 APPROVED BY: LA
 DRAWN DATE: 11.04.2018

DRAWING NUMBER: **EFATH-ALA-00-XX-DR-L-0007**
 SUITABILITY: **S2**
 REVISION: **P05**