

DO NOT SCALE

### SAFETY, HEALTH AND ENVIRONMENTAL INFORMATION

In addition to the hazards/risks normally associated with the types of work detailed on this drawing, note the following:

#### CONSTRUCTION

- Demolition works associated with removal of existing building walls and construction of new internal walls, risk of collapse.
- Working at height for works at high internal levels.
- Working with plant & machinery, risk of collision or electrocution



#### MAINTENANCE/CLEANING

- Working at height for installation of high level construction and proposed finishes.
- Working in confined spaces or voids, for servicing of any mechanical/electrical services

#### DECOMMISSIONING/DEMOLITION

- Demolition works associated with removal of existing building walls and construction of new internal walls, risk of collapse.
- Working at height for works at high levels.
- Risk associated with the stripping of existing services.

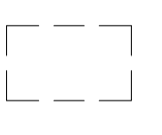
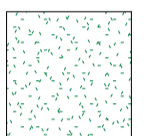
It is assumed that all works will be carried out by a competent contractor working, where appropriate, to an approved method statement

-  Rain water outlets
-  Solar photo-voltaic panel with fixed tilt to 12° off horizontal (1650 x 991 x 325mm to top of panel)
-  Green Roof Bauder's XF118 Wildflower Blanket - approx 815 m<sup>2</sup> (~70% of Available Roof Area)
-  Rooflights
-  Available roof area approx 1150 m<sup>2</sup>

Rev.	Date	Description	By	Chk'd	App'd
------	------	-------------	----	-------	-------

Drawing Suitability: **PLANNING** Status: **S2**

**SNC-LAVALIN**  
Atkins  
11 Bressenden Place  
Westminster  
London SW1E 5BY  
Tel: +44 (0) 20 7121 2000  
www.atkinsglobal.com  
© SNC-Lavalin (2019)

Client:  
Richmond upon Thames College  
Egerton Road  
Twickenham TW2 7SL



Project Title:  
**Richmond Upon Thames College STEM Building**

Drawing Title:  
**Level Roof - Proposed Plan**

Scale	Designed	Drawn	Checked	Authorised
1 : 100	TL	AS	TL	
Original Size	Date	Date	Date	Date
A1	12.06.19	09.07.19	12.07.19	
Drawing Number	Revision			
5186066-ATK-V1-RF-DR-A-1300	-			

100  
0 10  
Millimetres

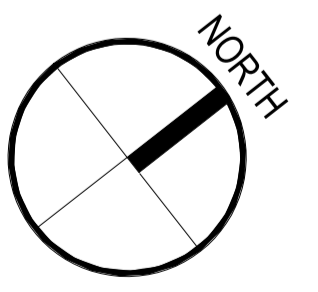
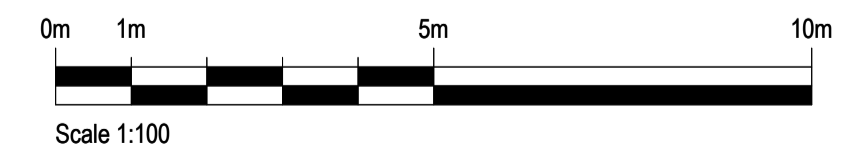
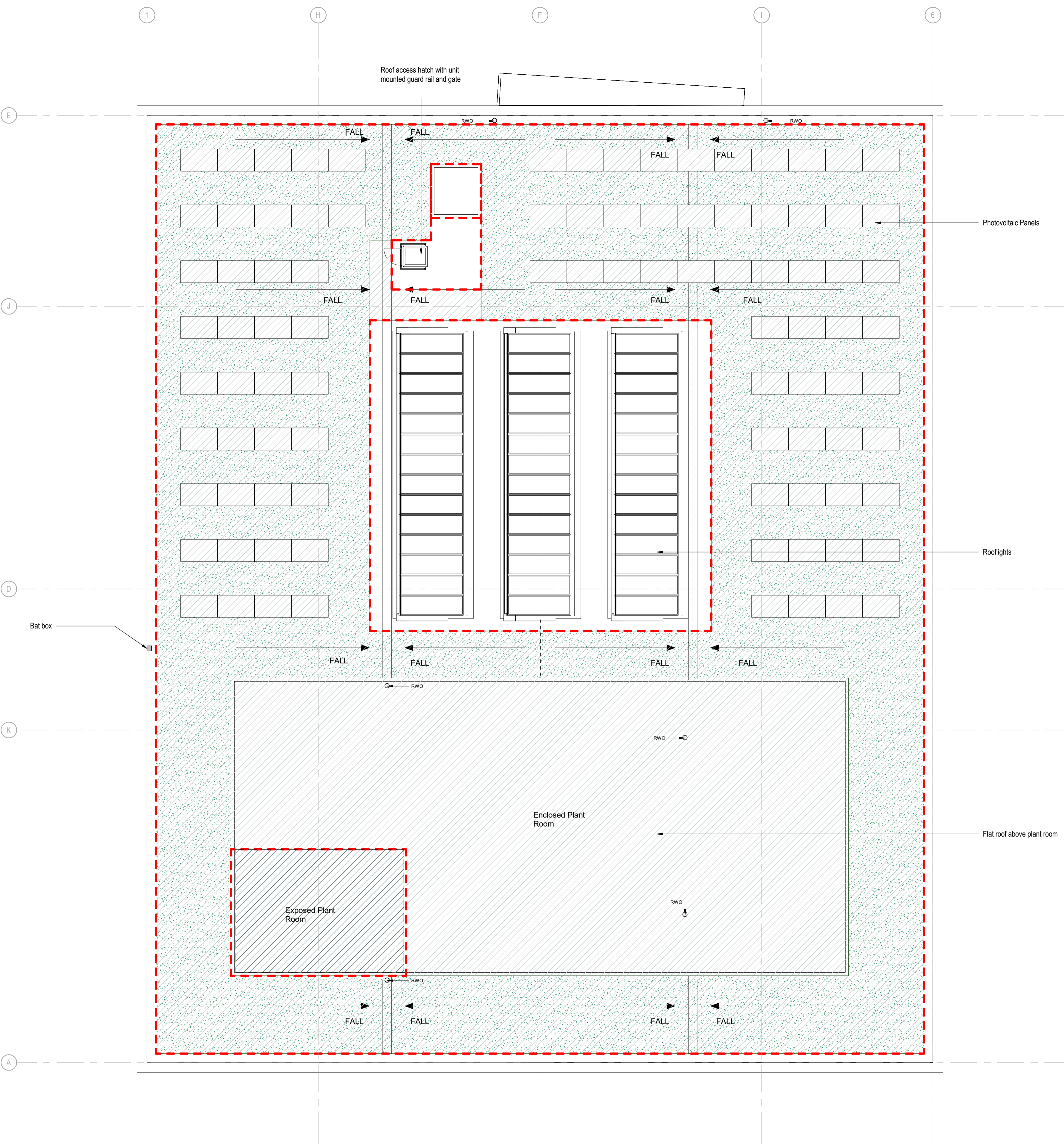

**1** Level 4 - Proposed Plan  
SCALE 1 : 100

Atkins Project Number: 5186066