

# Semi-Intensive Green Roof System

Dimensions are not to be scaled from this drawing.  
 This drawing is based on current available information and should not be relied on as accurate measurements of usable space.  
 This drawing is the property of the Colman Partnership Ltd. and Copyright is reserved by them. The drawing is issued on condition that it is not copied or disclosed by or to any unauthorised persons without the prior consent in writing of the Colman Partnership Ltd.

Rev	Notes	By	Date
P1	Planning Issue	DLa	05/07/19

## Brief Description

Semi-intensive roof greening with high ecological value, high biodiversity of flora and fauna and use of recycled plastic materials.

The nature roof solution increase the aesthetic value from upper floor windows with a high level of biodiversity and high ecological value. It is a perfect habitat for butterflies and other insects.

It allows the storm water attenuation and improves drainage.

The Green Roof is to be non-accessible to the public.

## Typical Roof Build-up

\*500mm Wide gravel perimeter to Green Roof and Plant Area to provide fire break between the structure and Green Roof

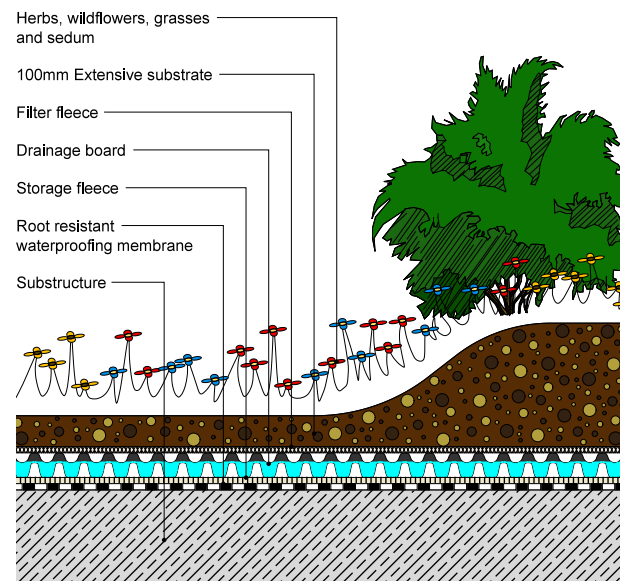

## Technical Data

- 0-5° Semi-Intensive Green Roof to the proposed Fourth Floor.
- 145mm Deep multi-layered system.
- 60-70% Water retention.
- High level of biodiversity.
- High ecological value.
- Long flowering window annually.
- Use of recycled plastic materials.



## Plant List

- Achillea tomentosa - Anthemis tinctoria - Hieracium pilosella - Potentilla verna - Sedum reflexum - Sedum sexangulare
- Hieracium x rubrum
- Dianthus carthusianorum - Sanguisorba minor - Saponaria ocymoides - Sedum spurium
- Allium schoenoprasum - Centaurea scabiosa
- Thymus montanus - Thymus serpyllum
- Verbascum phoeniceum - Veronica teucrium
- Achillea millefolium - Antennaria dioica - Chrysanthemum leucanthemum - Petrorhagia saxifraga - Sedum album
- Grasses:  
 Carex flacca - Carex humilis - Festuca amethystina - Festuca ovina - Poa compressa



## Roof Plan @ 1:500

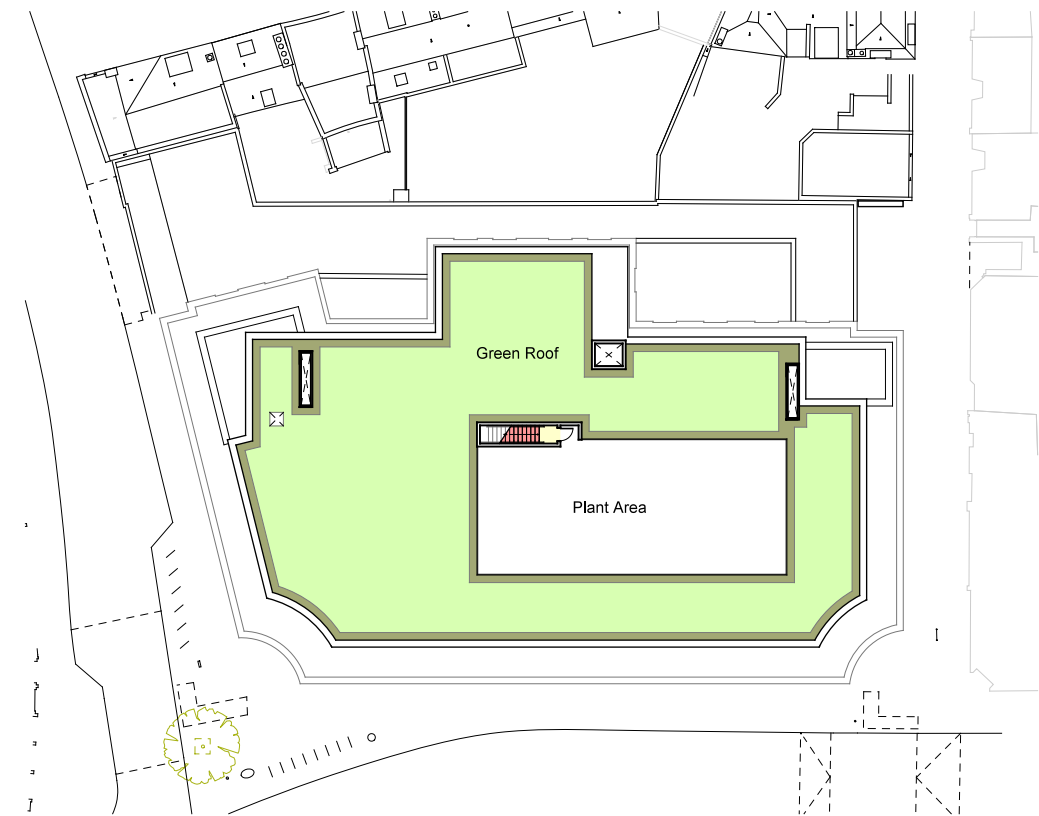

## Maintenance

Following 'handover', maintenance is required throughout the Development Care period, which allows the continued growth of species on the Roof until the target coverage is achieved.

After the 90% target vegetation coverage has been reached (2-4 years) ongoing maintenance care will be necessary. Maintenance will be required twice annually and be will undertaken from a mansafe system fitted to the Roof. Access to the Roof will be provided via the Office Reception and Stair 2 Core.

PLANNING ISSUE

## References



Project  
 75-81 George Street  
 Richmond, TW9 1HA

Title  
 Proposed Landscape Strategy  
 Semi-Intensive Green Roof

Scale 1:500@ A3	Date 29/06/2017
Drawn by DLa	Checked by Proj. Arch. Checked By Manager
Drawing No. 1720/P(90.4)01	Revision P1

The Colman Partnership Limited  
 27 Harcourt Street  
 London  
 W1H 4HP  
 Telephone: 020 7535 2040  
 Facsimile : 020 7535 2041  
 email: projects@colmanarchitects.co.uk

[www.colmanarchitects.co.uk](http://www.colmanarchitects.co.uk)

CAD Filename: \$FILES\$.SDAT13