

2 & 4th FLOORS
 RICHMOND LOCK
 PHASE 1

RIVER THAMES



OFFICE COPY
 DO NOT REMOVE FROM FILE

NOTES

Existing trees to be retained shown thus.

New trees to be planted shown thus.
 (Refer to Elizabeth Banks Associates drawings for detailed design)

Black painted 3.5m high lamp column with black painted lantern and polycarbonate vented-proof glass with metal finials lamps.

Basement access kiosks shown thus.

LANDSCAPING
 See Landscape Architect Elizabeth Banks Associates' report, recommendations and detailed proposal drawings for information on trees to be removed and new trees and shrubs to be planted.

Existing boundary walls to be retained except where altered by the proposals.

Proposed walls are shown by double line and are to be facing brickwork 21cm thick and 1.5m high with brick on edge coping on double course of the creasing.

Proposed exterior fence enclosing new garden area from public spaces are shown by single line and are to comprise 1.5m high close boarded with 150mm gravel board and with 450mm high and bugler finials on top.

Rain boundary fences between new houses are to be 1.2m high black plastic coated chain link fences.

New black glass painted metal railings are to be provided where indicated on plan.

Tree Protection Fencing
 Prior to any construction works on storage of materials on site and during construction, measures are to be implemented in accordance with report and specifications prepared by Cive Power Associates. This fencing is to remain in place during construction works. All Public Highway Cleanliness measures are to be put in place before any operations which involve the movement of materials in bulk either to or from the site are commenced.

Every vehicle will be visually inspected before leaving the site. All mud and debris will be cleaned off from wheels etc. by brushing by hand before the vehicle is allowed to leave. Suitable drainage will be put in place to ensure that no water or mud flows onto the highway.

The adjacent highway will be inspected regularly off as they working day and any accidental deposits cleaned off as they occur.

The adjacent highway will be additionally inspected at the end of each working day to leave the highway clear, unobstructed and all vehicles.

All as indicated on site plan.

Fencing
 All as indicated on site plan.

Proposed access to be built coloured pcc paving slabs with brick edging.

Safety improvements to existing highways.
 See report and detailed proposal drawings prepared by Mouchel Consulting Limited.

Flood Risk Assessment
 Flood risk assessment report. Arrangement will be put in place to exclude flood water from the site to a maximum flood level of 5.94m AOD.

Land Buildings
 See Paul Davis & Partners drawings showing details of Knight and Chapel buildings exist in the north east corner of the site.

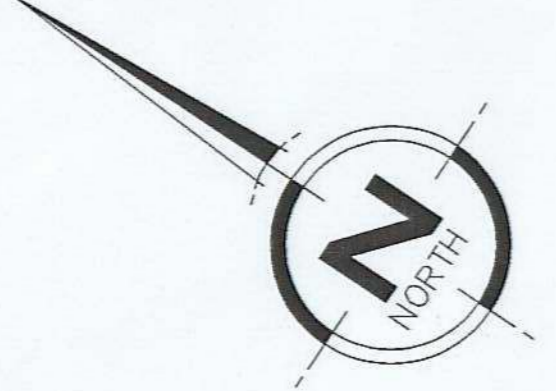

06/21/11/12