



Existing 06:00pm



Proposed 06:00pm

June 21st (BST)

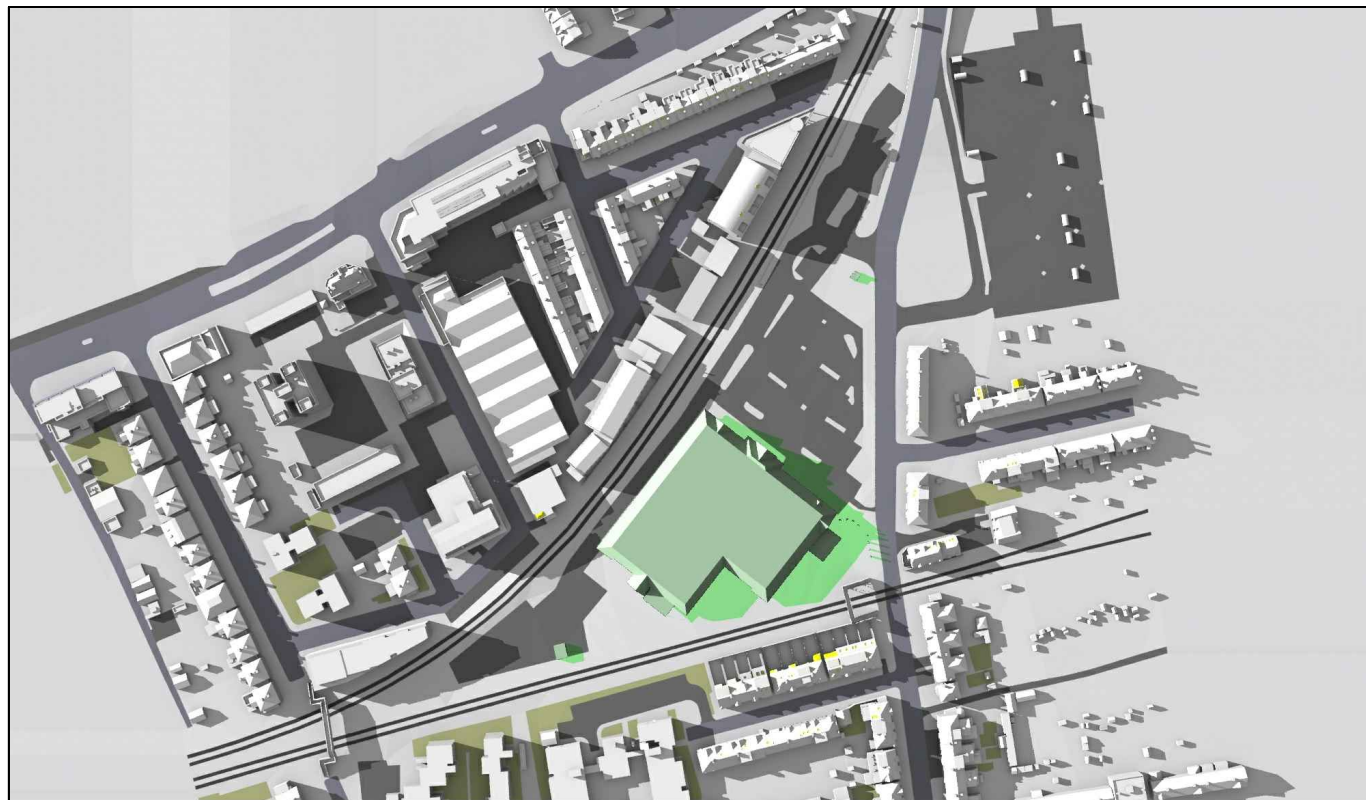

Existing 07:00pm

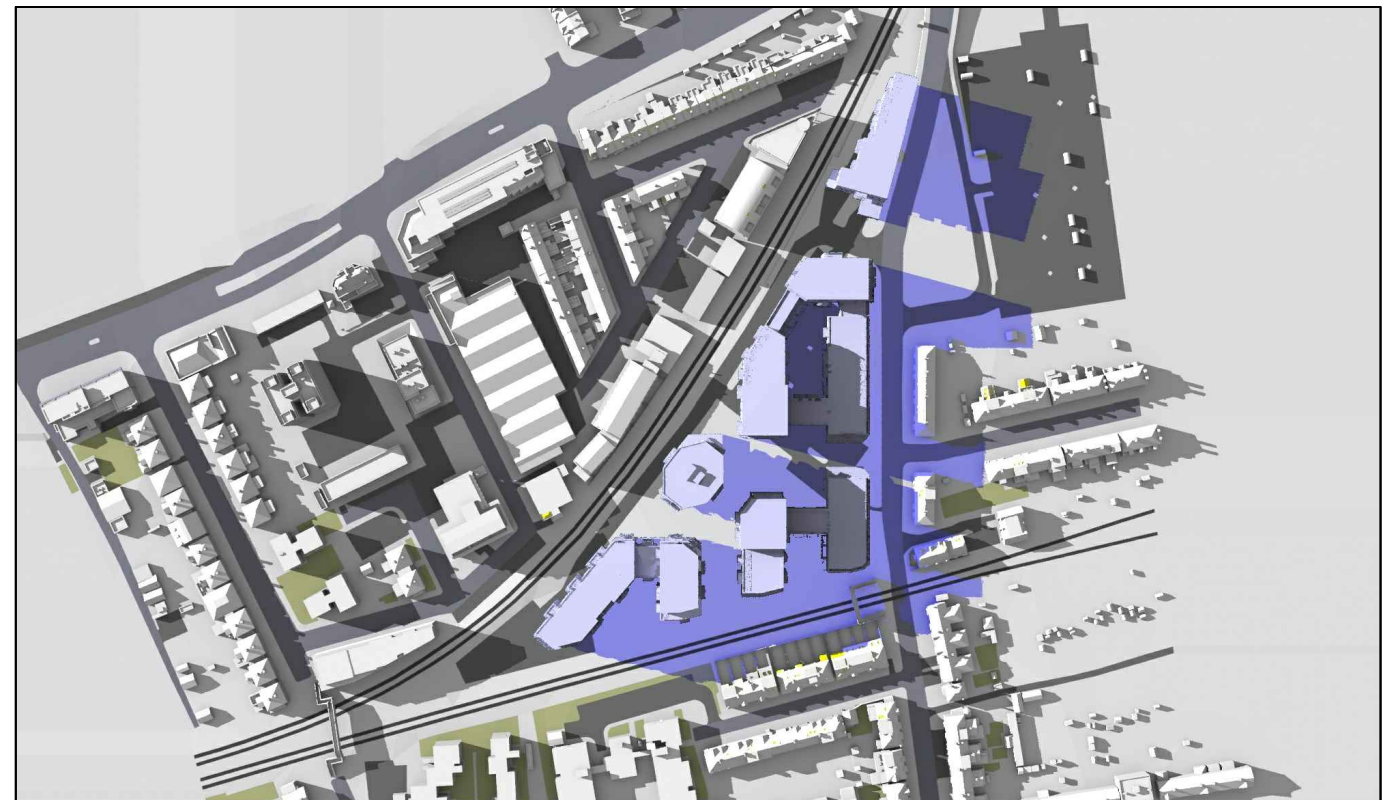

Proposed 07:00pm

Sources: Point 2 Surveyors  
Survey Info  
Point Cloud Data

Assael Architecture Limited  
3D Models (received 31/10/19)  
A3004 2-7-1 ENVELOPE AND PARTY-A1, A2 & A3.dwg  
A3004 2-7-1 ENVELOPE AND PARTY-B.dwg  
A3004 2-7-1 ENVELOPE AND PARTY-C1&C2.dwg  
A3004 2-7-1 ENVELOPE AND PARTY-D1 & D2.dwg  
A3004 2-7-1 ENVELOPE AND PARTY-E.dwg  
3D Model + 2D Drawings (received 08/11/19)  
A3004 2-7-1 ENVELOPE AND PARTY-E.dwg  
MNR-AA-BLE-ZZ-DR-A-(4500\_4503)-R3.dwg  
MNR-AA-BE1-(GF\_05)-DR-A-2601-R6 .dwg

Key:

- Grey shadows are those caused by buildings which are not on the site under development.
- Green shadows are those caused specifically by the existing buildings on the site.
- Blue shadows are those caused specifically by the proposed development.

Project: Homebase  
Richmond

Title: Transient Overshadowing  
Existing vs Proposed Scheme Dated 08/11/19

Scheme Confirmed: --

Date: --

Drawn By:  
JR

Scale:  
NTS

Date:  
Nov 19

Dwg No:  
**P1685/JUN02/07**

Rel:  
**10**



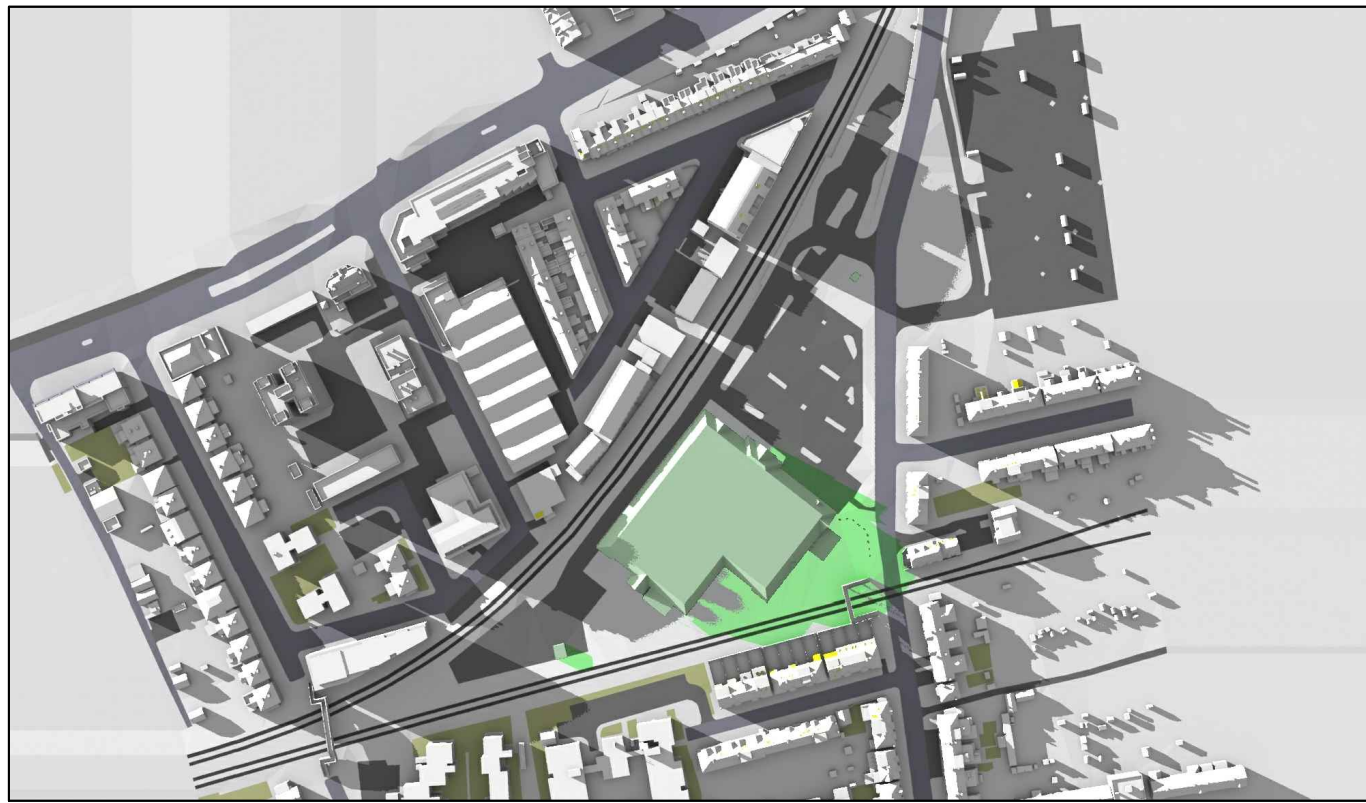

Existing 08:00pm

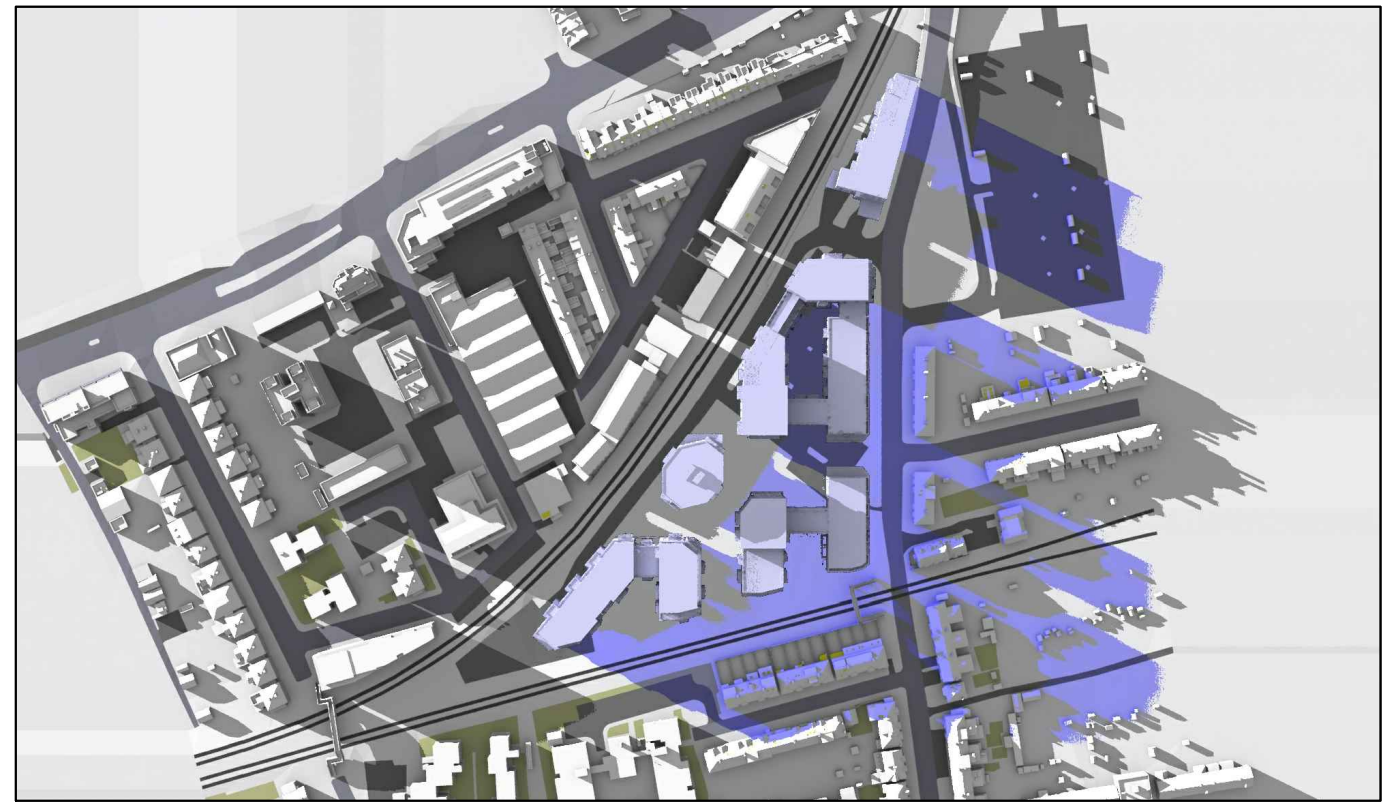

Proposed 08:00pm

June 21st (BST)



Existing 09:00pm



Proposed 09:00pm

Sources: Point 2 Surveyors  
Survey Info  
Point Cloud Data

Assael Architecture Limited  
3D Models (received 31/10/19)  
A3004 2-7-1 ENVELOPE AND PARTY-A1, A2 & A3.dwg  
A3004 2-7-1 ENVELOPE AND PARTY-B.dwg  
A3004 2-7-1 ENVELOPE AND PARTY-C1&C2.dwg  
A3004 2-7-1 ENVELOPE AND PARTY-D1 & D2.dwg  
A3004 2-7-1 ENVELOPE AND PARTY-E.dwg  
3D Model + 2D Drawings (received 08/11/19)  
A3004 2-7-1 ENVELOPE AND PARTY-E.dwg  
MNR-AA-BLE-ZZ-DR-A-(4500\_4503)-R3.dwg  
MNR-AA-BE1-(GF\_05)-DR-A-2601-R6 .dwg

**Key:**

- Grey shadows are those caused by buildings which are not on the site under development.
- Green shadows are those caused specifically by the existing buildings on the site.
- Blue shadows are those caused specifically by the proposed development.

**Project:** Homebase Richmond

**Title:** Transient Overshadowing Existing vs Proposed Scheme Dated 08/11/19

**Scheme Confirmed:** --

**Date:** --

**Drawn By:** JR

**Scale:** NTS

**Date:** Nov 19

**Dwg No:** P1685/JUN02/08

**Rel:** 10

