



Dimensions are not to be scaled from this drawing.
 This drawing is based on current available information and should not be relied on as accurate measurements of usable space.
 This drawing is the property of the Colman Partnership Ltd. and Copyright is reserved by them. The drawing is issued on condition that it is not copied or disclosed by or to any unauthorised persons without the prior consent in writing of the Colman Partnership Ltd.

Rev	Notes	By	Date
A	New Development	TD	01/05/18
B	Revised to Client Comments	TD	12/06/18
C	Revised following meeting with Planners	TD	06/09/18
D	Office Core Revised	TD	20/09/18
E	Scheme revised following design team meeting	TD	09/10/18
F	Revised for Pre-App	TD	09/10/18
G	Revised to include Survey Information	TD	30/11/18
H	Revised to PreApp Meeting comments	TD	10/01/19

KEY
 - - - - - Line of Potential Unit Division



INFORMATION ONLY



colman architects

75 - 81, George Street, Richmond,
 TW9 1HA

Proposed
 Ground Floor Plan

Scale	1:200 @ A3	1:100 @ A1	Date	29/06/2017
Drawn by	TD	Checked by Proj. Arch.	Checked By Manager	TD
Drawing No.	1720/L(--)	110	Revision	H

The Colman Partnership Limited
 27 Harcourt Street
 London W1H 4HP
 Telephone: 020 7535 2040
 Facsimile: 020 7535 2041
 email: projects@colmanarchitects.co.uk

www.colmanarchitects.co.uk
 CAD Filename: SFILES
 S04TES

Dimensions are not to be scaled from this drawing.
 This drawing is based on current available information and should not be relied on as accurate measurements of usable space.
 This drawing is the property of the Colman Partnership Ltd. and Copyright is reserved by them. The drawing is issued on condition that it is not copied or disclosed by or to any unauthorised persons without the prior consent in writing of the Colman Partnership Ltd.

Rev	Notes	By	Date
A	New Development	TD	01/05/18
B	Revised to Client Comments	TD	12/06/18
C	Revised following meeting with Planners	TD	06/09/18
D	Office Core Revised	TD	20/09/18
E	Scheme revised following design team meeting	TD	09/10/18
F	Revised for Pre-App	TD	09/10/18
G	Revised to include Survey Information	TD	30/11/18
H	Revised to PreApp Meeting comments	TD	10/01/19

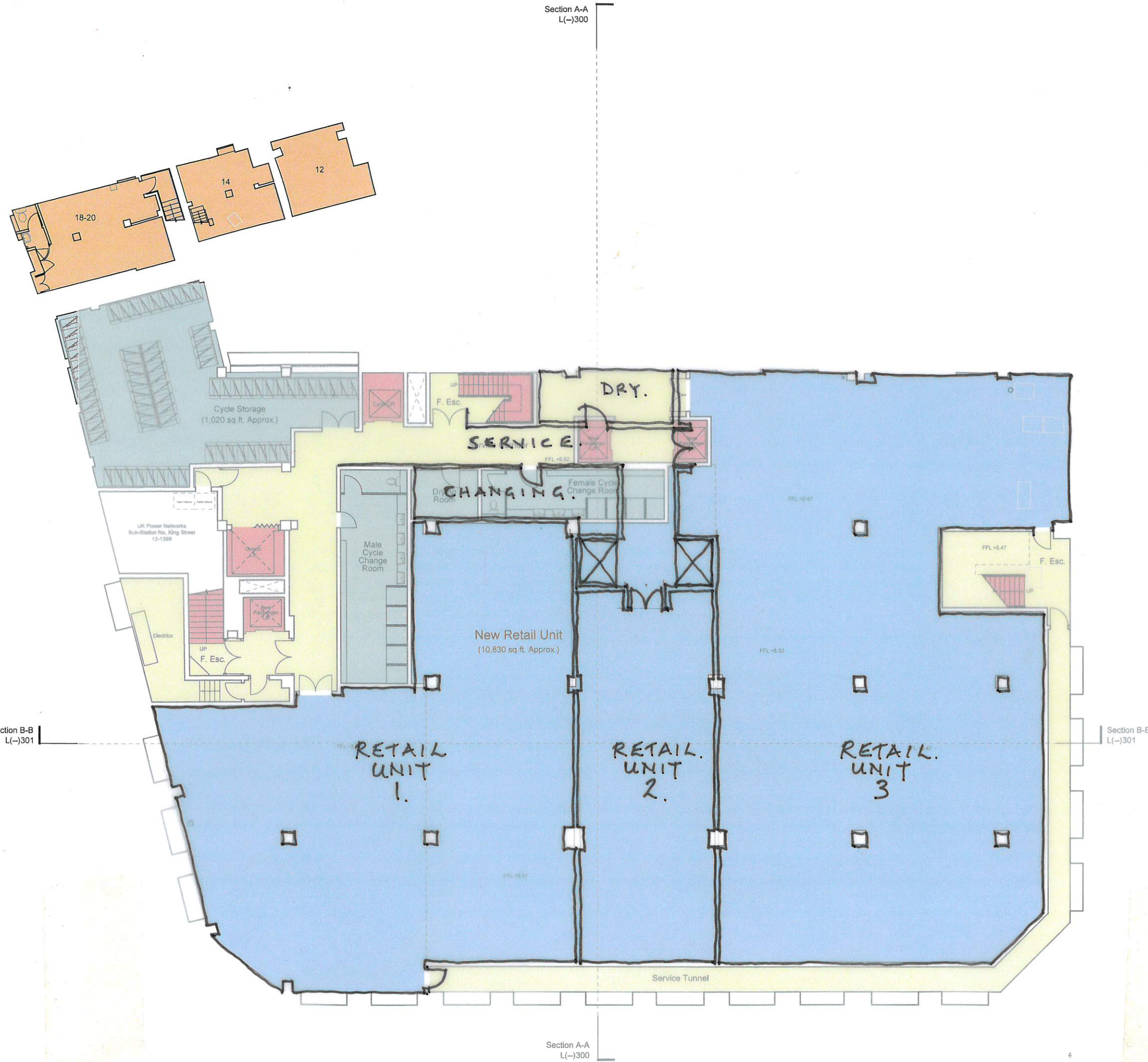

KEY
 - - - - - Line of Potential Unit Division



INFORMATION ONLY
 0 1 2 5 10m

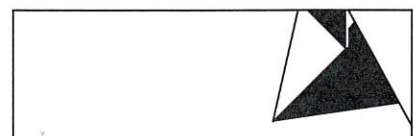

colman architects

Project
 75 - 81, George Street, Richmond,
 TW9 1HA

Title
 Proposed
 Basement Floor Plan

Scale	Date
1:200 @ A3	29/06/2017
1:100 @ A1	
Drawn by TD	Checked By Manager TD
Drawing No. 1720/L(--)-109	Revision H

The Colman Partnership Limited
 27 Harcourt Street
 London
 W1H 4HP
 Telephone: 020 7535 2040
 Facsimile: 020 7535 2041
 email: projects@colmanarchitects.co.uk
www.colmanarchitects.co.uk