

100
Millimetres
0 10

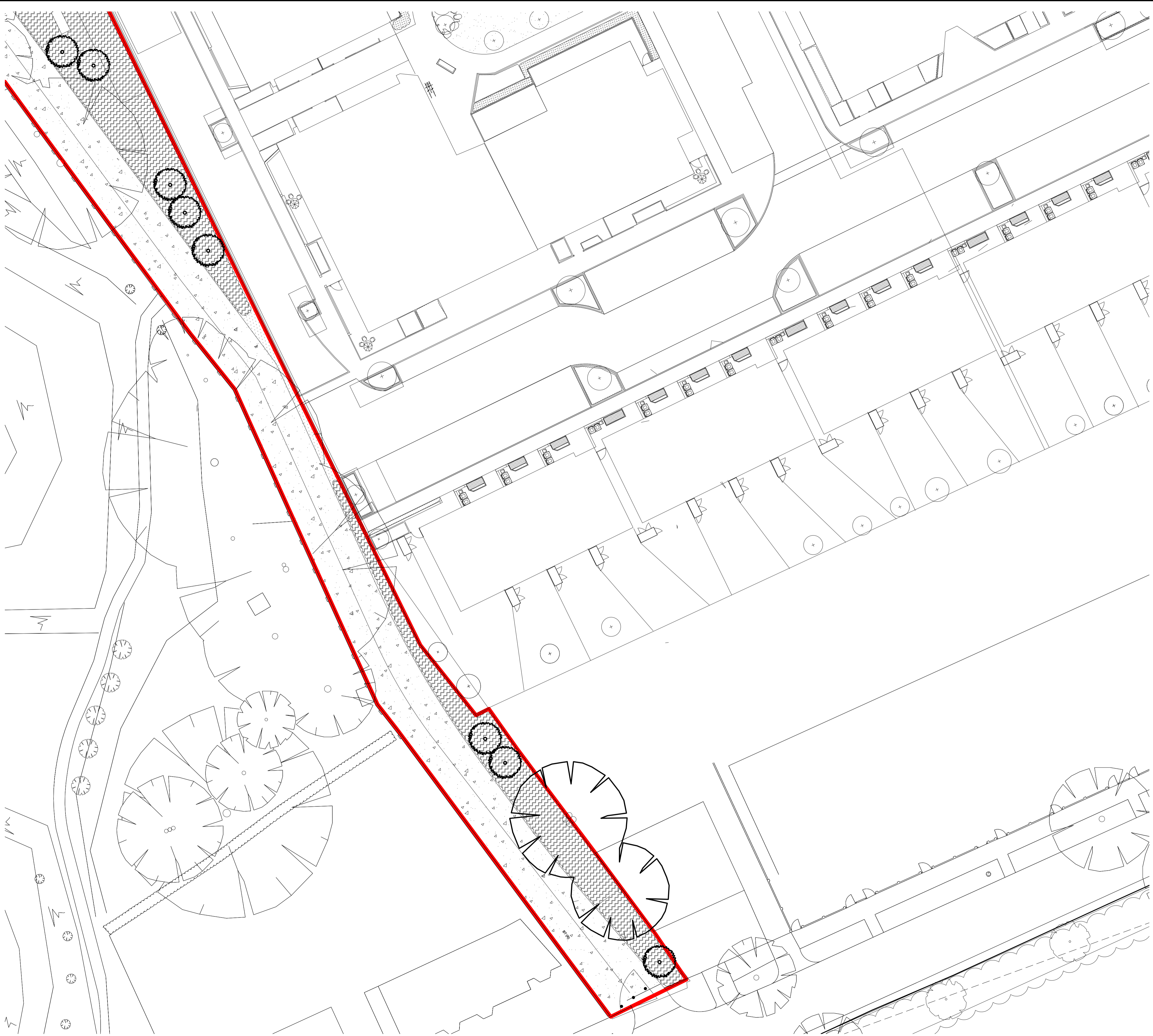

DO NOT SCALE

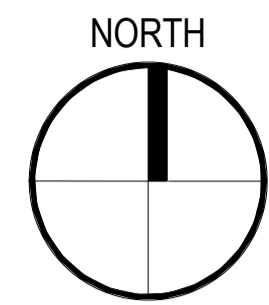

SAFETY, HEALTH AND ENVIRONMENTAL INFORMATION

In addition to the hazards/risks normally associated with the types of work detailed on this drawing, note the following:

CONSTRUCTION

- Demolition works associated with removal of existing building walls and construction of new internal walls, risk of collapse.
- Working at height for works at high internal levels.
- Working with plant & machinery, risk of collision or electrocution

MAINTENANCE/CLEANING

- Working at height for installation of high level construction and proposed finishes.
- Working in confined spaces or voids, for servicing of any mechanical/electrical services

DECOMMISSIONING/DEMOLITION

- Demolition works associated with removal of existing building walls and construction of new internal walls, risk of collapse.
- Working at height for works at high levels.
- Risk associated with the stripping of existing services.

It is assumed that all works will be carried out by a competent contractor working, where appropriate, to an approved method statement

Landscape drawings based on LUC drawing (6377-LD-PLN-160-GA_10) Issue 10

Rev.	Date	Description	By	Chk'd	App'd
P1	06.03.20	For Planning - Landscape Update	EL	SV	KD

Drawing Suitability **Planning** Status **S2**

Atkins
11 Bressenden Place
Westminster
London
SW1E 5BY
Tel: +44 (0) 20 7121 2000
www.atkinsglobal.com
© SNC-Lavalin (2019)

Client
Richmond upon Thames College
Egerton Road
Twickenham
TW2 7SL

Project Title
Richmond upon Thames College STEM Building

Drawing Title
Block Plan 4 of 4

Scale	Designed	Drawn	Checked	Authorised
1 : 200	KD	TL	SV	KD

Original Size	Date	Date	Date	Date
A1	19.07.19	19.07.19	06.03.20	06.03.20

Drawing Number **5186066-ATK-V1-ZZ-DR-A-0408** Revision **P1**

1 Block Plan
SCALE 1 : 200

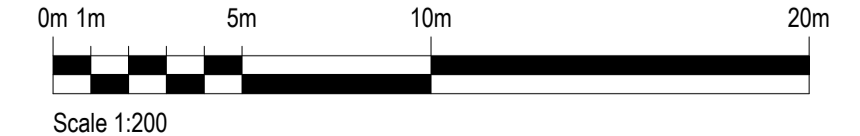

Atkins Project Number: 5186066