



Notes
 1. Drawing not to be scaled for construction or setting out purposes.
 2. To be read in conjunction with Project Risk Register REF: XXX
 3. To be read in conjunction with all other Landscape Architect's drawings

- KEY**
- Full sun planting mix**
 - Cotinus coggygria
 - Deschampsia cespitosa
 - Rudbeckia fulgida var. sullivanti 'Goldsturm'
 - Salvia nemorosa 'Caradonna'
 - Stipa tenuissima
 - Partial sun planting mix**
 - Aster frikartii 'Monch'
 - Geranium macrorrhizum 'White-Ness'
 - Pachysandra terminalis 'Green Carpet'
 - Rudbeckia fulgida var. sullivanti 'Goldsturm'
 - Saxifraga x urbium
 - Entrance herbaceous planting mix**
 - Aster frikartii 'Monch'
 - Calamagrostis x acutiflora 'Karl Foerster'
 - Fatsia japonica
 - Geranium macrorrhizum 'White-Ness'
 - Lavendula angustifolia 'Hidcote'
 - Pachysandra terminalis 'Green Carpet'
 - Amenity grass seeding**
 - Aberace (small) w/ Clover
 - Abercham Slender Creeping Red Fescue
 - Aberfleece Sheeps Fescue
 - Aberroyal Browntop Bentgrass
 - Aberavon (late) Dipper Ryegrass
 - Sports field grass seeding**
 - Chardin Perennial Ryegrass
 - Eurocordus Perennial Ryegrass
 - Eurosport Perennial Ryegrass
 - Europitch Perennial Ryegrass
 - Common Bent
 - Slender creeping red fescue
 - Smooth stalked meadow grass
 - Woodland planting mix**
 - Amalanchier lamarkii
 - Acer campestre
 - Betula pendula
 - Crataegus monogyna
 - Cornus alba
 - Cornus sanguinea
 - Hazel Corylus avellana
 - Hawthorn
 - Lavendula angustifolia
 - Rosa canina
 - Rosmarinus
 - Sambucus nigra
 - Green wall mix**
 - Euonymus fortunei 'Dart's Blanket'
 - Hedera helix 'Woerner'
 - Hedera helix 'Green Ripple'
 - Hedera hibernica
 - Parthenocissus tricuspidata
 - Woodland Tree Mix**
 - Acer campestre
 - Acer platanoides
 - Betula pendula
 - Carpinus betulus
 - Prunus padus
 - Pinus sylvestris
 - Populus nigra
 - Tilia cordata
 - Tilia platyphyllos

Planting Strategy

Species	Density	Girth (cm)	Height (cm)	Clear Stem (cm)
Acer platanoides	as shown	18 - 20 cm	15 - 35 ft	250 cm
Betula pendula	as shown	18-20cm	450-500cm	175-200cm
Betulus carpinus 'Fastigiata'	as shown	18-20cm	450-500cm	1750-200cm
Carpinus betulus 'Fastigiata'	as shown	18-20	35 - 50 ft	2m
Tilia cordata 'Greenspire'	as shown	18-20cm	450-500cm	175-200cm

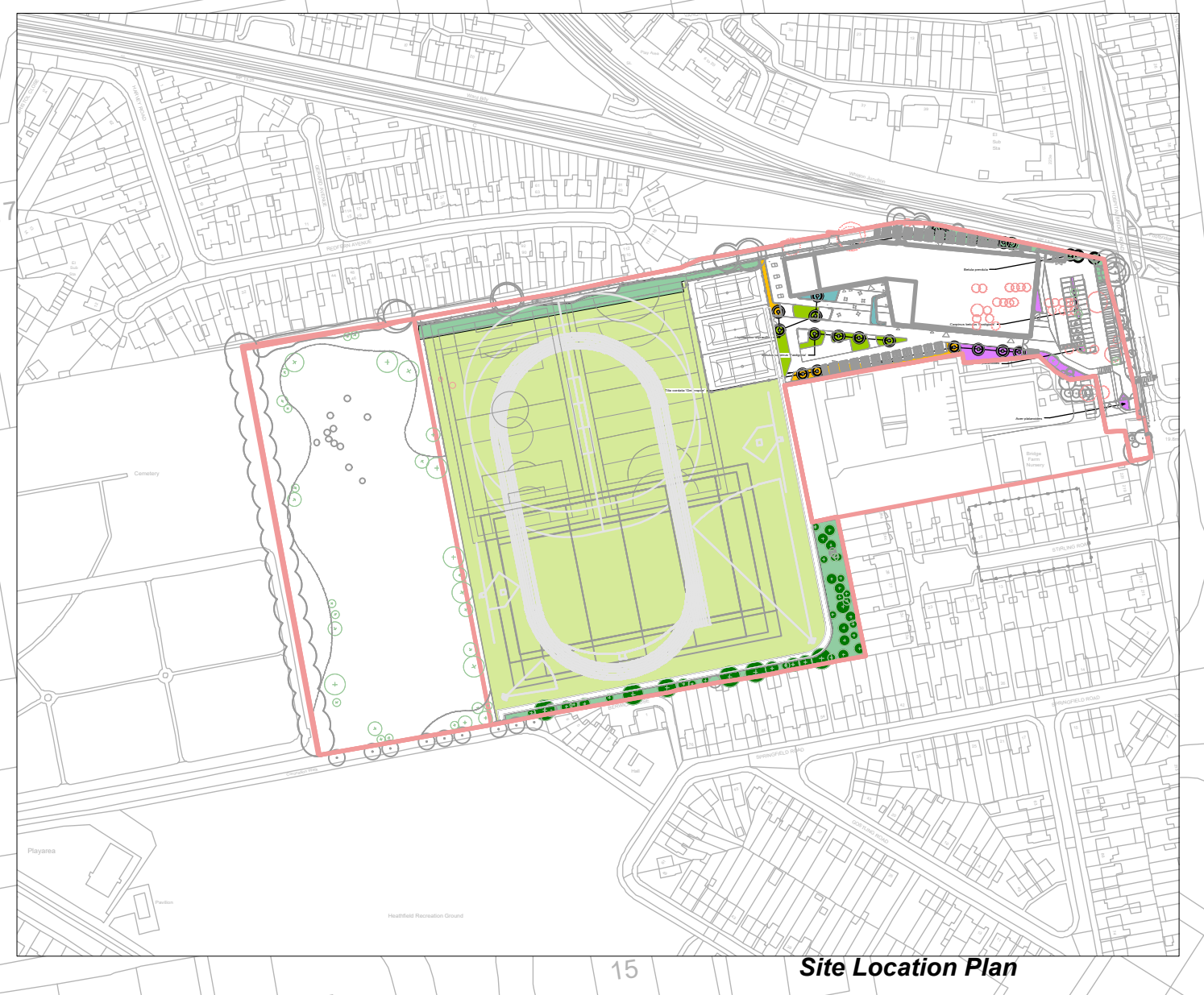

RESIDUAL PROJECT RISKS

ID	RISK	MITIGATION	Date Mitigated		
30.04.20	S2	P03	Grass mix changes in accordance with LPA guidance	CF	RA
10.07.19	S2	P06	Amendments to redline	LA	RA
26.06.19	S2	P07	Fence line amended to protect Habitat Corridor	EZ	LA
31.05.19	S2	P06	Species amended to green screen	LA	LA
22.05.19	S2	P05	Red line amended to 115 Berwick Ave. Parking Spaces amended	LA	LA
02.04.19	S2	P04	Car parking and tree removal strategy amended to reflect updated tree survey and bin store and substitution moved to accommodate ecology comments	LA	LA
07.02.19	S2	P03	Red Line Amended	HT	LA
13.11.18	S2	P02	Highways entrance and adjacent area updated	HT	LA

REVISIONS

DATE	SUITABILITY	REV	DESCRIPTION OF REVISION	DRAWN BY	APPROVED BY

SUITABILITY
S2 - For Planning

ares
 LANDSCAPE ARCHITECTS

Ares Landscape Architects LTD
 Gilecrashers
 51 Eyre Lane
 Sheffield
 S1 4RB

t: 0114 276 2000
 e: hello@ares.eu.com
 w: ares.eu.com

CLIENT:
Bowmer and Kirkland

PROJECT TITLE:
Turing House School

DRAWING TITLE:
Planting Strategy

DRAWING SCALE: 1:500
 DRAWN BY: EC
 DRAWN DATE: 02.03.2018

FRAME SIZE: A1
 APPROVED BY: LA

DRAWING NUMBER: EFATH-ALA-00-XX-DR-L-0014
 SUITABILITY: S2
 REVISION: P09