

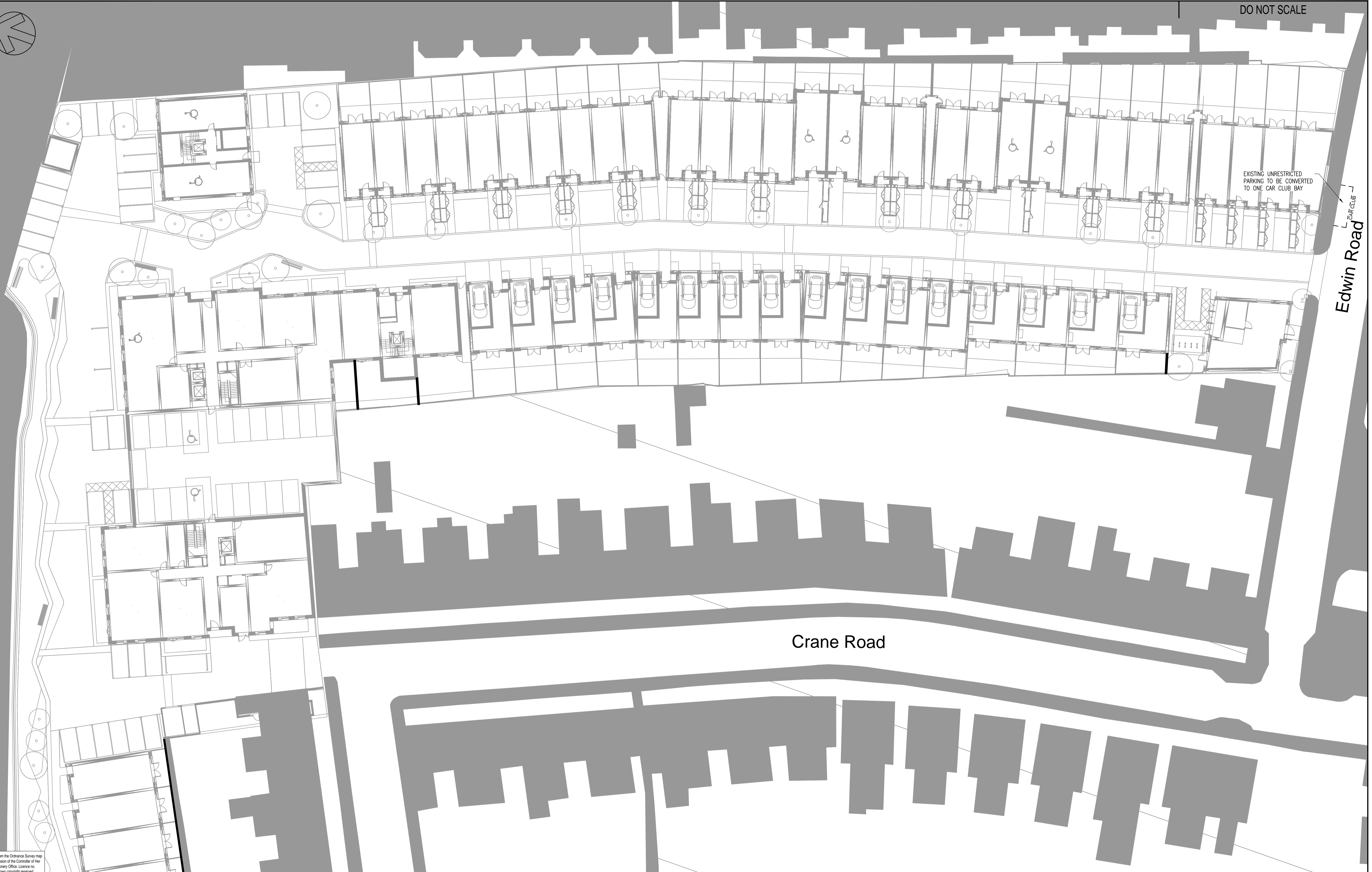

DO NOT SCALE



EXISTING UNRESTRICTED PARKING TO BE CONVERTED TO ONE CAR CLUB BAY

Edwin Road

Crane Road

File name: \\UK.VSPGROUP.COM\CENTRAL\_DATA\PROJECTS\70027521\GREGGS FACTORY, TWICKENHAM MODELS AND DRAWINGS\DEVELOPMENT\AUTOCAD\SKETCHES\70027521-SK-27.DWG, printed on 16 July 2020 12:30:26, by Brian, Craig

Reproduced from the Ordnance Survey map with the permission of the Controller of Her Majesty's Stationery Office. Licence no. 100048755. Crown copyright reserved.

P01	16/07/2020	CRJB	FIRST ISSUE		TE	DMcD
REV	DATE	BY	DESCRIPTION	CHK	APP	
DRAWING STATUS: S2 - FOR INFORMATION						



WSP House  
70 Chancery Lane  
London  
WC2A 1AF, UK  
T+ 44 (0) 207 314 5000  
F+ 44 (0) 207 314 5111  
wsp.com

CLIENT:  
LONDON SQUARE DEVELOPMENTS LTD

ARCHITECT:  
ASSAEL

PROJECT:  
GREGGS FACTORY, TWICKENHAM

TITLE:  
PROPOSED CAR CLUB PARKING BAY ON EDWIN ROAD

SCALE @ A1: 1:250	CHECKED: TE	APPROVED: DMcD
PROJECT No: 70027521	DESIGNED: CRJB	DATE: July 20
DRAWING No: 70027521-SK-27		REV: P01
© WSP UK Ltd		