

Sources: Point 2 Surveyors
 Survey Info
 Point Cloud Data
 Assael Architecture Limited
 3D Models (received 08/07/20)
 New Model.fbx

Key:

- Area analysed
- Area with more than 2 hours of direct sunlight
- Area with less than 2 hours of direct sunlight

50% Percentage of area with more than 2 hours of direct sunlight

Project: Homebase Richmond

Title: BRE 2 Hour Sun on Ground Analysis
 Proposed Scheme Received 08/07/20
 March 21st

Scheme Confirmed:
 Assael Architecture Limited

Date:
 10/07/20

Drawn By:
 JR

Scale:
 1:1500 @ A3

Date:
 July 20

Dwg No:
P1685/SHA/11

Rel:
13

Point 2 Surveyors Limited, 17 Slingsby Place, London, WC2E 9AB | 0207 836 5828 | point2.co.uk



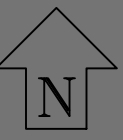

Sources: Point 2 Surveyors
 Survey Info
 Point Cloud Data
 Assael Architecture Limited
 3D Models (received 08/07/20)
 New Model.fbx

Key:

- Area analysed
- Area with more than 2 hours of direct sunlight
- Area with less than 2 hours of direct sunlight

50% Percentage of area with more than 2 hours of direct sunlight

Project: Homebase Richmond

Title: BRE 2 Hour Sun on Ground Analysis
 Proposed Scheme Received 08/07/20
 June 21st

Scheme Confirmed:
 Assael Architecture Limited

Date:
 10/07/20

Drawn By:
 JR

Scale:
 1:500 @ A3

Date:
 July 20

Dwg No:
P1685/SHA/12

Rel:
13

Point 2 Surveyors Limited, 17 Slingsby Place, London, WC2E 9AB | 0207 836 5828 | point2.co.uk



Appendix 7: Transient Overshadowing

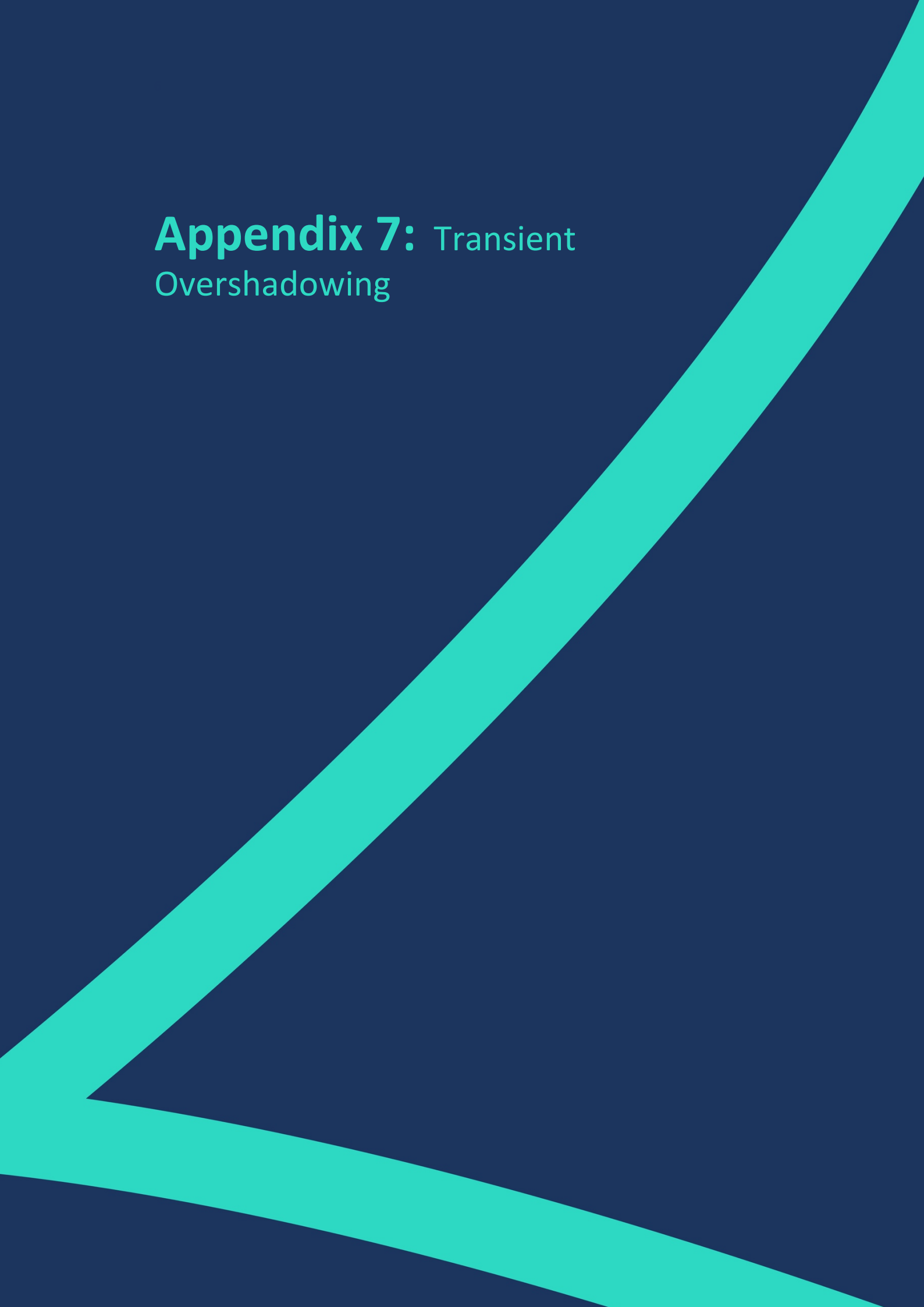

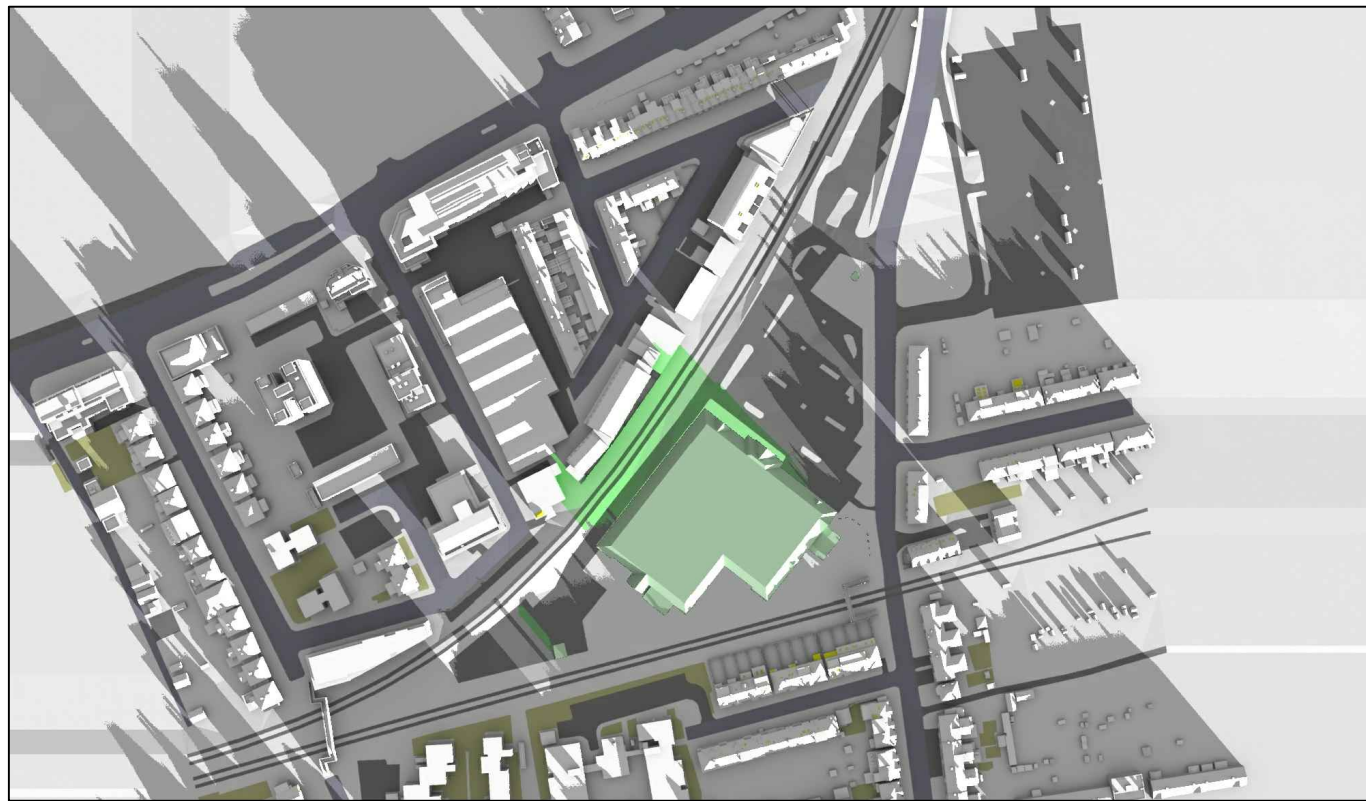

Existing 09:00am

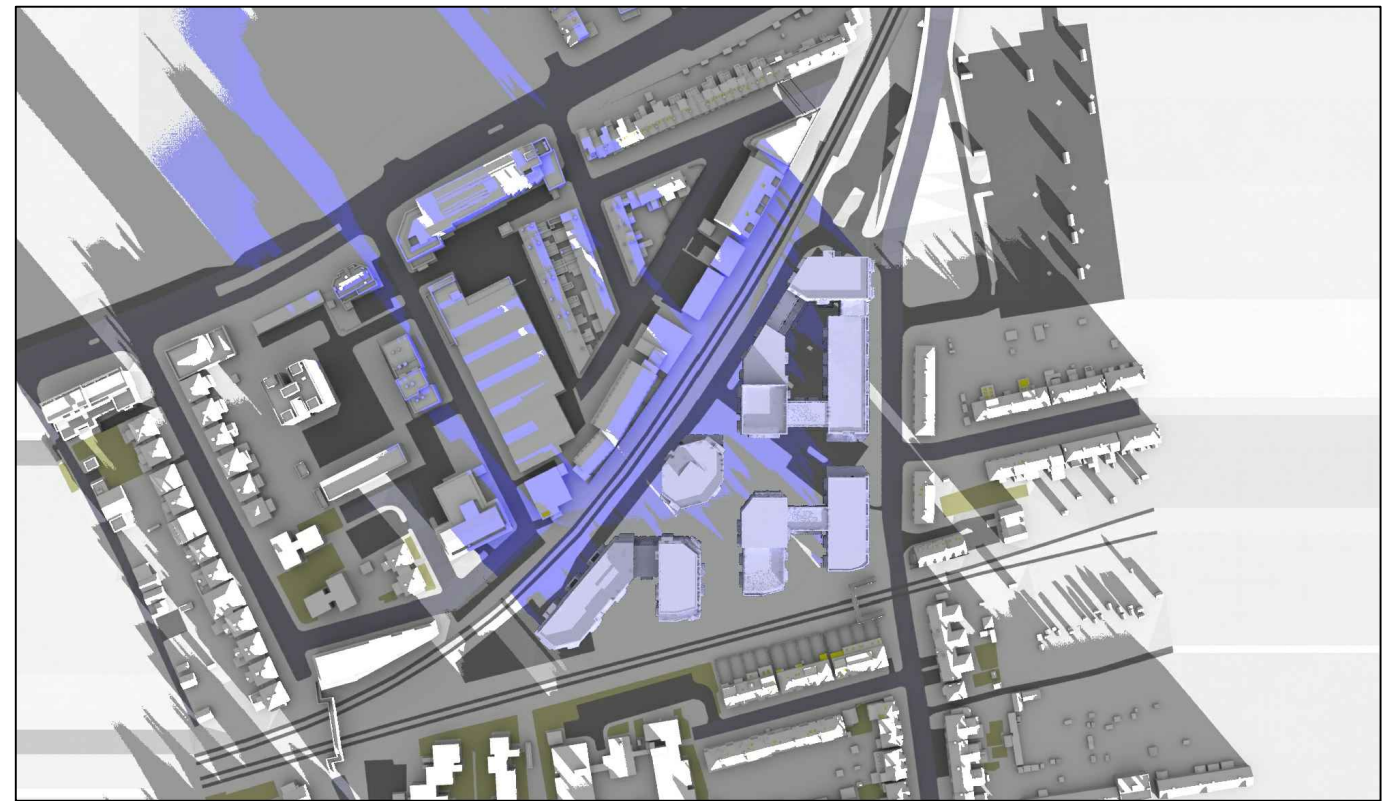

Proposed 09:00am

December 21st (GMT)

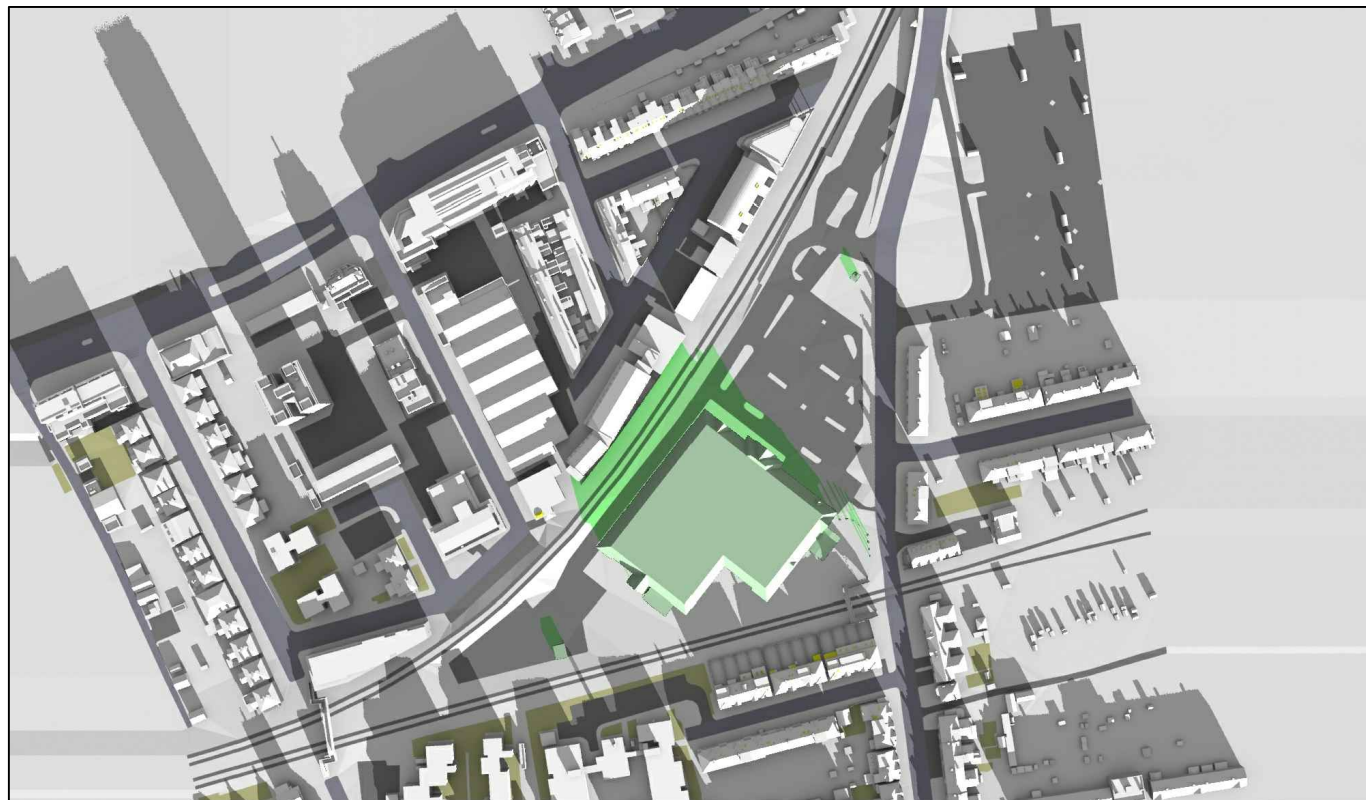

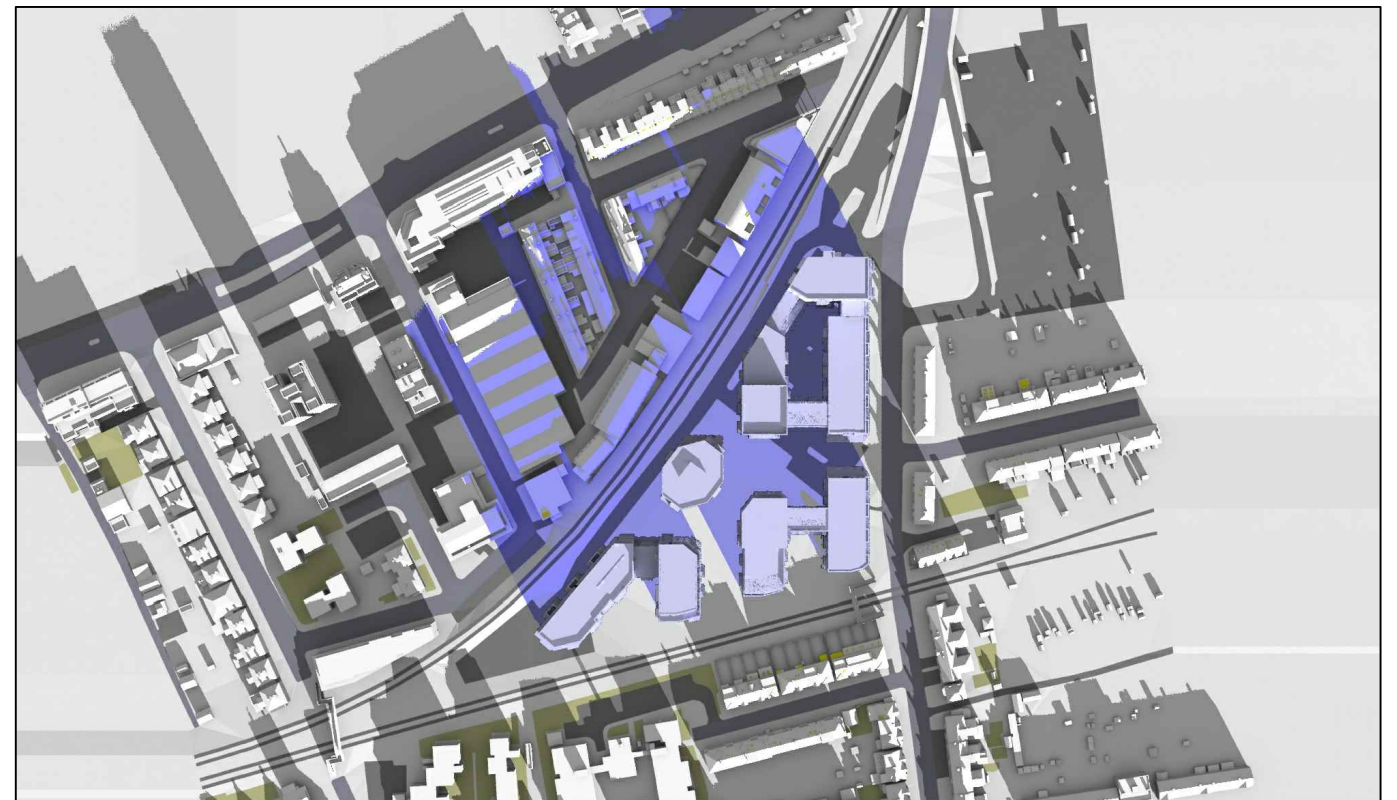

Existing 10:00am



Proposed 10:00am

Sources: Point 2 Surveyors
Survey Info
Point Cloud Data
Assael Architecture Limited
3D Models (received 08/07/20)
New Model.fbx

Key:	
	Grey shadows are those caused by buildings which are not on the site under development.
	Green shadows are those caused specifically by the existing buildings on the site.
	Blue shadows are those caused specifically by the proposed development.

Project: Homebase Richmond

Title: Transient Overshadowing Existing vs Proposed Scheme Dated 08/07/20

Scheme Confirmed: Assael Architecture Limited

Date: 10/07/20

Drawn By: JR

Scale: NTS

Date: July 20

Dwg No: P1685/DEC03/01

Rel: 13



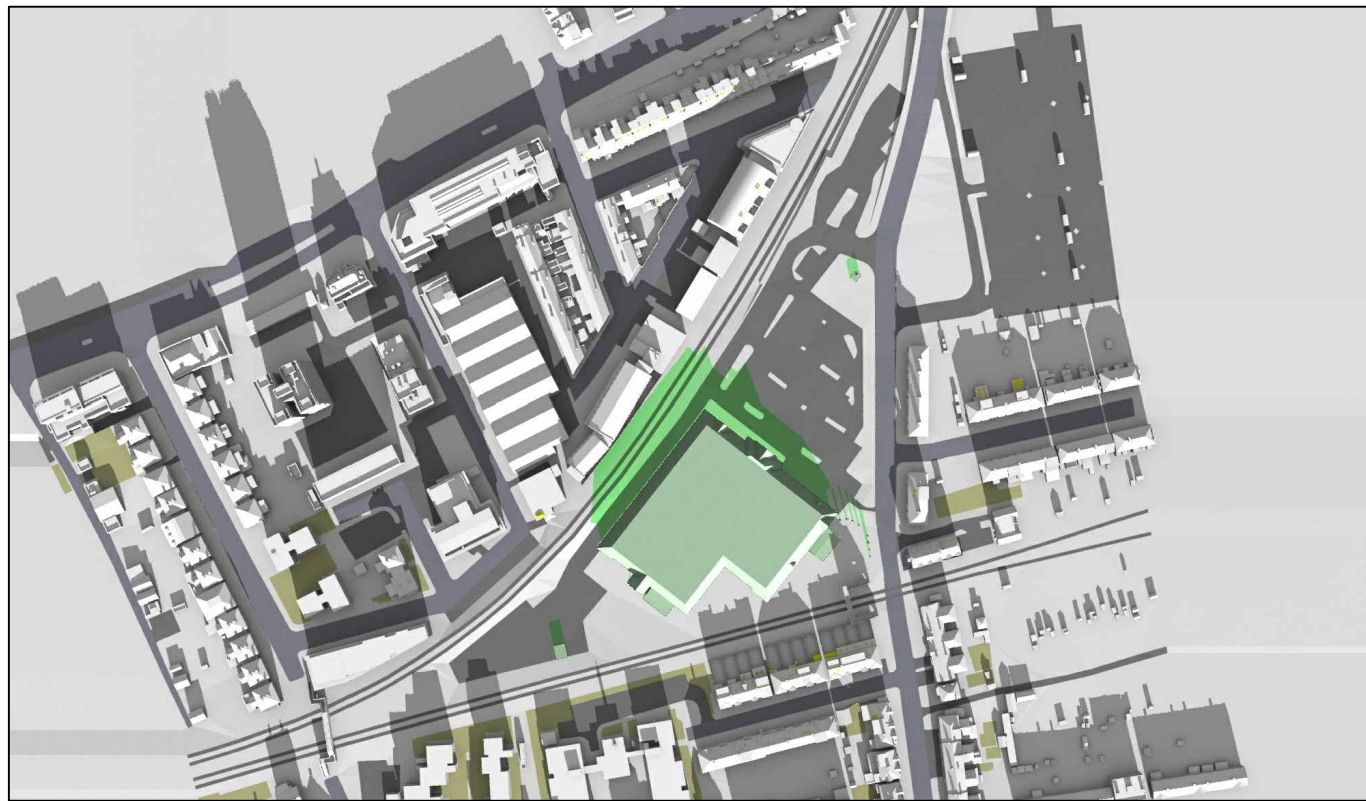

Existing 11:00am

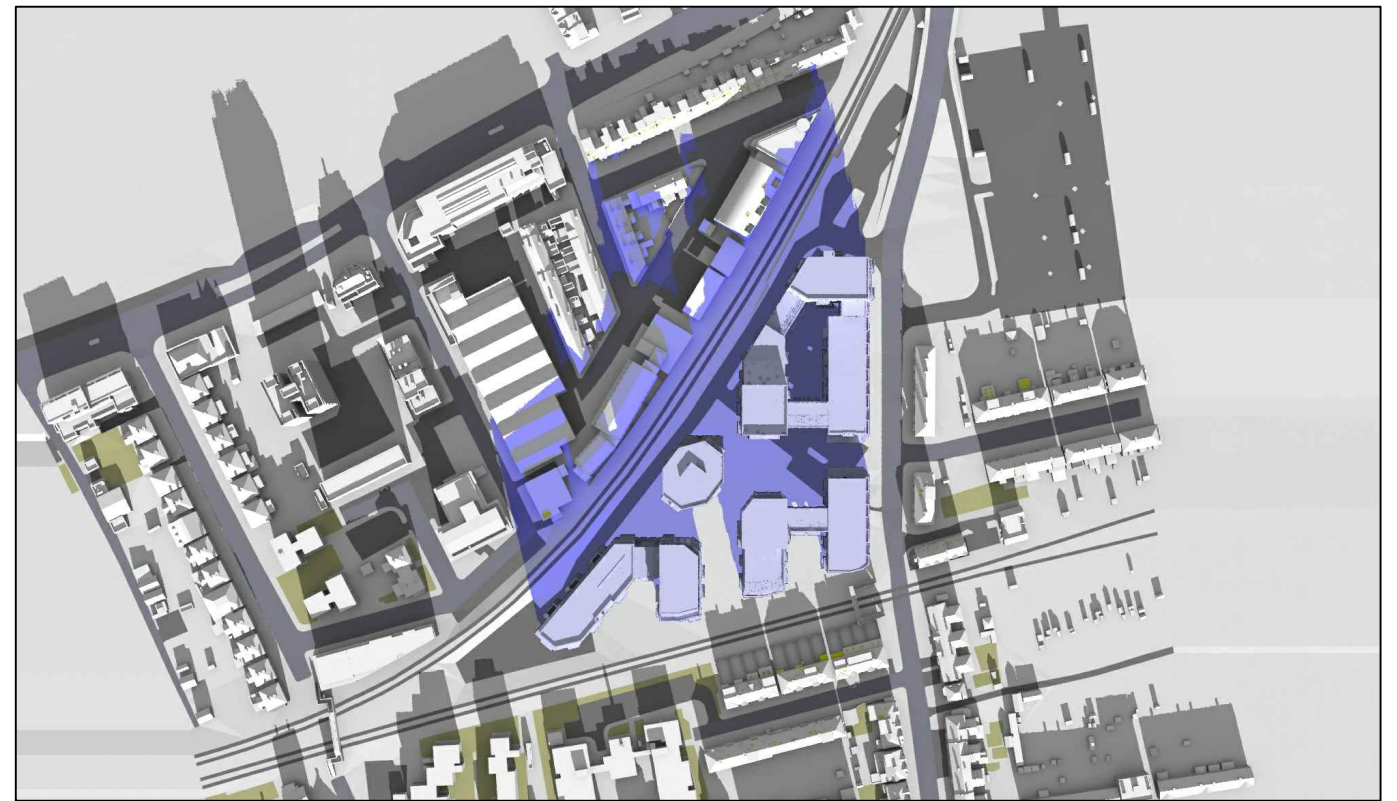

Proposed 11:00am

December 21st (GMT)



Existing 12:00pm



Proposed 12:00pm

Sources: Point 2 Surveyors
 Survey Info
 Point Cloud Data
 Assael Architecture Limited
 3D Models (received 08/07/20)
 New Model.fbx

Key:

- Grey shadows are those caused by buildings which are not on the site under development.
- Green shadows are those caused specifically by the existing buildings on the site.
- Blue shadows are those caused specifically by the proposed development.

Project: Homebase Richmond

Title: Transient Overshadowing Existing vs Proposed Scheme Dated 08/07/20

Scheme Confirmed:
 Assael Architecture Limited

Date:
 10/07/20

Drawn By:
 JR

Scale:
 NTS

Date:
 July 20

Dwg No:
P1685/DEC03/02

Rel:
13





Existing 01:00pm



Proposed 01:00pm

December 21st (GMT)

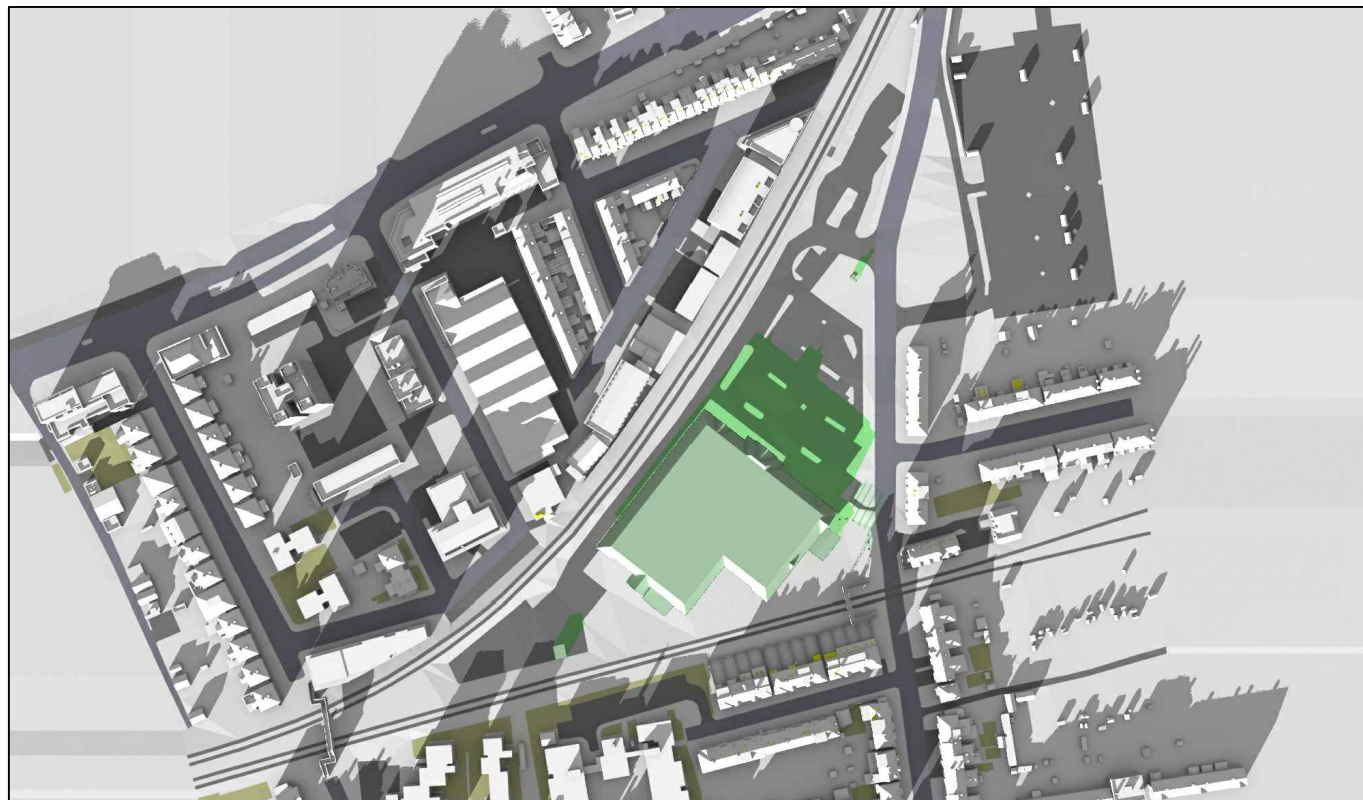

Existing 02:00pm

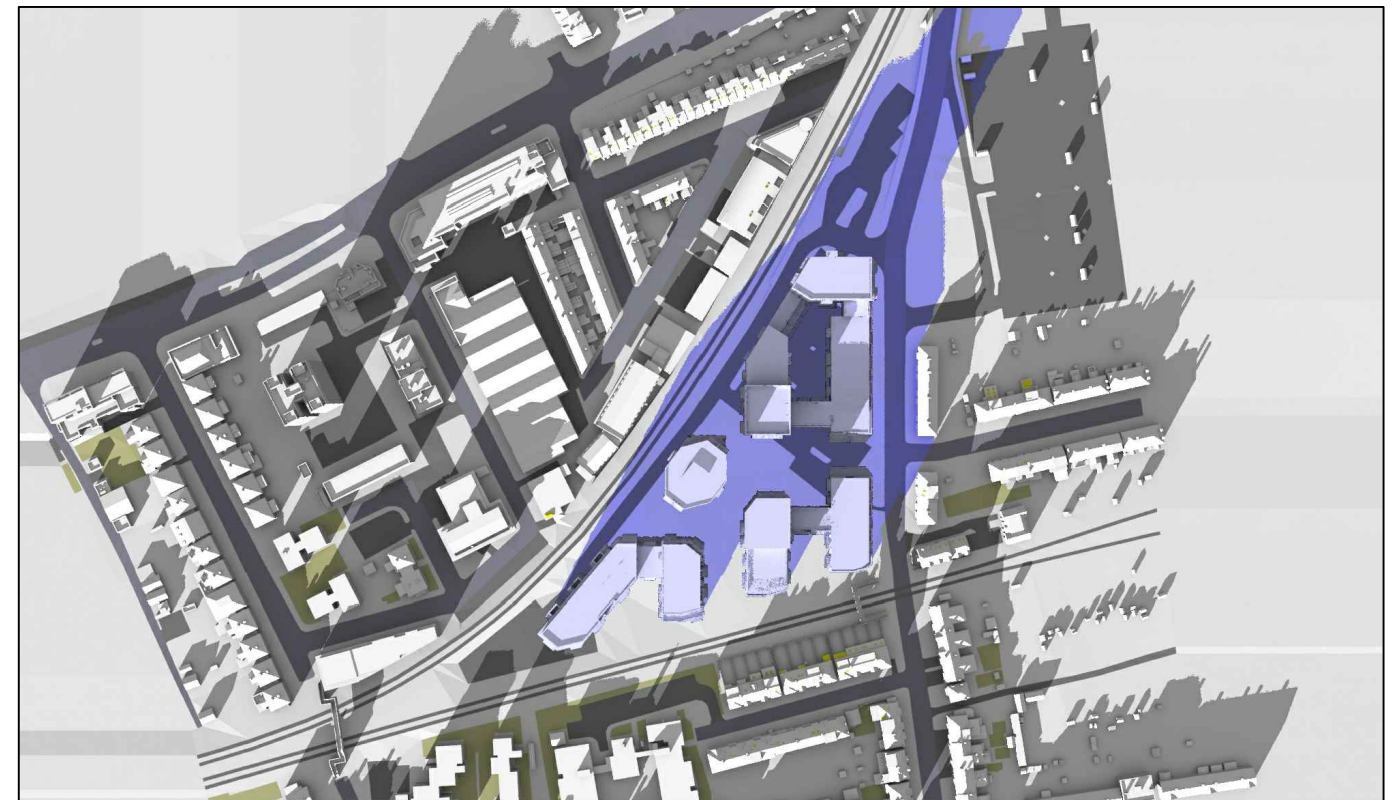

Proposed 02:00pm

Sources: Point 2 Surveyors
Survey Info
Point Cloud Data
Assael Architecture Limited
3D Models (received 08/07/20)
New Model.fbx

Key:

- Grey shadows are those caused by buildings which are not on the site under development.
- Green shadows are those caused specifically by the existing buildings on the site.
- Blue shadows are those caused specifically by the proposed development.

Project: Homebase Richmond

Title: Transient Overshadowing Existing vs Proposed Scheme Dated 08/07/20

Scheme Confirmed:
Assael Architecture Limited

Date:
10/07/20

Drawn By:
JR

Scale:
NTS

Date:
July 20

Dwg No:
P1685/DEC03/03

Rel:
13



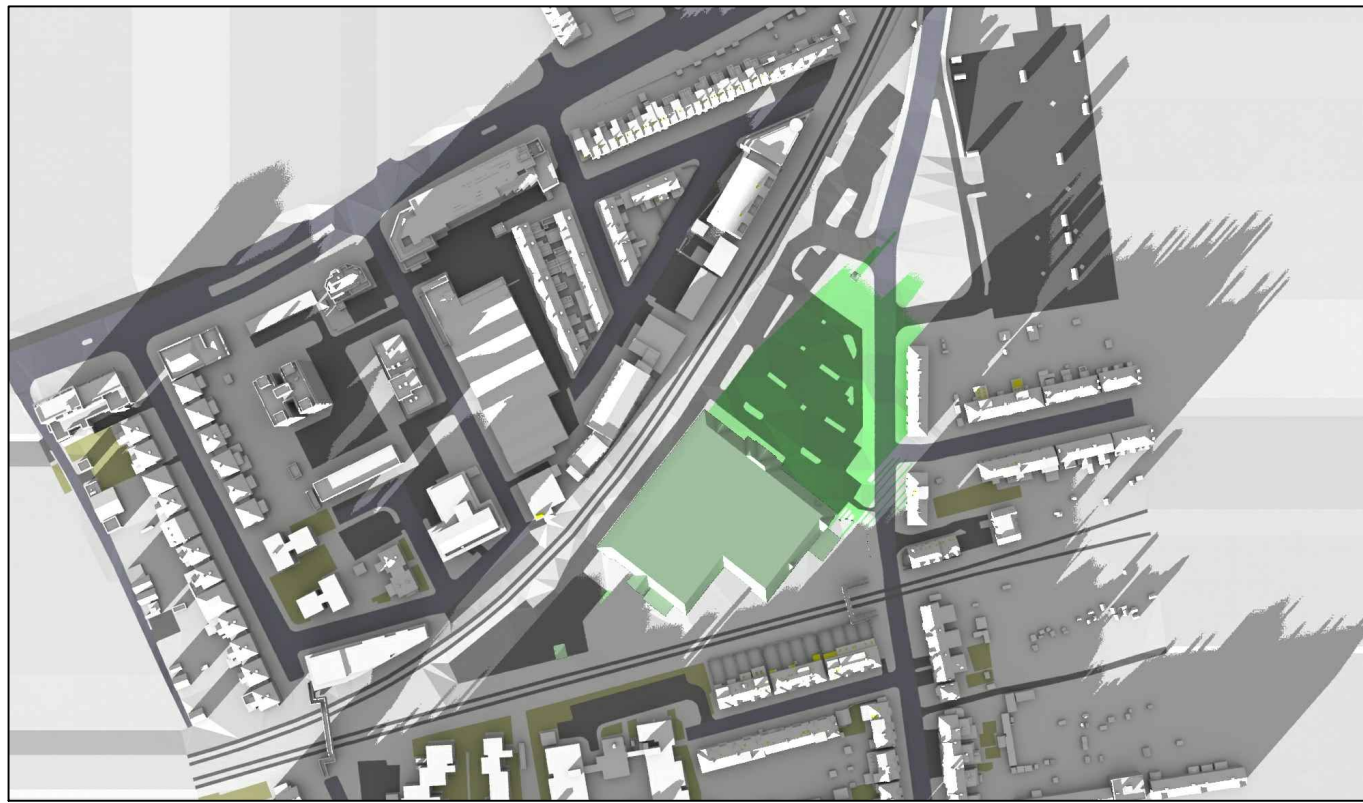

Existing 03:00pm

December 21st (GMT)

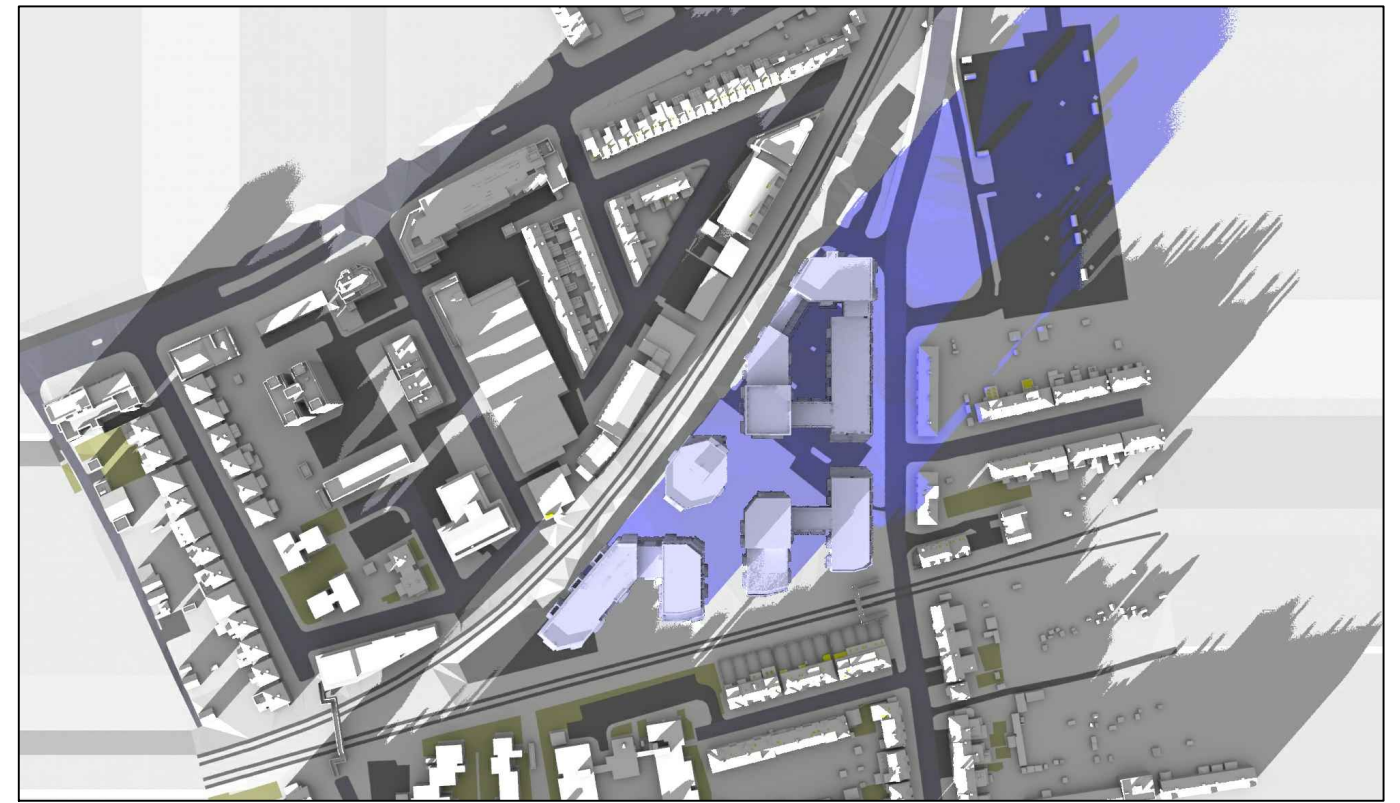

Proposed 03:00pm

Sources: Point 2 Surveyors
Survey Info
Point Cloud Data
Assael Architecture Limited
3D Models (received 08/07/20)
New Model.fbx

Key:

- Grey shadows are those caused by buildings which are not on the site under development.
- Green shadows are those caused specifically by the existing buildings on the site.
- Blue shadows are those caused specifically by the proposed development.

Project: Homebase
Richmond

Title: Transient Overshadowing
Existing vs Proposed Scheme Dated 08/07/20

Scheme Confirmed:
Assael Architecture Limited

Date:
10/07/20

Drawn By:
JR

Scale:
NTS

Date:
July 20

Dwg No:
P1685/DEC03/04

Rel:
13





Existing 07:00am

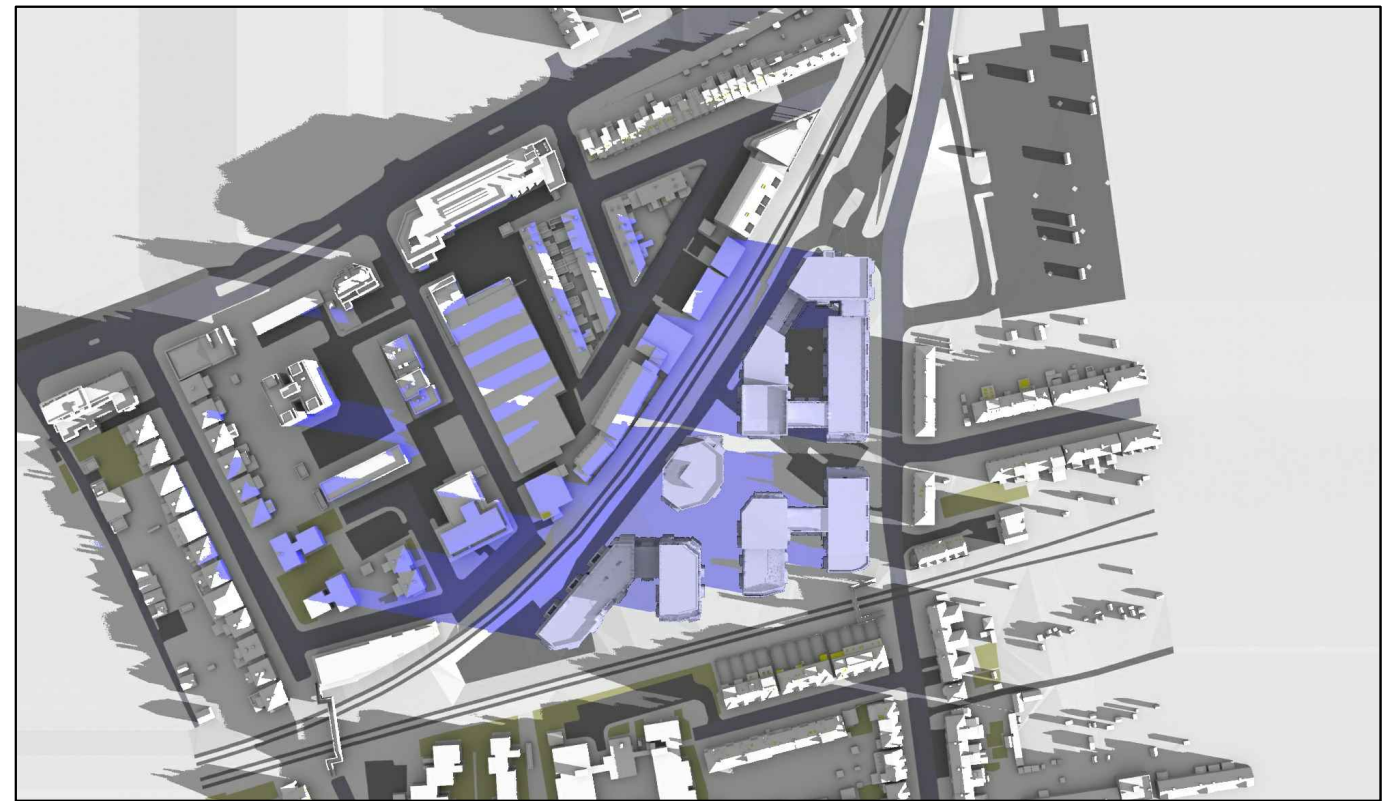

Proposed 07:00am

March 21st (GMT)



Existing 08:00am



Proposed 08:00am

Sources: Point 2 Surveyors
Survey Info
Point Cloud Data
Assael Architecture Limited
3D Models (received 08/07/20)
New Model.fbx

Key:	<ul style="list-style-type: none"> Grey shadows are those caused by buildings which are not on the site under development. Green shadows are those caused specifically by the existing buildings on the site. Blue shadows are those caused specifically by the proposed development.
------	----------------------------------------------------------------------------------------------------------------------------------------------------------------------------------------------------------------------------------------------------------------------------------------------------------------------------------------------------------------------------------------------------------------------------------------------------------------------------------------------------------------------------------------------------------------------------------------------------------------------------------------------------------------------------------

Project: Homebase Richmond

Title: Transient Overshadowing Existing vs Proposed Scheme Dated 08/07/20

Scheme Confirmed: Assael Architecture Limited

Date: 10/07/20

Drawn By: JR

Scale: NTS

Date: July 20

Dwg No: P1685/MAR03/01

Rel: 13





Existing 09:00am



Proposed 09:00am

March 21st (GMT)



Existing 10:00am



Proposed 10:00am

Sources: Point 2 Surveyors
 Survey Info
 Point Cloud Data
 Assael Architecture Limited
 3D Models (received 08/07/20)
 New Model.fbx

Key:	<ul style="list-style-type: none"> Grey shadows are those caused by buildings which are not on the site under development. Green shadows are those caused specifically by the existing buildings on the site. Blue shadows are those caused specifically by the proposed development.
------	----------------------------------------------------------------------------------------------------------------------------------------------------------------------------------------------------------------------------------------------------------------------------------------------------------------------------------------------------------------------------------------------------------------------------------------------------------------------------------------------------------------------------------------------------------------------------------------------------------------------------------------------------------------------------------

Project: Homebase Richmond

Title: Transient Overshadowing Existing vs Proposed Scheme Dated 08/07/20

Scheme Confirmed: Assael Architecture Limited

Date: 10/07/20

Drawn By: JR

Scale: NTS

Date: July 20

Dwg No: P1685/MAR03/02

Rel: 13





Existing 11:00am



Proposed 11:00am

March 21st (GMT)



Existing 12:00pm



Proposed 12:00pm

Sources: Point 2 Surveyors
 Survey Info
 Point Cloud Data
 Assael Architecture Limited
 3D Models (received 08/07/20)
 New Model.fbx

Key:	<ul style="list-style-type: none"> Grey shadows are those caused by buildings which are not on the site under development. Green shadows are those caused specifically by the existing buildings on the site. Blue shadows are those caused specifically by the proposed development.
------	----------------------------------------------------------------------------------------------------------------------------------------------------------------------------------------------------------------------------------------------------------------------------------------------------------------------------------------------------------------------------------------------------------------------------------------------------------------------------------------------------------------------------------------------------------------------------------------------------------------------------------------------------------------------------------

Project: Homebase Richmond

Title: Transient Overshadowing Existing vs Proposed Scheme Dated 08/07/20

Scheme Confirmed: Assael Architecture Limited

Date: 10/07/20

Drawn By: JR

Scale: NTS

Date: July 20

Dwg No: P1685/MAR03/03

Rel: 13





Existing 01:00pm



Proposed 01:00pm

March 21st (GMT)



Existing 02:00pm



Proposed 02:00pm

Sources: Point 2 Surveyors
 Survey Info
 Point Cloud Data
 Assael Architecture Limited
 3D Models (received 08/07/20)
 New Model.fbx

Key:	<ul style="list-style-type: none"> Grey shadows are those caused by buildings which are not on the site under development. Green shadows are those caused specifically by the existing buildings on the site. Blue shadows are those caused specifically by the proposed development.
------	----------------------------------------------------------------------------------------------------------------------------------------------------------------------------------------------------------------------------------------------------------------------------------------------------------------------------------------------------------------------------------------------------------------------------------------------------------------------------------------------------------------------------------------------------------------------------------------------------------------------------------------------------------------------------------

Project: Homebase Richmond

Title: Transient Overshadowing Existing vs Proposed Scheme Dated 08/07/20

Scheme Confirmed: Assael Architecture Limited

Date: 10/07/20

Drawn By: JR

Scale: NTS

Date: July 20

Dwg No: P1685/MAR03/04

Rel: 13

