







| rev | details | by | date |
|-----|------------------------|----|------------|
| D01 | Issued for Information | RJ | 24.11.2017 |
| D02 | Issued for Planning | RJ | 25.01.2018 |
| D03 | Issued for Planning | RJ | 09.02.2018 |
| D04 | Issued for Planning | RM | 24.04.2020 |
| | | | |
| | | | |
| | | | |

Notes

- 1.0 Do not scale from drawing, use figured dimensions only
- 1.1 All dimensions to be checked onsite
- 1.2 This drawing to be read in conjunction with all other Gillespies drawings and specifications

LEGEND

-  Primary (Quiet Route)
-  Secondary
-  Tertiary
-  Towpath
-  Site Application Boundary
-  School Application Boundary

Note:

- 1. In the event that building positions move within the limits of deviation set out in the parameter plans, the landscape zones will be adjusted to match any deviation from the current layout.
- 2. Please refer to Squires and Partners Drawing 16019_C645_Z2_P_PR_001_C, 002_C, 003_C, 004_C, 005_C and 013_C for building locations.

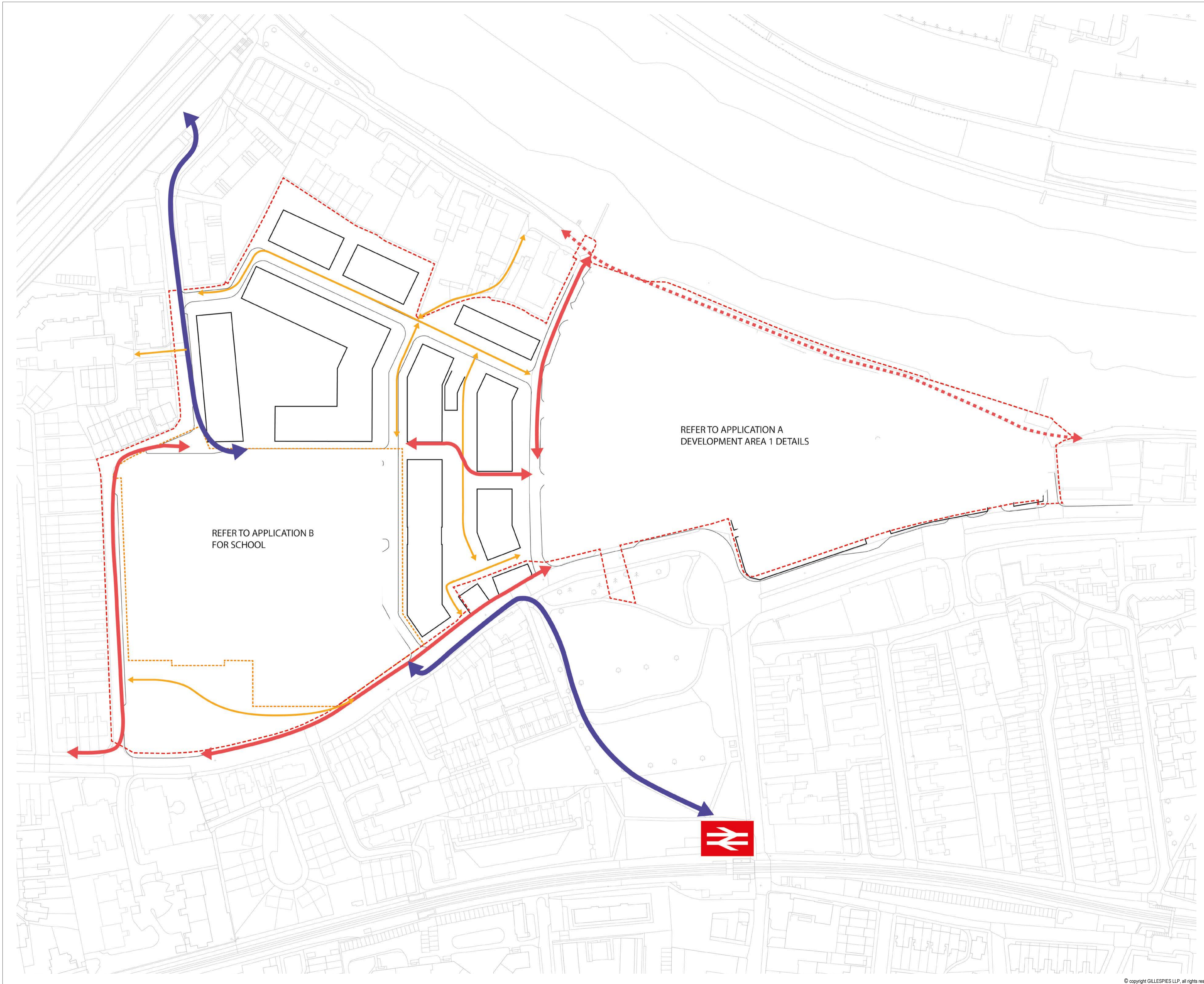
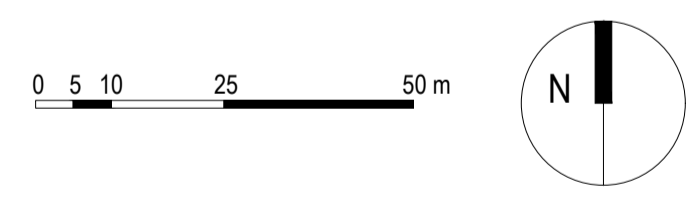

Project title
STAG BREWERY

Drawing title
Pedestrian Circulation Parameter Plan

| | | | |
|--------------------------|----------------|-------------|------------|
| DESIGN | Drawing status | Scale | Drawn |
| | 24.04.2020 | 1:1000 @ A1 | RM |
| P10736-00-001-126 | Drawing number | Date | Checked |
| | | 24.04.2020 | CL |
| | | Revision | |
| | | | D04 |

Client
DARTMOUTH CAPITAL
Alameda House, 90-100 Sydney Street, London SW13 9UJ
P: 0207 629 0239

