

PROPOSED POROUS SURFACING (POROUS MACADAM SURFACING AND ARTIFICIAL STONE FLAG PAVING) WITH AGGREGATE SUB-BASE UNDERLAIN BY GEO-CELLULAR CRATES (VOL. 892m<sup>3</sup>)

0.35m DEEP ATTENUATION TANKS BELOW TREE PITS AND LANDSCAPING (COMBINED VOL. 465m<sup>3</sup>)

1.8m DEEP ATTENUATION TANKS IN SERIES (VOL. 100m<sup>3</sup>)

1.5m DEEP ATTENUATION TANK BELOW TREE PITS (VOL. 499m<sup>3</sup>)

0.935m DEEP ATTENUATION TANK (VOL. 143m<sup>3</sup>)

3G SPORTS PITCH TO DRAIN FREELY (AS REQUESTED BY THE GREATER LONDON AUTHORITY), SUBJECT TO GROUND INVESTIGATIONS UNDERTAKEN DETAILED DESIGN. IF FREE DRAINING THIS AREA IS PROVEN NOT FEASIBLE, THEN THIS AREA WOULD BE ATTENUATED VIA A TANK OR OTHER SUITABLE ATTENUATION FEATURE.

PROPOSED CONNECTION INTO EXISTING SEWER

**GENERAL NOTES**

- THIS DRAWING IS TO BE READ IN CONJUNCTION WITH ALL ENGINEER'S, ARCHITECT'S OR OTHER RELEVANT DRAWINGS AND SPECIFICATIONS.
- ALL DIMENSIONS AND LEVELS ARE TO BE CHECKED ON SITE BY THE CONTRACTOR PRIOR TO PREPARING ANY WORKING DRAWINGS OR COMMENCING ON SITE.
- THE CONTRACTOR MUST ENSURE AND WILL BE HELD RESPONSIBLE FOR THE OVERALL STABILITY OF THE BUILDING/STRUCTURE/EXCAVATION AT ALL STAGES OF THE WORK.
- ALL WORK BY THE CONTRACTOR MUST BE CARRIED OUT IN SUCH A WAY THAT ALL REQUIREMENTS UNDER THE HEALTH AND SAFETY AT WORK ACT ARE SATISFIED.
- ALL WORK IS TO BE CARRIED OUT IN COMPLIANCE WITH THE REQUIREMENTS OF THE RELEVANT STATUTORY AUTHORITIES AND REGULATIONS.
- EXISTING DRAINAGE LAYOUT BASED ON THAMES WATER SEWER RECORDS AND PENBORN TECHNICAL SERVICES DRAWING (REF P979/07/31).
- EXISTING FOUL AND SURFACE WATER CONNECTIONS TO BE RE-USED WHERE FEASIBLE, SUBJECT TO DETAILED DESIGN.

**LEGEND**

- EXISTING SURFACE WATER SEWER
- EXISTING FOUL SEWER
- EXISTING COMBINED SEWER
- EXISTING PUBLIC RISING MAIN
- EXISTING SEWER TO BE ABANDONED
- PROPOSED SURFACE WATER SEWER
- PROPOSED ATTENUATION TANK
- PROPOSED CONVEYANCE CHANNEL
- PROPOSED POROUS SURFACING
- PROPOSED RAIN GARDEN
- APPLICATION A BOUNDARY
- SURFACE WATER DRAINAGE CATCHMENT
- DRAINAGE CATCHMENT NO.

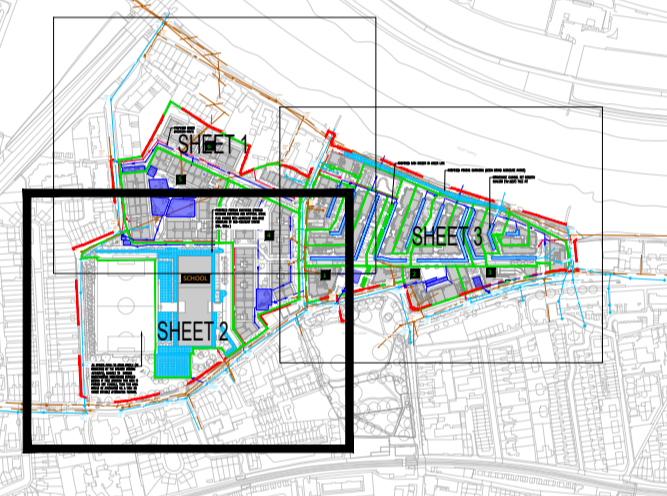

Rev	Date	Description	By
A10	07.04.20	AMENDED SCHEME PLANS	NB
A09	30.10.19	AMENDED SCHEME PLANS	NB
A08	09.09.19	BASEMENT TANKS REMOVED/REPLACED	NB
A07	08.01.19	MINOR AMENDMENT TO TEXT	NB
A06	20.12.18	PERMEABLE PAVING AND RAIN GARDEN ADDED	NB
A05	13.02.18	UPDATED APPLICATION BOUNDARY	NB
A04	29.01.18	UPDATED ARCHITECT LAYOUT	NB
A03	01.11.17	TEAM ISSUE	NB
A02	23.10.17	SURFACE WATER ATTENUATION AMENDED	NB
A01	29.09.17	PRELIMINARY ISSUE	MAC

Project: **STAG BREWERY**

Title: **PROPOSED FOUL AND SURFACE WATER DRAINAGE LAYOUT SHEET 2 OF 3**

Client: **RESELTON PROPERTIES LIMITED**

Pickfords Wharf Clink Street London SE1 9DG  
 1 020 7928 7888  
 mail@watermangroup.com www.watermangroup.com

Drawing Status				
PRELIMINARY				
Designed by	Checked by	DO	Project No	
NB	DO		WE15582	
Drawn by	Date	Computer File No		
NB	SEPTEMBER 2017	15582-WIE-ZZ-XX-GR-02005.dwg		
Scales @ A1		Number	Revision	
work to figured dimensions only 1:500		0005	A10	
Publisher	Zone	Category	Number	Revision
WIE	SA	92	0005	A10

