



Green Roof Location Plan  
1:200

**KEY**

**Green Roof System Q37/130A**

Wallbam M-Tray modular green roof system - installed loose and clipped together in-situ over proprietary geotextile membrane and single ply finished roof buildup. Permanent irrigation system provided to entire roof.

- Biodiverse wildflower vegetation mix (refer to landscape architect specification).
- 100mm high M Tray modular green roof container
- Tray comprises Pre-grown, multi-layered green roof system with drainage membrane, filtration layers, substrate and vegetation pre-installed
- 300gsm recycled fleece separation and filtration geotextile layer to protect waterproofing membrane and provide drainage filtration.

**Washed/rounded riverstone pebbles Q37/130A**

To provide fire break:  
Min. 500mm at abutments, service penetrations and rooflights.  
Min. 1000mm at compartments, at max. 40m ccs.

**Substrate to Green Roof**

**J42/111A Robust**, low maintenance single ply roof finish on rigid insulation with pc concrete planks laid to falls, comprising:

- Adhered PVC polymeric fleece backed roofing membrane
- 130mm rigid PIR insulation
- 200mm precast concrete hollowcore planks laid to falls

— PVC polymeric fleece backed roofing membrane  
- - - Vapour Barrier  
Notional air tightness line - all penetrations sealed  
300gsm recycled fleece separation and filtration geotextile layer  
Washed and rounded riverstone pebbles to provide fire break: Min. 500mm at abutments, service penetrations and rooflights. Min. 1000mm at compartments, at max. 40m ccs.

**Green Roof Design Criteria**

Green roof designed to comply with the requirements of Green Roof Organisation 'Green Roof Code', 2014 and GRO 'Fire Risk Guidance Document', 2017. The GRO Green Roof Code is intended to act as a code of best practice and as such it should be used to guide behaviour relating to green roof design, specification, installation and maintenance

**Irrigation**

Proprietary drip pipe irrigation system, pump and control unit to be installed to provide irrigation to entire green roof in accordance with Green Roof Organisation, Green Roof Code, 2014

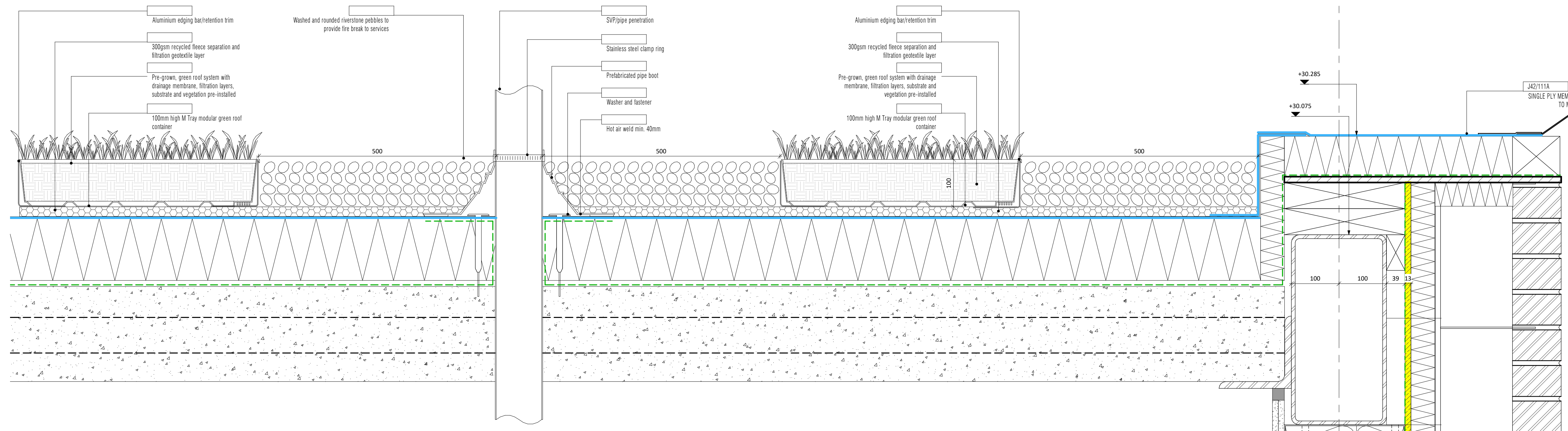

1 Typical retention/drainage trim to open perimeters  
2 Typical service penetration detail  
3 Typical abutment detail to parapet upstand

1 Typical Green Roof Details  
1:5

REV	AUTHOR	CHECK	DATE	DESCRIPTION
P04	CB	CB	06.08.20	Revised for planning condition issue
P03	CB	CB	05.08.20	Revised to show increased fire breaks and indicate pebble fire breaks within green roof system - FGR PLANNING
P02	CB	ND	18.10.19	External packages draft issue for comment
P01	SH	CB	16.09.19	Green Roof and Wall Issue

CLIENT	REVISION
Bowmer & Kirkland	SH
	CHECKED BY
	CB
	ORIGINATOR NO
	151547

CONSULTANT  
**STRIDE TREGLOWN**  
www.stride-treglow.com © Stride Treglow Limited 2016  
PROJECT  
Turing House School  
Twickenham

DRAWING TITLE  
**Green Roof Details**

SUITABILITY STATUS	SCALE
PL : PLANNING	As indicated @ A1

PROJECT   ORIGINATOR   ZONE   LEVEL   TYPE   ROLE   NUMBER	REVISION
FS0316-STL-01-XX-DR-A-4124	P04