

Trees at Hampton School-Hampton Pre-Prep School, 41-43 Wensleydale Road, Hampton

Tree No.	Species	Ht (m)	Branch Spread (m)				Stem diameters (cm)					Height of crown clearance (m)	Height of first branch (m) and direction (compass point)	Age class	Category grading	Estimated remaining contribution (yrs)	Condition Physiological / Structural	Tree Works to BS 3998	Root protection radius (m)	Root protection area sq.m	
			N	E	S	W	Single Stem	2-5 stems													More than 5 stems
								Stem 1	Stem 2	Stem 3	Stem 4										
1	Pair of holly	9av	2av				25av						2	2S	S	C2	>10	Pair of small trees, one overgrown with ivy.	Remove.	3.00	28
2	London plane	15	5	6	5	6	74					6	6N	M	A2	>40	Pollarded form. Part of an avenue.		8.88	248	
3	London plane	16	6	7	6	6	73					6	6E	M	A2	>40	Pollarded form. Part of an avenue.		8.76	241	

NORTH

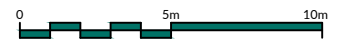

- NOTES
- The original of this drawing was produced in colour - a monochrome copy should not be relied upon.
 - Scale for planning purposes only.
 - All dimensions to be checked on site.
 - The copyright of this document resides with Keen Consultants unless assigned in writing by the company.
 - Details shown on this drawing are devised with reference to BS5837:2012: Trees in relation to design, demolition and construction - Recommendations.
 - Check if Tree Preservation Order or Conservation Area protection applies to trees before undertaking tree works.
 - Block Plan as Existing based on mackenzie wheeler drawing number 1443/002.
 - Trees plotted by eye.
 - Block Plan as Proposed based on mackenzie wheeler drawing number 1443/P/102 Rev B.

- KEY
- Existing site features
 - Proposed structures
 - Trees retained
 - Trees for removal
 - Area of ground protection as detail in Figure 2
 - Timber boxing as detail in Figure 4

- KEY TO TREE SCHEDULE
- | Column Heading | Explanation |
|---|--|
| Tree No. | Unique number corresponding with number on plan |
| Species | English names |
| Ht (m) | Height in metres |
| Branch Spread | Crown radius in metres to cardinal points of the compass |
| Stem Dia | All measurements conform to Annex C of BS 5837:2012
Single stem - Stem diameter in centimetres measured at 1.5m above ground level.
Multi-stemmed tree with 2 to 5 stems - Diameter of each stem
Multi-stemmed tree with more than 5 stems - Average stem diameter and number of stems |
| Height of crown clearance | Height in metres between the ground and underside of canopy |
| Height of first major branch and direction of growth | Height from ground level to base of first major branch and the approximate direction of growth |
| Abbreviations as suffix to a dimension | Suffix 'av' denotes an estimated dimension |
| Age Class | Age Class definitions:
Y = Young S = Semi-mature E = Early mature
M = Mature O = Over mature |
| Category grading and Estimated remaining Contribution (yrs) | Summary of BS 5837:2012 categorisation:

1. Trees unsuitable for retention:
U = those in such a condition that they cannot realistically be retained as living trees in the context of the current land use for longer than 10 years

2. Trees to be considered for retention:
A1, 2 or 3 = trees of high quality (substantial contribution >40 yrs)
B1, 2 or 3 = trees of moderate quality (significant contribution >20 yrs)
C1, 2 or 3 = trees of low quality (but adequate, ie >10 yrs or young trees - until new planting can be established)

Note: Useful estimated remaining contribution of the tree or tree group based on figures stated in BS5837:2012 |
| Condition | Brief description including physiological and structural defects |
| Tree Works | Works required to be undertaken to the trees to facilitate the construction of remediate a defect encountered during the survey |
| Root Protection Radius | Radius of minimum root protection area in metres |
| Root Protection Area | Radius of minimum root protection area in metres calculated from section 4.6 and Annex D of BS5837:2012
Total area of minimum root protection area extrapolated from root protection radius |

Rev	Description	Date
A	Hollies shown for removal	25.11.20
0	Preliminary issue	19.11.20

KEEN CONSULTANTS
 Keen Consultants is a trading name of Keen (Europe) Limited. Registered No.: 12641584
 Registered office: 4 Sufley Road, Bognor Regis, West Sussex, PO21 1EU

The Studio, Timbers,
 Gables Road, Church Crookham
 Fleet, Hampshire
 GU52 6QY
 T 01252 850096
 mail@keenconsultants.co.uk
 keenconsultants.co.uk

Client
HAMPTON SCHOOL

Project
**HAMPTON PRE-PREP SCHOOL,
 HAMPTON**

Title
TREE PROTECTION PLAN

Date
 NOV 2020

Scale
 1:250@A3

Drawn by
 ML

Checked by
 JTK

Drawing Number
1543-KC-XX-YTREE-TPP01RevA

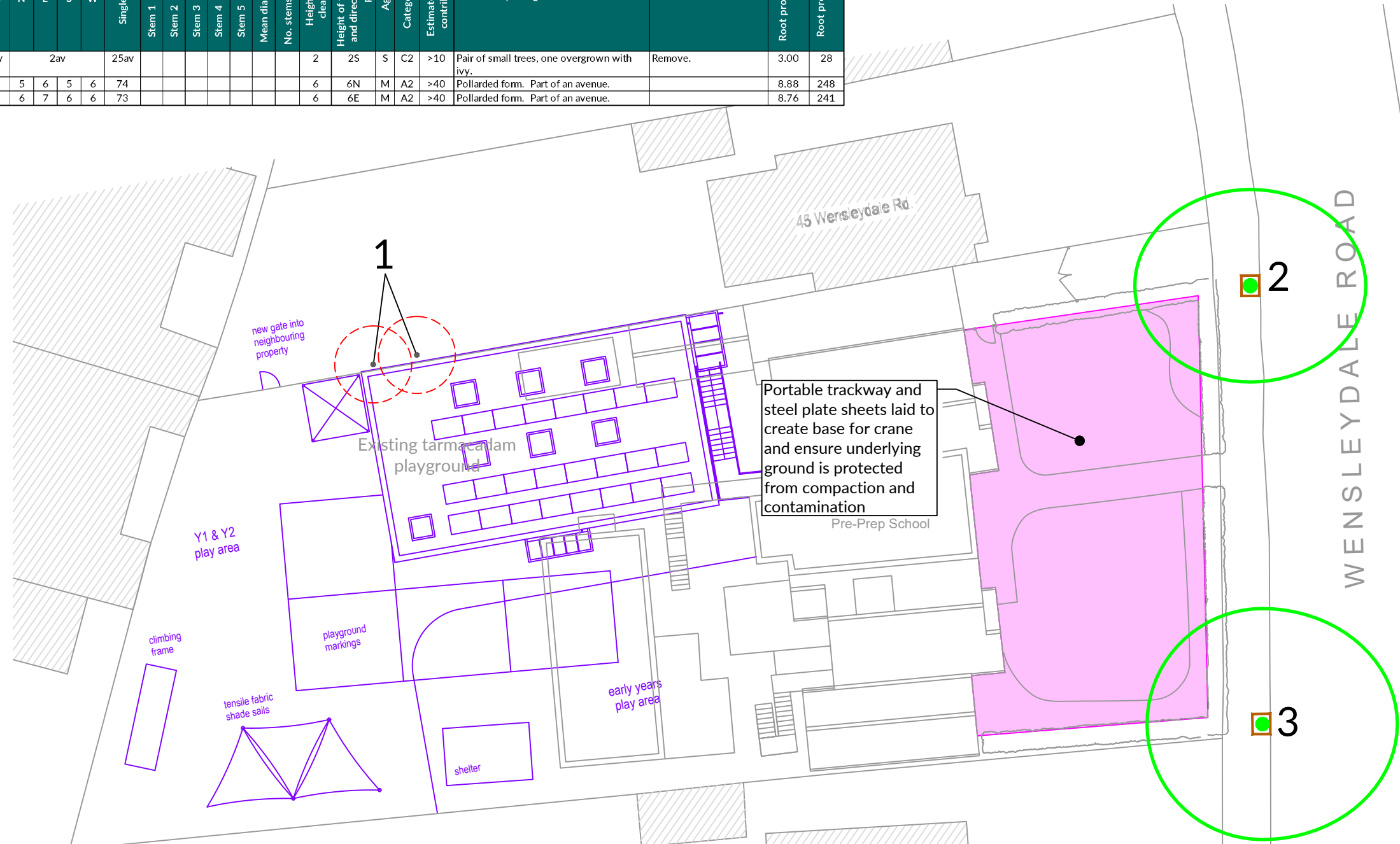
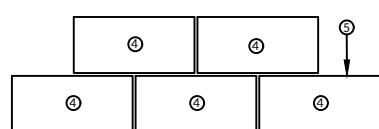
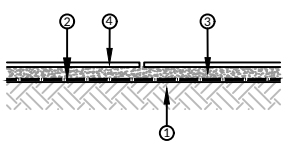

Figure 2: Typical ground protection detail



Plan of ground protection detail



Section of ground protection detail

- Existing ground
- Geotextile membrane eg. Terram 1000 or similar
- Compression-resistant layer (e.g. 100mm depth of woodchip)
- Robust sheets (timber, steel, recycled plastic) overlying Terram 1000 or similar
- Where wider than one sheet stagger joints

Figure 4: Timber boxing to protect tree trunk

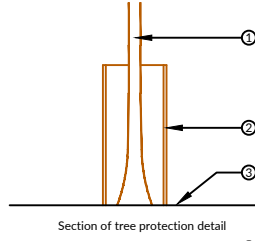

Section of tree protection detail



Plan of tree protection detail

- Trunk of tree
- Plywood box, typically 2.4m high, width to accommodate trunk
- Existing ground level