

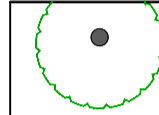

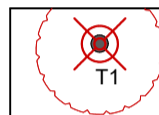



Proposed extension shown in magenta

Location of trial pits

-  TREE TO BE RETAINED
-  TREE TO BE REMOVED
-  A CATEGORY TREE
-  B CATEGORY TREE
-  C CATEGORY TREE
-  U CATEGORY TREE
-  ROOT PROTECTION AREA (RPA) FOR RETAINED TREES

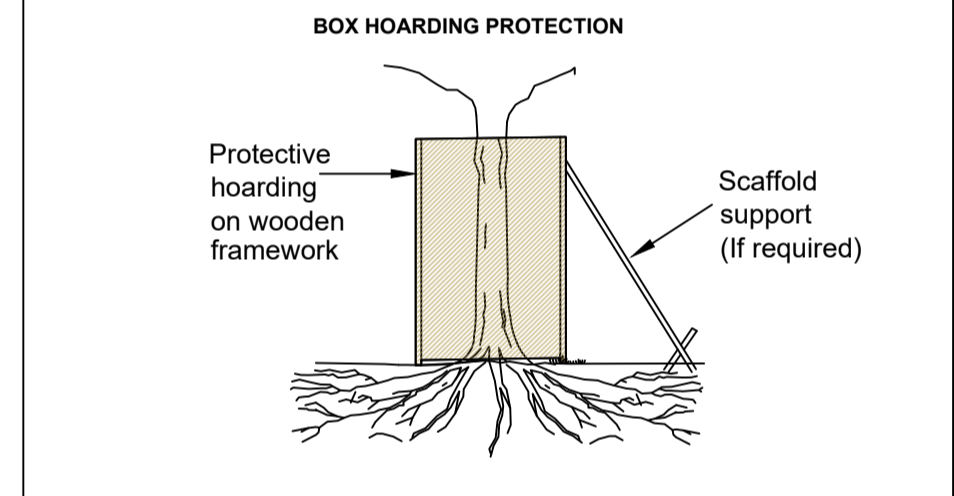

The original of this drawing was produced in colour - a monochrome copy should not be relied upon.



Rev	Date	Details	Drawn



**ACD ENVIRONMENTAL**  
 HEAD OFFICE  
 Rodbourne Rail Business Centre, Malmesbury,  
 SN16 0ES  
 Tel: 01666 825646  
 4 & 5 The Old Mill, Fry's Yard, Bridge Street, Godalming,  
 GU7 1HP  
 Tel: 01483 425714  
 Suite 6, Crescent House, Yonge Close, Eastleigh,  
 SO50 9SX  
 Tel: 02382 026300  
 email: mail@acdenv.co.uk  
 www.acdenvironmental.co.uk

Copyright of ACD. All rights described in Chapter IV of the Copyright, Designs and Patents Act 1988 have been generally asserted. 2015. Copyright of this plan remains with ACD until all fees have been paid in full.

scheme: Twickenham Studios. The Barons, Twickenham  
 client: Twickenham Studios  
 drawing: Tree Survey Plan  
 date: 6.01.2020  
 scale: 1:200@A1  
 dwg no: PRI23128-01 Sheet 1 of 2  
 drawn: RA checked: XXX

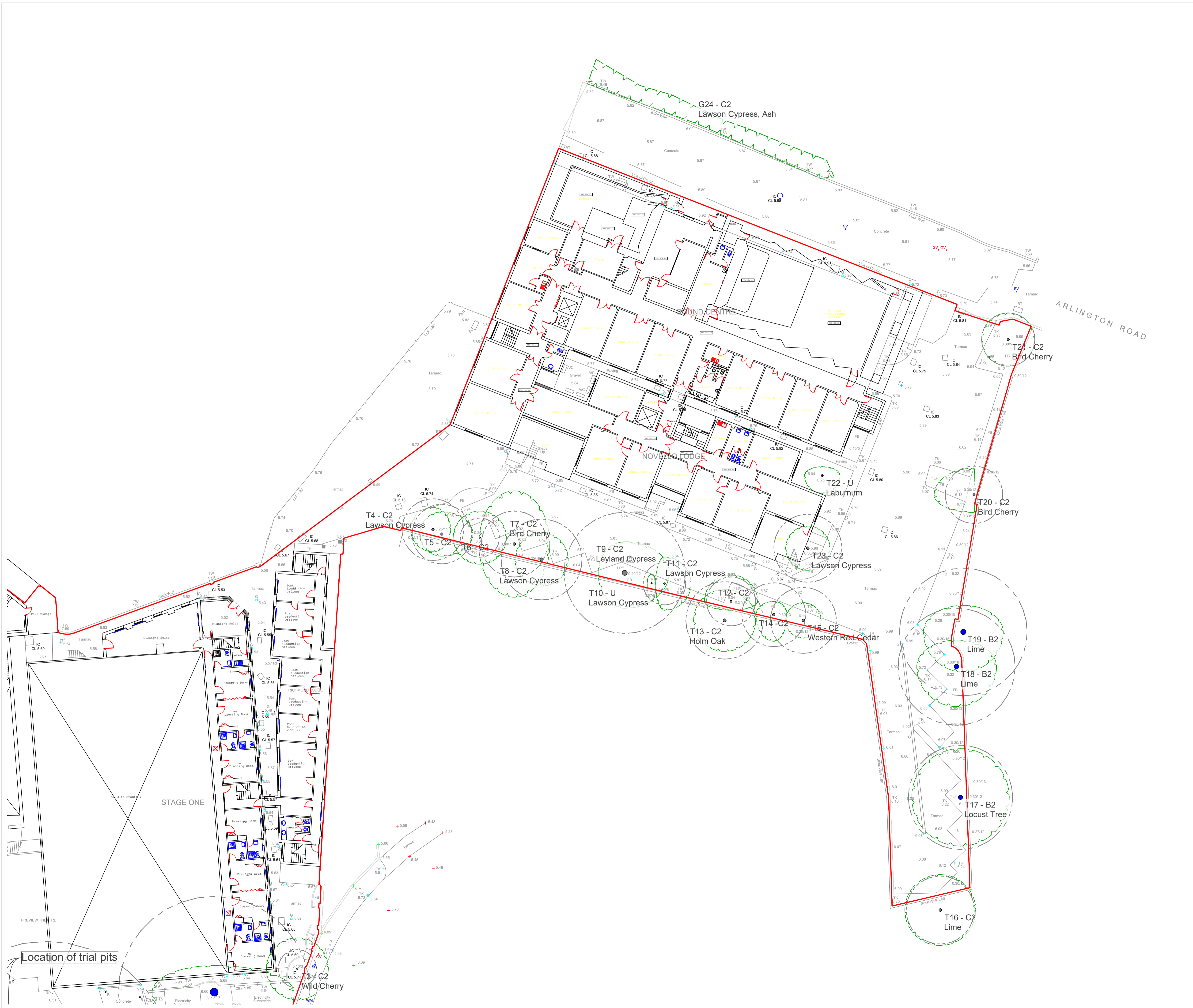

**TREE TO BE RETAINED**

**TREE TO BE REMOVED**

**A CATEGORY TREE**  
**B CATEGORY TREE**  
**C CATEGORY TREE**  
**U CATEGORY TREE**

**ROOT PROTECTION AREA (RPA) FOR RETAINED TREES**

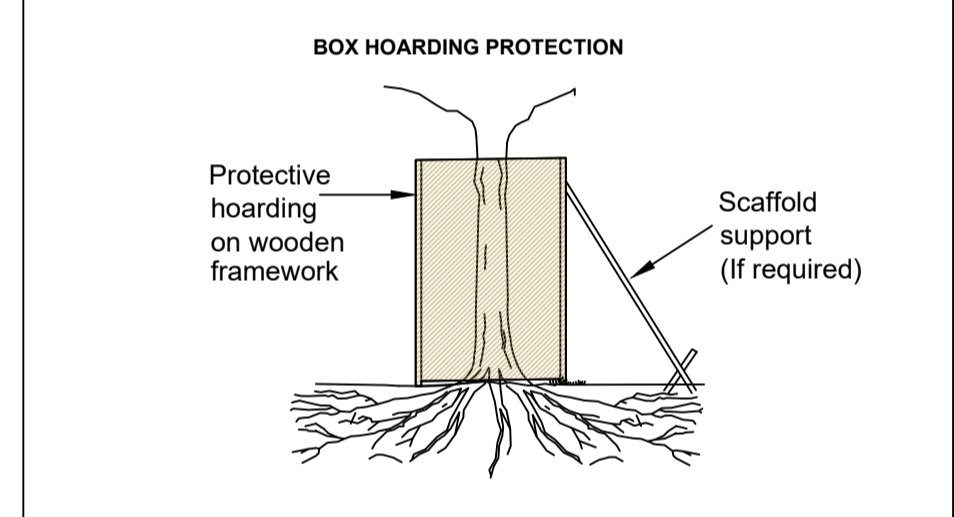

The original of this drawing was produced in colour - a monochrome copy should not be relied upon.

Rev	Date	Details	Drawn

**ACD ENVIRONMENTAL**

HEAD OFFICE  
 Rodbourne Rail Business Centre, Malmesbury,  
 SN16 0ES  
 Tel: 01666 825646

4 & 5 The Old Mill, Fry's Yard, Bridge Street, Codrington,  
 GU7 1HP  
 Tel: 01483 425714

Suite 6, Crescent House, Yonge Close, Eastleigh,  
 SO50 9SX  
 Tel: 02382 026300  
 email: mail@acdenv.co.uk  
 www.acdenvironmental.co.uk

Copyright of ACD. All rights described in Chapter IV of the Copyright, Designs and Patents Act 1988 have been generally asserted. 2015. Copyright of this plan remains with ACD until all fees have been paid in full.

scheme: Twickenham Studios. The Barons, Twickenham  
 client: Twickenham Studios  
 drawing: Tree Survey Plan  
 date: 17.12. 2020  
 scale: 1:200@A1  
 dwg no: PRI23128-01 Sheet 2 of 2  
 drawn: RA checked: XXX