

HIP TO GABLE VOLUME IS 17.2m<sup>2</sup>

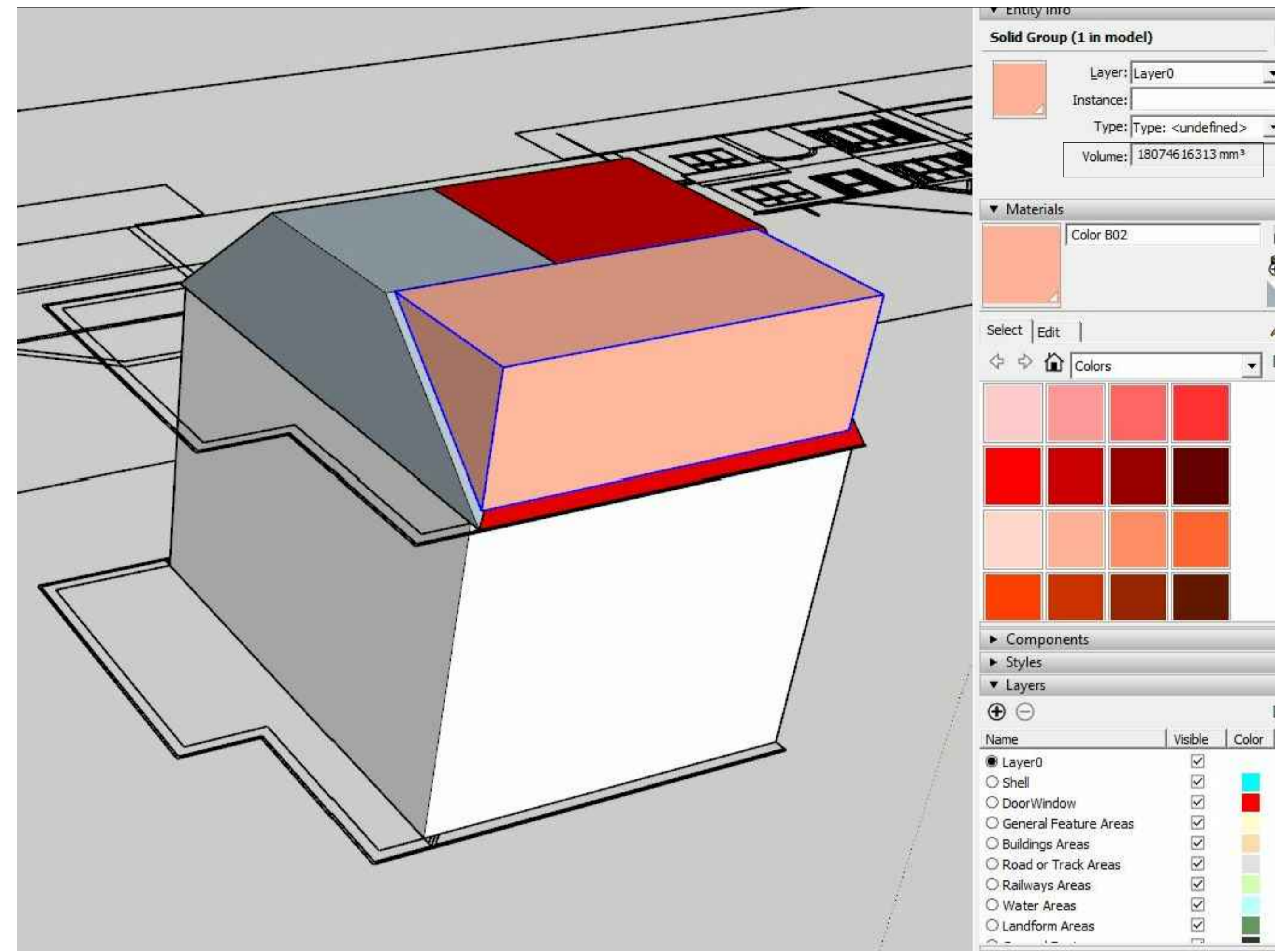

REAR DORMER VOLUME IS 18m<sup>2</sup>

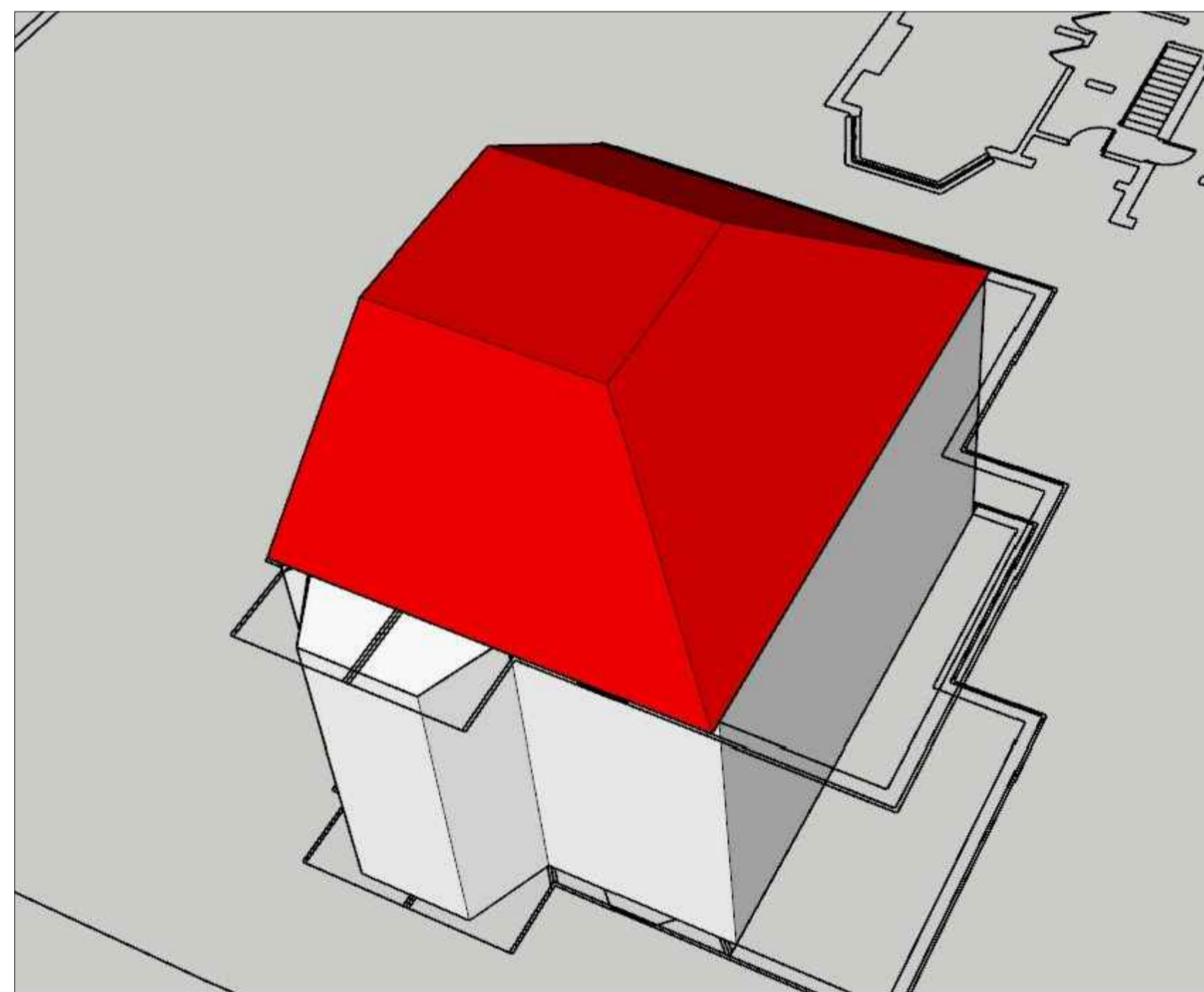

EXISTING ROOF

TOTAL VOLUME INCREASE IS 35.2m<sup>2</sup>

114 MONTROSE AVENUE, WHITTON, TW2 6HD

LOFT CONVERSION

CALCULATIONS

date FEB 2021	client MR FIROZ KHAN
scale N.T.S	drawing no. 20 / 114M / P 202
	revision -



**MIKE BECK DESIGN**

t: 07961 031 843  
w: www.mikebeckdesign.co.uk  
e: info@mikebeckdesign.co.uk