



Photo 1



Photo 2



Photo 3



Photo 4



Photo 5



Photo 6

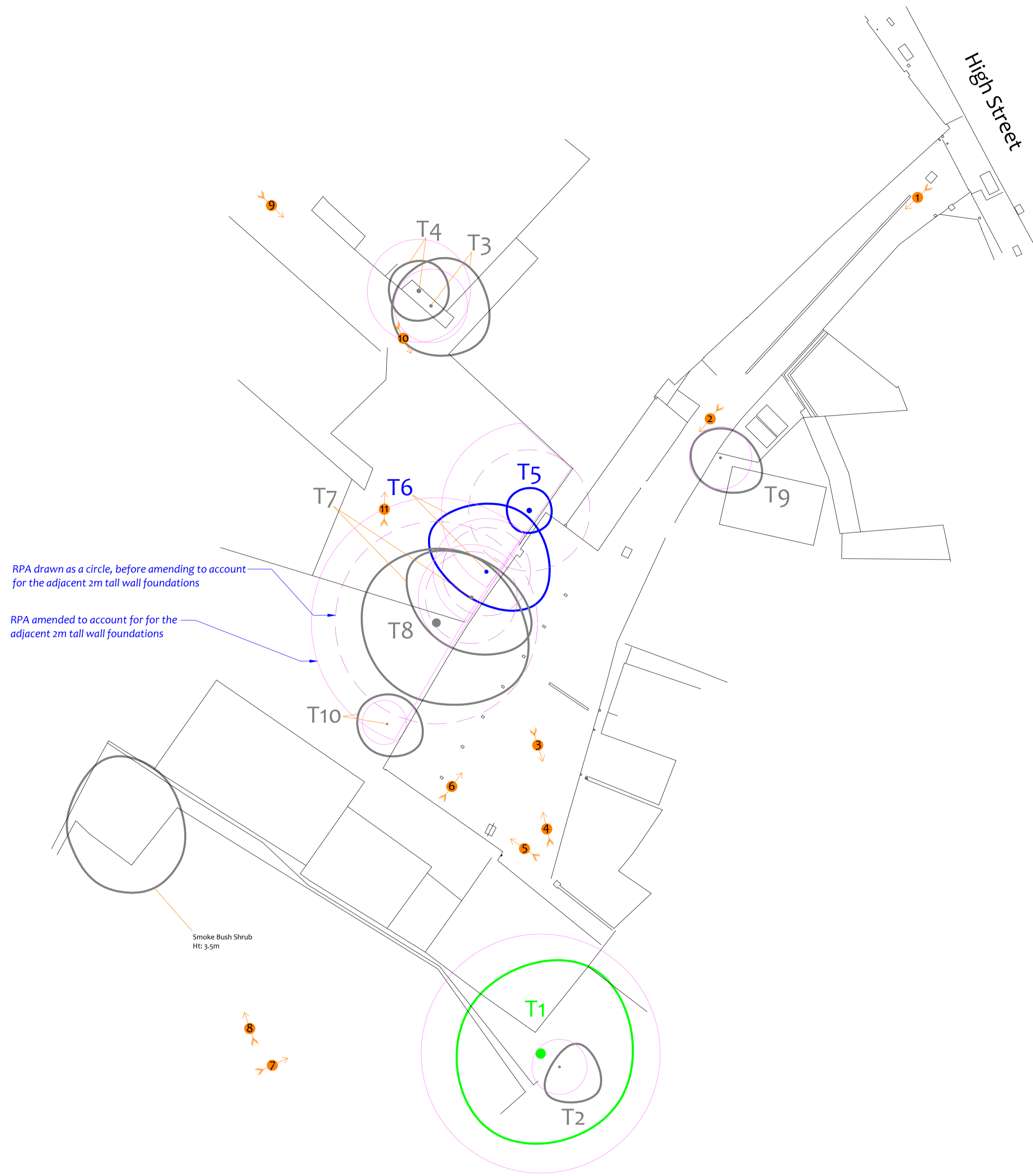

Photo 7

Drawing No: CCL 10330 / TCP Rev: 2
 Title: Tree Constraints Plan (Existing Layout)
 Site: 29 High Street KT1 4DA
 Scale: 1:300 Paper Size: A1



Tree Retention Categories		Stems & canopies shown
	Category A tree	Trees of high quality with an estimated life expectancy of 40+ years. Usually large trees with significant presence or smaller trees with excellent form. Retention of these trees is highly desirable.
	Category B tree	Trees of moderate quality with a life expectancy of 20+ years. Usually maturing trees or younger trees with good form. Retention of these trees is desirable though less than Category A trees.
	Category C tree	Unremarkable trees of low quality and merit. Individual specimens are not considered to be a material planning consideration.
	Category U tree	Trees unsuitable for retention due to their very poor condition.



Tree Constraints Plan

	B5 s37 Root Protection Area (radius = 1x stem diameter)
	Root Protection Area needing amendment due to site conditions, e.g. presence of existing road or building.
	Root Protection Area having been amended to account for site conditions

Photo 1

MN = Measured North:
 Canopy spreads are sometimes measured to an approximate N defined by site features. Often more accurate, especially where rows of trees are not aligned N-S or E-W.

Tree Ref.	Species	Height (m)	Root Protection Area	
			Radius (m)	Square (m)
T1	Ash	15	7.8	191
T2	Holly	5	1.8	10
T3	Ash	7	2.4	18
T4	Lawson Cypress	6	3.4	35
T5	Lawson Cypress	13	4.0	49
T6	Ash	12	2.9	26
T7	Ash	12	3.0	28
T8	Cherry	6	6.6	137
T9	Ash	6	2.0	13
T10	Ash	4.5	1.4	7

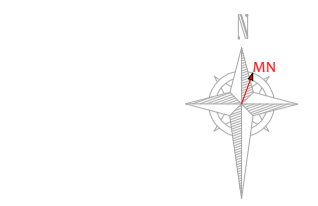

Tree Constraints Plan (Existing Layout)



Photo 8



Photo 9



Photo 10



Photo 11

Excerpts from the Arboricultural Impact Assessment

Overview

It is proposed to demolish number 29 High Street along with some disused workshops at the rear of the site and construct a new mixed-use development with associated car parking, as indicated on the plans in Appendix 6. The existing layout is indicated in black, the footprint of the proposed ground floor layout is indicated in pale green and the first floor footprint is indicated in turquoise.

The table below summarises the potential impact on trees due to various activities.

Activity	Trees Potentially Affected
Tree Removal	None
Tree Pruning	T1, T3, T8 and T9
RPA Building Foundations	T1
RPA Other Foundations	None
RPA New Hard Surface	None
RPA Replace Existing Hard Surface	None
RPA Underground Services	None Anticipated
RPA Change of Ground Levels	None
RPA Soil Compaction	Trees adjacent the construction area (preventable by installing tree protection measures)

Tree Removal

All trees are to be retained.

Impact on Tree Canopies

A single storey building is proposed close to the outer canopy of T1. It is proposed to remove its lower branches to a height of 4.5m where they overhang the proposed building to ensure adequate clearance to install the building and prevent any accidental damage to overhanging branches during construction.

The lower branches of T8 are to be removed to a height of 3m where they overhang the proposed car parking spaces to ensure adequate clearance for vehicles parking and operating beneath.

It is also proposed to trim the overhanging foliage of T3 and T9 back to the boundaries (or close to them) to ensure adequate clearance for construction activity and increase clearance from the nearest proposed building. This shall require the removal of relatively small secondary branches which should be pruned back to a secondary growth point where possible.

So long as all pruning works are undertaken sympathetically (working to BS 3998: 2010 guidelines), such pruning shall have no impact on local visual amenity.

Impact on Tree Roots

Foundations:

The foundations for the new single-storey building will extend into approximately 10% of the outer, theoretical Root Protection Area of T1. The potential detrimental impact is considered to be relatively small, however, in order to minimise the potential impact on the trees' root system, a shallow raft or beam foundation is to be installed. The following restrictions are proposed:

- Excavation shall be overseen by the local authority tree officer or the project arborist.
- Excavation shall be limited to a maximum depth of 300mm to facilitate the installation of a raft or beam foundation.
- Hand tools or a small, carefully marshalled mechanical excavator shall be used during the excavation, so long as it operates from a suitable load spreading surface.
- If necessary, the raft/beam may be supported on narrow diameter piles (maximum diameter 250mm). However, before installing such piles, their location shall be determined by trial pits excavated to a depth of 600mm using hand tools and overseen by the arborist. Trial pits should be kept as narrow as possible and if any roots in excess of 20mm diameter are encountered, the pile shall be relocated.
- If roots in excess of 50mm diameter are encountered close to the edge of the excavation, they shall be retained wherever possible and protected with damp sacking during times that they are unearthed. Any roots that need to be severed shall be pruned with secateurs.

By adopting this method of installation, it will be possible to retain all significant roots and ensure that the root system will be able to supply the canopy with the required water and nutrients. Hence it is considered that the proposal shall not result in any long term detrimental impact on the health of T1. Furthermore, the proposed canopy pruning shall create a slight reduction in demand for water and nutrients upon the root system such that it shall be able to cope with the small incursion into its Root Protection Area.

New Surfaces:

No new surfaces are proposed within the Root Protection Areas of any trees.

Underground Services:

No underground services should be installed through any Root Protection Area without consulting the project arborist and if necessary, gaining approval from the local authority.

See Section 4
for a more
detailed assessment

Drawing No:	CCL 10330 / IAP Rev: 1
Title:	Impact Assessment Plan (Existing Layout with Proposals Overlaid)
Site:	29 High Street KT1 4DA
Scale:	1:2000 Paper Size: A1



Tree Retention Categories	
	Category A tree
	Category B tree
	Category C tree
	Category U tree

	Trees of high quality with an estimated life expectancy of 40+ years. Usually large trees with significant presence or smaller trees with excellent form. Retention of these trees is highly desirable.
	Trees of moderate quality with a life expectancy of 20+ years. Usually maturing trees or younger trees with good form. Retention of these trees is desirable though less than Category A trees.
	Unremarkable trees of low quality and merit. Individual specimens are not considered to be a material planting consideration.
	Trees unsuitable for retention due to their very poor condition.

Proposed Ground Floor Layout (Pale Green)
Proposed First Floor Layout (Dashed Turquoise)

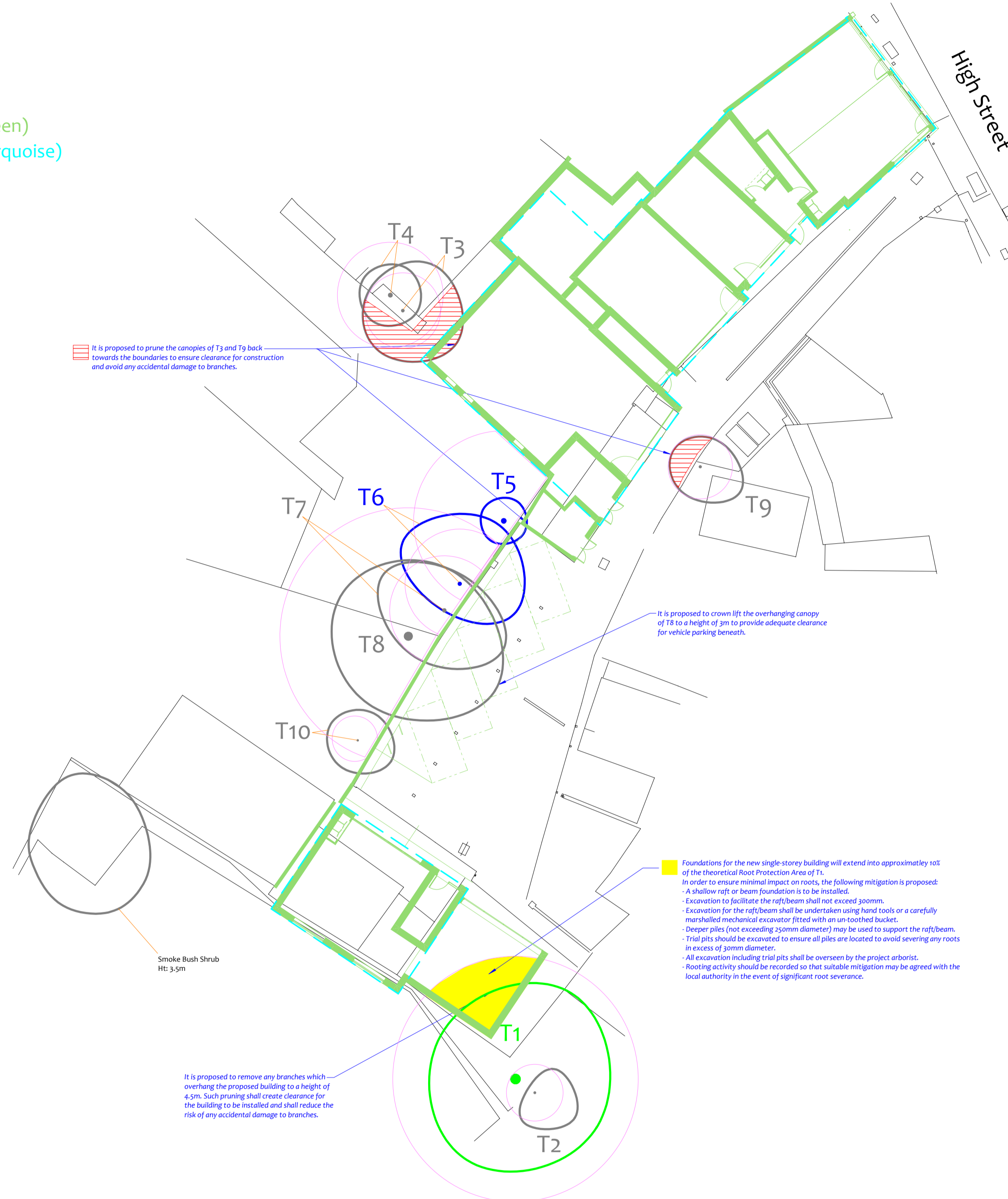

Impact Assessment Plan

(Existing Layout with Proposals Overlaid)

	BS 5837 Root Protection Area (radius = 1x stem diameter)
	Root Protection Area needing amendment due to site conditions, e.g. presence of existing road or building.
	Root Protection Area having been amended to account for site conditions
T1 = Tree No 1	G2 = Group No 2 H3 = Hedge No 3

	Tree to be removed to facilitate the proposal
	Tree to be removed due to its low quality
	Proposed pruning

MN = Measured North:
Canopy spreads are sometimes measured to an approximate N defined by site features. Often more accurate, especially where rows of trees are not aligned N/S or E/W.

Tree Ref.	Species	Height (m)	Root Protection Area	
			Radius (m)	Square (m)
T1	Ash	15	7.8	191
T2	Holly	5	1.8	10
T3	Ash	7	2.4	18
T4	Lawson Cypress	6	3.4	36
T5	Lawson Cypress	13	4.0	49
T6	Ash	12	2.9	26
T7	Ash	12	3.0	28
T8	Cherry	6	6.6	137
T9	Ash	6	2.0	13
T10	Ash	4.5	1.4	7

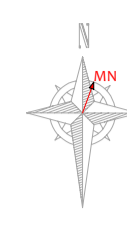

Impact Assessment Plan

(Existing Layout with Proposals Overlaid)

Tree Protection Barriers

The purpose of tree protection barriers is to keep construction activity away from Restricted Activity Zones or Construction Exclusion Zones. They should be appropriate to the nature and proximity of activity within the site. The barriers should be erected prior to the commencement of all activity including demolition, soil stripping and delivery of materials and demolition (except where existing structures require demolition to enable the barriers to be installed). Barrier systems are specified below and should be installed according to the legend on the Tree Protection Plan.

Stem Protection – Timber Boxing

Where indicated by a turquoise square on the Tree Protection Plan, it shall be necessary to install robust plywood boxing to protect the stem of T9. The plywood boxing specification is indicated in the diagram below. The actual size of the plywood boxing shall be determined by the extent of the root flare at the base of its stem. The box shall be large enough to avoid contact with any part of the tree that it surrounds. No fixings shall be attached to any part of the tree. Instead, it shall be free standing or attached to the ground or adjacent structures (e.g. walls or fences). It shall be made firm enough to withstand occasional knocks from any plant machinery that may be operate in its vicinity.

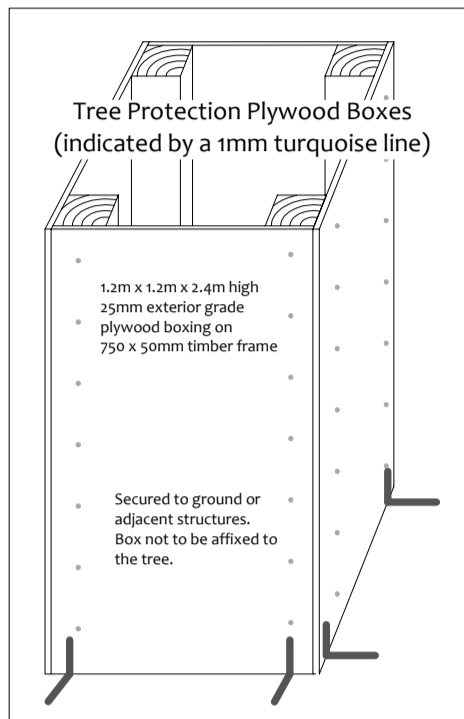

Removal of Tree Protection Barriers

Removal of protective fencing or ground protection measures shall be done after all major construction work is complete and their removal has been approved by the appointed arborist.

Notices

Suitable weather-proof notices shall be displayed to identify tree protection zones. They should state the purpose of the fencing and that it should not be moved, or traversed, other than by authorised persons.

Tree Works Specification

The following table specifies the tree works which will be required prior to the commencement of construction activity:

Tree Reference	Action Required	Notes
T1	Crown lift to 4.5m on the side facing the property	Branches to be pruned back to a secondary branch junction or the branch collar wherever possible.
T8	Crown lift to fit on the side overhanging the proposed car parking spaces.	Branches to be pruned back to a secondary branch junction or the branch collar wherever possible.
T3 and T9	Lightly trim prune back towards the boundaries.	Only light pruning to be undertaken to provide suitable clearance for construction vehicles and to provide clearance from the proposed building.

Ground Protection Measures

Within Restricted Activity Zones, soils containing roots may be subject to compaction due to general construction activity (including pedestrian activity and use of plant machinery), in order to minimise compaction. It is proposed to ensure that a suitable load-spreading surface is in place at all times. Any existing hard surfacing may be retained where engineers consider it adequate to spread the load of construction traffic. Otherwise it shall be reinforced or replaced with adequate ground protection measures.

Unless specified otherwise, ground protection shall consist of 24mm OSB boards laid at double thickness and screwed together to prevent slippage. The ground shall first be made even by raking, or by adding a few centimetres of sand or woodchips. Where only pedestrian traffic will occur boards or planks may be supported by a scaffold framework. The scaffold may be founded on poles driven into the ground and/or onto blocks (to raise the scaffold) with additional couplings to make the framework secure.

Where engineers consider OSB boards to be inadequate (e.g. for large plant machinery where the tracks may chew up the timber) sturdier ground protection measures will be installed such as road plates, or rooms of 75mm angular gravel installed in 30 cellular confinement system (e.g. CelwebTM).

If a piling mat is required, engineer's specifications should be referred to. The ground protection measures shall be installed and approved before commencement of demolition and construction activity and before the arrival of plant machinery or materials. They shall remain in place until all heavy construction activity is complete or until they are due to be replaced with a new hard surface.

Construction Exclusion Zones

Within Construction Exclusion Zones the following restrictions shall apply:

- Tree Protection Barriers shall be erected and maintained throughout the entire project as indicated on the Tree Protection Plan and under the header 'Tree Protection Barriers'.
- These shall remain in place at all times except when authorised landscaping works are being undertaken. At such times, adequate ground protection measures shall be installed, and excavation shall be limited to that required for new planting. Furthermore, the project arborist shall be consulted prior to any works being undertaken in these zones.
- No construction activity or excavation shall occur unless agreed otherwise by the project arborist and local authority.
- No vehicles or plant machinery shall be driven or parked.
- No tree works other than those specified on this document shall be undertaken.
- No alterations of ground levels or conditions shall occur.
- No chemicals or cement washings permitted.
- No temporary structures shall be installed.
- No spoil shall be stored.
- No fires shall be permitted.
- All hazardous materials (including non-essential cement products) shall be forbidden.
- Removal of hard surfaces, structures or turf shall be done using hand operated tools only and supervised by the project arborist.

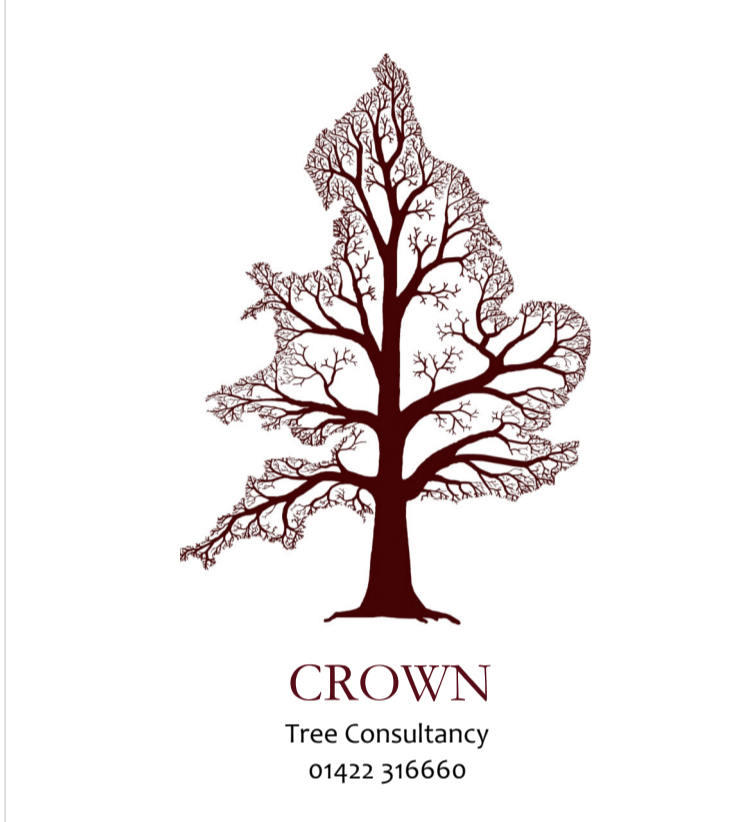

Timing of Operations
Activity within the site shall be phased according to the following chronology

Order	Phase	Activity
1st.		Planning conditions relating to trees to be identified and discussed with the Project arborist and site manager.
2nd.		All specified tree removal and pruning to be undertaken (see Header -Tree Works Schedule).
3rd.	Pre-Construction Phase	Install the tree protection barriers (fencing and ground protection boards - see Headers -Tree Protection Barriers and Ground Protection Measures).
4th.		Pre-Commencement site meeting: Tree protection barriers inspected. Additional protection measures to be agreed. Variances to be agreed. Location of underground services to be agreed. Boundary treatments to be agreed. Extents of excavation to be agreed. Scaffold restrictions to be agreed. Scope of future inspections / monitoring to be agreed.
5th.		Arboricultural Method Statement to be revised and approved necessarily.
Protection measures confirmed acceptable by the local authority		
6th.	Construction Phase	Demolish existing structures and remove existing surfaces where applicable.
7th.		Install new buildings, hard surfaces and services taking into account restricted activities as specified in this Arboricultural Method Statement.
8th.		Site meeting with project arborist. Landscaping restrictions to be agreed. Condition of retained trees to be assessed and mitigation agreed. Ground conditions to be assessed and ground remediation to be agreed.
9th.	Post-Construction Phase	Remove protective barriers (fencing and ground protection measures as applicable).
10th.		Undertake restricted landscaping operations within Root Protection Areas, including (where applicable) boundary treatments, pedestrian surfaces, decking and any proposed tree planting.

Personnel and Accountability
This table should be completed at the Pre-Start Meeting or earlier

Position	Name	Contact Phone & email	Roles
Project Manager	Insert Details	Insert Details	Liaising with site manager & project arborist regarding any potential issues relating to trees. Scheduling of meeting, excavations and inspections. Overseeing this monitoring schedule. Instructing the project arborist and arranging access. Liaising with local authority regarding discharge of planning conditions and variances to the Arboricultural Method Statement.
Site Manager	Insert Details	Insert Details	Day to day monitoring of tree protection measures. Fortnightly supply of site photographs showing all tree protection measures. Induction of all contractors. Reporting to the Appointed Arborist of any incidents or potential variations to the agreed tree protection measures.
Project Arborist	Crown Tree Consultancy	08000 1413 30 0203 797 7449 info@crownstreecol.co.uk	Liaising with LPA Tree Officer over all arboricultural matters. Initial inspection and signing off of tree protection barriers including ground protection measures. Monthly site visits and inspections. Oversight of excavation for basement down to 1.2m in Restricted Zones. Reporting to the local authority following site inspections and any variation or incidents. Receipt of reports from the appointed arborist. Liaising with the appointed arborist to agree suitability of tree protection measures and any variations. Enforcement. Advice and assistance with the discharge of planning conditions relating to trees.
Local Authority	London Borough of Richmond upon Thames	Insert Details	Insert Details
Additional Contact	Insert Details	Insert Details	Insert Details
Additional Contact	Insert Details	Insert Details	Insert Details

Site Monitoring Schedule

Inspection	Site Attendees	Comments
Pre-Start Desk top To occur prior to any works taking place on the site.	N/A.	Project Manager and Site Manager to study this Method Statement & contact the Project Arborist to agree all protection measures.
Pre-Start Meeting After tree works completed & tree protection barriers / ground protection measures installed. Prior to any other activity, i.e. demolition & soil stripping.	Site manager, project arborist, Tree Officer invited.	The protection fencing locations & specification checked. Ground protection measures checked. Contractors to be inducted to all relevant aspects of the Arboricultural Method Statement. Responsibilities checked and acknowledged. Agreement to the Arboricultural Method Statement to be discussed and agreed. Report on findings to be sent to the local authority tree officer (see accompanying reporting template).
Monthly Inspection and Reporting To occur once per calendar month throughout the entirety of the project until the local authority agree that tree protection measures may be removed.	Site manager and project arborist.*	Tree protection fencing locations & specification checked. Ground protection measures checked. Past month, present and future month – activities and adherence to Arboricultural Method Statement discussed and checked. Report on findings to be sent to the local authority tree officer within 5 working days.
Overseeing Excavation for foundations in Restricted Activity Zone B. All excavation to be overseen.	Site manager and project arborist.	Two week's notice to be given prior to commencement. Excavation to be as specified in this Method Statement. Roots to be retained or pruned as specified in this Method Statement. Activities to be recorded and photographed. Mitigation measures to be employed specified by the project arborist.
Post-Construction Meeting Post external construction activity but prior to removal of fencing & landscaping operations.	Site manager, project arborist, Tree Officer invited.	Retained trees inspected. Ground conditions assessed and mitigation measures agreed where appropriate. Further landscaping operations and restrictions to be agreed.

* Where agreed with the L.A. it may be acceptable to supply photographs of the fencing to avoid the necessity for a site visit.

Tree Data Schedule

Reference	Age & Species	Height (m)	Crown Spread (m)	Green Retention (%)	Scalped Tree Diagram	Notes	Recommendations (Arboricultural Method Statement)	Priority	Value	Assess
T1	Mature Ash	15	2.5	65	5	Problem: Skirted on third party land. No evidence of significant pruning. Defects: No significant defects observed. Other: Limited inspection, dimensions estimated.	No action required.	Moderate	Good	40+
T2	Semi-Mature Holly	5	2	75	5	Problem: Skirted on third party land. Single stemmed and bearing with an unbalanced crown. History: No evidence of significant pruning. Defects: No significant defects observed. Other: Limited inspection, dimensions estimated.	No action required.	Moderate	Low	20-40
T3	Semi-Mature Ash	7	1.5	75	5	Problem: Skirted on third party land. Twin stemmed at ground level with a slightly unbalanced crown. History: No evidence of significant pruning. Defects: No significant defects observed. Other: Record stem diameter or equivalent for 3 stems (10cm, 20cm).	No action required.	High	Good	40+
T4	Lawson Cypress	6	0.5	75	5	Problem: Skirted on third party land. Single stemmed and vertical with a balanced crown. History: No evidence of significant pruning. Defects: No significant defects observed. Other: Record stem diameter or equivalent for 3 stems (20cm, 30cm).	No action required.	Moderate	Low	40+
T5	Lawson Cypress	13	3.5	75	5	Problem: Skirted on third party land. Single stemmed and vertical with a balanced crown. History: No evidence of significant pruning. Defects: No significant defects observed. Other: Structure to be checked.	No action required.	High	Good	40+
T6	Semi-Mature Ash	12	3.5	75	5	Problem: Skirted on third party land. Single stemmed and vertical with an unbalanced crown. History: No evidence of significant pruning. Defects: No significant defects observed.	No action required.	High	Good	40+
T7	Semi-Mature Ash	12	5	75	5	Problem: Skirted on third party land. Single stemmed and vertical with an unbalanced crown. History: No evidence of significant pruning. Defects: No significant defects observed.	No action required.	High	Good	40+
T8	Mature Cherry	6	1.5	75	5	Problem: Skirted on third party land. Multi-stemmed at 2cm. History: No evidence of significant pruning. Defects: No significant defects observed. Other: Limited inspection, dimensions estimated.	No action required.	Moderate	Low	10-20
T9	Semi-Mature Ash	6	2.5	75	5	Problem: Skirted on third party land. Single stemmed and vertical with a balanced crown. History: No evidence of significant pruning. Defects: No significant defects observed.	No action required.	High	Good	40+
T10	Young Ash	4.5	2.5	75	5	Problem: Skirted on third party land. Single stemmed and bearing with an unbalanced crown. History: No evidence of significant pruning. Defects: No significant defects observed. Other: Limited inspection, dimensions estimated.	No action required.	High	Good	40+

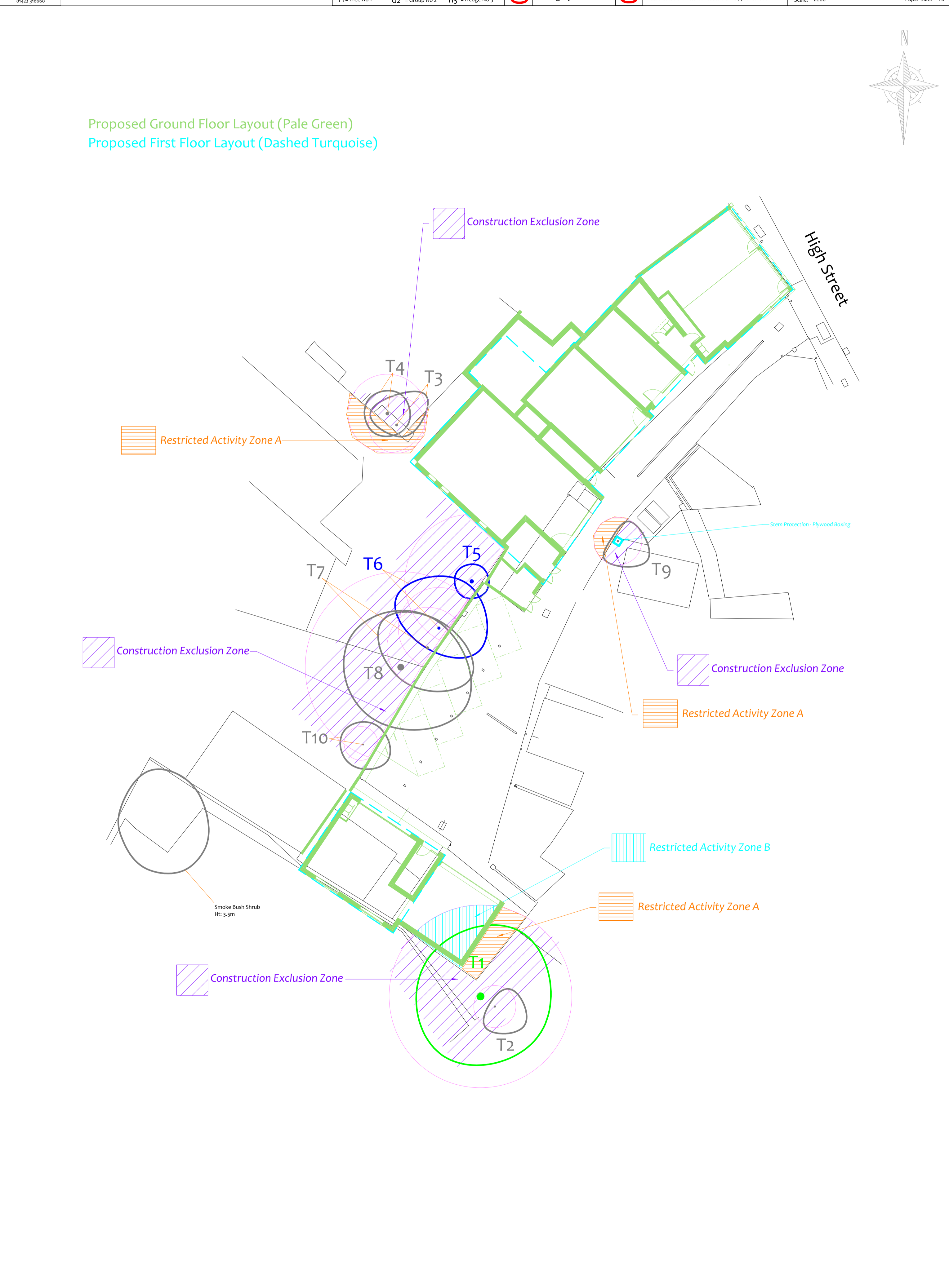

Restrictions in Specific Zones

Restricted Activity Zone A

Within these zones trees roots are likely to be present where access will be required to facilitate construction. The following restrictions shall apply:

- No vehicles or plant machinery shall park or operate unless a suitable load spreading surface is in place. The load spreading surface shall be installed and/or maintained as specified under the heading 'Ground Protection Measures'. This shall remain in place throughout the entire demolition and construction phase or until any new permanent hard surfacing is installed. Any pedestrian activity other than very occasional staff also using a suitable load spreading surface.
- Removal of existing structures such as walls, steps and hard surfaces (where applicable) shall be undertaken using hand tools or a mechanical excavator operating from outside the Restricted Activity Zone and carefully marshalled by the project arborist.
- No excavation shall occur beneath any existing hard surfacing and its sub-base or beneath the foundations of any structure such as wall, steps or patio.
- No further excavation shall occur in this zone without consulting the project arborist and obtaining approval from the local authority.
- Existing ground levels shall be retained undisturbed or raised by no more than 100mm. Ground levels may only be raised using granular topsoil (not rich in clay) or where new surfacing is proposed.
- No new permanent or temporary structures shall be erected other than those shown on the planning application documents unless approved by the local authority.
- Underground services shall not be installed in this area without prior consultation with the project arborist and a methodology agreed and approved by the local authority.
- If roots are encountered in excess of 25mm diameter, they shall be retained wherever possible and protected with damp sacking during times that they are unearthed. Any roots in excess of 25mm that need to be severed shall be pruned with secateurs.
- Storage of materials and spoil shall be avoided unless it has been agreed with the project arborist that the ground protection measures are adequate to ensure no soil compaction or contamination occurs. All hazardous materials (including non-essential cement products) shall be forbidden.
- No fires shall be permitted.

Restricted Activity Zone B

In this zone foundations are to be installed. In order to minimise the impact on roots, it is proposed to install a shallow foundation. The following restrictions shall apply:

- Deep concrete strip foundations shall not be acceptable in this area. Instead, a shallow raft or beam foundations shall be installed.
- Excavation for the raft or beam shall be limited to a depth of 300mm and shall be undertaken using hand tools. A mechanical excavator may only be used if agreed by the project arborist overseeing the excavation and if it operates from a suitable load spreading surface. Hand tools shall always be used to probe the upper soil horizons before any mechanical excavation occurs.
- Excavation shall not exceed 300mm beyond the building footprint unless approved otherwise by the local authority.
- Roots in excess of 25mm which are located close to the bottom or the edge of the excavation are to be retained (if possible) and covered with wet sacking while exposed. All roots in excess of 20mm which cannot be retained shall be neatly pruned with secateurs.
- Narrow diameter piles may be installed to support the raft or beam foundation. In which case, trial pits shall be excavated to determine the location of the piles. Trial pits shall be 300mm x 300mm and excavated using hand tools to a depth of 600mm. Excavation shall be undertaken in the presence of project arborist. Soil shall first be loosened with a garden fork to ascertain if large roots are present before the loosened soil is removed with a spade. If roots in excess of 25mm are encountered, they shall be retained (wherever possible) and the pile shall be relocated. Roots in excess of 20mm shall be pruned using sharp secateurs. Beyond this depth, piles may be installed using an auger or piling rig. The diameter shall not exceed 300mm unless agreed otherwise with the local authority.

General Restrictions - Throughout the Site

Preparatory Works

No demolition, removal of surfaces, or soil stripping shall commence until the protective fencing and ground protection measures are installed to the satisfaction of the local authority.

Fires

No fires shall be permitted beneath any tree canopy or within 5m of any tree stem, branch or foliage. No fires shall be permitted in the vicinity of any Construction Exclusion Zone or Restricted Activity Zone. No fires shall be permitted in the vicinity of any exposed tree roots.

Canopy Protection

In order to protect tree canopies the following restrictions shall apply throughout the site:
 • No machinery in excess of 2m shall pass beneath the canopy of any tree without being carefully marshalled in order to ensure that no branches are damaged.
 • If materials require installation or delivery beneath tree canopies, this shall be done without the use of overhead cranes.
 • If materials are to be installed or delivered close to tree canopies (but not beneath them) and a crane is required, they shall be carefully marshalled in order to ensure that branches are not accidentally damaged.

Storage of Spoil and Materials

Storage of materials and spoil shall be avoided in any Construction Exclusion Zones and Restricted Activity Zones unless it has been agreed with the project arborist that the ground protection measures are adequate to ensure no soil compaction or contamination occurs. All hazardous materials (including non-essential cement products) shall be forbidden.

Hazardous Materials

Any mixing of cement based materials shall take place outside the Construction Exclusion Zones and Restricted Activity Zones. Where cement is to be mixed at considerable distances from trees and water run-off cannot enter Root Protection Areas, then no further special measures are required. Otherwise, provision shall be made to ensure that the mixing area is contained so that no water run-off enters the Root Protection Area of any trees (see diagram for example). Mixers and barrows will be cleaned within this area.

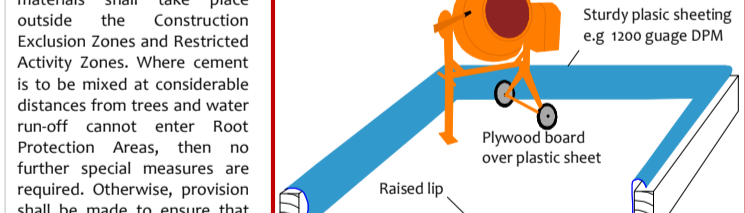

Underground Services

No underground services (including soak-aways) shall be located in any part of the Construction Exclusion Zones or Restricted Activity Zones unless done so in a manner detailed in a specific Method Statement and approved by the local authority.

Site Hoarding

- If site hoarding shall be installed over the Root Protection Area of any tree, the following restrictions shall apply:
 • Ground levels shall be maintained as existing.
 • Post holes shall not exceed 300mm x 300mm.
 • No post hole shall be excavated within 5m of any tree stem.
 • Post holes shall be excavated using hand tools or by a post-hole auger attached to plant machinery sited outside of Root Protection Areas.
 • Roots in excess of 20mm shall be retained wherever possible.
 • Roots in excess of 20mm shall be pruned with sharp secateurs.
 • Fencing shall be minimal and only undertaken where absolutely necessary to facilitate the site hoarding. It shall be undertaken by a reputable tree surgeon working to BS 3988 (2010).

Site hoarding may be installed in place of the specified tree protection measures subject to the approval of the local authority with regard to its location and specification.

Siting of Cabins

Cabins shall be located outside of Construction Exclusion Zones and Restricted Activity Zones unless agreed otherwise by the project arborist. Where this is being considered, the project arborist shall be consulted and specific tree protection measures agreed. The following general restrictions will apply:
 • All services to and from site cabins shall be installed above ground through any Root Protection Areas.

- No excavation shall occur within Root Protection Areas to enable cabins to be installed.
- The cabins shall be founded on a suitable load spreading surface.

Fence Posts or Decking Posts

If permanent fencing or decking is to be installed within Root Protection Areas, the following restrictions shall apply:

- All post holes shall be excavated by hand and kept as narrow as possible (maximum diameter 300mm).
- Exploratory post holes shall be dug before committing to post / panel positions. If any roots in excess of 25mm are encountered they are to remain intact and the post hole shall be relocated slightly. The fencing system must permit such flexibility (i.e. where fixed panel widths are used all post holes must be excavated before committing to the final location).
- Any roots in excess of 20mm which are severed shall be neatly pruned back with secateurs. This will encourage healing and reduce the likelihood of infection. Walls shall be avoided over Root Protection Areas unless their foundations may be spanned over roots using a beam system. Hedges may be planted within Root Protection Areas using hand tools to minimise excavation.

