

BUR 26 - 6 BURNELL AVENUE, RICHMOND, TW10 7YE
 House extension and remodelling for Philippa and Limoz Logli
PROPOSED GROUND FLOOR PLAN
 Scale 1:100@A3

© Mark Prizeman 2021

26th February 2021

Mark Prizeman AADipl RIBA, chartered architect -
 7 Dilke Street, London SW3 4JE
 TEL: 020 7460 1348
 MOB: 07990 525 869
 E-MAIL: markprizeman@hotmail.com
 markprizeman@btinternet.com
 WEB: www.prizeman.co.uk

PROPOSED

PLOT SIZE = 383.126 sq m
 ORIGINAL BUILDING FOOTPRINT
 HOUSE PLUS OUT BUILDINGS = 55.986 sq m
 OPEN SPACE WITHIN CURTILAGE = 327.14 sq m
 PROPOSED EXTENSION FOOTPRINT TO HOUSE = 82.327 sq m
 LESS INCLUDED OUT BUILDING FOOT PRINT = 75.459 sq m
 plus
 STUDIO OUT BUILDING = 34.715 sq m
 EQUALS LOSS of 110.174 sq m to open space
 leaving 53.396 sq m to 50% limit on development

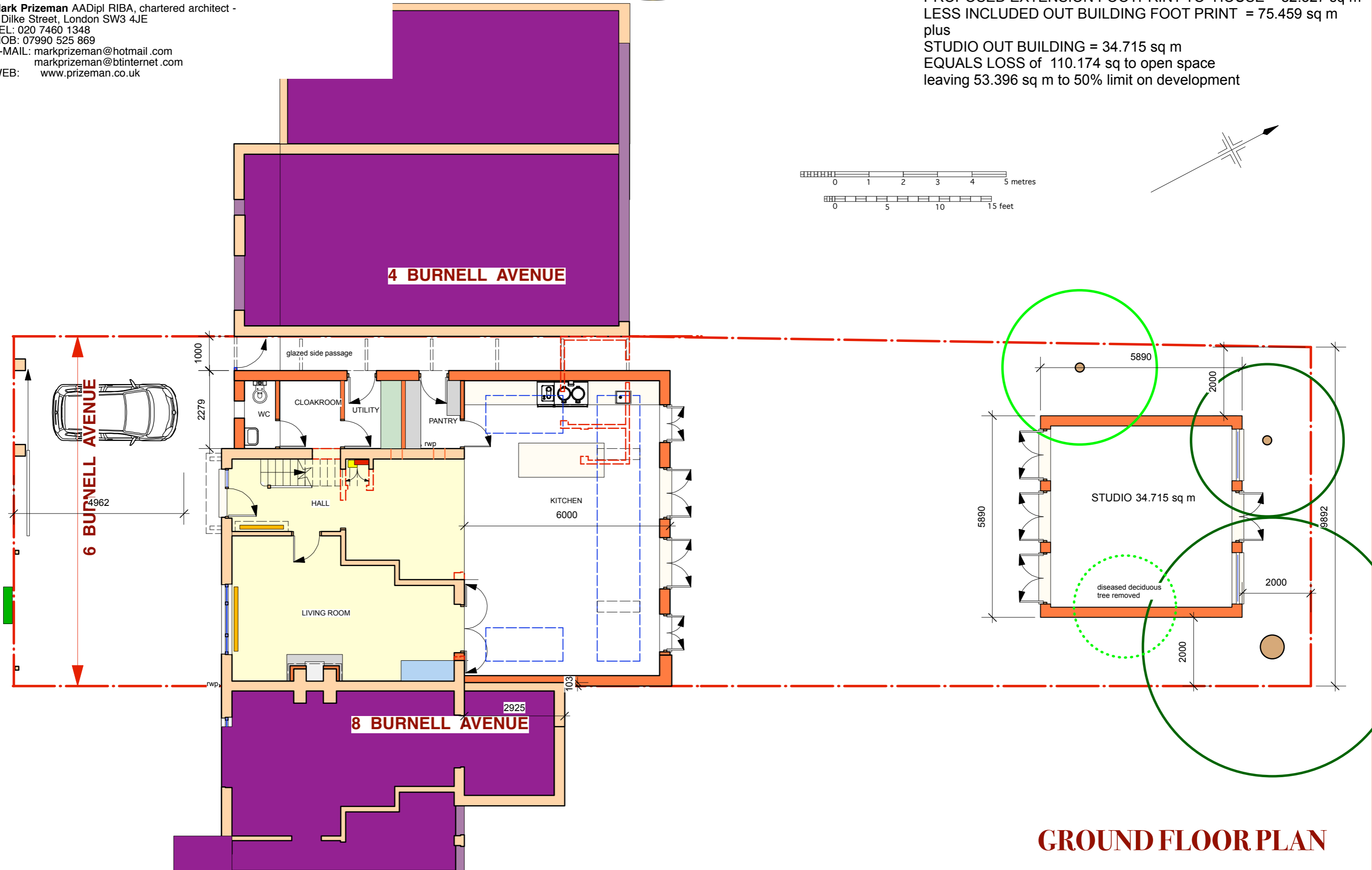

GROUND FLOOR PLAN