

DIMENSIONS

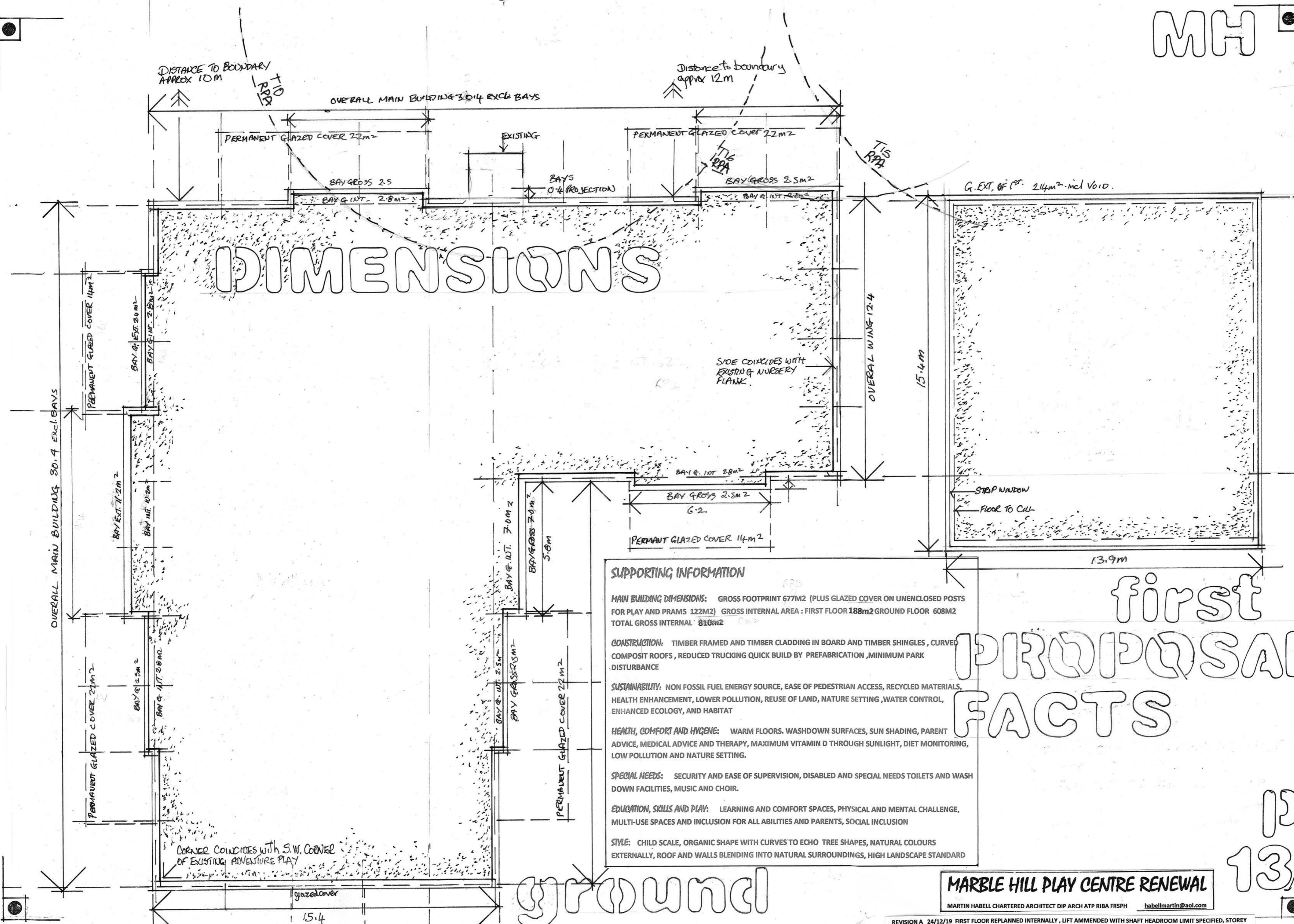

SUPPORTING INFORMATION

MAIN BUILDING DIMENSIONS: GROSS FOOTPRINT 677M² (PLUS GLAZED COVER ON UNENCLOSED POSTS FOR PLAY AND PRAMS 122M²) GROSS INTERNAL AREA : FIRST FLOOR 188M² GROUND FLOOR 608M² TOTAL GROSS INTERNAL 810M²

CONSTRUCTION: TIMBER FRAMED AND TIMBER CLADDING IN BOARD AND TIMBER SHINGLES, CURVED COMPOSITE ROOFS, REDUCED TRUCKING QUICK BUILD BY PREFABRICATION, MINIMUM PARK DISTURBANCE

SUSTAINABILITY: NON FOSSIL FUEL ENERGY SOURCE, EASE OF PEDESTRIAN ACCESS, RECYCLED MATERIALS, HEALTH ENHANCEMENT, LOWER POLLUTION, REUSE OF LAND, NATURE SETTING, WATER CONTROL, ENHANCED ECOLOGY, AND HABITAT

HEALTH, COMFORT AND HYGIENE: WARM FLOORS, WASHDOWN SURFACES, SUN SHADING, PARENT ADVICE, MEDICAL ADVICE AND THERAPY, MAXIMUM VITAMIN D THROUGH SUNLIGHT, DIET MONITORING, LOW POLLUTION AND NATURE SETTING.

SPECIAL NEEDS: SECURITY AND EASE OF SUPERVISION, DISABLED AND SPECIAL NEEDS TOILETS AND WASH DOWN FACILITIES, MUSIC AND CHOIR.

EDUCATION, SKILLS AND PLAY: LEARNING AND COMFORT SPACES, PHYSICAL AND MENTAL CHALLENGE, MULTI-USE SPACES AND INCLUSION FOR ALL ABILITIES AND PARENTS, SOCIAL INCLUSION

STYLE: CHILD SCALE, ORGANIC SHAPE WITH CURVES TO ECHO TREE SHAPES, NATURAL COLOURS EXTERNALLY, ROOF AND WALLS BLENDING INTO NATURAL SURROUNDINGS, HIGH LANDSCAPE STANDARD

first PROPOSAL FACTS

13

MARBLE HILL PLAY CENTRE RENEWAL
 MARTIN HABELL CHARTERED ARCHITECT DIP ARCH ATP RIBA FRSPH habelmartin@aol.com