

NOTES
 Drawings for sketch purposes only
 and not for construction.

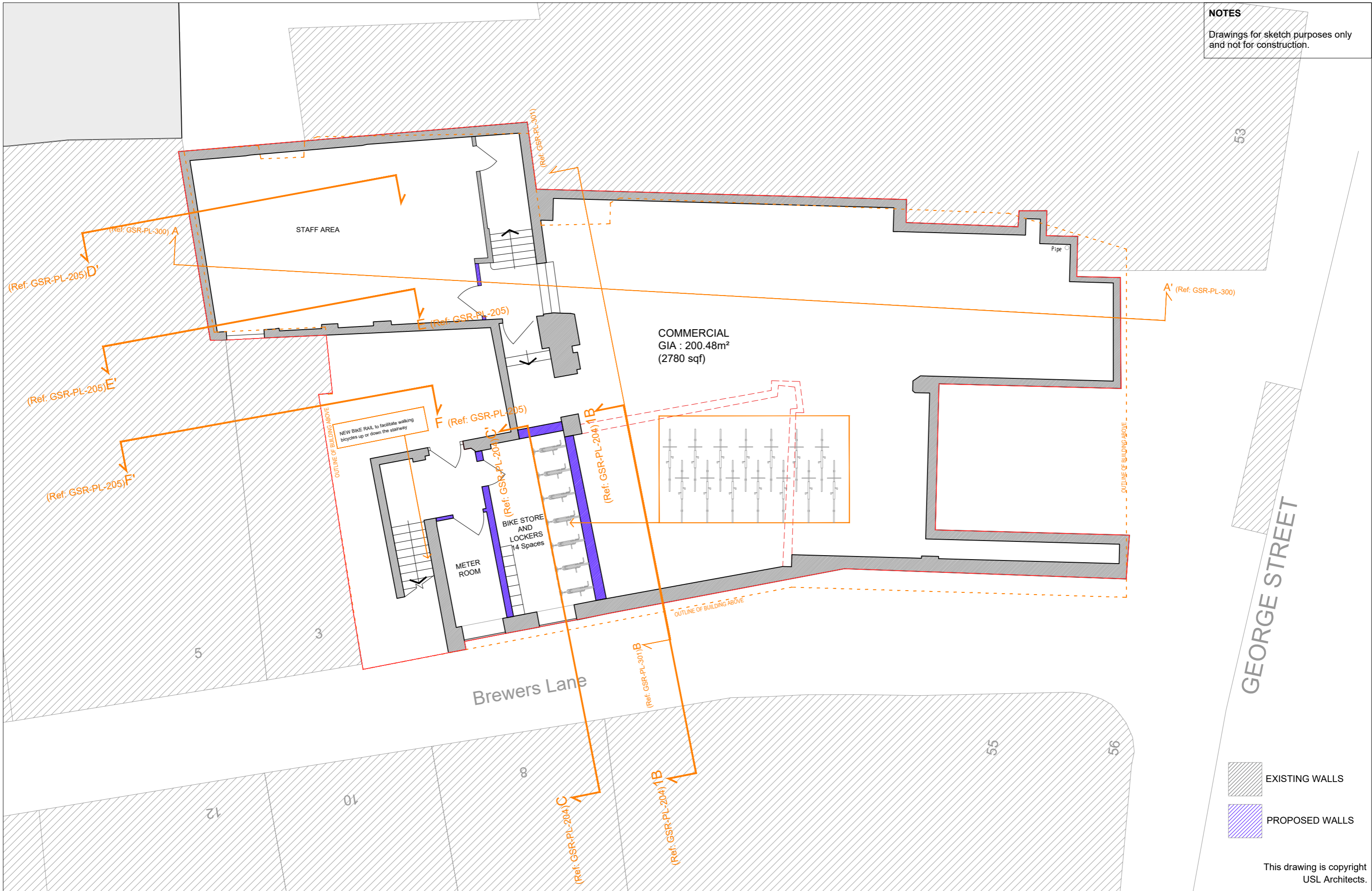

EXISTING WALLS
 PROPOSED WALLS

This drawing is copyright
 USL Architects.

USL ARCHITECTS
 Ground floor
 7 Progress Business Centre
 Whittle Parkway
 Burnham SL1 6DQ
 England
 usl@uslarchitects.co.uk

Job No.	20/ GSR
Date	22/04/2021

Job
GEORGE STREET RICHMOND
 53-54 GEORGE STREET,
 RICHMOND, SURREY
 TW9 1HJ

Drawing
 PROPOSED BASEMENT

Drawing No.	GSR/PL/100	
Revision	Dwn	Chk
	CDG	BK

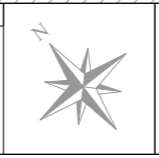

0m 1m 2m 3m 4m 5m 6m 7m 8m 9m 10m
 PAPER SIZE: A3
 SCALE 1:100