

The Hermitage Road

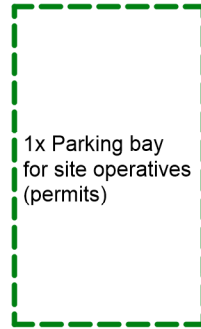

1x Parking bay for site operatives (permits)

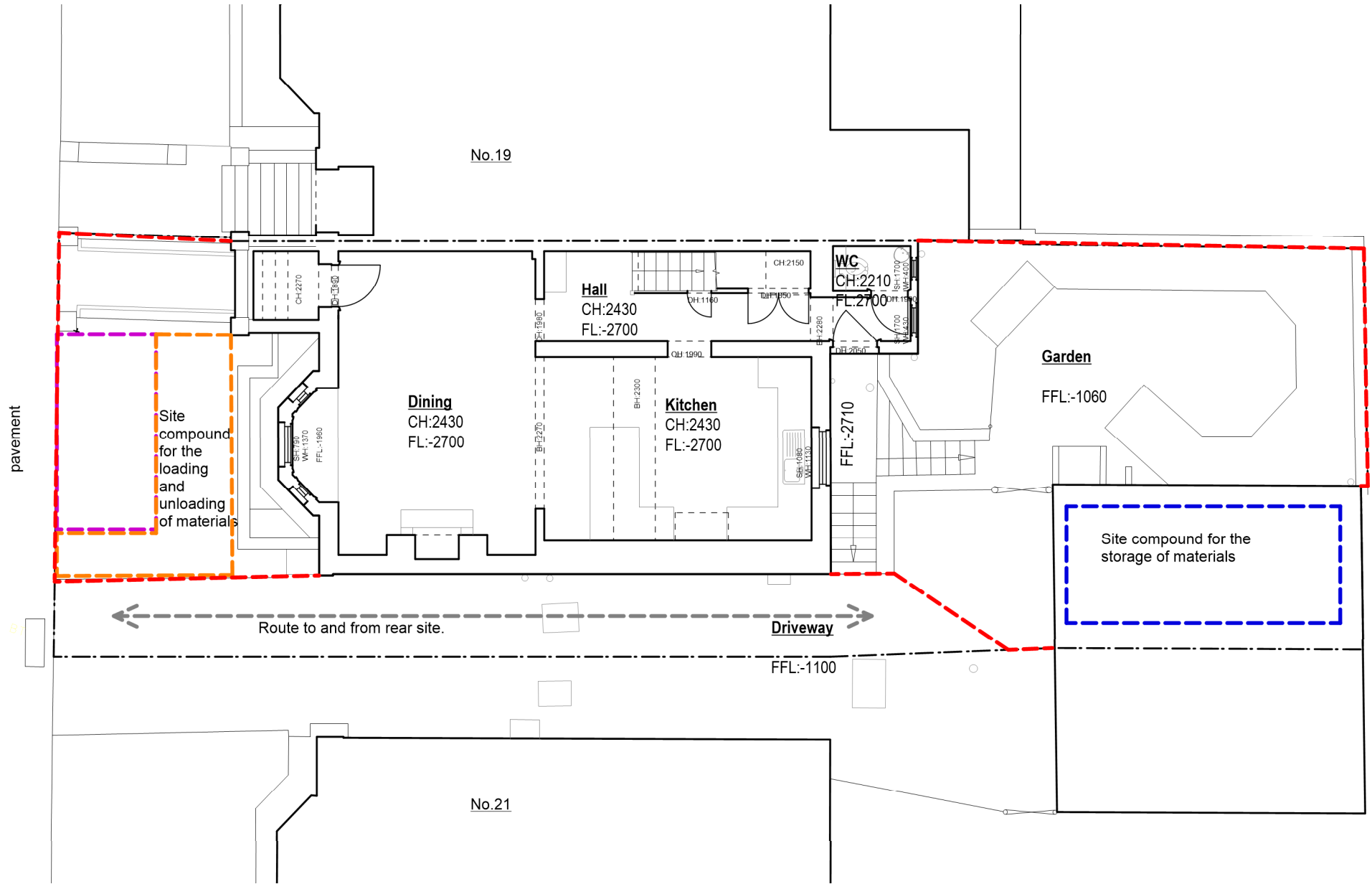

- 1x Parking bay for site operatives (permits) - - - - -
- Skip location - - - - -
- Site compound for the loading and unloading of materials - - - - -
- Hoarding - - - - -
- Site compound for the storage of materials - - - - -
- Route to and from rear site. - - - - -

Contractor to confirm:

- Tracking of construction vehicles to and from the site.
- Any wheel washing facilities.
- Demolition recycling schemes.
- Control of noise emissions, dust, vibration and working hours.
- Any license required.
- Phasing / timing of the works.
- Construction Programme.



| | | | | | | | | | | | | | | | | | | | | | | |
|---|-------------------------------------|--------------------|--|-------|------------|--------------------|---|--|---|---------|--------------|--|-----------------------------------|--|--|--|--|--|--|--|--|---|
| <table border="1" style="width: 100%; border-collapse: collapse;"> <tr> <td style="width: 10%;">Rev:</td> <td style="width: 10%;">Date:</td> <td style="width: 80%;">Description:</td> </tr> <tr> <td>-</td> <td>10.05.2021</td> <td>Issued to Planning</td> </tr> </table> | Rev: | Date: | Description: | - | 10.05.2021 | Issued to Planning | <table border="1" style="width: 100%; border-collapse: collapse;"> <tr> <td style="width: 10%;">Project:</td> <td style="width: 90%;">20 The Hermitage, Richmond TW10 6SH</td> </tr> <tr> <td>Dwg no:</td> <td>2103 / PL.06</td> </tr> <tr> <td>Drawing:</td> <td>Construction Management Statement</td> </tr> </table> | Project: | 20 The Hermitage, Richmond TW10 6SH | Dwg no: | 2103 / PL.06 | Drawing: | Construction Management Statement | <div style="font-size: 2em; font-weight: bold; margin-bottom: 5px;">3s</div> <div style="font-weight: bold; margin-bottom: 5px;">architects</div> <div style="font-weight: bold; margin-bottom: 5px;">interiors</div> <div style="font-weight: bold;">commercial</div> | | | | | | | | |
| Rev: | Date: | Description: | | | | | | | | | | | | | | | | | | | | |
| - | 10.05.2021 | Issued to Planning | | | | | | | | | | | | | | | | | | | | |
| Project: | 20 The Hermitage, Richmond TW10 6SH | | | | | | | | | | | | | | | | | | | | | |
| Dwg no: | 2103 / PL.06 | | | | | | | | | | | | | | | | | | | | | |
| Drawing: | Construction Management Statement | | | | | | | | | | | | | | | | | | | | | |
| <p>NOTES: Do not scale from this drawing. All dimensions in millimeters. All dimensions to be checked on site. All omissions and discrepancies to be reported to the architect immediately. This drawing is © 3s Architects and Designers. Use of these drawings must be authorised by 3s.</p> | | | <table border="1" style="width: 100%; border-collapse: collapse;"> <tr> <td style="width: 10%;">Date:</td> <td style="width: 10%;">April 2021</td> <td style="width: 10%;">C</td> <td style="width: 10%;">RW</td> <td style="width: 10%;">D</td> <td style="width: 10%;">JH</td> <td style="width: 10%;">Rev:</td> <td style="width: 10%;">-</td> <td style="width: 40%;">T +44 (0)20 8332 99 -66 F -91 W www.3s-ad.com E info@3s-ad.com</td> </tr> <tr> <td>Scale:</td> <td>1:100 @ A1</td> <td colspan="7"></td> <td>17A Princes Road, Richmond upon Thames, Surrey TW10 6DQ</td> </tr> </table> | Date: | April 2021 | C | RW | D | JH | Rev: | - | T +44 (0)20 8332 99 -66 F -91 W www.3s-ad.com E info@3s-ad.com | Scale: | 1:100 @ A1 | | | | | | | | 17A Princes Road, Richmond upon Thames, Surrey TW10 6DQ |
| Date: | April 2021 | C | RW | D | JH | Rev: | - | T +44 (0)20 8332 99 -66 F -91 W www.3s-ad.com E info@3s-ad.com | | | | | | | | | | | | | | |
| Scale: | 1:100 @ A1 | | | | | | | | 17A Princes Road, Richmond upon Thames, Surrey TW10 6DQ | | | | | | | | | | | | | |

PLANNING