

Proposed Package Co2 gas cooler

Proposed new platform in steel framework over existing stairs for plant access.

Proposed 3 Wall mounted AC units with two mounted one above other.

Proposed Satellite Dish.

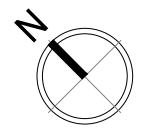
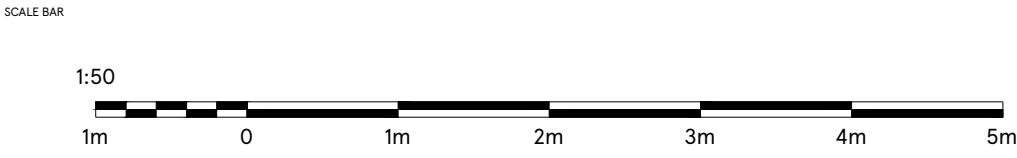
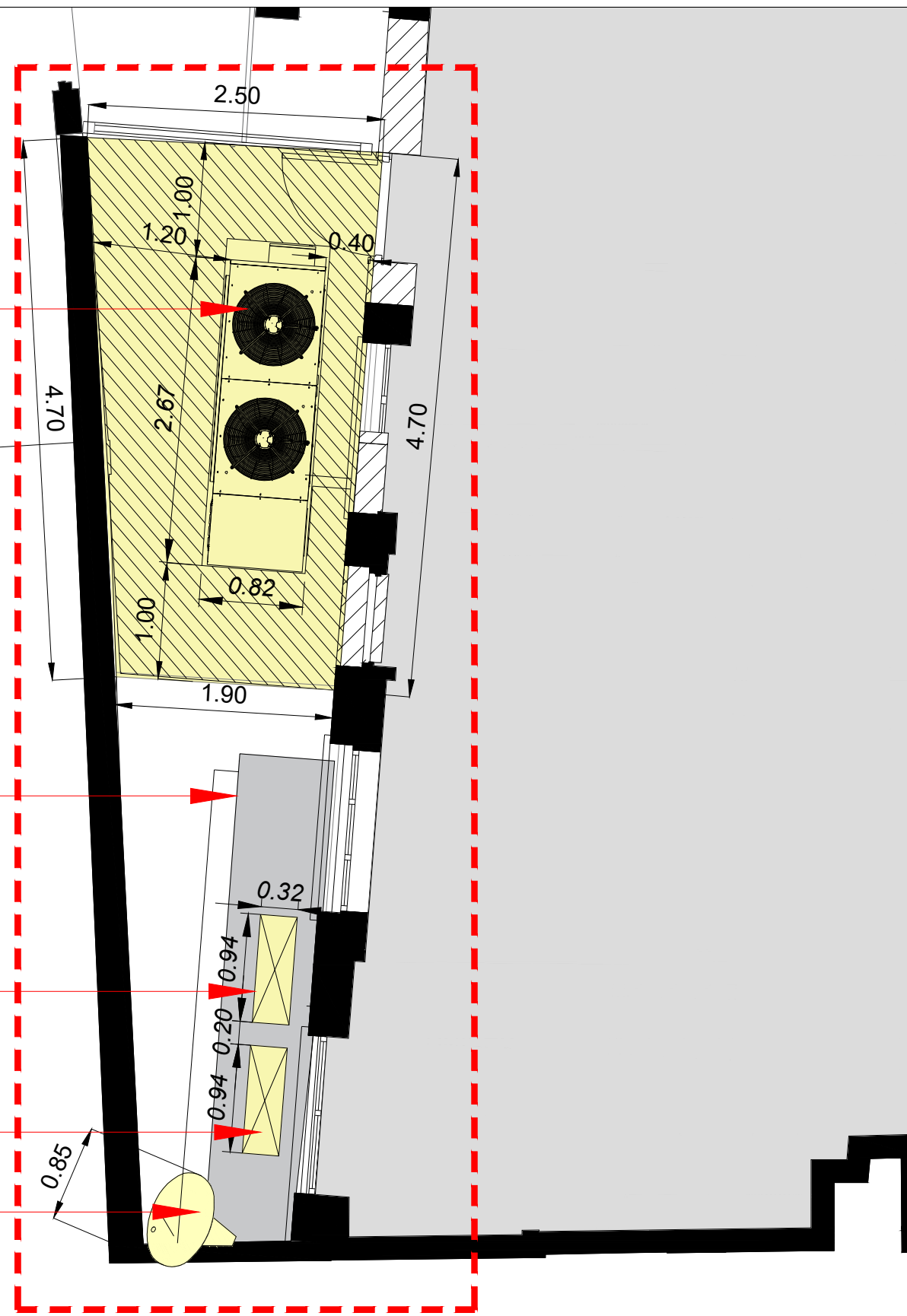

DRAWING NO
O2_TWIC_02D

SCALE 1:50@A3 DATE 02.03.2021

CHECKED BY ANDY HORWOOD
DRAWN BY SAISREE

STORE TYPE
EXPRESS

STORE NAME
TWICKENHAM

CONTENT
PROPOSED PART PLAN

TESCO
FEASIBILITY PLANNING
STORE PLANNING DEPARTMENT
PROPERTY SERVICES
HIGHWOODS BUILDING, KESTRAL WAY
WELWYN GARDEN CITY, HERTFORDSHIRE, AL7 1GB UK
TELEPHONE : 01707 395150

THE COPYRIGHT AND ALL OTHER RIGHTS IN AND RELATING TO THIS PUBLICATION BELONG TO AND ARE THE SOLE PROPERTY OF TESCO STORES LIMITED. ALL RIGHTS ARE RESERVED. NEITHER THE WHOLE NOR ANY PART OF THIS PUBLICATION MAY BE REPRODUCED OR TRANSMITTED IN ANY FORM OR BY ANY ELECTRONIC OR MECHANICAL MEANS INCLUDING PHOTOCOPIING AND RECORDING OR FROM ANY RETRIEVAL SYSTEM WITHOUT THE PRIOR WRITTEN LICENCE FROM THE OWNER. © 2021 TESCO STORES LIMITED