

© Ampersand Architecture LLP  
 Do not scale from this drawing.  
 Dimensions are to be verified on site prior to construction.  
 Ordnance Survey Data reproduced by permission of Ordnance Survey® on behalf of Her Majesty's Stationery Office. © Crown Copyright. All rights reserved.

Notes

Rev	Date	Prepared/Checked	Description

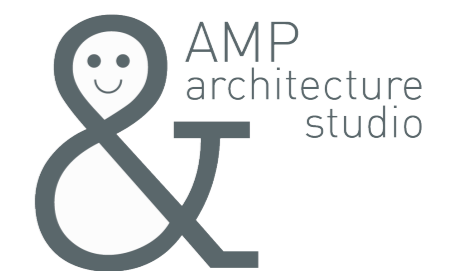

The Studio, 4 Cole Park Road, Twickenham TW1 1HW  
 AMP Architecture Studio is a trading name for  
 AMP Space Ltd (Company Registration 12452245)  
 07590 319111 / info@amparchitecture.co.uk  
 www.amparchitecture.co.uk

Client

**Ms Rachel Lang**  
 Project  
**5 Gordon Avenue, St Margarets,  
 Twickenham TW1 1NH**

Drawing Title  
**Existing Plan  
 Roof**

Drawing Status		Drawn
<b>Planning</b>		YT
Date	Scale	Revision
04.03.21	1:50@A2	-
Drawing Number	Revision	

**135-E-012**

