

Produced on 19 May 2021 from the Ordnance Survey National Geographic Database and incorporating surveyed revision available at this date.
 This map shows the area bounded by 516494 174694,516636 174694,516636 174836,516494 174836,516494 174694
 Reproduction in whole or part is prohibited without the prior permission of Ordnance Survey.
 Crown copyright 2021. Supplied by copla ltd trading as UKPlanningMaps.com a licensed Ordnance Survey partner (100054135).
 Data licence expires 19 May 2022. Unique plan reference: v2c/632787/857814

© Ampersand Architecture LLP
 Do not scale from this drawing.
 Dimensions are to be verified on site prior to construction.
 Ordnance Survey Data reproduced by permission of Ordnance Survey®, on behalf of Her Majesty's Stationery Office. © Crown Copyright. All rights reserved.

Notes

Rev	Date	Prepared/Checked	Description

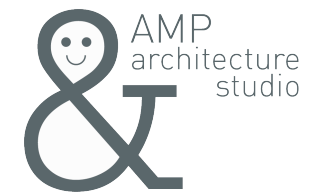

The Studio, 4 Cole Park Road, Twickenham TW1 1HW
 AMP Architecture Studio is a trading name for
 AMP Space Ltd (Company Registration 12452245)
 07590 319111 / info@amparchitecture.co.uk
 www.amparchitecture.co.uk

Client

Ms Rachel Lang
 Project
**5 Gordon Avenue, St Margarets,
 Twickenham TW1 1NH**

Drawing Title
Site Location Plan

Drawing Status		
Date	Scale	Drawn
19.05.21	1:1250@A3	OA
Drawing Number	Revision	
135-S-001	-	