

**NOTES**  
 Drawings for sketch purposes only  
 and not for construction.

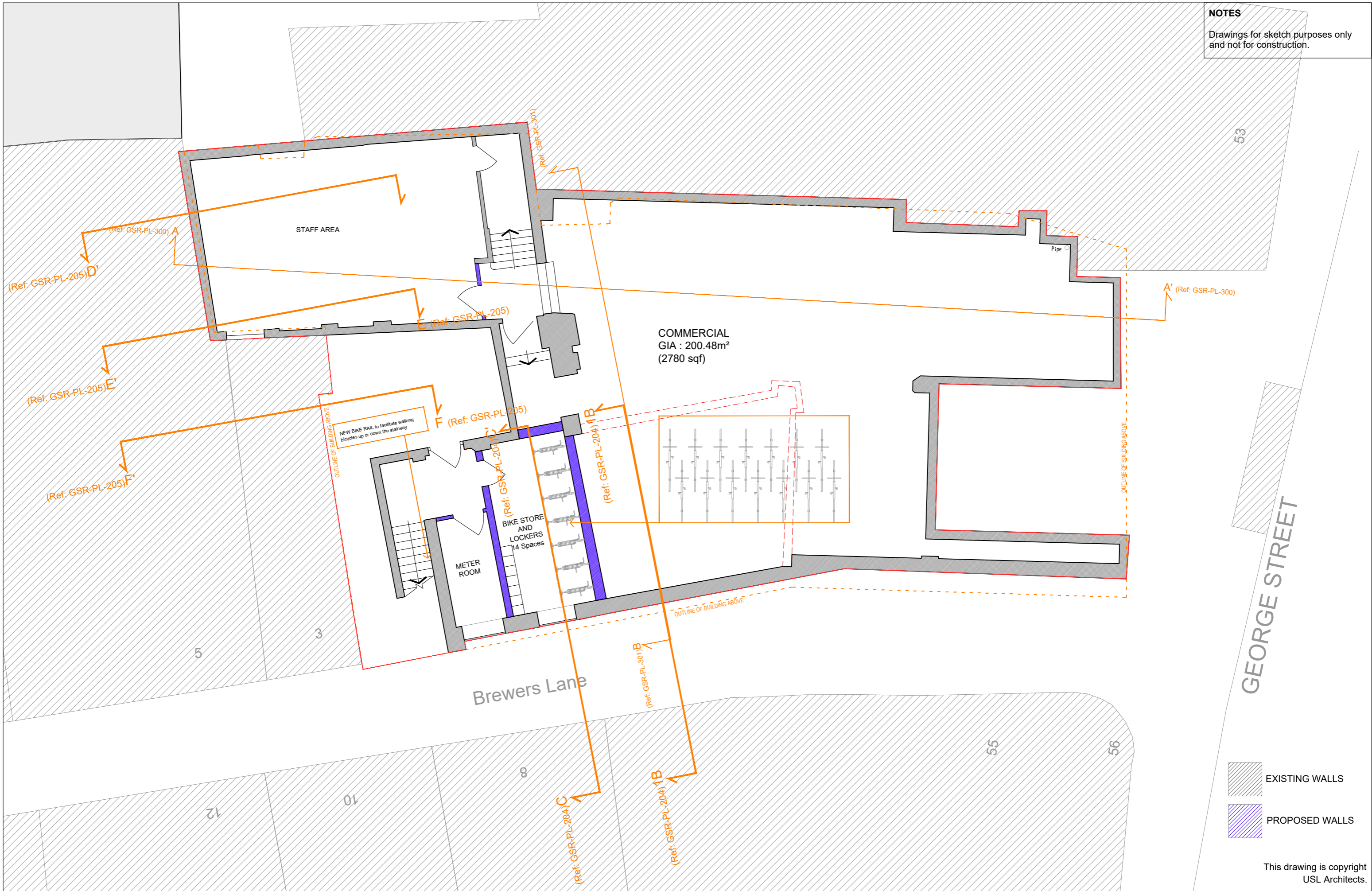

EXISTING WALLS  
 PROPOSED WALLS

This drawing is copyright  
 USL Architects.

**USL ARCHITECTS**  
 Ground floor  
 7 Progress Business Centre  
 Whittle Parkway  
 Burnham SL1 6DQ  
 England  
 usl@uslarchitects.co.uk

Job No.	20/ GSR
Date	22/04/2021

**Job**  
**GEORGE STREET RICHMOND**  
 53-54 GEORGE STREET,  
 RICHMOND, SURREY  
 TW9 1HJ

**Drawing**  
 PROPOSED BASEMENT

Drawing No.	GSR/PL/100	
Revision	Dm	Chk
	CDG	BK

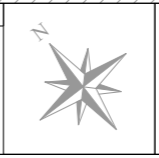

0m 1m 2m 3m 4m 5m 6m 7m 8m 9m 10m  
 PAPER SIZE: A3  
 SCALE 1:100