

NOTES

1. THIS DRAWING IS TO BE READ IN CONJUNCTION WITH THE ELECTRICAL SPECIFICATION AND ALL OTHER STRUCTURAL AND ARCHITECTURAL DRAWINGS.
2. ALL EXTERNAL LIGHTING IS TO BE CONTROLLED BY A PHOTOCELL/TIMECLOCK ARRANGEMENT WITH MANUAL OVERRIDE SWITCH.
3. THE EXTERNAL TIME CLOCK IS TO BE SET SO ALL EXTERNAL LIGHTING IS OFF BETWEEN 2300 & 0700HRS.
4. ALL LIGHTING COLUMNS TO BE SITED TO SUIT LOCATION AWAY FROM TREES LANDSCAPE AND EXTERNAL FURNITURE.
5. THE ELECTRICAL SUB CONTRACTOR SHALL REFER TO THE ARCHITECTS LANDSCAPE DRAWING FOR FINAL POSITIONS.
6. THE NORMAL PEDESTRIAN ESCAPE ROUTES SHALL BE PROVIDED WITH EMERGENCY LIGHTING TO THE SAME STANDARD AS ESCAPE ROUTES WITHIN NON-RESIDENTIAL PUBLIC PREMISES IN ACCORDANCE WITH BS 5266-1.
7. THE ELECTRICAL SUB-CONTRACTOR SHALL ALLOW ABOVE ALL FINAL EXITS A SUITABLY IP RATED WALL MOUNTED LUMINAIRE OR 3-HOUR EMERGENCY BATTERY BACK UP.

LIGHTING STANDARDS:

THE EXTERNAL LIGHTING DESIGN WILL BE DESIGNED IN LINE WITH THE FOLLOWING DESIGN STANDARDS:-

- I.E. THE INSTANTION OF LIGHTING ENGINEERS GUIDANCE NOTES FOR THE REDUCTION OF OBTRUSIVE LIGHT SIGNATURE
- BS EN 12542 LIGHTING OF WORK PLACES - OUTDOOR WORK PLACES PART 2

DESIGN CRITERIA

APPLICATION	MINIMUM MAINTAINED MEAN ILLUMINANCE (lx)	UNIFORMITY (min/max/average)	NOTES
CAR PARKS	10	0.25	THE ILLUMINANCE IS MEASURED ON THE GROUND
PEDESTRIAN WALKWAYS	5	0.25	THE ILLUMINANCE IS MEASURED ON THE GROUND
BUILDING PERIMETER	5	0.25	THE ILLUMINANCE IS MEASURED ON THE GROUND

LEGEND

- PROPOSED NEW BUILDING/DEVELOPMENT FOOTPRINT
- CAR PARK, BIN STORE, CYCLE STORE AREAS AND ACCESS ROADS SHALL BE DESIGNED IN ACCORDANCE WITH BS5489-1:2013 & L1G5
- (L)E) REDUCTION OF OBTRUSIVE LIGHT ENVIRONMENTAL ZONES MEDIUM DISTRICT BRIGHTNESS AREA (E3)
- 10 LUX MAINTAINED AVERAGE ILLUMINANCE (Eav)
- 25% MINIMUM OVERALL UNIFORMITY RATIO (Uo)
- PEDESTRIAN WALKWAY AREAS WILL BE DESIGNED IN ACCORDANCE WITH BS5489-1:2013 & LGS
- (L)E) REDUCTION OF OBTRUSIVE LIGHT ENVIRONMENTAL ZONES MEDIUM DISTRICT BRIGHTNESS AREA (E3)
- 5 LUX MAINTAINED AVERAGE ILLUMINANCE (Eav)
- 0.25% MINIMUM OVERALL UNIFORMITY RATIO (Uo)
- BUILDING PERIMETER SECURITY WILL BE DESIGNED IN ACCORDANCE WITH BS5489-1:2003 & LGS
- (L)E) REDUCTION OF OBTRUSIVE LIGHT ENVIRONMENTAL ZONES MEDIUM DISTRICT BRIGHTNESS AREA (E3)
- 5 LUX MAINTAINED AVERAGE ILLUMINANCE (Eav)
- 0.25% MINIMUM OVERALL UNIFORMITY RATIO (Uo)
- AUDIO VIDEO INTERCOM CALL PANEL LOCATED AT PEDESTRIAN ENTRANCE GATE
- AUDIO VIDEO INTERCOM MASTER PANEL LOCATED AT MAIN SCHOOL RECEPTION ON REMOTE GATE RELEASE MAGNETIC GATE CONTACT WITH FIRE ALARM INTERFACE TO FAULTSAFE OPEN
- GREEN PUSH TO EXIT BUTTON (GATE / POST MOUNTED)
- ACCESS CONTROL PROXIMITY READER (GATE / POST MOUNTED)

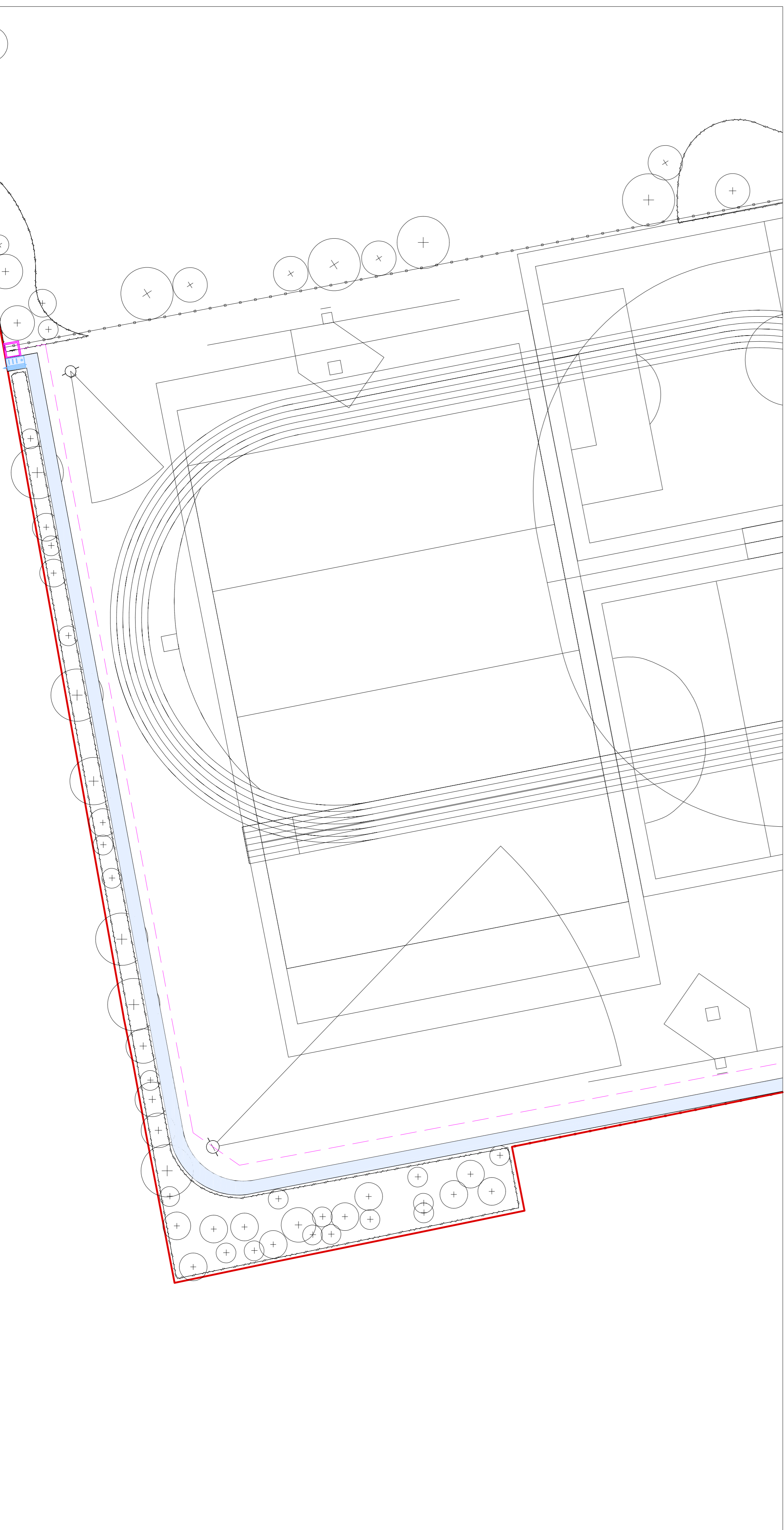
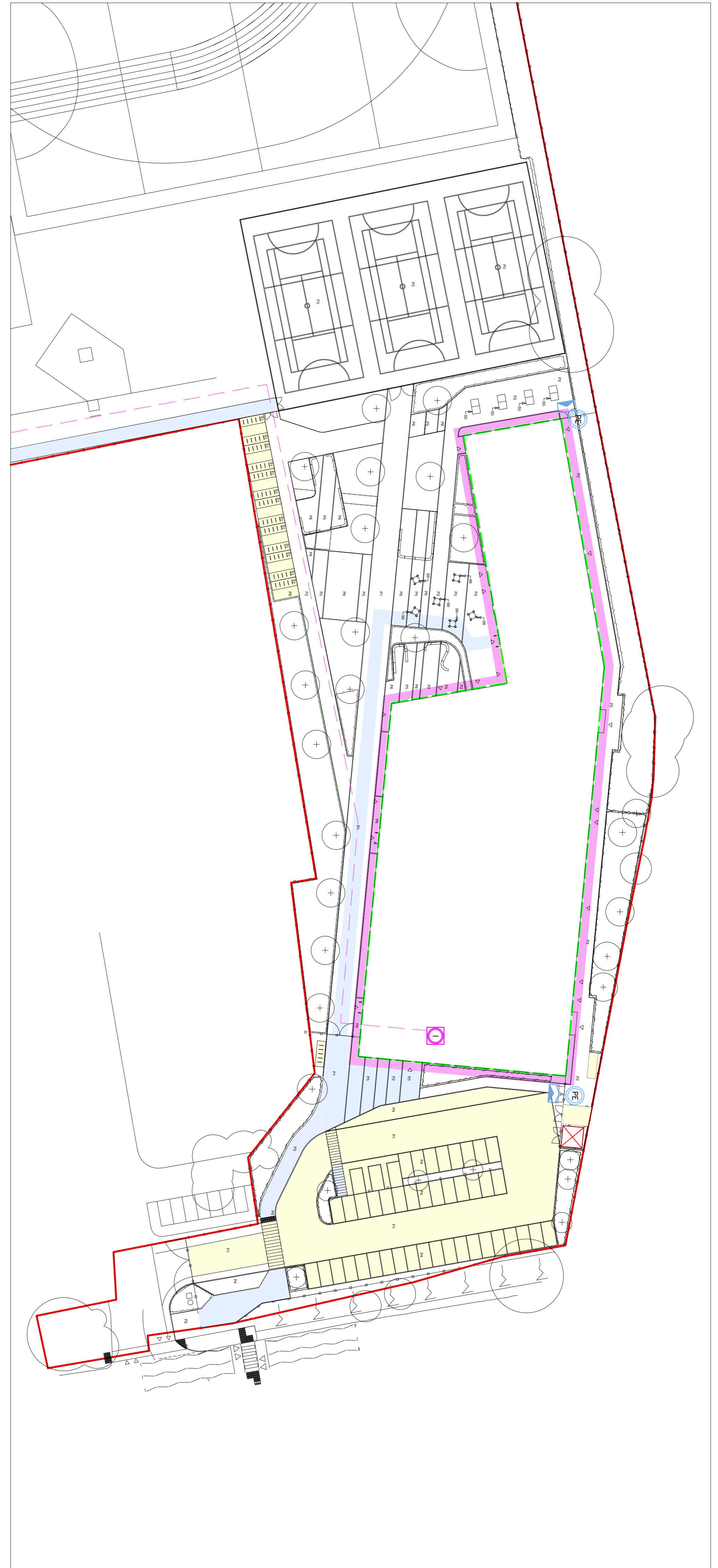

couchperrywilkes
 engineering change

Birmingham | +44(0) 121 709 6009
 Nottingham | +44(0) 115 924 5248
 Huddersfield | +44(0) 148 645 2488
 Leeds | +44(0) 113 247 0709
 London | +44(0) 1753 52011
 Manchester | +44(0) 161 924 7292
 Cambridge City | +44(0) 122 327 0112
 Follow us @couchperrywilkes

Bowler & Kirkland
 EDUCATION

CLIENT

PROJECT

TURING HOUSE SCHOOL

PROPOSED EXTERNAL LIGHTING & SECURITY PHILOSOPHY LAYOUT

STATUS

CONTRACTORS PROPOSALS

SCALE

1:500 @ A1

DATE

JAN 2018

BY

MA JF

DATE

1500

FILE

FS0316-CPW-ZZ-XX-DR-E-1000

REV

P06