

NOTES

All dimensions are to be checked on site by the contractor before any work is commenced.
In the case of apparent discrepancy refer immediately to Twickenham Surveys.
The accuracy and completeness of this survey is dependent on the original survey brief including the scale intended.
The type and extent of information and the survey accuracy will have been matched to the client's original requirements.
Twickenham Surveys accepts no responsibility or liability to later users without prior consent.
Surveyed boundary features may not represent the extent of legal ownership.
The detail of this survey was established for a brief requiring a 1:50 plot. It is therefore suitable for plotting or planning/designing at scales of 1:50 or smaller.
The survey grid is not related to Ordnance Survey National Grid.
Level positions are indicated by a cross.
Levels relate to TBM 10.00m STN1 nailhead located on opposite pavement.

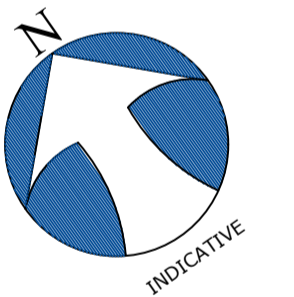
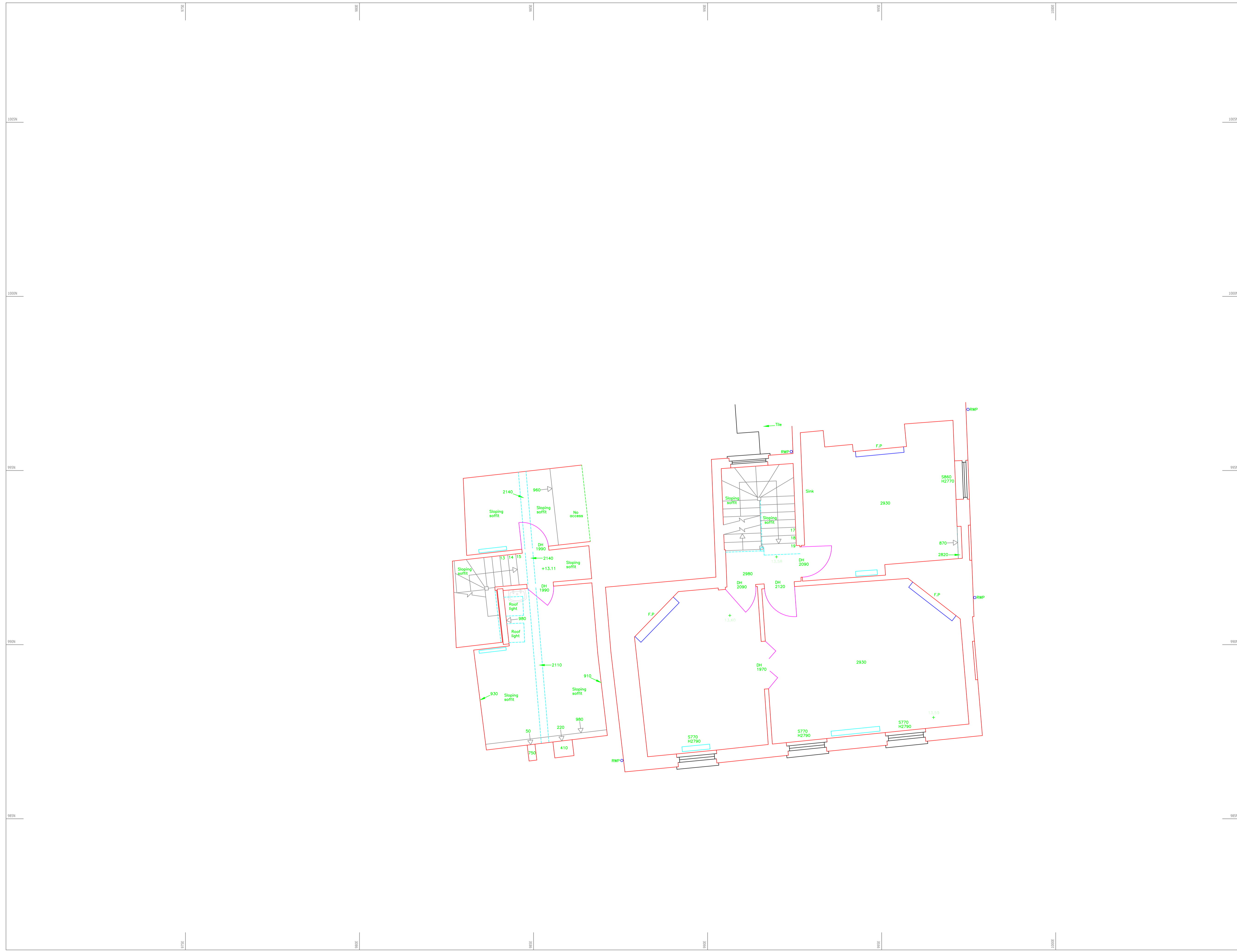

FIRST FLOOR PLAN

**19 & 19a KING STREET
RICHMOND
TW9 1ND**

Drawing No. : 20651
Scale : refer grid
Date : JULY 2020
Drawn by : SC
Checked by : NHS

TWICKENHAM SURVEYS
LAND AND BUILDING SURVEYORS

CENTRAL HOUSE
124 HIGH STREET
HAMPTON HILL
MIDDLESEX TW12 1NS
Tel-020 8614 4480
mail@twickenhamsurveys.co.uk
www.twickenhamsurveys.co.uk